



Oregon

Theodore R. Kulongoski, Governor

Department of Transportation
Technical Services
Roadway Engineering Section
355 Capitol Street NE, Room 222
Salem, OR 97301-3871
Telephone 503-986-3714
FAX 503-986-3749

DATE: July 9, 2009

Addenda No. 2

TO: PLAN HOLDERS

PREPARED BY: Chris Beatty
Chris Beatty, P.E.

APPROVED BY: Ken Ackerman
Ken Ackerman, P.E.

SUBJECT: Bay Blvd Sidewalk, Lights, & Paving (Newport) Section
SW Bay Boulevard
Lincoln County
(Bids to be opened and read July 16, 2009)

The following changes are made to the Project Bid Booklet:

1. The following changes are made to the Project Bid Items:

a. Quantity changes:

<u>Number</u>	<u>Item</u>	<u>Quantity</u>	
		<u>Original</u>	<u>New</u>
0240	6 INCH STORM SEWER PIPE, 5 FT DEPTH	49	100
0250	8 INCH STORM SEWER PIPE, 5 FT DEPTH	170	60
0310	TRENCH RESURFACING	23	300
0620	2 INCH GREY SCHEDULE 40 PVC CONDUIT FOR POWER	1,670	50
0630	2 INCH SCHEDULE 40 PVC CONDUIT FOR CHARTER	4,719	4,380

Bay Blvd Sidewalk, Lights, & Paving (Newport) Section
 SW Bay Boulevard
 Lincoln County
 (Bids to be opened and read July 16, 2009)

Addenda No. 2

0640	2 INCH SCHEDULE 40 PVC CONDUIT FOR COASTCOM	2,000	1,730
0650	2 INCH SCHEDULE 40 PVC CONDUIT FOR QWEST	429	930
0660	3 INCH GREY SCHEDULE 40 PVC CONDUIT FOR POWER	3,867	6,440
0670	4 INCH GREY SCHEDULE 40 PVC CONDUIT FOR POWER	1,758	1,960
0680	4 INCH SCHEDULE 40 PVC CONDUIT FOR QWEST	3,796	3,100
0710	2 FOOT BY 3 FOOT VAULT	15	16

b. Deleted items:

<u>Number</u>	<u>Item</u>
0260	12 INCH STORM SEWER PIPE 5 FT DEPTH
0790	VAULT COASTCOM
0830	VAULT-QWEST 9 FOOT BY 7 FOOT

c. Added items:

<u>Number</u>	<u>Item</u>	<u>Unit</u>	<u>Quantity</u>
0840	LEVEL 2, 1/2 INCH DENSE MHMAC MIXTURE	TON	60
0850	8 INCH STORM SEWER PIPE (C-900), 5 FT DEPTH	FOOT	230
0860	TYPE 2 CATCH BASIN	EACH	1
0870	VAULT-QWEST 4.5 FOOT BY 4.5 FOOT	EACH	1

Make a copy of and use the new attached Bid Sheets. A Bid **not** including these new Bid Sheets will be rejected as non-responsive.

The following changes are made to the Project Special Provisions:

1. Subsection **00150.50 Cooperation with Utilities**, Subsection (f) **Utility Information** – Utility No. 5. NW Natural Gas, the Estimated Completion Date (Time) column with the words "Prior to Construction" is replaced with the following:

During Construction

2. Subsection **00150.50 Cooperation with Utilities**, Subsection (f) **Utility Information** – Utility No. 5. NW Natural Gas, replace the first paragraph beginning with "NW Natural Gas will be" with the following:

NW Natural Gas will be on hand to monitor any gas line conflicts encountered during project construction.

3. Subsection **00495.00 Scope** – This subsection is added prior to Subsection 00495.80 Measurement:

This work consists of resurfacing pipe trenches, including replacement of pavement, curbs, sidewalks, rock surfacing, topsoil, landscaping and other features removed or damaged during pipe trenching operations. These include areas that are outside of the pavement reconstruction limits identified on the plans, i.e. parking lots, and areas of existing sidewalk on the north side of Bay Boulevard that are not identified on the plans for reconstruction. Items covered under scope of work include, but is not limited to, streetlight and traffic sign foundation construction, water meter/service installation, sanitary sewer service laterals, utility vaults and utility conduit.

4. Subsection **00495.80 Measurement** – Add the following bullet item under the second paragraph that begins with "The width will be":

12 inches for pipe less than 6"

5. Subsection **00970.90 Lump Sum Basis** - The paragraph that begins with the words "Item (a) will include" is replaced with the following:

Item (a) will include payment in full for removing existing lighting hardware, furnishing and installing all new lighting hardware, connections to power sources as indicated, street light and conduit trenching (south side of Bay Boulevard and west side of Bay Street), directional boring of conduit (north side of Bay Boulevard and east side of Bay Street), conduits, placing all materials, furnishing all equipment, tools, labor, and incidental to complete the work specified.

6. Subsection **01210.10 Materials** - The first sentence of the paragraph that begins with the words "All conduits and vaults" is replaced with the following:

All conduit and vault materials will be provided to the Contractor by the appropriate utility at no cost to the Contractor, except for all conduit, boxes and vaults for Qwest utilities, which shall be supplied by the Contractor.

7. Subsection **01210.43 Qwest Installation** - The first sentence of the paragraph that begins with the words "Install Qwest Conduits" is replaced with the following:

Install Contractor supplied conduit, boxes and vaults to Qwest standards.

8. Subsection **01210.43 Charter Communications Installation** - The subsection number, 01210.43, and title, Charter Communications Installation, is replaced with the following:

Subsection 01210.44 Charter Communications Installation

9. Subsection **01210.43 CoastCom, Inc Installation** - The first paragraph beginning with "Install CoastCom, Inc conduits and vaults" is replaced with the following:

Install CoastCom, Inc conduit and vaults to CoastCom, Inc standards. CoastCom, Inc will have an on-site inspector reviewing the work. The Contractor will need to give CoastCom, Inc three weeks notice prior to installing the conduit and vault system. After the underground conduits and vaults have been installed, CoastCom, Inc will certify that the work is complete.

10. Subsection **01210.43 CoastCom, Inc Installation** - The subsection number, 01210.43, and title, CoastCom, Inc Installation, is replaced with the following:

Subsection 01210.45 CoastCom, Inc Installation

11. Subsection **01210.80 Measurement** – The first bullet item that begins with the words "The accepted quantities for Vault" is replaced with the following:

The accepted quantities for vault installation will be on a per each basis and will include the complete installation of the utility company supplied vault including excavation, bedding, backfill and other elements required for the complete installation of the vault to the Engineer including removal and replacement of wooden and rockery retaining walls on Case Street. In addition, for Qwest vaults, the Contractor shall supply all materials and will be on a per each basis including the complete installation listed above.

12. Subsection **01210.80 Measurement** – The third bullet item that begins with the words "The accepted quantities of conduit" is replaced with the following:

The accepted quantities of conduit installed will be the length, to the nearest foot and will include all bends. The utility company will supply the materials to be installed except for Qwest, where the Contractor shall supply all conduit.

13. Subsection **01210.90 Payment** – The second sentence of the second paragraph that begins with "In Item (a)" is replaced with the following:

Payment will include excavation, bedding, compacted granular backfill and other elements required for the complete installation of the vault to the Engineer including removal and replacement of wooden and rockery retaining walls on Case Street.

14. Subsection **01210.90 Payment** – The second sentence of the second paragraph that begins with "In Item (b)" is replaced with the following:

Payment will include supplying vaults, excavation, bedding, compacted granular backfill and other elements required for the complete installation of the vault to the Engineer including removal and replacement of wooden and rockery retaining walls on Case Street.

15. Subsection **01210.90 Payment** – The second sentence of the second paragraph that begins with "In Item (c)" is replaced with the following:

Payment will include excavation, bedding, compacted granular backfill and other elements required for the complete installation of the vault to the Engineer including removal and replacement of wooden and rockery retaining walls on Case Street.

16. Subsection **01210.90 Payment** – The second sentence of the second paragraph that begins with "In Item (d)" is replaced with the following:

Payment will include excavation, bedding, compacted granular backfill and other elements required for the complete installation of the vault to the Engineer including removal and replacement of wooden and rockery retaining walls on Case Street.

17. Subsection **01210.90 Payment** – Item (g) is deleted from the sixth paragraph that begins with the words "In items (f), (g), (h) and (i)".

18. Subsection **01210.90 Payment** – The following paragraph is added after the paragraph that begins "In items (f), (g), (h) and (i)":

In item (g), the size of the conduit will be inserted into the bid schedule. Payment will be for the installation of conduit supplied by the contractor. Contractor will need to install conduit to utility standards.

The following changes are made to the Project Plans:

1. Plan sheets 2A, 2A-2, 2B-23, 2B-24, 2B-34, 2E-2, 2E-4, 2E-5, 2E-7 and 7 are replaced with revised plan sheets 2A, 2A-2, 2B-23, 2B-24, 2B-34, 2E-2, 2E-4, 2E-5, 2E-7 and 7.
2. Plan sheet 2B-38 is added.

These changes will be included in the Contract for this Project. It is understood that your Bid will be submitted accordingly.

Bay Blvd Sidewalk, Lights, & Paving (Newport) Section
SW Bay Boulevard
Lincoln County
(Bids to be opened and read July 16, 2009)

Addenda No. 2

Make copies of the new Bid Sheets to replace the Special Provisions Bid Schedule Sheets.

CAB : KMA

Attachments: New Bid Sheets
Revised Plan Sheets
New Plan Sheet

BID SCHEDULE

CONTRACT ID: 14081

PROJECT: BAY BLVD SIDEWALK, LIGHTS & PAVING
(NEWPORT)

PROJECT KEY: 16544

ADDENDUM NUMBER: 2

ITEM NO	ITEM DESCRIPTION	QUANTITY AND UNITS	UNIT PRICE (IN FIGURES)	BID AMOUNT (IN FIGURES)
SECTION 0001 TEMPORARY FEATURES AND APPURTENANCES				
0010	0210-0100000A MOBILIZATION	LS	ALL	
0020	0225-0100000A TEMPORARY PROTECTION AND DIRECTION OF TRAFFIC	LS	ALL	
0030	0225-0102000J TEMPORARY SIGNS	SQFT	500.00	
0040	0225-0168000T FLAGGERS	HOUR	1,500.00	
0050	0280-0100000A EROSION CONTROL	LS	ALL	
0060	0280-0113000F SEDIMENT FENCE, UNSUPPORTED	FOOT	109.00	
0070	0280-0114000E INLET PROTECTION	EACH	32.00	
0080	0280-0115000F SEDIMENT BARRIER	FOOT	40.00	
0090	0290-0100000A POLLUTION CONTROL PLAN	LS	ALL	
0100	0290-0102000A WORK CONTAINMENT PLAN AND SYSTEM	LS	ALL	
0110	0290-9Z90000A CONTAMINATED SOIL REMOVAL AND DISPOSAL	LS	ALL	
0120	0290-9Z90000A GROUNDWATER TREATMENT AND DISPOSAL	LS	ALL	

BID SCHEDULE

CONTRACT ID: 14081

PROJECT: BAY BLVD SIDEWALK, LIGHTS & PAVING
(NEWPORT)

PROJECT KEY: 16544

ADDENDUM NUMBER: 2

ITEM NO	ITEM DESCRIPTION	QUANTITY AND UNITS	UNIT PRICE (IN FIGURES)	BID AMOUNT (IN FIGURES)
0130	0290-9Z90000A HAZARDOUS SUBSTANCE HEALTH AND SAFETY PLAN	LS ALL		

SECTION 0002 ROADWORK

0140	0305-0100000A CONSTRUCTION SURVEY WORK	LS ALL		
0150	0310-0105000E REMOVAL OF MANHOLES	EACH 2.00		
0160	0310-0106000A REMOVAL OF STRUCTURES AND OBSTRUCTIONS	LS ALL		
0170	0330-0105000K GENERAL EXCAVATION	CUYD 2,710.00		

SECTION 0003 DRAINAGE AND SEWERS

0180	0410-0102000F PIPE BURSTING AND HDPE LINER, 12 INCH	FOOT 1,070.00		
0190	0445-030004BF 4 INCH SANITARY SEWER PIPE, 10 FT DEPTH	FOOT 775.00		
0200	0445-030004CF 4 INCH SANITARY SEWER PIPE, 20 FT DEPTH	FOOT 410.00		
0210	0445-030006BF 6 INCH SANITARY SEWER PIPE, 10 FT DEPTH	FOOT 75.00		
0220	0445-030010CF 10 INCH SANITARY SEWER PIPE, 20 FT DEPTH	FOOT 53.00		
0230	0445-030018CF 18 INCH SANITARY SEWER PIPE, 20 FT DEPTH	FOOT 6.00		

BID SCHEDULE

CONTRACT ID: 14081

PROJECT: BAY BLVD SIDEWALK, LIGHTS & PAVING
(NEWPORT)

PROJECT KEY: 16544

ADDENDUM NUMBER: 2

ITEM NO	ITEM DESCRIPTION	QUANTITY AND UNITS	UNIT PRICE (IN FIGURES)	BID AMOUNT (IN FIGURES)
0240	0445-035006AF 6 INCH STORM SEWER PIPE, 5 FT DEPTH	100.00 FOOT		
0250	0445-035008AF 8 INCH STORM SEWER PIPE, 5 FT DEPTH	60.00 FOOT		
0260	0000-0100000A DELETED BID ITEM	ALL LS	0.00	0.00
0270	0470-0100000E CONCRETE SANITARY SEWER MANHOLES	5.00 EACH		
0280	0470-0103000E CONCRETE MANHOLES, WITH INLET	1.00 EACH		
0290	0470-0112000E STORMFILTER CATCH BASIN	12.00 EACH		
0300	0490-0104000E CONNECTION TO EXISTING STRUCTURES	3.00 EACH		
0310	0495-0100000J TRENCH RESURFACING	300.00 SQYD		

SECTION 0004 BASES

0320	0620-0120000J COLD PLANE PAVEMENT REMOVAL, 2 INCHES DEEP	317.00 SQYD		
0330	0640-0100000M AGGREGATE BASE	4,475.00 TON		

SECTION 0005 WEARING SURFACES

0340	0744-0302000M LEVEL 3, 1/2 INCH DENSE MHMAC MIXTURE	2,140.00 TON		
------	---	-----------------	--	--

BID SCHEDULE

CONTRACT ID: 14081

PROJECT: BAY BLVD SIDEWALK, LIGHTS & PAVING
(NEWPORT)

PROJECT KEY: 16544

ADDENDUM NUMBER: 2

ITEM NO	ITEM DESCRIPTION	QUANTITY AND UNITS	UNIT PRICE (IN FIGURES)	BID AMOUNT (IN FIGURES)
0350	0759-0105000F CONCRETE CURBS, CURB AND GUTTER, MODIFIED	1,774.00 FOOT		
0360	0759-0127000J CONCRETE DRIVEWAYS, REINFORCED	1,323.00 SQFT		
0370	0759-0128000J CONCRETE WALKS	4,152.00 SQFT		
0380	0759-0140000J 6 INCH CONCRETE SURFACING	8,319.00 SQFT		
0390	0759-0153000E CONCRETE SIDEWALK RAMPS	6.00 EACH		

SECTION 0006 PERMANENT TRAFFIC SAFETY AND GUIDANCE DEVICES

0400	0860-0200000F LONGITUDINAL PAVEMENT MARKINGS - PAINT	5,340.00 FOOT		
0410	0867-0106000E PAVEMENT LEGEND, PAINT, "STOP"	2.00 EACH		
0420	0867-0144000J PAVEMENT BAR, TYPE PAINT	306.00 SQFT		
0430	0867-0172000E PAVEMENT LEGEND, PAINT DISABLED	1.00 EACH		

SECTION 0007 PERMANENT TRAFFIC CONTROL AND ILLUMINATION SYSTEMS

0440	0905-0101000A REMOVE AND REINSTALL EXISTING SIGNS	ALL LS		
0450	0930-9Z90000A DECORATIVE SIGN BASE AND SUPPORT	ALL LS		

BID SCHEDULE

CONTRACT ID: 14081

PROJECT: BAY BLVD SIDEWALK, LIGHTS & PAVING
(NEWPORT)

PROJECT KEY: 16544

ADDENDUM NUMBER: 2

ITEM NO	ITEM DESCRIPTION	QUANTITY AND UNITS	UNIT PRICE (IN FIGURES)	BID AMOUNT (IN FIGURES)
0460	0970-9Z90000A ILLUMINATION INSTALLATION COMPLETE	LS ALL		

SECTION 0008 WATER SUPPLY SYSTEMS

0470	1140-0156000F 4 INCH POTABLE WATER PIPE, FITTINGS AND COUPLINGS WITH RESTR AINED JOINTS AND CLASS B BACKFILL	FOOT	290.00	
0480	1140-0157000F 6 INCH POTABLE WATER PIPE, FITTINGS AND COUPLINGS WITH RESTR AINED JOINTS AND CLASS B BACKFILL	FOOT	285.00	
0490	1140-0158000F 8 INCH POTABLE WATER PIPE, FITTINGS AND COUPLINGS WITH RESTR AINED JOINTS AND CLASS B BACKFILL	FOOT	56.00	
0500	1140-0160000F 12 INCH POTABLE WATER PIPE, FITTINGS AND COUPLINGS WITH REST RAINED JOINTS AND CLASS B BACKFILL	FOOT	1,153.00	
0510	1150-0100000E 2 INCH GATE VALVE	EACH	13.00	
0520	1150-0102000E 4 INCH GATE VALVE	EACH	10.00	
0530	1150-0103000E 6 INCH GATE VALVE	EACH	11.00	
0540	1150-0104000E 8 INCH GATE VALVE	EACH	1.00	

BID SCHEDULE

CONTRACT ID: 14081

PROJECT: BAY BLVD SIDEWALK, LIGHTS & PAVING
(NEWPORT)

PROJECT KEY: 16544

ADDENDUM NUMBER: 2

ITEM NO	ITEM DESCRIPTION	QUANTITY AND UNITS	UNIT PRICE (IN FIGURES)	BID AMOUNT (IN FIGURES)
0550	1150-0106000E 12 INCH GATE VALVE	EACH 3.00		
0560	1160-0101000E RESETTING EXISTING HYDRANTS	EACH 4.00		
0570	1170-0101000E 1 INCH WATER SERVICE CONNECTIONS	EACH 36.00		
0580	1170-0103000E 2 INCH WATER SERVICE CONNECTIONS	EACH 12.00		
0590	1170-9Z90000E LARGE WATER METER BOXES	EACH 8.00		
0600	1170-9Z90000E SMALL WATER METER BOXES	EACH 40.00		
0610	1170-9Z90000E WATER VAULT	EACH 1.00		

SECTION 0009 MISCELLANEOUS UTILITY SYSTEMS

0620	0583-0105000F 2 INCH GREY SCHEDULE 40 PVC CONDUIT FOR POWER	FOOT 50.00		
0630	0583-0105000F 2 INCH SCHEDULE 40 PVC CONDUIT FOR CHARTER	FOOT 4,380.00		
0640	0583-0105000F 2 INCH SCHEDULE 40 PVC CONDUIT FOR COASTCOM	FOOT 1,730.00		
0650	0583-0105000F 2 INCH SCHEDULE 40 PVC CONDUIT FOR QWEST	FOOT 930.00		
0660	0583-0107000F 3 INCH GREY SCHEDULE 40 PVC CONDUIT FOR POWER	FOOT 6,440.00		

BID SCHEDULE

CONTRACT ID: 14081

PROJECT: BAY BLVD SIDEWALK, LIGHTS & PAVING
(NEWPORT)

PROJECT KEY: 16544

ADDENDUM NUMBER: 2

ITEM NO	ITEM DESCRIPTION	QUANTITY AND UNITS	UNIT PRICE (IN FIGURES)	BID AMOUNT (IN FIGURES)
0670	0583-0109000F 4 INCH GREY SCHEDULE 40 PVC CONDUIT FOR POWER	1,960.00 FOOT		
0680	0583-0109000F 4 INCH SCHEDULE 40 PVC CONDUIT FOR QWEST	3,100.00 FOOT		
0690	1150-9Z90000F JOINT TRENCH AND BACKFILL	4,143.00 FOOT		
0700	1200-9Z90000E 2 FOOT BY 1.5 FOOT VAULT	6.00 EACH		
0710	1200-9Z90000E 2 FOOT BY 3 FOOT VAULT	16.00 EACH		
0720	1200-9Z90000E 5 FOOT BY 7 FOOT VAULT	2.00 EACH		
0730	1200-9Z90000E 7 FOOT BY 7 FOOT VAULT	4.00 EACH		
0740	1200-9Z90000E 9 FOOT BY 7 FOOT VAULT	3.00 EACH		
0750	1200-9Z90000E AMP PED VAULT CHARTER	3.00 EACH		
0760	1200-9Z90000E PULL VAULT-COASTCOM	7.00 EACH		
0770	1200-9Z90000E TAP VAULT CHARTER	15.00 EACH		
0780	1200-9Z90000E TV PED VAULT CHARTER	1.00 EACH		
0790	0000-0100000A DELETED BID ITEM	ALL LS	0.00	0.00

BID SCHEDULE

CONTRACT ID: 14081

PROJECT: BAY BLVD SIDEWALK, LIGHTS & PAVING
(NEWPORT)

PROJECT KEY: 16544

ADDENDUM NUMBER: 2

ITEM NO	ITEM DESCRIPTION	QUANTITY AND UNITS	UNIT PRICE (IN FIGURES)	BID AMOUNT (IN FIGURES)
0800	1200-9Z90000E VAULT-QWEST - 5 FOOT BY 2 FOOT	EACH 5.00		
0810	1200-9Z90000E VAULT-QWEST 2.5 FOOT BY 2.5 FOOT	EACH 3.00		
0820	1200-9Z90000E VAULT-QWEST 5 FOOT BY 3. 5 FOOT	EACH 2.00		
0830	0000-0100000A DELETED BID ITEM	LS ALL	0.00	0.00

SECTION 0010 ADDED BID ITEMS

0840	0744-0202000M LEVEL 2, 1/2 INCH DENSE MHMAC MIXTURE	TON 60.00		
0850	0445-9Z90000F 8 INCH STORM SEWER PIPE (C-900) 5 FT DEPTH	FOOT 230.00		
0860	0470-9Z90000E TYPE 2 CATCH BASIN	EACH 1.00		
0870	1200-9Z90000E VAULT - QUEST 4.5 FOOT BY 4.5 FOOT	EACH 1.00		
	TOTAL BID			

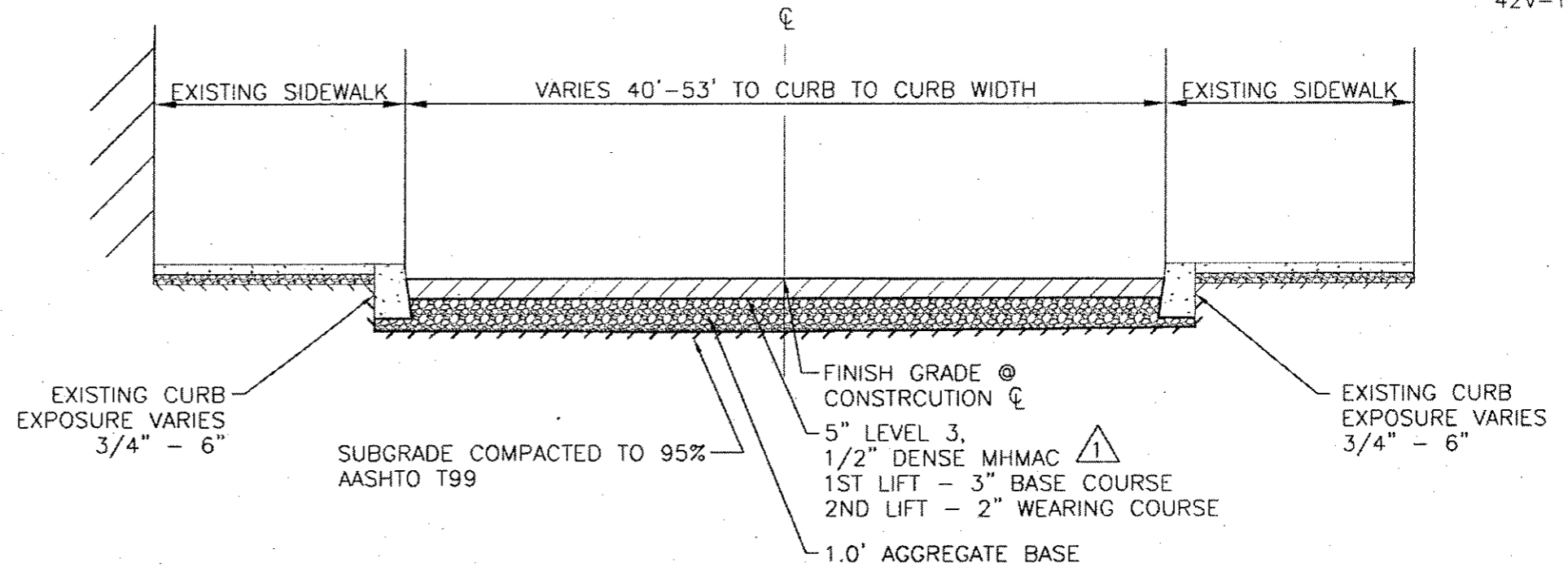

TYPICAL FALL STREET SECTION
 LOOKING NORTH
 (STA 0+00 TO 0+65.130)
 NTS

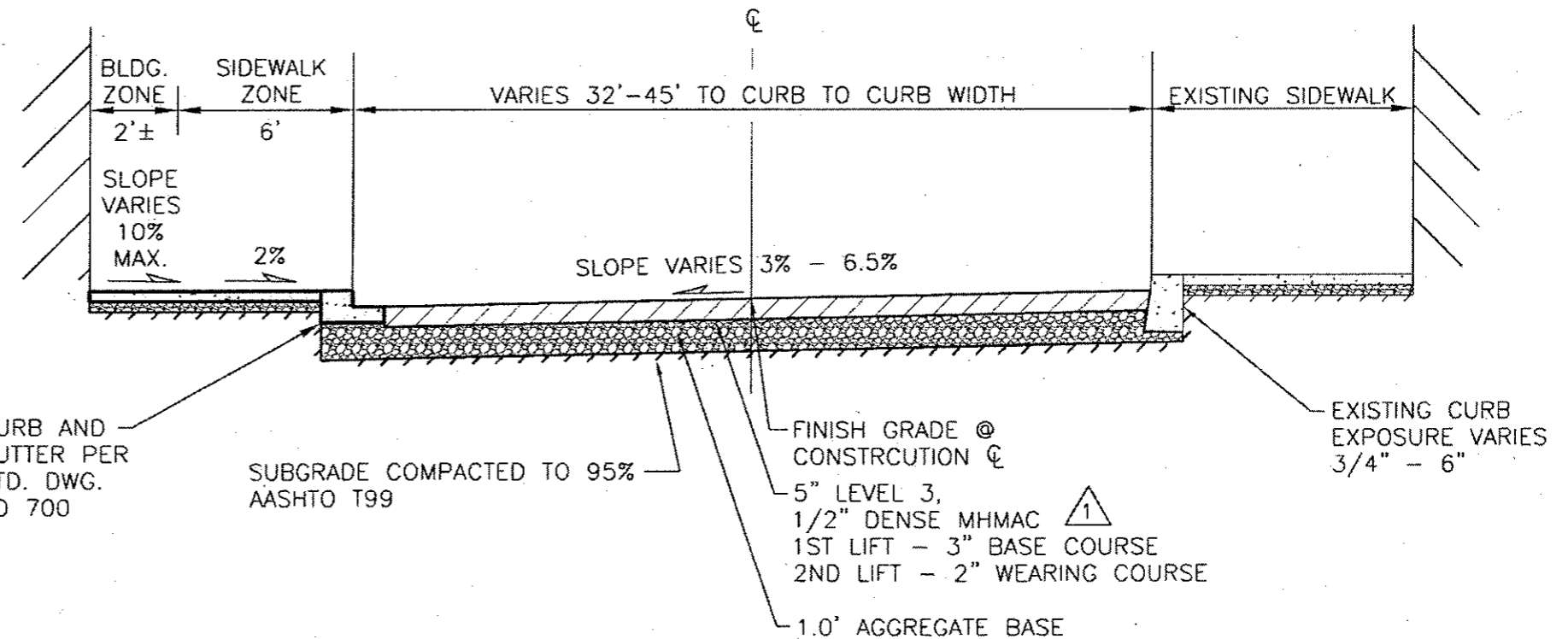

TYPICAL BAY BOULEVARD SECTION
 LOOKING WEST
 (STA -0+68.13 TO 11+78.52)
 NTS

REVISIONS	
1	REVISED 7-8-2009 ASPHALT DEPTH (INCHES) AND LIFT DATA
2	

OREGON DEPARTMENT OF TRANSPORTATION

Harper Houf Peterson Righellis Inc.
ENGINEERS • PLANNERS • LANDSCAPE ARCHITECTS • SURVEYORS
 205 SE Spokane Street, Suite 200 Portland, OR 97202 phone: 503.221.1151 www.hhp.com fax: 503.221.1171

PAVING
 BAY BLVD SIDEWALK, LIGHTS & PAVING (NEWPORT) SECTION
 SW BAY BOULEVARD
 LINCOLN COUNTY

Reviewed By HHPR Team
 Designed By City Of Newport & HHPR Team
 Drafted By HHPR Team

SHEET NO. 2A
TYPICAL ROADWAY SECTIONS



EXPIRES: 12/31/09

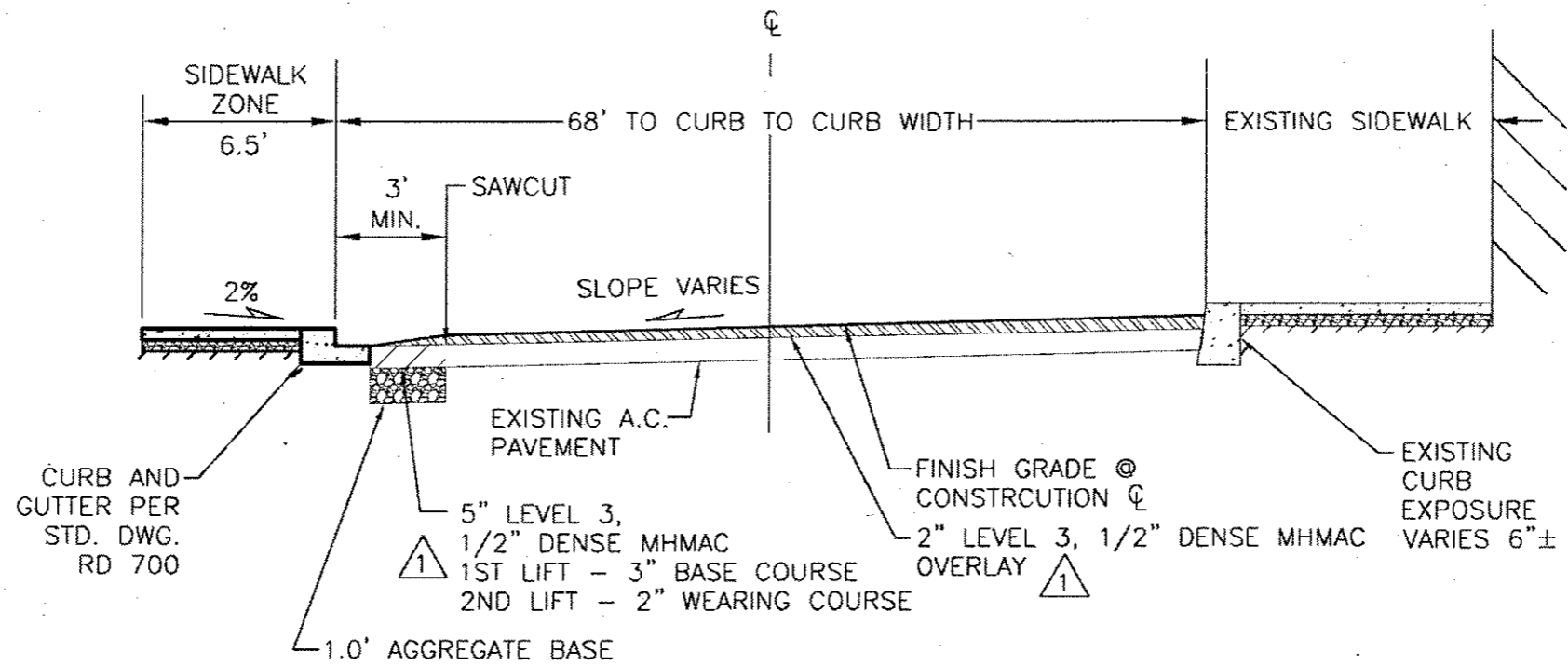

TYPICAL BAY STREET SECTION
 LOOKING NORTH
 (STA 11+78.52 TO 12+94.86)
 NTS

REVISIONS	
①	REVISED 7-8-2009 ASPHALT DEPTH (INCHES) AND LIFT DATA
②	

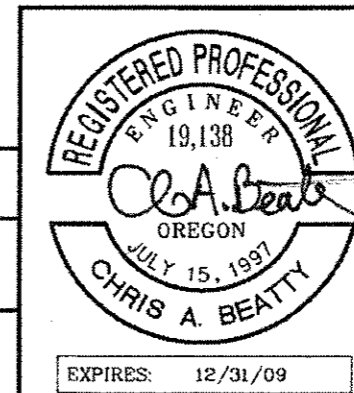

OREGON DEPARTMENT OF TRANSPORTATION

Harper Houf Peterson Righellis Inc.
ENGINEERS • PLANNERS • LANDSCAPE ARCHITECTS • SURVEYORS
 205 SE Spokane Street, Suite 200, Portland, OR 97201 phone: 503.221.1151 www.hhr.com fax: 503.221.1176

PAVING
 BAY BLVD SIDEWALK, LIGHTS & PAVING (NEWPORT) SECTION
 SW BAY BOULEVARD
 LINCOLN COUNTY

Reviewed By HHRP Team
 Designed By City Of Newport & HHRP Team
 Drafted By HHRP Team

TYPICAL ROADWAY SECTIONS

SHEET NO.	2A-2
-----------	------

P:\NEW-01\NEW01-DWG\S\SHEETS\NEW01-ODOT-2A-2-SECT.dwg

PUD VAULTS & EQUIPMENT

B#	DESC	DETAIL	SHEET	LOCATION	FR / TO	LF	#/SZ	TYPE	NEAREST UTILITY POLE
(0)				EXISTING SWITCHSTAND	0 / 1	30	3 / D3	SCHED 40	F08L /
(1)	200.15	200.15	2B-13	FALL ST PARKING LOT	1 / 34	70	1 / D4	SCHED 40	F08L / 37
(2)	MC	202.37	2B-17	FALL ST PARKING LOT	2/36	40	1/D4	SCHED 40	F08L / 8
(3)	MC	202.37	2B-17	FALL ST RT	3 / 5	110	1 / D4	SCHED 40	F08L / 8
(5)	SC	202.38	2B-17	BAY BLVD RIGHT	N/A	N/A	N/A	SCHED 40	F08L / 7
(7)	SC	202.38	2B-17	BAY BLVD RIGHT	7 / 9	100	1 / D4	SCHED 40	F08L / 15
(8)	MC	202.37	2B-17	BAY MARKET PARKING LOT	8 / 9	80	1 / D4	SCHED 40	F08L / 59
(9)	MC	202.37	2B-17	BAY BLVD RIGHT	9 / 11	70	1 / D4	SCHED 40	F08L / 15
(10)	200.16	200.16	2B-14	ABBEY ST ROW RIGHT	10 / 12	80	1 / D4	SCHED 40	F08L / 16 ACROSS STREET
(10)					10 / 13	100	1 / D4	SCHED 40	
(10)					10 / 16	375	1 / D3	SCHED 40	F08L / 16 ACROSS STREET
(10)					10 / 11	70	1 / D3	SCHED 40	
(11)	200.16	200.16	2B-14	ABBEY ST ROW RIGHT	11 / A	280	1 / D3		
(12)	MC	202.37	2B-17	BAY BLVD LEFT	12 / 14	110	1 / D4	SCHED 40	F08L / 16
(13)	SC	202.38	2B-17	ABBEY ST BATHROOMS	N/A	N/A	N/A		F08L / 18 ACROSS STREET
(13)					13 / EL-24	13	1 / D2	SCHED 40	
(14)	MC	202.37	2B-17	BAY BLVD LEFT	N/A	N/A	N/A		F08L / 17
(15)	SC	202.38	2B-17	ABBEY ST PUB PARK/ROGUE	15 / 16	40	1 / D4	SCHED 40	F08L / 68
(16)	200.15	200.15	2B-13	ABBEY ST PUB PARK LEFT	16 / C	140	3 / D3	SCHED 40	F08L / 68
(18)	MC	202.37	2B-17	ROGUE ALE PATIO AREA	18 / 16	15	1 / D4	SCHED 40	
(21)	200.16	200.16	2B-14	CASE STREET ROW	21 / C	180	1 / D3	SCHED 40	F08L / 39
(21)					21 / 24	225	1 / D3	SCHED 40	
(21)					21 / 22	30	1 / D4	SCHED 40	
(21)					21 / 23	210	1 / D4	SCHED 40	
(21)					21 / EL-25	5	1 / D2	SCHED 40	
(22)	SC	202.38	2B-17	"GINO'S" / CASE ST	N/A	N/A	N/A		F08L / 39 ACROSS STREET
(23)	MC	202.37	2B-17	BAY BLVD RIGHT	N/A	N/A	N/A		F08L / 5
(24)	201.32	201.32	2B-14	BAY BLVD LEFT	24 / 35	70	3 / D3	SCHED 40	F08L / 5
(25)	MC	202.37	2B-17	BAY BLVD RIGHT / APOLLO'S	25 / 31	155	1 / D4	SCHED 40	F08P / 6 ACROSS STREET
(26)	MC	202.37	2B-17	BAY BLVD LEFT	26 / 32	200	1 / D4	SCHED 40	F08P / 6
(27)	MC	202.37	2B-17	BAY BLVD LEFT	27 / 32	150	1 / D4	SCHED 40	F08P / 6
(28)	MC	202.37	2B-17	BAY BLVD RIGHT / FORINASH	28 / 31	125	1 / D4	SCHED 40	F08P / 6 ACROSS STREET
(29)	MC	202.37	2B-17	BAY BLVD LEFT	29 / 31	120	1 / D4	SCHED 40	F08P / 6
(30)	MC	202.37	2B-17	BAY BLVD LEFT	30 / 31	70	1 / D4	SCHED 40	F08P / 8
(31)	200.15	200.15	2B-13	BAY ST LEFT / COAST GUARD DW	31 / 24	310	3 / D3	SCHED 40	F08P / 8
(31)					31 / EL-23	32	1 / D2	SCHED 40	
(32)	200.16	200.16	2B-14	BAY ST LEFT / COAST GUARD DW	N/A	N/A	N/A		F08P / 27
(33)	201.32	201.32	2B-14	BAY ST LEFT	33 / 31	100	3 / D3	SCHED 40	F08P / 11
					33 / E	165	3 / D3	SCHED 40	F08P / 11
					33 / EL13	300	3 / D3	SCHED 40	F08P / 11
					33 / 32	110	1 / D3	SCHED 40	F08P / 11
(34)	MC	202.37	2B-17	FALL STREET PARKING LOT	34 / 2	40	1 / D4	SCHED 40	F08L / 8
(35)	SC	202.38	2B-17	APOLLO'S PARKING LOT	N/A	N/A	N/A	SCHED 40	F08P / 11
(36)	MC	202.37	2B-17	FALL STREET PARKING LOT	N/A	N/A	N/A		F08L / 8
(A)				BAY BLVD LEFT/EXISTING VAULT	A / 16	510	2 / D3	SCHED 40	F08L /
(B)				BAY BLVD LEFT/EXISTING TRANS	N/A	N/A	N/A		F08L /
(C)				BAY BLVD LEFT/EXISTING VAULT	C / EL12	150	3 / D3	SCHED 40	F08L / 15
(C)					C / 24	220	2 / D3	SCHED 40	F08L / 15
(D)				EXISTING TRANSFORMER	D / 24	N/A	N/A	N/A	SEE NOTE ON PLANS
(E)				EXISTING UTILITY POLE	N/A	N/A	N/A	N/A	F08L / A1261
(I)				EXISTING UTILITY BOX	I / 3	45	1 / D4	SCHED 40	F08L / 93

CHARTER VAULTS & EQUIPMENT

B#	DESC	DETAIL	SHEET	LOCATION	FR / TO	LF	#/SZ	TYPE	NEAREST UTILITY POLE
①	TAP VAULT	C-1	2B-17	FALL ST PLANTER	1 / 2	48	1 / 2"	SCHED 40	F08L / 8
②	TAP VAULT	C-1	2B-17	FALL ST RIGHT	2 / 20	47	1 / 2"	SCHED 40	F08L / 15
③	TAP VAULT	C-1	2B-17	BAY BLVD LEFT	3 / 5	270	1 / 2"	SCHED 40	F08L / 14
④	TAP VAULT	C-1	2B-17	BAY BLVD RIGHT	4 / 5	156	1 / 2"	SCHED 40	F08L / 15
⑤	AMP PED	C-2	2B-17	ABBEY ST ROW RIGHT	5 / 6	123	1 / 2"	SCHED 40	F08L / 17 ACROSS STREET
⑤					5 / 16	895	1 / 2"	SCHED 40	COND TO UPOLE BAY ST
⑤					5 / 20	59	1 / 2"	SCHED 40	
⑥	TAP VAULT	C-1	2B-17	BAY BLVD LEFT	6 / 7	160	1 / 2"	SCHED 40	F08L / 17
⑦	TAP VAULT	C-1	2B-17	BAY BLVD LEFT	7 / 9	156	1 / 2"	SCHED 40	F08L / 19
⑧	TV PED	C-3	2B-17	ABBEY ST PUB PARK/ROGUE	8 / 9	139	1 / 2"	SCHED 40	F08L / 19 ACROSS STREET
⑨	TAP VAULT	C-1	2B-17	BAY BLVD LEFT	9 / 11	107	1 / 2"	SCHED 40	F08L / 62
⑩	AMP PED	C-2	2B-17	CASE STREET ROW	10 / 11	107	2 / 2"	SCHED 40	F08P / 22 ACROSS STREET
⑩					10 / EL7	232	1 / 2"	SCHED 40	
⑪	TAP VAULT	C-1	2B-17	BAY BLVD LEFT	11 / 12	143	1 / 2"	SCHED 40	F08P / 22 ACROSS STREET
⑫	TAP VAULT	C-1	2B-17	BAY BLVD LEFT	12 / 13	191	1 / 2"	SCHED 40	F08P / 5
⑬	TAP VAULT	C-1	2B-17	BAY BLVD RIGHT	13 / 15	90	1 / 2"	SCHED 40	F08P / 6 ACROSS STREET
⑭	TAP VAULT	C-1	2B-17	BAY BLVD LEFT	14 / 16	136	1 / 2"	SCHED 40	F08P / 6
⑮	TAP VAULT	C-1	2B-17	BAY BLVD LEFT	15 / 16	84	1 / 2"	SCHED 40	F08P / 8
⑯	TAP VAULT	C-1	2B-17	BAY ST LEFT	16 / 17	92	3 / 2"	SCHED 40	F08P / 11
⑰	TAP VAULT	C-1	2B-17	BAY ST LEFT	17 / 18	150	3 / 2"	SCHED 40	F08P / 11
⑱	AMP PED	C-2	2B-17	BASE OF HILL / TOP BAY ST	18 / E*	6	2 / 2"	SCHED 40	
⑲					18 / F*	122	2 / 2"	SCHED 40	
⑲	TAP VAULT	C-1	2B-17	NATERLIN DR RIGHT	19 / 18	78	2 / 2"	SCHED 40	POLE 900
⑳	TAP VAULT	C-1	2B-17	BAY BLVD LEFT	20 / 3	93	1 / 2"	SCHED 40	
㉑				EXISTING UTILITY POLE	N/A	N/A	N/A		13TH STREET RIGHT

UP = UTILITY POLE
 *SWEEP CHARTER CONDUITS UP 7" FROM UTILITY POLE
 CHARTER WILL SUPPLY CONDUIT, BOXES, VAULTS, ETC.

COAST COM BOXES

B#	DESC	DETAIL	SHEET	LOCATION	FR / TO	LF	#/SZ	TYPE	NEAREST UTILITY POLE
1	L-Series	1730-18	2B-26	FALL ST PLANTER	1 / 2	352	1 / 2"	SCHED 40	F08L / 8
2	L-Series	1730-18	2B-26	FALL ST RIGHT	2 / 3	300	1 / 2"	SCHED 40	F08L / 15
3	L-Series	1730-18	2B-26	BAY BLVD LEFT	3 / 4	260	1 / 2"	SCHED 40	F08L / 14
4	L-Series	1730-18	2B-26	BAY BLVD RIGHT	4 / 5	240	1 / 2"	SCHED 40	F08L / 15
5	L-Series	1730-18	2B-26	ABBEY ST ROW RIGHT	5 / 6	282	1 / 2"	SCHED 40	F08L / 17 ACROSS STREET
6	L-Series	1730-18	2B-26	BAY BLVD LEFT	6 / 7	288	1 / 2"	SCHED 40	F08L / 17
7	L-Series	1730-18	2B-26						

COAST COMM WILL SUPPLY CONDUIT, BOXES, VAULTS, ETC.

INSTALL PUD BOXES AS STAKED BY CLPUD ENGINEER IN COORDINATION WITH ON SIGHT PUD CONTACT.
 PUD WILL SUPPLY CONDUIT, BOXES, VAULTS, ETC.



Harper Houf Peterson Righellis Inc.
 ENGINEERS • PLANNERS • LANDSCAPE ARCHITECTS • SURVEYORS
 205 SE Spokane Street, Suite 200 Portland, OR 97202 phone: 503.221.1151 www.hhrp.com fax: 503.221.1171

PAVING
 BAY BLVD SIDEWALK, LIGHTS & PAVING (NEWPORT) SECTION
 SW BAY BOULEVARD
 LINCOLN COUNTY

Reviewed By HHRP Team
 Designed By City Of Newport & HHRP Team
 Drafted By HHRP Team

SHEET NO.
 2B-23

DETAILS



EXPIRES: 12/31/2010

REVISIONS	
①	REVISED 7-8-2009 CONDUIT LENGTHS & ADDED CONDUITS/VAULTS
②	

QWEST VAULTS & EQUIPMENT

B#	DESC	DETAIL	SHEET	LOCATION	FR / TO	LF	#/SZ	TYPE**	NEAREST UTILITY POLE
△	25-TA HH		2B-15	FALL ST PLANTER	1 / 3	176	1 / 4"	SCHED 40	F08L / 37
△					1 / H	154	1 / 4"	SCHED 40	
△					1 / EL1	51	1 / 2"	SCHED 40	
△					1 / EL2	60	1 / 2"	SCHED 40	
△	3660		2B-13	BAY BLVD RIGHT	3 / 4	53	1 / 4"	SCHED 40	F08L / 15
△					3 / 5	332	1 / 4"	SCHED 40	
△					3 / EL3	42	1 / 2"	SCHED 40	
△					3 / EL4	70	1 / 2"	SCHED 40	
△					3 / EL17	37	1 / 2"	SCHED 40	
△					3 / EL18	21	1 / 2"	SCHED 40	
△					3 / EL19	3	1 / 2"	SCHED 40	
△	25-TA HH		2B-15	BAY BLVD LEFT	N/A	N/A	N/A		F08L / 14
△					4 / EL15	90	1 / 2"	SCHED 40	
△					4 / EL16	50	1 / 2"	SCHED 40	
△	25-TA HH		2B-15	ABBEY STREET BATHROOMS	5 / 6	50	1 / 4"	SCHED 40	F08L / 7
△					5 / 7	248	1 / 4"	SCHED 40	
△	444-LA		2B-16	BAY BLVD LEFT	6 / EL5	154	1 / 2"	SCHED 40	F08L / 15
△					6 / EL21	10	1 / 2"	SCHED 40	F08L / 15
△					6 / EL22	10	1 / 2"	SCHED 40	F08L / 15
△	12X48 PED	NO DETAIL		ABBEY ST PUB PARK/ROGUE	7 / 8	264	1 / 4"	SCHED 40	F08L / 15
△					7 / 9	117	1 / 4"	SCHED 40	F08L / 15
△	12X48 PED	NO DETAIL		CASE STREET ROW	8 / 10	210	1 / 4"	SCHED 40	F08L / 59
△					8 / 11	341	1 / 4"	SCHED 40	
△					8 / EL6	17	1 / 4"	SCHED 40	
△					8 / EL7	205	1 / 4"	SCHED 40	
△	504-LA		2B-18	BAY BLVD LEFT	N/A	N/A	N/A		F08L / 16 ACROSS STREET
△	444-LA		2B-16	BAY BLVD LEFT	N/A	N/A	N/A		F08L / 16 ACROSS STREET
△	3660		2B-13	BAY BLVD RIGHT	11 / 12	50	1 / 4"	SCHED 40	F08L / 16 ACROSS STREET
△					11 / 14	162	1 / 4"	SCHED 40	
△					11 / EL14	144	1 / 2"		
△					11 / EL8	73	1 / 2"	SCHED 40	F08L / 17
△					11 / EL9	77	1 / 2"	SCHED 40	
△	25-TA HH		2B-15	BAY BLVD LEFT	N/A	N/A	N/A		F08L / 16
△	25-TA HH		2B-15	BAY BLVD LEFT	N/A	N/A	N/A		F08L / 18 ACROSS STREET
△	12X48 PED	NO DETAIL		BAY ST LEFT	14 / EL10	37	1 / 2"	SCHED 40	
△					14 / 11	162	1 / 4"	SCHED 40	
△					14 / 13	123	1 / 4"	SCHED 40	
△					14 / 15	237	1 / 4"	SCHED 40	
△	444-LA		2B-16	NATERLIN DRIVE	15 / F	197	1 / 4"	SCHED 40	POLE 900
△				EXISTING VAULT	G / 1				OUTSIDE PROJECT: QWEST
△				EXISTING UTILITY POLE	N/A	N/A	N/A		BAY BLVD EAST

** QWEST PREFERS GRAY SCHEDULE 40 CONDUIT; THEY WILL ACCEPT WHITE.
 * QWEST NEEDS A CONTINUOUS PATHWAY TO EACH SERVICE ENTRANCE. LAY CONDUIT TO SERVICE ENTRANCE.
 THE 504 MUST BE PLACED DEEP ENOUGH TO ALLOW QWEST TO PLACE THEIR OWN FRAME AND COVER—OR ORDER THE 504'S WITH THE STANDARD QWEST FRAME AND COVER. QWEST COVERS ARE HARD TO PUT ON, UNLESS THIS IS PLANNED OUT FROM THE "GET-GO" THE FRAME/COVER AND THE 504 SHOULD BE ONSITE AND PLACED TOGETHER.
 PULL STRINGS IN CONDUITS
 CONTRACTOR TO SUPPLY AND INSTALL ALL CONDUIT, BOXES AND VAULTS. QWEST TO PROVIDE PEDESTALS FOR CONTRACTOR INSTALLATION.

REVISIONS	
△ 1	REVISED 7-8-2009 CONDUIT LENGTHS
△ 2	

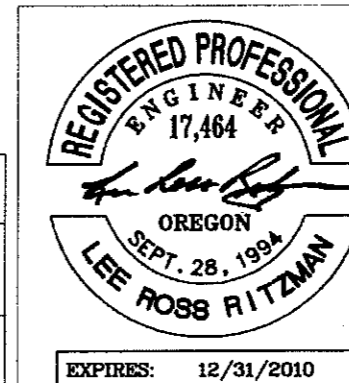

OREGON DEPARTMENT OF TRANSPORTATION

Harper Houf Peterson Righellis Inc.
 ENGINEERS • PLANNERS • LANDSCAPE ARCHITECTS • SURVEYORS
 205 SE Spokane Street, Suite 200, Portland, OR 97202, phone: 503.221.1131 www.hhrp.com fax: 503.221.1171

PAVING
 BAY BLVD SIDEWALK, LIGHTS & PAVING (NEWPORT) SECTION
 SW BAY BOULEVARD
 LINCOLN COUNTY

Reviewed By HHRP Team
 Designed By City Of Newport & HHRP Team
 Drafted By HHRP Team

DETAILS SHEET NO. 2B-24

C:\Melissa\Bay Blvd Utility Upgrade\HHRP Files\NEW01-ODOT-2B-24-DETAILS.dwg

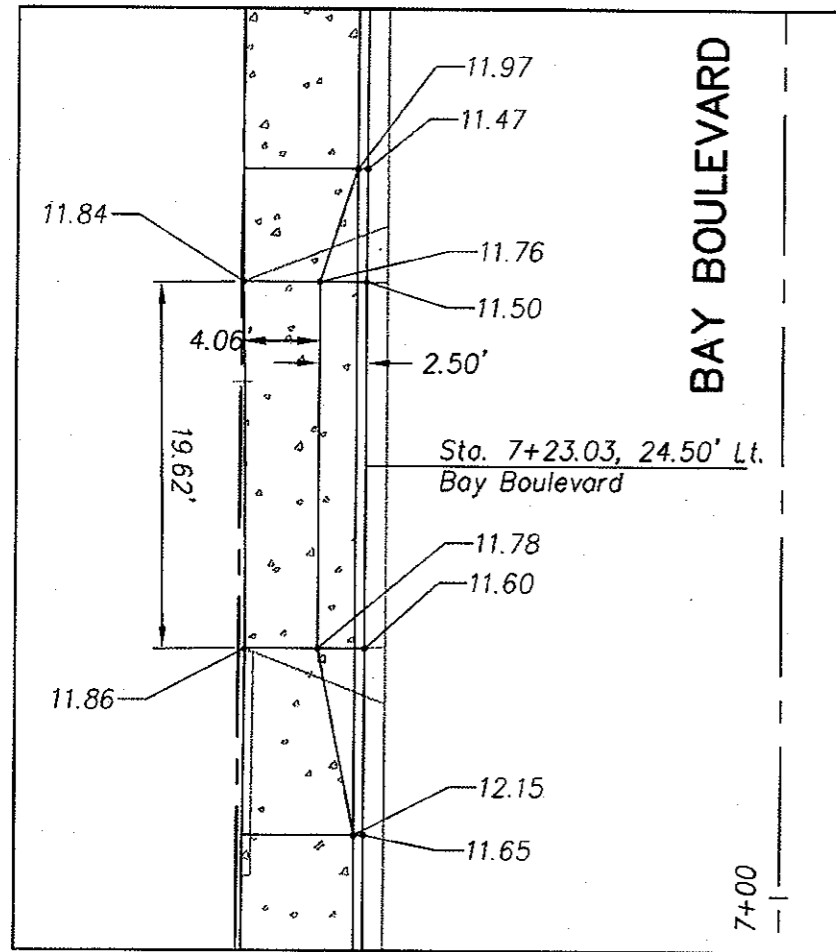

Driveway #7

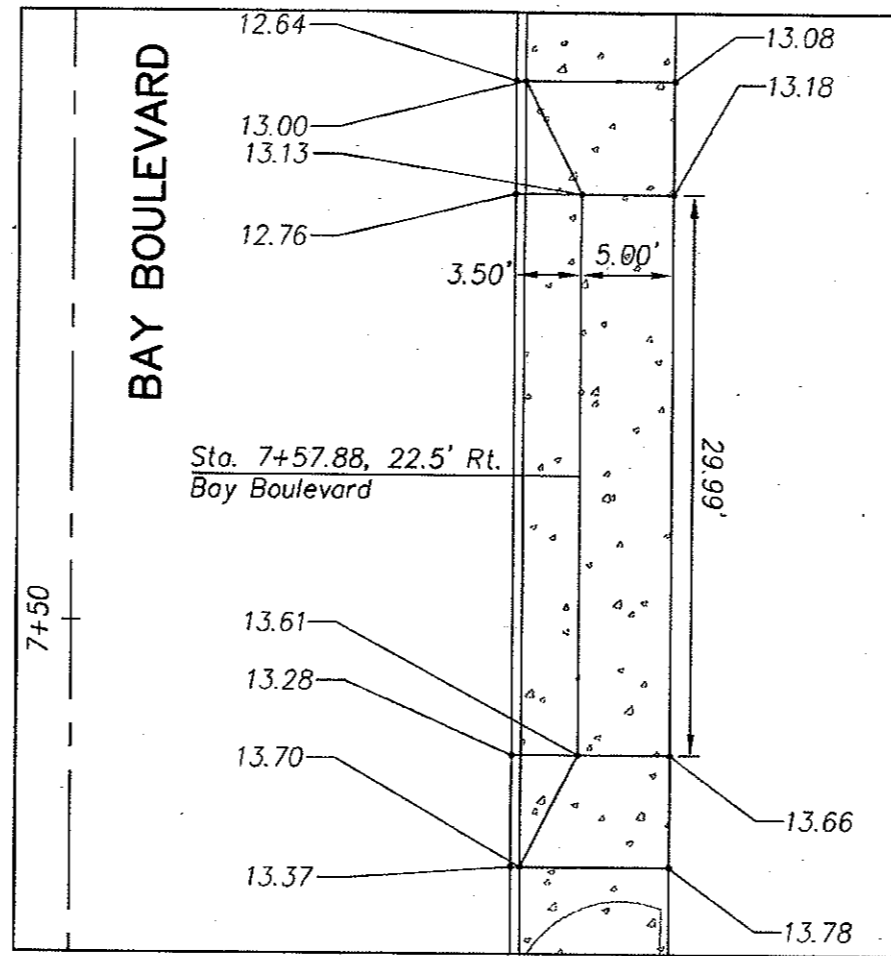
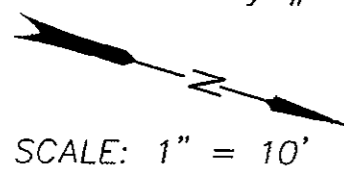

Driveway #8 1

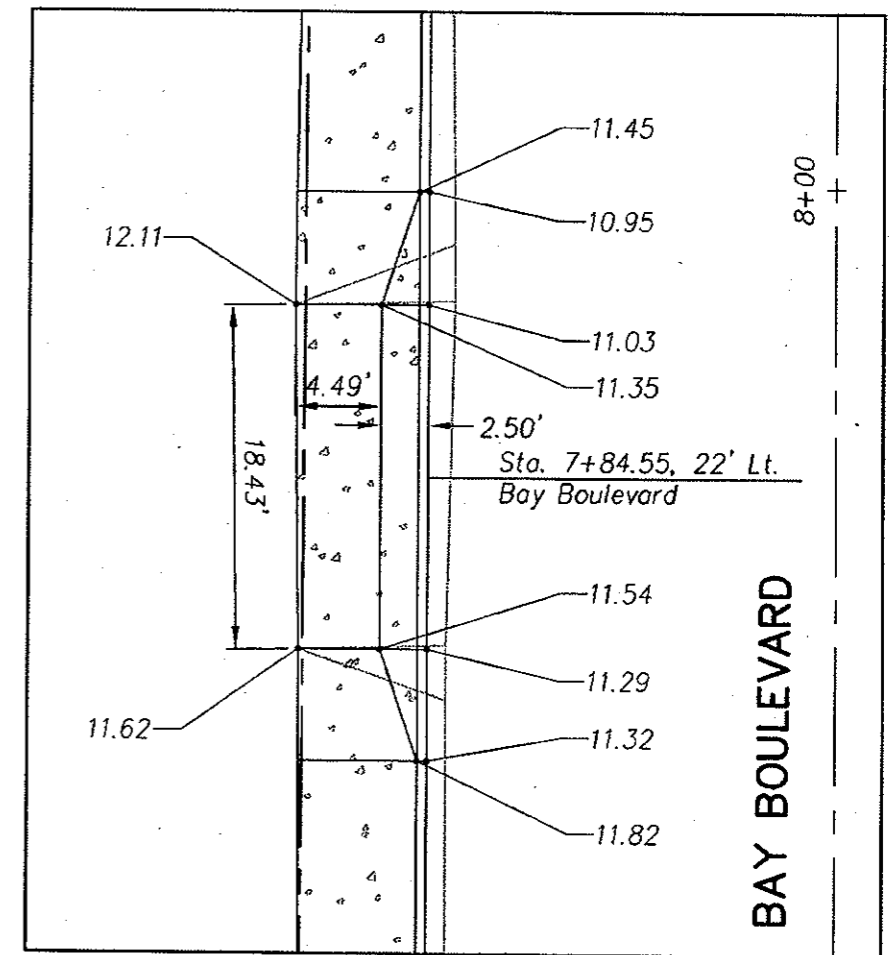
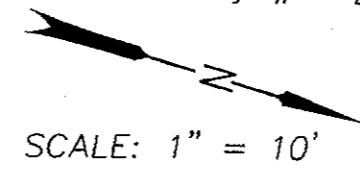

Driveway #9

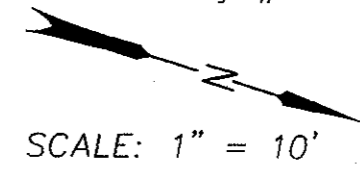

REVISIONS	
1	REVISED 7-8-2009 REVISED GRADES FOR DRIVEWAY #8
2	

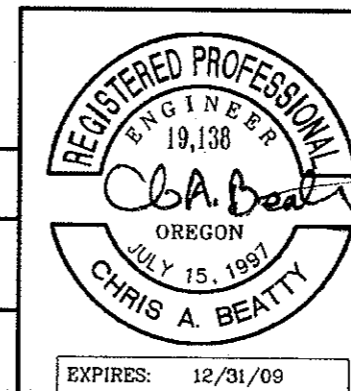

OREGON DEPARTMENT OF TRANSPORTATION	
Harper Houf Peterson Righellis Inc. <small>ENGINEERS • PLANNERS • LANDSCAPE ARCHITECTS • SURVEYORS</small> <small>205 SE Spokane Street, Suite 200 Portland, OR 97202 phone 503.224.1131 www.hhpr.com fax 503.224.1171</small>	
PAVING BAY BLVD SIDEWALK, LIGHTS & PAVING (NEWPORT) SECTION SW BAY BOULEVARD LINCOLN COUNTY	
Reviewed By HHPR Team Designed By City Of Newport & HHPR Team Drafted By HHPR Team	
DRIVEWAY & CURB EXTENSION DETAILS	SHEET NO. 2B-34

C:\Melissa\Bay Blvd Utility Upgrade\HPR Files\NEW01-ODOT-2E-2-MISC UT.dwg

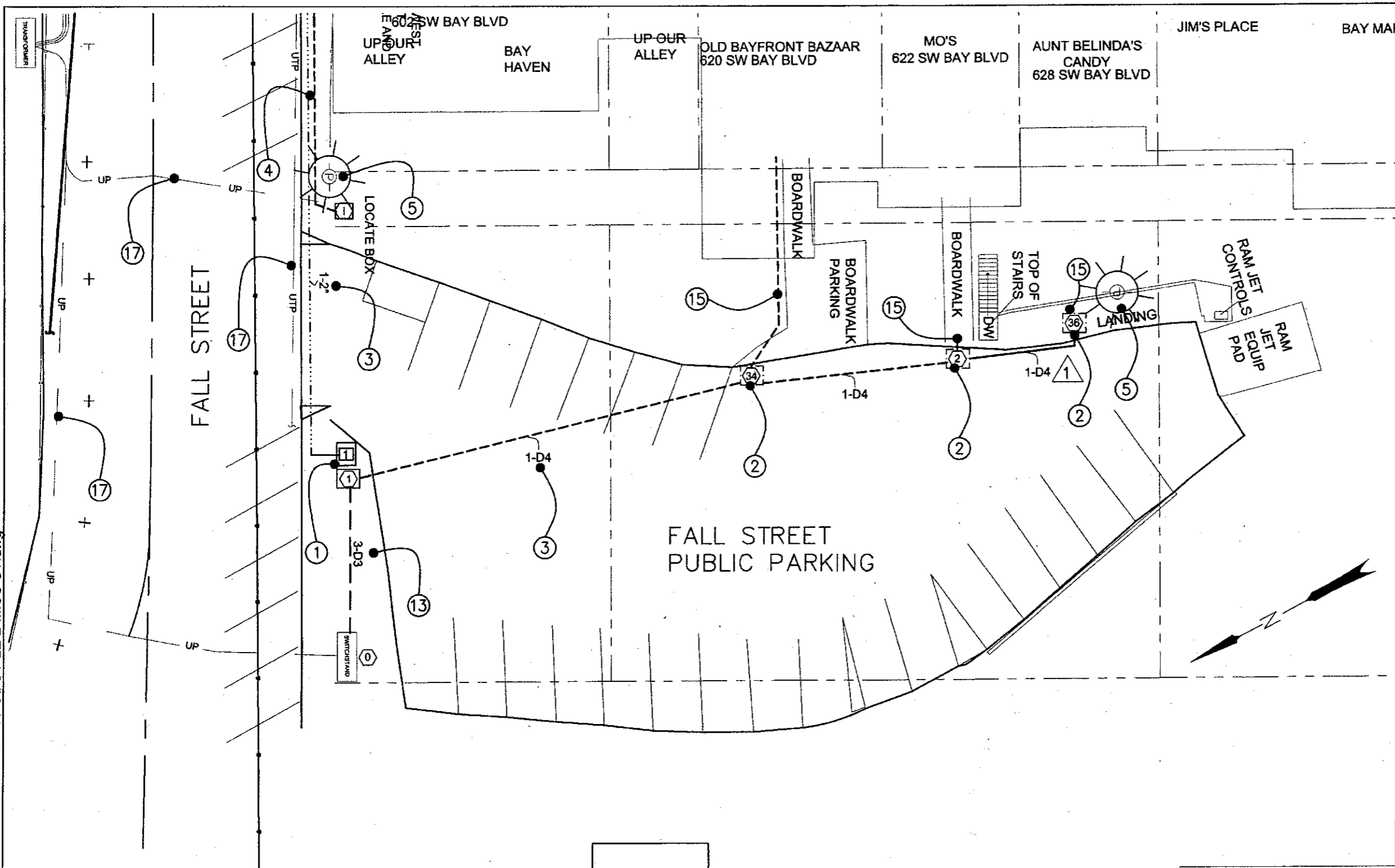

General Notes: 42V-144
 The Locations Of The Joint Trenches, Utility Vaults, And Pedestals Shown On These Plans Are Schematic And Are For Informational Purposes Only. Locations May Vary In Field. To Avoid Existing Utilities And Other Physical Features, Not All Trenching Needed For Conduit, Utility Vault, And Pedestal Installation Are Represented On These Schematic Drawings. See Sheets 2B-13 Thru 2B-26 For Details.

Electrical Design Is A Conduit/Vault Plan Only. Installation Of Power And Communication Conductors, Transformers, Switches, Etc. Shall Be Completed By The Appropriate Utility Agency.

Adjust All Existing And Proposed Vault Lids To Finish Grade.

Curb And Sidewalk Restoration Included In Trench Restoration Bid Item Except For Lower-South Side Installations.

Contractor Shall Coordinate His Work Schedule With The Utility Agencies.

- Construction Notes:**
- ① Install Junction Boxes. See Sheet 2B-22, Detail 6 For Positioning Of Transformers And Utility Boxes.
 - ② Install Utility Junction Boxes. Field Fit Locations Per City Engineer And Utility Coordinator.
 - ③ Number And Size Of Conduits Varies By Utility. See Sheet 2B-23 And 2B-24 For Details.
 - ④ Conduit Runs Under Sidewalk Shown Schematically.
 - ⑤ Existing Utility Pole Remains.
 - ⑥ See website: www.hhpr.com/newport For Further Information About Conduit Runs And Layout.
 - ⑬ Parallel Runs Of 3-D3 Must Be Kept Separate In The Trench; CLPUD Recommends Tie-Wrapping Each 3-D3 Bundle Every 20 Feet.
 - ⑮ Service Drop. Connected By Others.
 - ⑰ Save Existing Underground Utility.

LEGEND

-----	Proposed Coast Comm, Inc	□	Proposed Coast Comm, Inc Box
-----	Proposed Qwest	△	Proposed Qwest Box
-----	Proposed Charter Communications	○	Proposed Charter Communications Box
-----	Proposed PUD Primary Power	□	Proposed PUD Box
-----	Proposed PUD Secondary Power		
-----	Proposed City Of Newport Street Lights		
-----	Proposed Street Light Locations		

REVISIONS	
①	REVISED 7-8-2009 ADDED VAULT 36 & CONDUIT FROM VAULT 2
②	

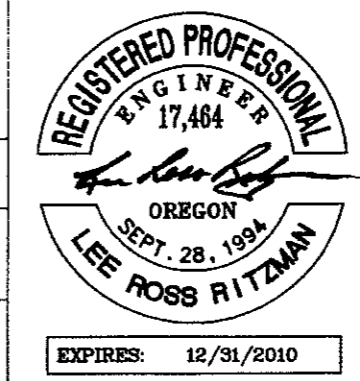

OREGON DEPARTMENT OF TRANSPORTATION

Harper Houf Peterson Righellis Inc.
 ENGINEERS • PLANNERS • LANDSCAPE ARCHITECTS • SURVEYORS
 705 SE Spokane Street, Suite 200 Portland, OR 97202 phone: 503.221.1131 www.hhpr.com fax: 503.221.1171

PAVING
BAY BLVD SIDEWALK, LIGHTS & PAVING (NEWPORT) SECTION
 SW BAY BOULEVARD
 LINCOLN COUNTY

Reviewed By HHPR Team
 Designed By City Of Newport & HHPR Team
 Drafted By HHPR Team

MISC. UTILITIES

SHEET NO. 2E-2

C:\Missal\Bay Blvd Utility Upgrade\HPR Files\NEW01-ODOT-2E-4-MISC UT.dwg

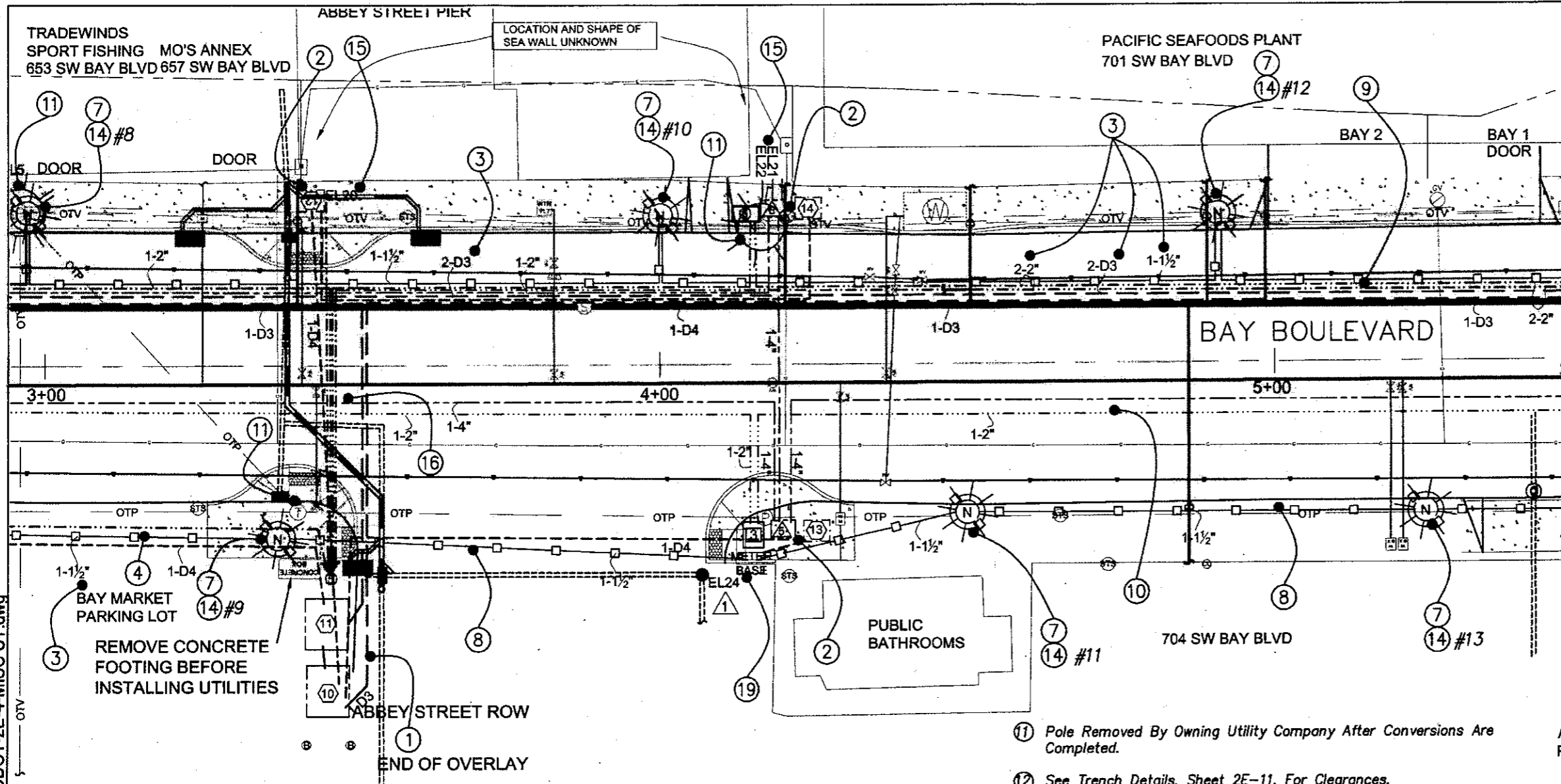

General Notes: 42V-144
 The Locations Of The Joint Trenches, Utility Vaults, And Pedestals Shown On These Plans Are Schematic And Are For Informational Purposes Only. Locations May Vary In Field. To Avoid Existing Utilities And Other Physical Features, Not All Trenching Needed For Conduit, Utility Vault, And Pedestal Installation Are Represented On These Schematic Drawings. See Sheets 2B-13 Thru 2B-26 For Details.

Electrical Design Is A Conduit/Vault Plan Only. Installation Of Power And Communication Conductors, Transformers, Switches, Etc. Shall Be Completed By The Appropriate Utility Agency.

Adjust All Existing And Prop. Vault Lids To Finish Grade.

Curb And Sidewalk Restoration Included In Trench Restoration Bid Item Except For Lower-South Side Installations.

Contractor Shall Coordinate His Work Schedule With The Utility Agencies.

- Construction Notes:**
- ① Install Junction Boxes. See Sheet 2B-21, Detail 4 For Positioning Of Transformers And Utility Boxes.
 - ② Install Utility Junction Boxes. Field Fit Locations Per City Engineer And Utility Coordinator.
 - ③ Number And Size Of Conduits Varies By Utility. See Sheet 2B-23 And 2B-24 For Details.
 - ④ Conduit Runs Under Sidewalk Shown Schematically. See Sheet 2E-11 For Details.
 - ⑥ See website: www.hhpr.com/newport For Further Information About Conduit Runs And Layout.
 - ⑦ Install Street Light Base 2' From Face Of Curb. Field Fit Per City Engineer. See Sheet 2B-28 For Details.
 - ⑧ Install Conduit For Street Lights.
 - ⑨ Conduit Routes Are Shown Schematically. Conduits To Be Placed In Utility Trench. See Electrical Sheet 2E-11 For Details.
 - ⑩ Conduit Routes Are Shown Schematically. Place Conduits In Water Trench. See Electrical Sheets 2E-11 For Details.

Lateral #	Street Sta.	Offset	Pole Ht.	Dist. From FC
8	2+97	Rt.	23' 1"	2.0'
9	3+38	Rt.	23' 1"	2.0'
10	4+00	Lt.	23' 1"	2.0'
11	4+50	Rt.	23' 1"	2.0'
12	4+91	Lt.	23' 1"	2.0'
13	5+24	Rt.	23' 1"	2.0'

LEGEND

- Proposed Coast Comm, Inc
- Proposed Qwest
- Proposed Charter Communications
- Proposed PUD Primary Power
- Proposed PUD Secondary Power
- Proposed City Of Newport Street Lights
- Proposed Street Light Locations
- Proposed Coast Comm, Inc Box
- △ Proposed Qwest Box
- Proposed Charter Communications Box
- Proposed PUD Box
- OTV Overhead Television Cable
- OP Overhead Power Cable
- OTP Overhead Telephone Cable

- ⑪ Pole Removed By Owning Utility Company After Conversions Are Completed.
- ⑫ See Trench Details, Sheet 2E-11, For Clearances.
- ⑬ Install Street Light Pole, Shroud, Banner Arms And Luminaire. See Sheets 2B-28 Thru 2B-30 For Details. Wiring By Others.
- ⑮ Service Drop. Connected By Others.
- ⑯ See Sheet 2E-11 For Crossing Details And Conduit Clearances.
- ⑰ Meter Base Detail Shown For Illustrative Purposes Only. See Sheet 2b-17 For Details.



REVISIONS	
①	REVISED 7-8-2009 ADDED EL24 AND CONDUIT FROM VAULT 13
②	



OREGON DEPARTMENT OF TRANSPORTATION

Harper Houf Peterson Righellis Inc.
 ENGINEERS • PLANNERS • LANDSCAPE ARCHITECTS • SURVEYORS
 203 SB Spokane Street, Suite 200 Portland, OR 97202 phone: 503.221.1131 www.hhpr.com fax: 503.221.1171

PAVING
BAY BLVD SIDEWALK, LIGHTS & PAVING (NEWPORT) SECTION
 SW BAY BOULEVARD
 LINCOLN COUNTY

Reviewed By HPR Team
 Designed By City Of Newport & HPR Team
 Drafted By HPR Team

MISC. UTILITIES

SHEET NO. 2E-4

General Notes:

The Locations Of The Joint Trenches, Utility Vaults, And Pedestals Shown On These Plans Are Schematic And Are For Informational Purposes Only. Locations May Vary In Field. To Avoid Existing Utilities And Other Physical Features, Not All Trenching Needed For Conduit, Utility Vault, And Pedestal Installation Are Represented On These Schematic Drawings. See Sheets 2B-13 Thru 2B-26 For Details.

Electrical Design Is A Conduit/Vault Plan Only. Installation Of Power And Communication Conductors, Transformers, Switches, Etc. Shall Be Completed By The Appropriate Utility Agency.

Adjust All Existing And Proposed Vault Lids To Finish Grade.

Curb And Sidewalk Restoration Included In Trench Restoration Bid Item Except For Lower-South Side Installations.

Contractor Shall Coordinate His Work Schedule With The Utility Agencies.

Construction Notes:

- ① Install Junction Boxes. See Sheet 2B-20, Detail 2, And Sheet 2B-21, Detail 3, For Positioning Of Transformers And Utility Boxes.
- ② Install Utility Junction Boxes. Field Fit Locations Per City Engineer And Utility Coordinator.
- ③ Number And Size Of Conduits Varies By Utility. See Sheet 2B-23 And 2B-24 For Details.
- ⑥ See website: www.hhpr.com/newport For Further Information About Conduit Runs And Layout.
- ⑦ Install Street Light Base 2' From Face Of Curb. Field Fit Per City Engineer. See Sheet 2B-28 For Details.
- ⑧ Install Conduit For Street Lights.
- ⑨ Conduit Routes Are Shown Schematically. Conduits To Be Placed In Utility Trench. See Electrical Sheet 2E-12 For Details.
- ⑩ Conduit Routes Are Shown Schematically. Place Conduits In Water Trench. See Electrical Sheets 2E-12 For Details.
- ⑪ Pole Removed By Owning Utility Company After Conversions Are Completed.
- ⑫ See Trench Details, 2E-12, For Clearances.

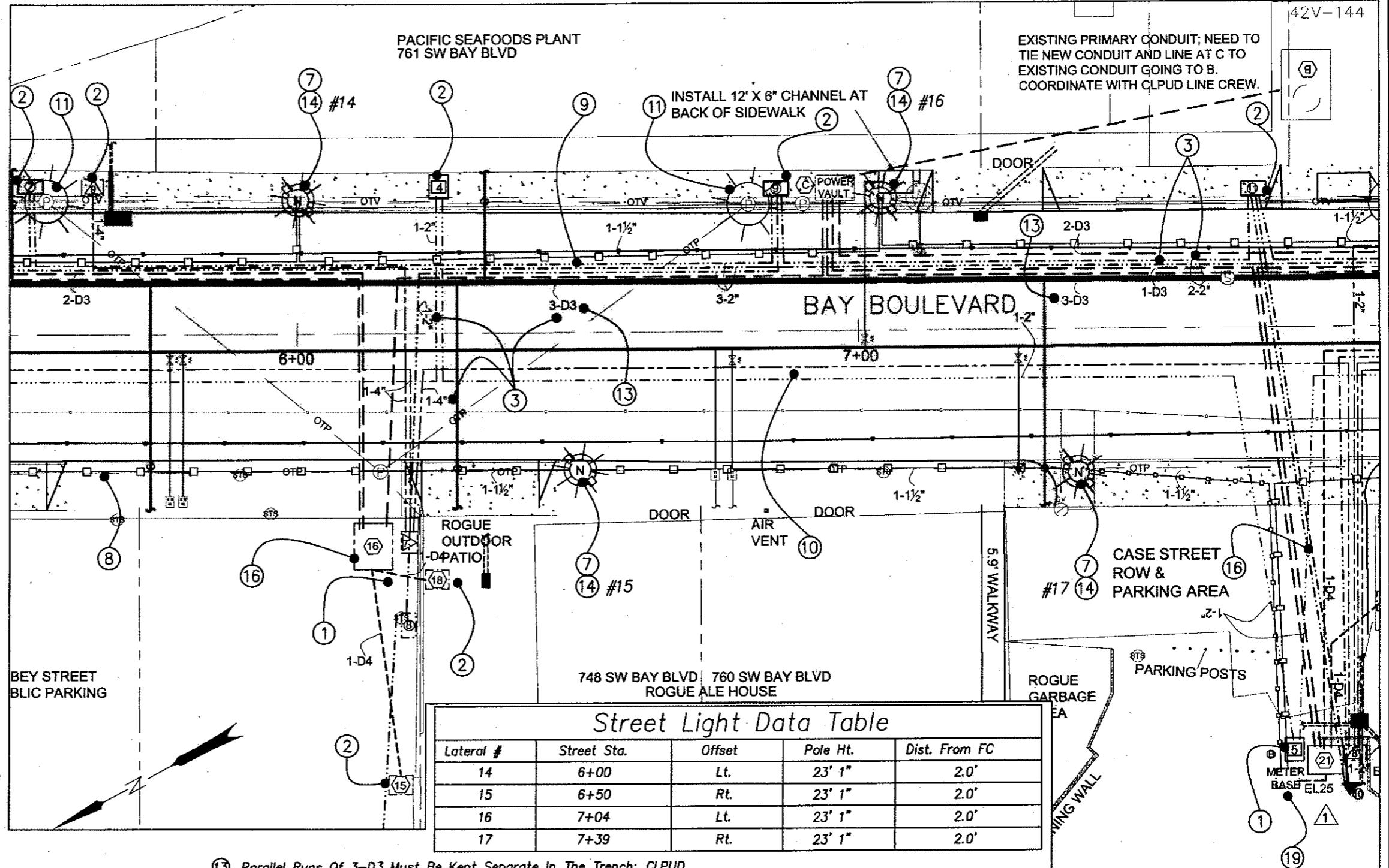

Lateral #	Street Sta.	Offset	Pole Ht.	Dist. From FC
14	6+00	Lt.	23' 1"	2.0'
15	6+50	Rt.	23' 1"	2.0'
16	7+04	Lt.	23' 1"	2.0'
17	7+39	Rt.	23' 1"	2.0'

OREGON DEPARTMENT OF TRANSPORTATION

Harper Houf Peterson Righellis Inc.
ENGINEERS • PLANNERS • LANDSCAPE ARCHITECTS • SURVEYORS
 205 SE Spokane Street, Suite 200 Portland, OR 97202 phone: 503.221.1131 www.hhpr.com fax: 503.221.1171

PAVING
BAY BLVD SIDEWALK, LIGHTS & PAVING (NEWPORT) SECTION
 SW BAY BOULEVARD
 LINCOLN COUNTY

Reviewed By HHPR Team
 Designed By City Of Newport & HHPR Team
 Drafted By HHPR Team

SHEET NO. 2E-5 **MISC. UTILITIES**

REGISTERED PROFESSIONAL ENGINEER
 17,464
Lee Robb Ritzman
 OREGON
 SEPT. 28, 1994
LEE ROBB RITZMAN
 EXPIRES: 12/31/2010

- ⑬ Parallel Runs Of 3-D3 Must Be Kept Separate In The Trench; CLPUD Recommends Tie-Wrapping Each 3-D3 Bundle Every 20 Feet.
- ⑭ Install Street Light Pole, Shroud, Banner Arms And Luminaire. See Sheets 2B-28 Thru 2B-30 For Details. Wiring By Others.
- ⑯ See Sheet 2E-12 For Crossing Details And Conduit Clearances.
- ⑰ Meter Base Detail Shown For Illustrative Purposed Only. See Sheet 2b-17 For Details.

REVISIONS	
1	REVISED 7-8-2009 ADDED EL25 AND CONDUIT FROM VAULT 21

LEGEND

- Proposed Coast Comm, Inc
- Proposed Qwest
- Proposed Charter Communications
- Proposed PUD Primary Power
- Proposed PUD Secondary Power
- Proposed City Of Newport Street Lights
- Proposed Street Light Locations
- Proposed Coast Comm, Inc Box
- △ Proposed Qwest Box
- Proposed Charter Communications Box
- Proposed PUD Box
- OTV Overhead Television Cable
- OP Overhead Power Cable
- OTP Overhead Telephone Cable

C:\Melissa\Bay Blvd Utility Upgrade\HHPR Files\NEW01-ODOT-2E-5-MISC UT.dwg

General Notes:

The Locations Of The Joint Trenches, Utility Vaults, And Pedestals Shown On These Plans Are Schematic And Are For Informational Purposes Only. Locations May Vary In Field. To Avoid Existing Utilities And Other Physical Features, Not All Trenching Needed For Conduit, Utility Vault, And Pedestal Installation Are Represented On These Schematic Drawings. See Sheets 2B-13 Thru 2B-26 For Details.

Electrical Design Is A Conduit/Vault Plan Only. Installation Of Power And Communication Conductors, Transformers, Switches, Etc. Shall Be Completed By The Appropriate Utility Agency.

Adjust All Existing And Prop. Vault Lids To Finish Grade.

Curb And Sidewalk Restoration Included In Trench Restoration Bid Item Except For Lower-South Side Installations.

Contractor Shall Coordinate His Work Schedule With The Utility Agencies.

Construction Notes:

- ① Install Junction Boxes. See Sheet 2B-20, Detail 1 For Positioning Of Transformers And Utility Boxes.
- ② Install Utility Junction Boxes. See Electrical Sheet 2B-24. Field Fit Locations Per City Engineer And Utility Coordinator.
- ③ Number And Size Of Conduits Varies By Utility. See Sheet 2B-23 And 2B-24 For Details.
- ④ Conduit Runs Under Sidewalk Shown Schematically. See Sheet 2E-15 For Details.
- ⑥ See website: www.hhpr.com/newport For Further Information About Conduit Runs And Layout.
- ⑦ Install Street Light Base 2' From Face Of Curb. Field Fit Per City Engineer. See Sheet 2B-28 For Details.
- ⑧ Install Conduit For Street Lights.
- ⑨ Conduit Routes Are Shown Schematically. Conduits To Be Placed In Utility Trench. See Electrical Sheet 2E-15 For Details.
- ⑩ Conduit Routes Are Shown Schematically. Place Conduits In Water Trench. See Electrical Sheets 2E-15 For Details.
- ⑪ Pole Removed By Owning Utility Company After Conversions Are Completed.
- ⑫ See Trench Details, Sheet 2E-16, For Clearances.

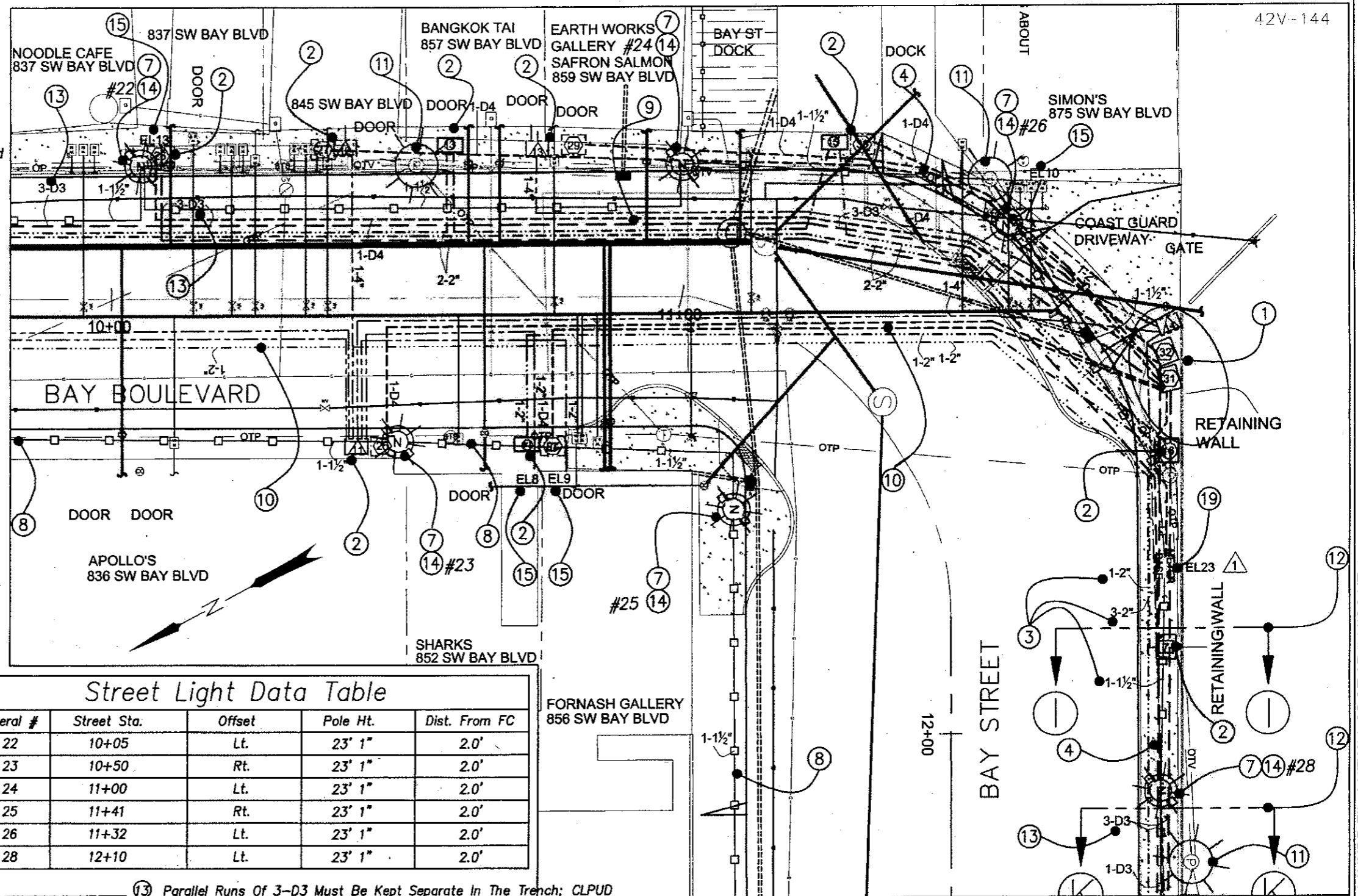

Street Light Data Table

Lateral #	Street Sta.	Offset	Pole Ht.	Dist. From FC
22	10+05	Lt.	23' 1"	2.0'
23	10+50	Rt.	23' 1"	2.0'
24	11+00	Lt.	23' 1"	2.0'
25	11+41	Rt.	23' 1"	2.0'
26	11+32	Lt.	23' 1"	2.0'
28	12+10	Lt.	23' 1"	2.0'

OREGON DEPARTMENT OF TRANSPORTATION

Harper Houf Peterson Righellis Inc.
ENGINEERS • PLANNERS • LANDSCAPE ARCHITECTS • SURVEYORS
 203 SE Spokane Street, Suite 200, Newport, OR 97122 phone: 503.221.1131 www.hhpr.com fax: 503.221.1171

PAVING
BAY BLVD SIDEWALK, LIGHTS & PAVING (NEWPORT) SECTION
 SW BAY BOULEVARD
 LINCOLN COUNTY

Reviewed By HHPR Team
 Designed By City Of Newport & HHPR Team
 Drafted By HHPR Team

SHEET NO. **2E-7**

MISC. UTILITIES

REGISTERED PROFESSIONAL ENGINEER
 17,464



 OREGON
 SEPT. 28, 1994
LEE ROSS RITZMAN
 EXPIRES: 12/31/2010

- ⑬ Parallel Runs Of 3-D3 Must Be Kept Separate In The Trench; CLPUD Recommends Tie-Wrapping Each 3-D3 Bundle Every 20 Feet.
 - ⑭ Install Street Light Pole, Shroud, Banner Arms And Luminaire. See Sheets 2B-28 Thru 2B-30 For Details. Wiring By Others.
 - ⑮ Service Drop. Connected By Others.
 - ⑰ Meter Base Detail Shown For Illustrative Purposes Only. See Sheet 2B-17 For Details.
- REVISIONS**
- | | |
|---|--|
| ① | REVISED 7-8-2009
ADDED EL23 AND CONDUIT FROM VAULT 31 |
|---|--|

LEGEND

-----	Proposed Coast Comm, Inc	□	Proposed Coast Comm, Inc Box
-----	Proposed Qwest	△	Proposed Qwest Box
-----	Proposed Charter Communications	○	Proposed Charter Communications Box
-----	Proposed PUD Primary Power	◻	Proposed PUD Box
-----	Proposed PUD Secondary Power	OTV	Overhead Television Cable
-----	Proposed City Of Newport Street Lights	OP	Overhead Power Cable
-----	Proposed Street Light Locations	OTP	Overhead Telephone Cable

CONSTRUCTION NOTES

- ① Construct 6" Thick Concrete Sidewalk at All Side Streets (Per Std. Dwg. RD720)
- ② Construct Commercial Driveway (Per Std. Dwg. RD750)
- ③ Depress Sidewalk, Curb and Gutter at all Driveways and Ramps (Per Std. Dwg. RD750)
- ④ Left Blank Intentionally 
- ⑤ Match New Curb to Existing Curb.
- ⑥ Match New Sidewalk to Existing Sidewalk.
- ⑦ Remove Existing Concrete Curb, Sidewalk, Driveway Apron or Concrete Pad.
- ⑧ Protect Existing Concrete Curb, Sidewalk or Driveway.
- ⑨ Construct Concrete Curb and 18" Gutter (Per Std. Dwg. RD700)
- ⑩ Remove Existing A.C. Pavement Section.
- ⑪ Construct New HMA Pavement Section (For Details, See Sht. 2A).
- ⑫ Refer To Misc. Utility Plan For Underground Utility And Street Light Information.
- ⑬ Adjust Vault, Lid, or Cover to Finish Grade.
- ⑭ Construct Concrete Driveway Transition.
- ⑮ Construct Mountable Concrete Curb Per Std. Drawing RD700.
- ⑯ Match Existing Driveway At Back Of Apron.
- ⑰ Construct Parking Lot Widening With 3" of 1/2" Dense, Level 2 HMAC on 8" of Compacted 3/4" (Minus) Rock. Refer To Sheet 2B-38 For Detail. 

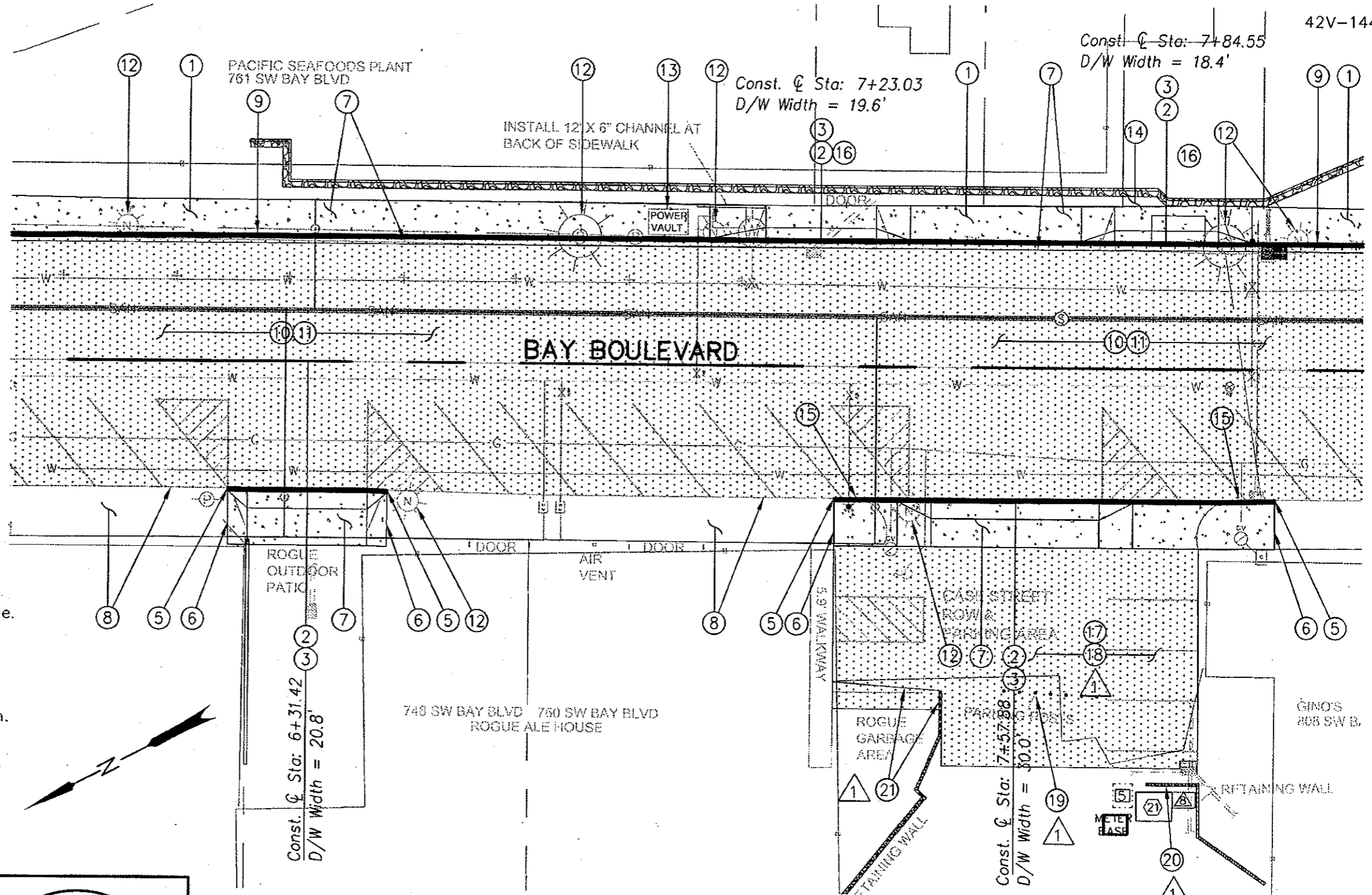

42V-144

OREGON DEPARTMENT OF TRANSPORTATION

Harper Houf Peterson Righellis Inc.
ENGINEERS • PLANNERS • LANDSCAPE ARCHITECTS • SURVEYORS
 200 SE Spokane Street, Suite 300, Portland, OR 97202 phone: 503 231 1131 www.hhpr.com 503 231 1171

PAVING
 BAY BLVD SIDEWALK, LIGHTS & PAVING (NEWPORT) SECTION
 SW BAY BOULEVARD
 LINCOLN COUNTY



Reviewed By HHPR Team
 Designed By City Of Newport & HHPR Team
 Drafted By HHPR Team

SHEET NO. 7 **RIGHT-OF-WAY AND ALIGNMENT**

REGISTERED PROFESSIONAL ENGINEER
 19,138
Chris A. Beatty
 OREGON
 JULY 15, 1997
 CHRIS A. BEATTY

EXPIRES: 12/31/09

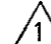
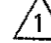
REVISIONS	
①	REVISED 7-8-2009 ADD NOTES 17, 18, 19, 20 & 21. DELETE NOTE 4
②	

-  ⑱ Remove Existing Asphalt Surfacing
-  ⑲ Remove Bollards
-  ⑳ Remove and Replace Wooden and Rockery Retaining Wall For Utility Vault Installation
-  ㉑ Screen Wall and Concrete Pad to Be Removed By Others Prior To Construction

P:\NEW-01\NEW01-DWG\SHEET\SROW-DRAWINGS\NEW01-ODOT-7-ROW.dwg

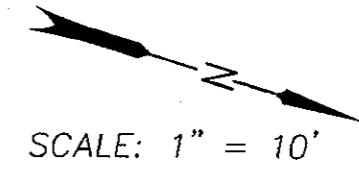
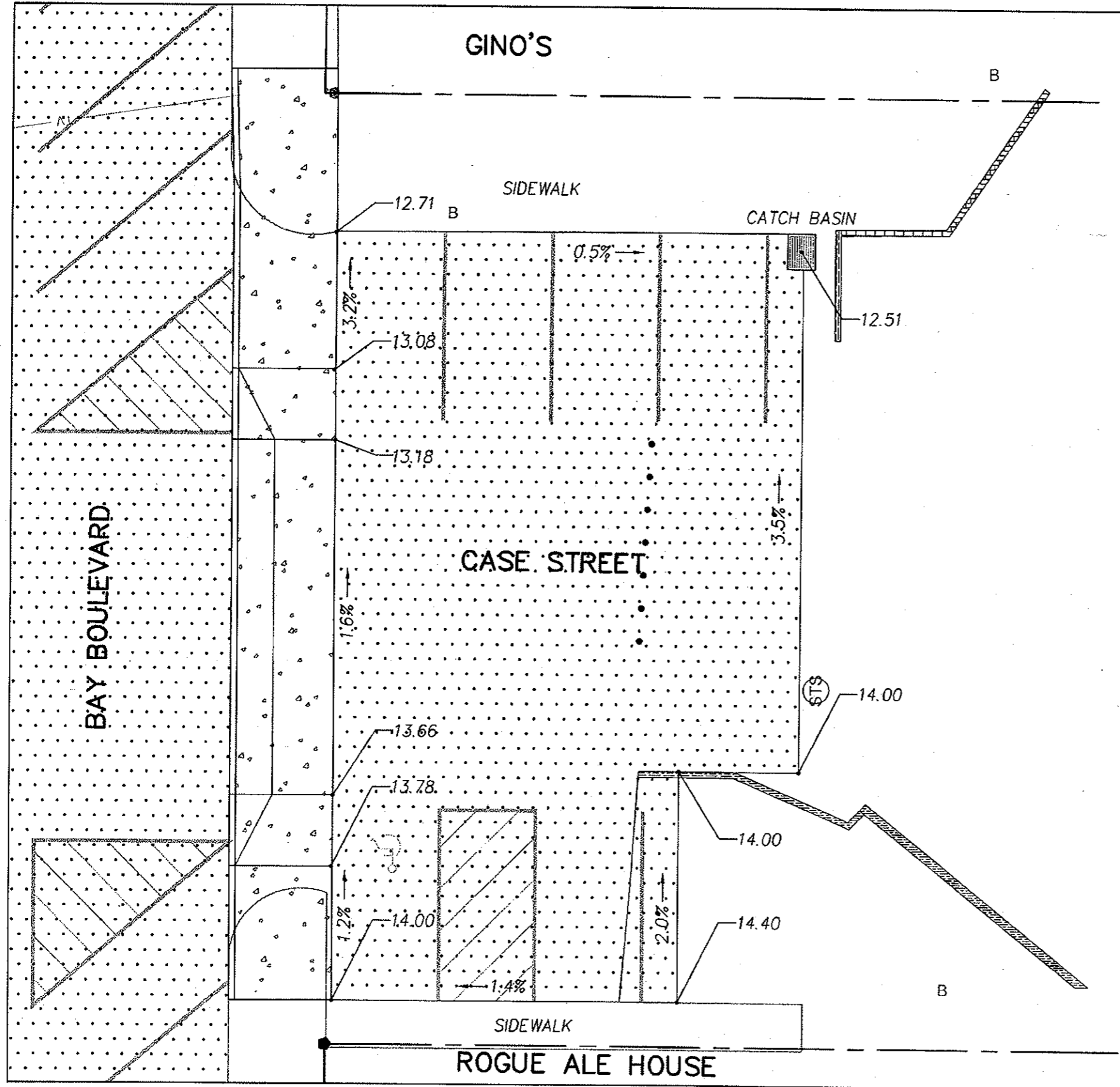

NOTES:

CONTRACTOR TO GRADE PARKING LOT SO THAT THERE IS POSITIVE DRAINAGE DRAINAGE TO THE CATCH BASIN LOCATED IN THE NORTHWEST CORNER.

REFER TO SHEET 7 FOR CASE STREET PLAN.

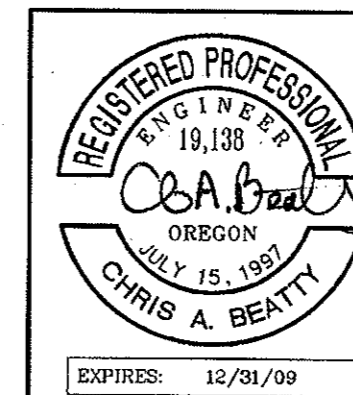

<p>OREGON DEPARTMENT OF TRANSPORTATION</p>	
<p>Harper Houf Peterson Righellis Inc. ENGINEERS • PLANNERS • LANDSCAPE ARCHITECTS • SURVEYORS 205 SE Spokane Street, Suite 2100, Portland, OR 97202 phone: 503.221.1131 www.hhr.com fax: 503.221.1171</p>	
<p>PAVING BAY BLVD SIDEWALK, LIGHTS & PAVING (NEWPORT) SECTION SW BAY BOULEVARD LINCOLN COUNTY</p>	
<p>Reviewed By HHPR Team Designed By City Of Newport & HHPR Team Drafted By HHPR Team</p>	
<p>CASE STREET PARKING LOT DETAIL</p>	<p>SHEET NO. 2B-38</p>