



Oregon

Theodore R. Kulongoski, Governor

Department of Transportation
Technical Services
Roadway Engineering Section
355 Capitol Street NE, Room 222
Salem, OR 97301-3871
Telephone 503-986-3714
FAX 503-986-3749

DATE: January 15, 2009

Addenda No. 3

TO: PLAN HOLDERS

PREPARED BY: Michael Gumbel

APPROVED BY: Chris F. Bell P.E.

SUBJECT: OR 99/238 Paving (Grants Pass) Section
Rogue River/Jacksonville Highway
Jackson County
Paving & Drainage Project
(Bids to be opened and read January 22, 2009)

The following changes are made to the Project Bid Booklet:

1. COVER PAGE - The date on the Bid Booklet cover page is replaced with January 22, 2009.
2. DESCRIPTION OF WORK page - The paragraph under TIME AND PLACE OF RECEIVING BIDS is replaced with the following:

Bids for the work described above will be opened and read at the Oregon Department of Transportation, 455 Airport Road SE, Building E, Salem, Oregon, at 9:00 a.m. on the 22nd day of January, 2009.

3. The following changes are made to the Project Bid Items:

a. Quantity changes:

| <u>Number</u> | <u>Item</u> | <u>Quantity</u> | |
|---------------|--------------------------------------------|-----------------|------------|
| | | <u>Original</u> | <u>New</u> |
| 0130 | Temporary Mulching | 1.00 | 1.66 |
| 0240 | Subgrade Geotextile | 722 | 811 |
| 0250 | 12 Inch Storm Sewer Pipe, 5 ft Depth | 2,198 | 2,128 |
| 0260 | 12 Inch Storm Sewer Pipe, 10 ft Depth | 220 | 237 |
| 0270 | 18 Inch Storm Sewer Pipe, 5 ft Depth | 1,825 | 1,726 |
| 0470 | Cold Plane Pavement Removal, 3 Inches Deep | 69,361 | 69,277 |
| 0490 | Aggregate Base | 460 | 3,590 |
| 0510 | Level 3, ½ Inch Dense HMAc | 19,010 | 19,300 |
| 0520 | PG 70-22 Asphalt in HMAc | 1,150 | 1,170 |
| 0570 | Concrete Driveways | 15,852 | 15,972 |
| 0580 | Concrete Walks | 36,585 | 27,451 |
| 0590 | Monolithic Curb and Sidewalks | 12,653 | 19,476 |

b. Added items:

| <u>Number</u> | <u>Item</u> | <u>Unit</u> | <u>Quantity</u> |
|---------------|--------------------------------------|-------------|-----------------|
| 0970 | 24 inch Storm Sewer Pipe, 5 ft Depth | Foot | 168 |

Make a copy of and use the new attached Bid Sheets. A Bid **not** including these new Bid Sheets **will be rejected as non-responsive**.

The following changes are made to the Project Special Provisions:

1. COVER PAGE - The date on the Special Provisions cover page is replaced with January 22, 2009.
2. DESCRIPTION OF WORK page - The paragraph under TIME AND PLACE OF RECEIVING BIDS is replaced with the following:

 Bids for the work described above will be opened and read at the Oregon Department of Transportation, 455 Airport Road SE, Building E, Salem, Oregon, at 9:00 a.m. on the 22nd day of January, 2009.
3. Subsection 0120.15 Examination of Work Site and Solicitation Documents; Consideration of Conditions to be Encountered - This subsection is added after subsection 00120.05:

Bidders are advised that additional funding could become available through a state or federal economic stimulus package resulting in possible changes in Plans, Specifications,

quantities or work. Such change would be processed in accordance with other subsections of the Specifications

4. Subsection 00160.30 Agency Furnished Material - This subsection is replaced with the following subsection:

00160.30 Agency-Furnished Material - The Agency will furnish the listed items at the following location:

City of Grants Pass service yard located at 650 S.E. "H" Street:

| Item | Quantity |
|---------------------------------|-----------------|
| Lighting Poles, Fixed Base | 30 Each |
| Luminaires, Lamps, and Ballasts | 30 Each |

Anchor bolts, nuts and washers are included with the Lighting Poles.

At the Project Site:

| Item | Quantity |
|-------------------------------------------------------------------------------------------------------------|-----------------|
| Poly Vehicle Signal Heads (consists of vehicle signal housings, including the doors, visor, and backboards) | 2 Each |
| Poly Pedestrian Signal Heads (consists of housings and doors) | 2 Each |

5. Subsection 01040.90(d) Plant Materials - Replace percentages for plant establishment payment as follows:

| | |
|------------------------------------------------------|-----|
| At the time of original planting..... | 60% |
| After the first plant establishment inspection..... | 10% |
| After the second plant establishment inspection..... | 10% |
| After the third plant establishment period..... | 10% |
| At completion of the establishment period..... | 10% |

The following changes are made to the Project Plans:

1. Plan sheets 2, 2A-3, 2A-6, 2A-8, 2A-9, 2B, 2D, 2D-2, 4B, 5B, 5C, 7A, 7B, 7C and 8 are replaced with revised plan sheets 2A-3, 2A-6, 2A-8, 2A-9, 2B, 2D, 2D-2, 4B, 5B, 5C, 7A, 7B, 7C and 8.

OR 99/238 Paving (Grants Pass) Section
Rogue River/Jacksonville Highway
Jackson County
Paving & Drainage Project
(Bids to be opened and read January 22, 2009)

Addenda No. 3

These changes will be included in the Contract for this Project. It is understood that your Bid will be submitted accordingly.

Make copies of the new Bid Sheets to replace the Special Provisions Bid Schedule Sheets.

CZ:mg_

Attachments: New Bid Sheets
Revised Plan Sheets

BID SCHEDULE

CONTRACT ID: 13969
PROJECT KEY: 13818

PROJECT: OR 99/238 PAVING (GRANTS PASS)
ADDENDUM NUMBER: 3

| ITEM NO | ITEM DESCRIPTION | QUANTITY AND UNITS | UNIT PRICE (IN FIGURES) | BID AMOUNT (IN FIGURES) |
|---------------------------------------------------|-------------------------------------------------------------------|--------------------|----------------------------|----------------------------|
| SECTION 0001 TEMPORARY FEATURES AND APPURTENANCES | | | | |
| 0010 | 0210-0100000A MOBILIZATION | LS ALL | | |
| 0020 | 0225-0100000A TEMPORARY PROTECTION AND DIRECTION OF TRAFFIC | LS ALL | | |
| 0030 | 0225-0102000J TEMPORARY SIGNS | SQFT 1,270.00 | | |
| 0040 | 0225-0105000E TEMPORARY BARRICADES, TYPE III | EACH 28.00 | | |
| 0050 | 0225-0145000E TEMPORARY PLASTIC DRUMS | EACH 254.00 | | |
| 0060 | 0225-0149000E TEMPORARY FLEXIBLE PAVEMENT MARKERS | EACH 8,095.00 | | |
| 0070 | 0225-0150000F TEMPORARY REMOVABLE TAPE | FOOT 1,000.00 | | |
| 0080 | 0225-0162000E SEQUENTIAL ARROW SIGNS | EACH 6.00 | | |
| 0090 | 0225-0164000E PORTABLE CHANGEABLE MESSAGE SIGNS | EACH 4.00 | | |
| 0100 | 0225-0168000T FLAGGERS | HOUR 3,000.00 | | |
| 0110 | 0225-0169000E TRAFFIC CONTROL SUPERVISOR | EACH 96.00 | | |
| 0120 | 0280-0100000A EROSION CONTROL | LS ALL | | |

BID SCHEDULE

CONTRACT ID: 13969
PROJECT KEY: 13818

PROJECT: OR 99/238 PAVING (GRANTS PASS)
ADDENDUM NUMBER: 3

| ITEM NO | ITEM DESCRIPTION | QUANTITY AND UNITS | UNIT PRICE (IN FIGURES) | BID AMOUNT (IN FIGURES) |
|---------|-------------------------------------------------|--------------------|----------------------------|----------------------------|
| 0130 | 0280-0104000R TEMPORARY MULCHING | 1.66 ACRE | | |
| 0140 | 0280-0113000F SEDIMENT FENCE, UNSUPPORTED | 1,850.00 FOOT | | |
| 0150 | 0280-0114000E INLET PROTECTION | 128.00 EACH | | |
| 0160 | 0290-0100000A POLLUTION CONTROL PLAN | ALL LS | | |

SECTION 0002 ROADWORK

| | | | | |
|------|------------------------------------------------------------|------------------|--|--|
| 0170 | 0305-0100000A CONSTRUCTION SURVEY WORK | ALL LS | | |
| 0180 | 0310-0106000A REMOVAL OF STRUCTURES AND OBSTRUCTIONS | ALL LS | | |
| 0190 | 0320-0100000A CLEARING AND GRUBBING | ALL LS | | |
| 0200 | 0330-0101000K DITCH EXCAVATION | 93.00 CUYD | | |
| 0210 | 0330-0123000K EMBANKMENT IN PLACE | 2,179.00 CUYD | | |
| 0220 | 0331-0106000J 12 INCH SUBGRADE STABILIZATION | 100.00 SQYD | | |
| 0230 | 0331-0112000J 24 INCH SUBGRADE STABILIZATION | 220.00 SQYD | | |
| 0240 | 0350-0105000J SUBGRADE GEOTEXTILE | 811.00 SQYD | | |

SECTION 0003 DRAINAGE AND SEWERS

BID SCHEDULE

CONTRACT ID: 13969
PROJECT KEY: 13818

PROJECT: OR 99/238 PAVING (GRANTS PASS)
ADDENDUM NUMBER: 3

| ITEM NO | ITEM DESCRIPTION | QUANTITY AND UNITS | UNIT PRICE (IN FIGURES) | BID AMOUNT (IN FIGURES) |
|---------|-----------------------------------------------------------|--------------------|----------------------------|----------------------------|
| 0250 | 0445-035012AF 12 INCH STORM SEWER PIPE, 5 FT DEPTH | 2,128.00 FOOT | | |
| 0260 | 0445-035012BF 12 INCH STORM SEWER PIPE, 10 FT DEPTH | 237.00 FOOT | | |
| 0270 | 0445-035018AF 18 INCH STORM SEWER PIPE, 5 FT DEPTH | 1,726.00 FOOT | | |
| 0280 | 0445-035018BF 18 INCH STORM SEWER PIPE, 10 FT DEPTH | 691.00 FOOT | | |
| 0290 | 0445-0735020E CONCRETE CLOSURE COLLARS | 2.00 EACH | | |
| 0300 | 0445-0735050F VIDEO INSPECTION | 1,229.00 FOOT | | |
| 0310 | 0470-0101000E CONCRETE STORM SEWER MANHOLES | 2.00 EACH | | |
| 0320 | 0470-0103000E CONCRETE MANHOLES, WITH INLET | 4.00 EACH | | |
| 0330 | 0470-0307000E CONCRETE INLETS, TYPE CG-2 | 6.00 EACH | | |
| 0340 | 0470-0309000E CONCRETE INLETS, TYPE CG-3 | 30.00 EACH | | |
| 0350 | 0470-0315000E CONCRETE INLETS, TYPE G-2 | 22.00 EACH | | |
| 0360 | 0490-0100000E ADJUSTING BOXES | 141.00 EACH | | |
| 0370 | 0490-0104000E CONNECTION TO EXISTING STRUCTURES | 9.00 EACH | | |

BID SCHEDULE

CONTRACT ID: 13969
PROJECT KEY: 13818

PROJECT: OR 99/238 PAVING (GRANTS PASS)
ADDENDUM NUMBER: 3

| ITEM NO | ITEM DESCRIPTION | QUANTITY AND UNITS | UNIT PRICE (IN FIGURES) | BID AMOUNT (IN FIGURES) |
|---------|--------------------------------------------------|--------------------|----------------------------|----------------------------|
| 0380 | 0490-0120000E MINOR ADJUSTMENT OF MANHOLES | EACH 41.00 | | |
| 0390 | 0490-0121000E MAJOR ADJUSTMENT OF MANHOLES | EACH 10.00 | | |
| 0400 | 0490-9Z90000E CAPPING INLETS | EACH 3.00 | | |
| 0410 | 0495-0100000J TRENCH RESURFACING | SQYD 525.00 | | |

SECTION 0004 BRIDGES

| | | | | |
|------|-------------------------------------------------------------------------------|-------------|--|--|
| 0420 | 0503-0101000J BRIDGE DECK COLD PLANE PAVEMENT REMOVAL, 2 INCHES DEEP | SQYD 611.00 | | |
|------|-------------------------------------------------------------------------------|-------------|--|--|

SECTION 0005 BASES

| | | | | |
|------|-----------------------------------------------------------------------|----------------|--|--|
| 0430 | 0620-0106000J COLD PLANE PAVEMENT REMOVAL, 0 - 3 INCHES DEEP | SQYD 2,167.00 | | |
| 0440 | 0620-0112000J COLD PLANE PAVEMENT REMOVAL, 2 - 4 INCHES DEEP | SQYD 244.00 | | |
| 0450 | 0620-0112000J COLD PLANE PAVEMENT REMOVAL, 2 - 3 INCHES DEEP | SQYD 4,900.00 | | |
| 0460 | 0620-0120000J COLD PLANE PAVEMENT REMOVAL, 2 INCHES DEEP | SQYD 30,330.00 | | |
| 0470 | 0620-0122000J COLD PLANE PAVEMENT REMOVAL, 3 INCHES DEEP | SQYD 69,277.00 | | |

BID SCHEDULE

CONTRACT ID: 13969
PROJECT KEY: 13818

PROJECT: OR 99/238 PAVING (GRANTS PASS)
ADDENDUM NUMBER: 3

| ITEM NO | ITEM DESCRIPTION | QUANTITY AND UNITS | UNIT PRICE (IN FIGURES) | BID AMOUNT (IN FIGURES) |
|---------|---------------------------------|--------------------|-------------------------|-------------------------|
| 0480 | 0620-9Z90000J RUBBLIZE PCC | SQYD 2,167.00 | | |
| 0490 | 0641-0102000M AGGREGATE BASE | TON 3,590.00 | | |

SECTION 0006 WEARING SURFACES

| | | | | |
|------|--------------------------------------------------------------|-------------------|--|--|
| 0500 | 0730-0100000M EMULSIFIED ASPHALT FOR TACK COAT | TON 38.00 | | |
| 0510 | 0745-0302000M LEVEL 3, 1/2 INCH DENSE HMAC | TON 19,300.00 | | |
| 0520 | 0745-0640000M PG 70-22 ASPHALT IN HMAC | TON 1,170.00 | | |
| 0530 | 0748-0116000J 31 INCH ASPHALT CONCRETE PAVEMENT REPAIR | SQYD 275.00 | | |
| 0540 | 0749-0100000E EXTRA FOR ASPHALT APPROACHES | EACH 70.00 | | |
| 0550 | 0749-0108000J EXTRA FOR ASPHALT SLOPE PAVING | SQFT 14,655.00 | | |
| 0560 | 0759-0103000F CONCRETE CURBS, CURB AND GUTTER | FOOT 9,394.00 | | |
| 0570 | 0759-0126000J CONCRETE DRIVEWAYS | SQFT 15,972.00 | | |
| 0580 | 0759-0128000J CONCRETE WALKS | SQFT 27,451.00 | | |
| 0590 | 0759-0134000J MONOLITHIC CURB AND SIDEWALKS | SQFT 19,476.00 | | |

BID SCHEDULE

CONTRACT ID: 13969
PROJECT KEY: 13818

PROJECT: OR 99/238 PAVING (GRANTS PASS)
ADDENDUM NUMBER: 3

| ITEM NO | ITEM DESCRIPTION | QUANTITY AND UNITS | UNIT PRICE (IN FIGURES) | BID AMOUNT (IN FIGURES) |
|---------|---------------------------------------------------------|--------------------|----------------------------|----------------------------|
| 0600 | 0759-0138000J LANDSCAPE PAVERS CONCRETE SURFACING | 12.00 SQFT | | |

SECTION 0007 PERMANENT TRAFFIC SAFETY AND GUIDANCE DEVICES

| | | | | |
|------|----------------------------------------------------------------------|-------------------|--|--|
| 0610 | 0855-0100000E MONO-DIRECTIONAL WHITE TYPE 1 MARKERS | 520.00 EACH | | |
| 0620 | 0855-0102000E BI-DIRECTIONAL YELLOW TYPE 1 MARKERS | 522.00 EACH | | |
| 0630 | 0865-0119000F THERMOPLASTIC, NON-PROFILE, 120 MILS, SPRAYED | 63,117.00 FOOT | | |
| 0640 | 0867-0102000E PAVEMENT LEGEND, TYPE A: ARROWS | 45.00 EACH | | |
| 0650 | 0867-0130000E PAVEMENT LEGEND, TYPE A: BICYCLE LANE STENCIL | 63.00 EACH | | |
| 0660 | 0867-0144000J PAVEMENT BAR, TYPE A | 2,625.00 SQFT | | |

SECTION 0008 PERMANENT TRAFFIC CONTROL AND ILLUMINATION SYSTEMS

| | | | | |
|------|---------------------------------------------------------|-----------------|--|--|
| 0670 | 0905-0100000A REMOVE EXISTING SIGNS | ALL LS | | |
| 0680 | 0905-0101000A REMOVE AND REINSTALL EXISTING SIGNS | ALL LS | | |
| 0690 | 0910-0100000K WOOD SIGN POSTS | 1,140.00 FBM | | |
| 0700 | 0930-0107000A SIGNAL POLE MOUNTS | ALL LS | | |

BID SCHEDULE

CONTRACT ID: 13969
PROJECT KEY: 13818

PROJECT: OR 99/238 PAVING (GRANTS PASS)
ADDENDUM NUMBER: 3

| ITEM NO | ITEM DESCRIPTION | QUANTITY AND UNITS | UNIT PRICE (IN FIGURES) | BID AMOUNT (IN FIGURES) |
|---------|------------------------------------------------------------------------------------------------|--------------------|-------------------------|-------------------------|
| 0710 | 0940-0113000J TYPE "G" SIGNS IN PLACE | 122.00 SQFT | | |
| 0720 | 0940-0121000J TYPE "R" SIGNS IN PLACE | 81.00 SQFT | | |
| 0730 | 0940-0124000J TYPE "W1" SIGNS IN PLACE | 85.70 SQFT | | |
| 0740 | 0963-0102000F 42 INCH DIAMETER SIGNAL SUPPORT DRILLED SHAFT | 15.00 FOOT | | |
| 0750 | 0970-0100000A POLE FOUNDATIONS | ALL LS | | |
| 0760 | 0970-0101000A LIGHTING POLE INSTALLATION | ALL LS | | |
| 0770 | 0970-0105000A SWITCHING, CONDUIT, AND WIRING | ALL LS | | |
| 0780 | 0990-0102000A TRAFFIC SIGNAL MODIFICATION (ROGUE RIVER HWY AT PARKDALE DR) | ALL LS | | |
| 0790 | 0990-0103000A LOOP DETECTOR INSTALLATION (JACKSONVILLE HWY AT HARBECK RD) | ALL LS | | |
| 0800 | 0990-0103000A LOOP DETECTOR INSTALLATION (JACKSONVILLE HWY AT NEW HOPE RD) | ALL LS | | |
| 0810 | 0990-0103000A LOOP DETECTOR INSTALLATION (JACKSONVILLE HWY UNION AVE & HARBECK RD) | ALL LS | | |

BID SCHEDULE

CONTRACT ID: 13969
PROJECT KEY: 13818

PROJECT: OR 99/238 PAVING (GRANTS PASS)
ADDENDUM NUMBER: 3

| ITEM NO | ITEM DESCRIPTION | QUANTITY AND UNITS | UNIT PRICE (IN FIGURES) | BID AMOUNT (IN FIGURES) |
|---------|------------------------------------------------------------------------------------|--------------------|----------------------------|----------------------------|
| 0820 | 0990-0103000A LOOP DETECTOR INSTALLATION (REDWOOD HWY AT ROGUE RIVER HWY) | LS ALL | | |

SECTION 0009 RIGHT-OF-WAY DEVELOPMENT AND CONTROL

| | | | | |
|------|-----------------------------------------------------|---------------|--|--|
| 0830 | 1030-0108000R PERMANENT SEEDING | ACRE 0.26 | | |
| 0840 | 1040-0100000E SOIL TESTING | EACH 2.00 | | |
| 0850 | 1040-0101000K TOPSOIL | CUYD 3,250.00 | | |
| 0860 | 1040-0107000K SOIL CONDITIONER | CUYD 547.00 | | |
| 0870 | 1040-0130000E DECIDUOUS TREES, 2 INCH CALIPER | EACH 83.00 | | |
| 0880 | 1040-0154000E SHRUBS, NO. 2 CONTAINER | EACH 5,168.00 | | |
| 0890 | 1040-0155000E SHRUBS, NO. 3 CONTAINER | EACH 2,822.00 | | |
| 0900 | 1040-0157000E SHRUBS, SPECIMEN | EACH 53.00 | | |
| 0910 | 1040-0190000K BARK MULCH | CUYD 547.00 | | |
| 0920 | 1050-0137000F CL-6R CHAIN-LINK FENCE | FOOT 140.00 | | |
| 0930 | 1070-0100000E SINGLE MAILBOX SUPPORTS | EACH 6.00 | | |

BID SCHEDULE

CONTRACT ID: 13969
PROJECT KEY: 13818

PROJECT: OR 99/238 PAVING (GRANTS PASS)
ADDENDUM NUMBER: 3

| ITEM NO | ITEM DESCRIPTION | QUANTITY AND UNITS | UNIT PRICE (IN FIGURES) | BID AMOUNT (IN FIGURES) |
|---------|-----------------------------------------------------------|--------------------|----------------------------|----------------------------|
| 0940 | 1070-0101000E MULTIPLE MAILBOX SUPPORTS | EACH 17.00 | | |
| 0950 | 1070-0103000E REMOVE AND REINSTALL CLUSTER BOX UNIT | EACH 4.00 | | |

SECTION 0010 WATER SUPPLY SYSTEMS

| | | | | |
|------|------------------------------------|--------|--|--|
| 0960 | 1120-0100000A IRRIGATION SYSTEM | LS ALL | | |
|------|------------------------------------|--------|--|--|

SECTION 0011 ADDED BID ITEMS

| | | | | |
|------|----------------------------------------------------------|-------------|--|--|
| 0970 | 0445-035024AF 24 INCH STORM SEWER PIPE, 5 FT DEPTH | FOOT 168.00 | | |
| | TOTAL BID | | | |

TYPICAL SECTIONS

42V-012

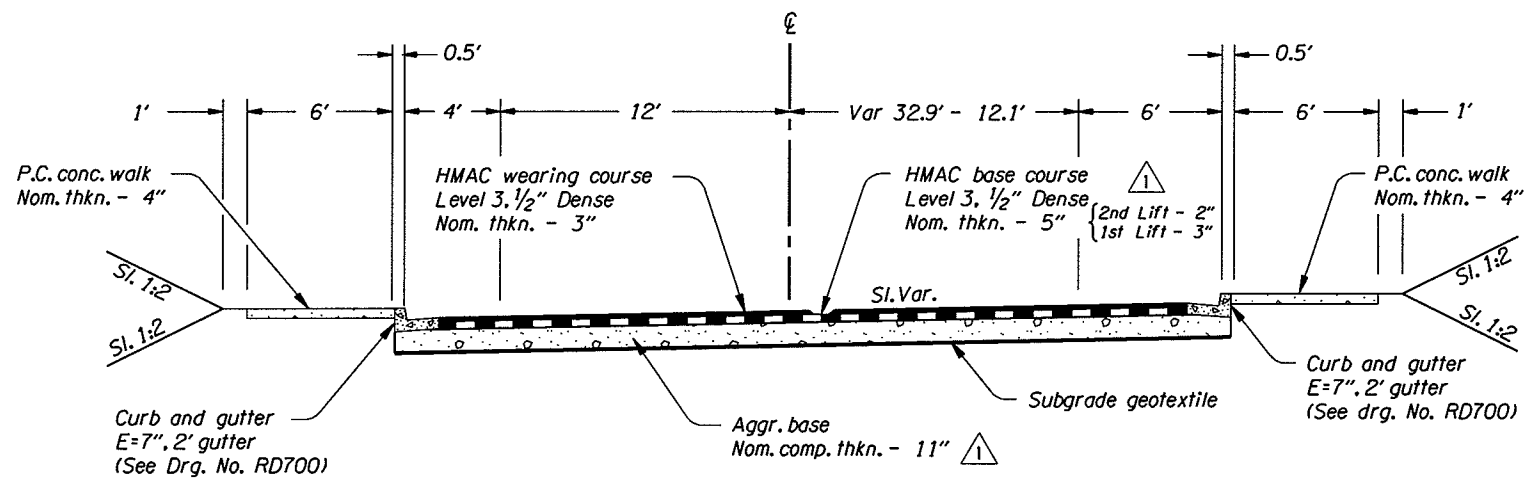

STA. "RR" 17+10.00 To STA. "RR" 18+08.03

| Rev. No. | Description | Date | Engineer |
|----------|-----------------------------------------------------------------------------|----------|--------------|
| 1 | Revise base course from: 4" to 5" Chg. Nom. comp. thkn. from: 12" to 11" | 12-30-08 | Chris Zelmer |

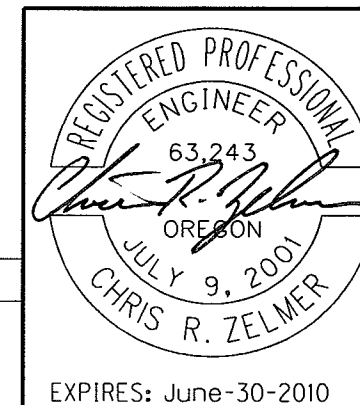

OREGON DEPARTMENT OF TRANSPORTATION

REGION 3 - TECHNICAL CENTER

OR 99/238 PAVING (GRANTS PASS)
ROGUE RIVER / JACKSONVILLE HIGHWAY
JOSEPHINE COUNTY

Design Team Leader - Chris Zelmer
Designed By - Bob Branch
Drafted By - David Knox

TYPICAL SECTIONS

SHEET NO. 2

TYPICAL SECTIONS

42V-012

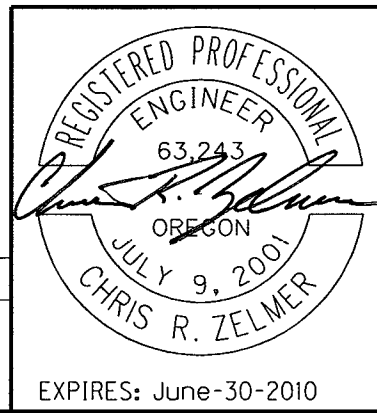
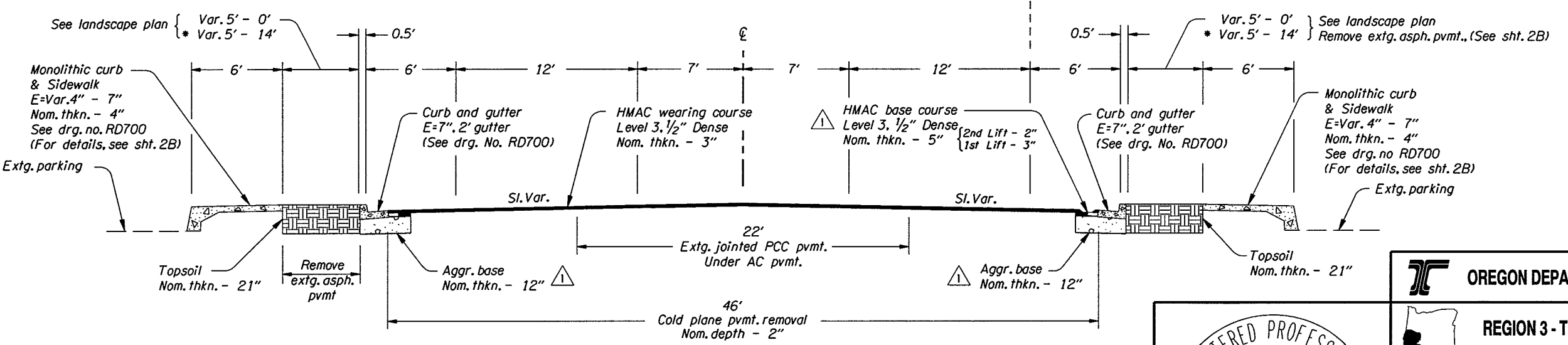
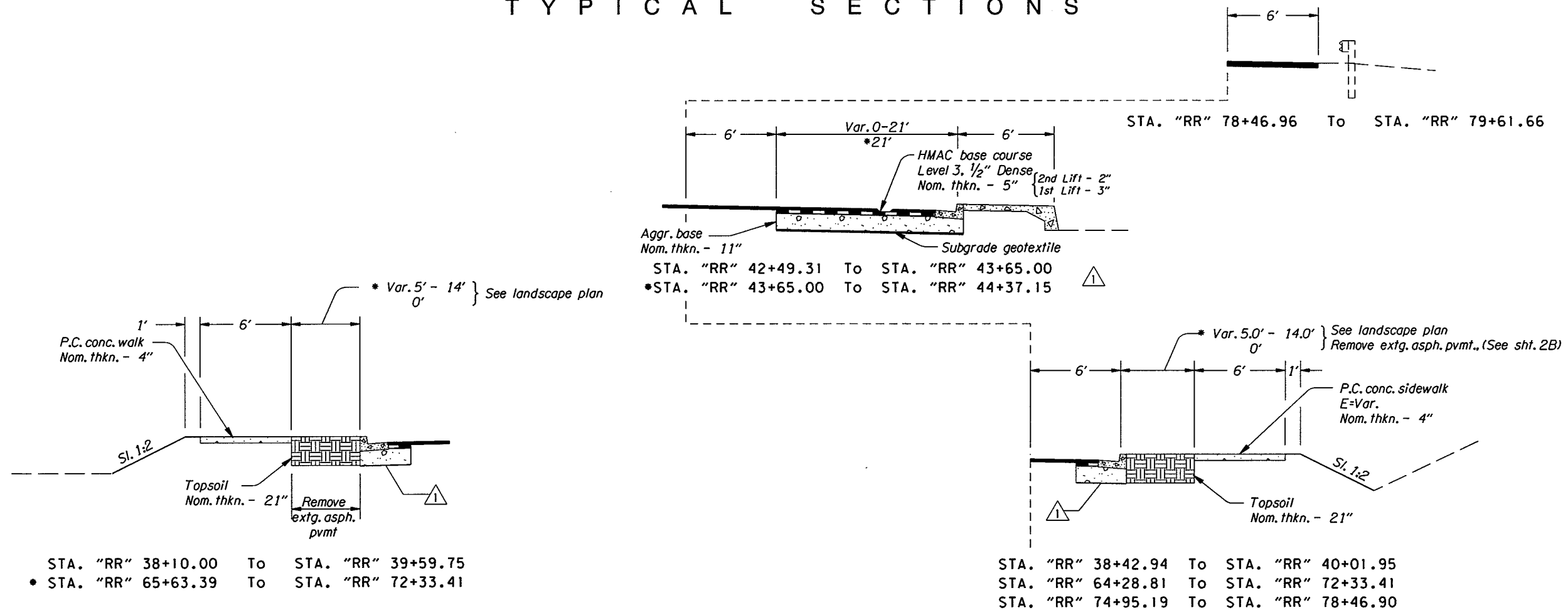

OREGON DEPARTMENT OF TRANSPORTATION

REGION 3 - TECHNICAL CENTER

OR 99/238 PAVING (GRANTS PASS)
 ROGUE RIVER / JACKSONVILLE HIGHWAY
 JOSEPHINE COUNTY

Design Team Leader - Chris Zelmer
 Designed By - Bob Branch
 Drafted By - David Knox

TYPICAL SECTIONS

SHEET NO. **2A-3**

| Rev. No. | Description | Date | Engineer |
|----------|------------------------------------------------------|--------|--------------|
| 1 | Added aggregate base 12" under curb / gutter & stack | 1-9-09 | Chris Zelmer |

EXPIRES: June-30-2010

TYPICAL SECTIONS

42V-012

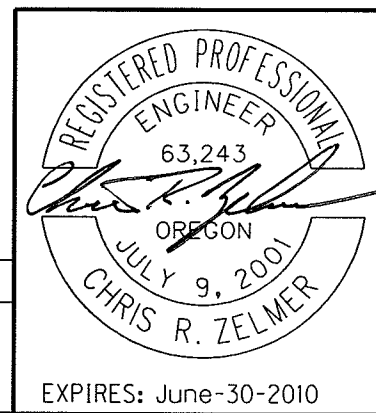
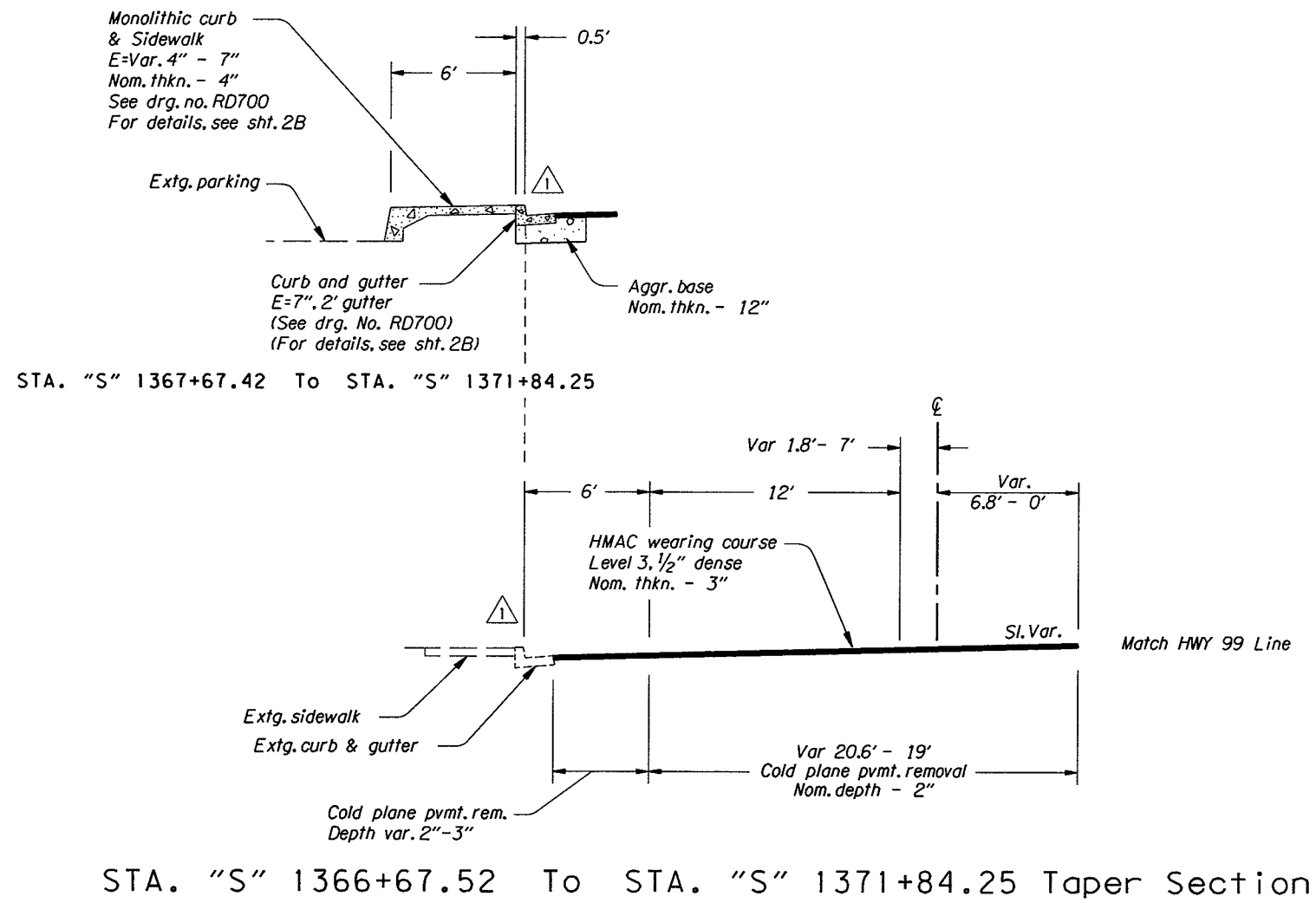

| | |
|-------------------------------------------------------------------------------------------------|--------------------------|
| OREGON DEPARTMENT OF TRANSPORTATION | |
| REGION 3 - TECHNICAL CENTER | |
| OR 99/238 PAVING (GRANTS PASS) ROGUE RIVER / JACKSONVILLE HIGHWAY JOSEPHINE COUNTY | |
| Design Team Leader - Chris Zelmer Designed By - Bob Branch Drafted By - David Knox | |
| TYPICAL SECTIONS | SHEET NO. 2A-6 |

| Rev. No. | Description | Date | Engineer |
|----------|-----------------------------------------------|---------|--------------|
| 1 | Moved dim's from edge of asph to edge of curb | 1-12-09 | Chris Zelmer |

TYPICAL SECTIONS

42V-012

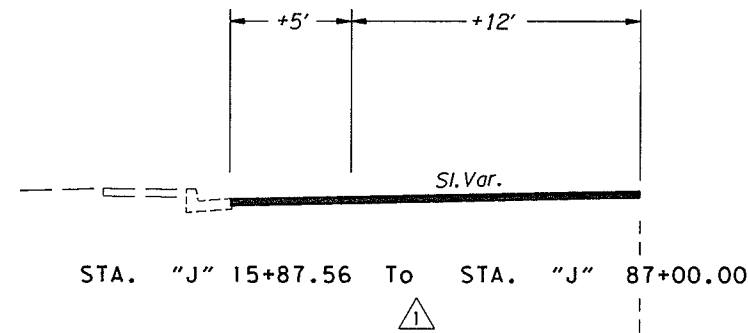

| TABLE | | |
|---------------------|--------------|----------------|
| STATION | MEDIAN WIDTH | |
| | Lt. | Rt. |
| 7+51.5 - 10+85.90 | Var. 0'-7.0' | 3.2' |
| 10+85.90 - 14+85.98 | 7.0' | Var. 3.2'-7.0' |
| 14+85.98 - 87+00.00 | 7.0' | 7.0' |

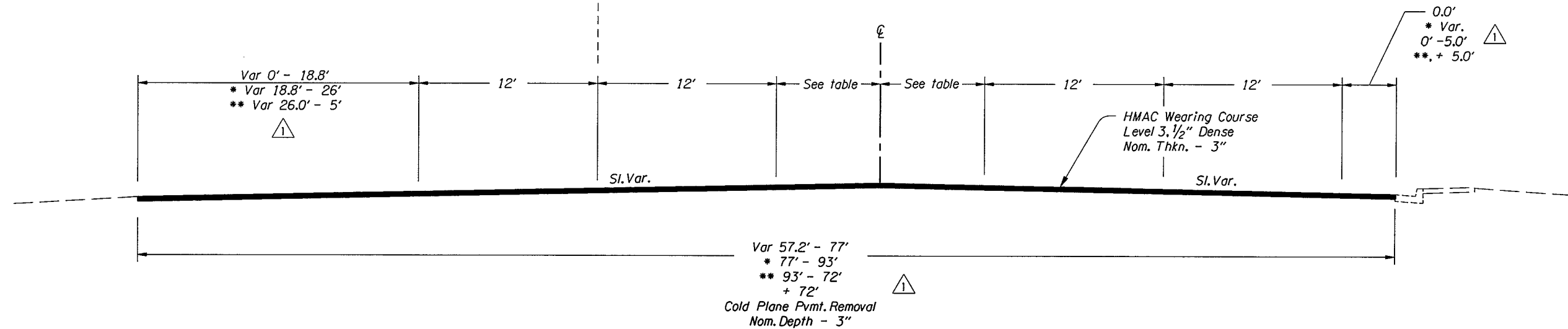

STA. "J" 07+51.50 To STA. "J" 10+85.90 Taper Section
 *STA. "J" 10+85.90 To STA. "J" 14+85.98 Taper Section
 **STA. "J" 14+85.90 To STA. "J" 15+87.56 Taper Section
 +STA. "J" 15+87.56 To STA. "J" 87+00.00

OREGON DEPARTMENT OF TRANSPORTATION

REGION 3 - TECHNICAL CENTER

OR 99/238 PAVING (GRANTS PASS)
 ROGUE RIVER / JACKSONVILLE HIGHWAY
 JOSEPHINE COUNTY

Design Team Leader - Chris Zelmer
 Designed By - Bob Branch
 Drafted By - David Knox

TYPICAL SECTIONS SHEET NO. 2A-8

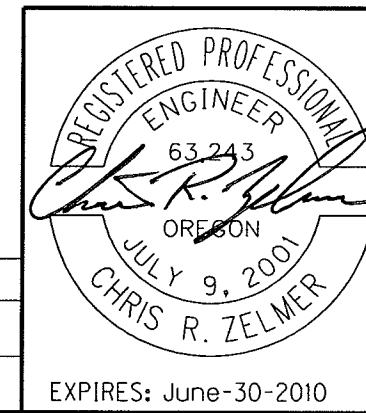

| Rev. No. | Description | Date | Engineer |
|----------|------------------------------|---------|--------------|
| 1 | Moved stack, chgd dimensions | 1-12-09 | Chris Zelmer |

EXPIRES: June-30-2010

TYPICAL SECTIONS

42V-012

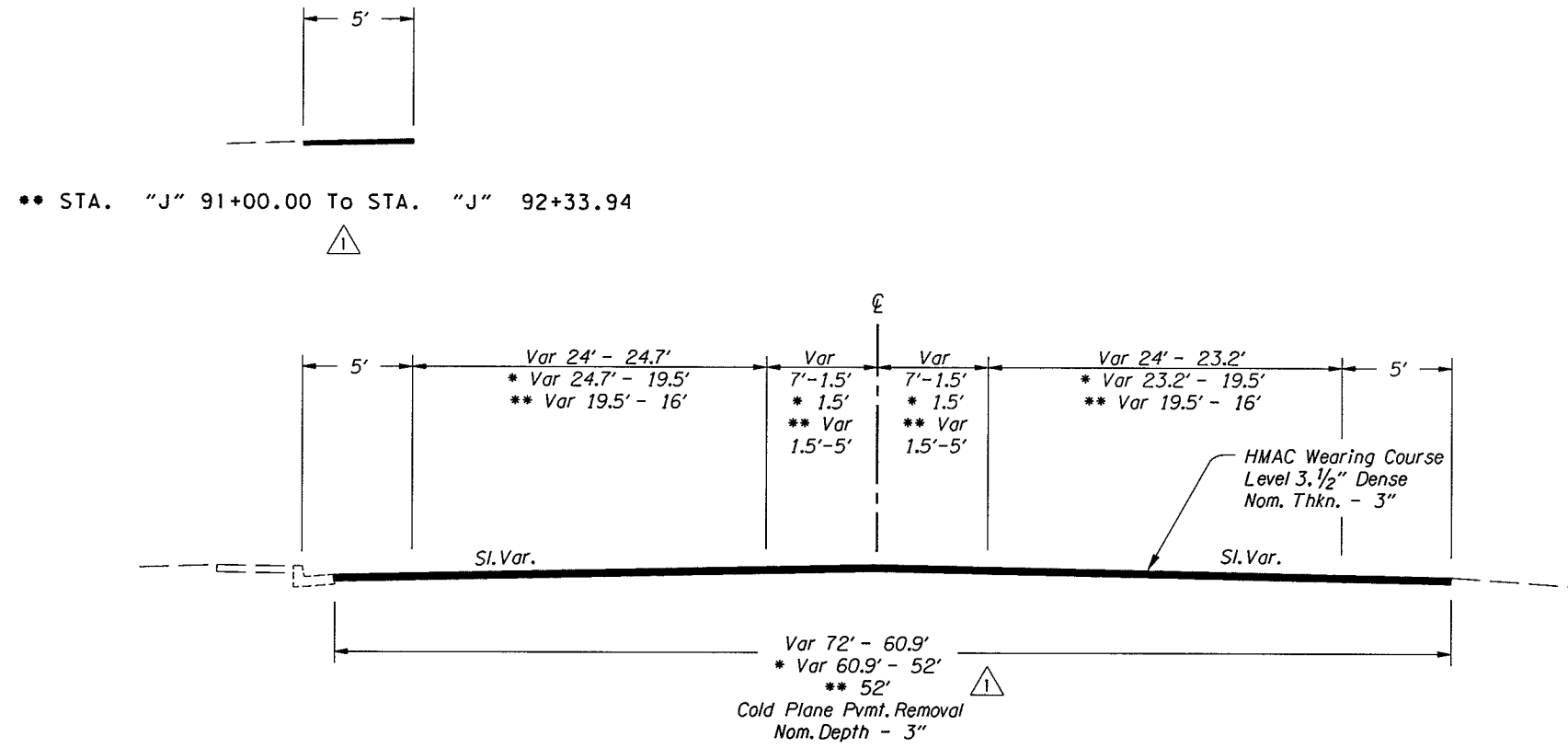

STA. "J" 87+00.00 To STA. "J" 89+52.75 Taper Section
 *STA. "J" 89+52.75 To STA. "J" 91+00.00 Taper Section
 **STA. "J" 91+00.00 To STA. "J" 92+33.94 Taper Section

OREGON DEPARTMENT OF TRANSPORTATION

REGION 3 - TECHNICAL CENTER

OR 99/238 PAVING (GRANTS PASS)
 ROGUE RIVER / JACKSONVILLE HIGHWAY
 JOSEPHINE COUNTY

Design Team Leader - Chris Zelmer
 Designed By - Bob Branch
 Drafted By - David Knox

TYPICAL SECTIONS

SHEET NO. 2A-9

REGISTERED PROFESSIONAL ENGINEER
 63,243
 OREGON
 JULY 9, 2001
 CHRIS R. ZELMER
 EXPIRES: June-30-2010

| Rev. No. | Description | Date | Engineer |
|----------|------------------------------|---------|--------------|
| 1 | Moved stack, chgd dimensions | 1-12-09 | Chris Zelmer |

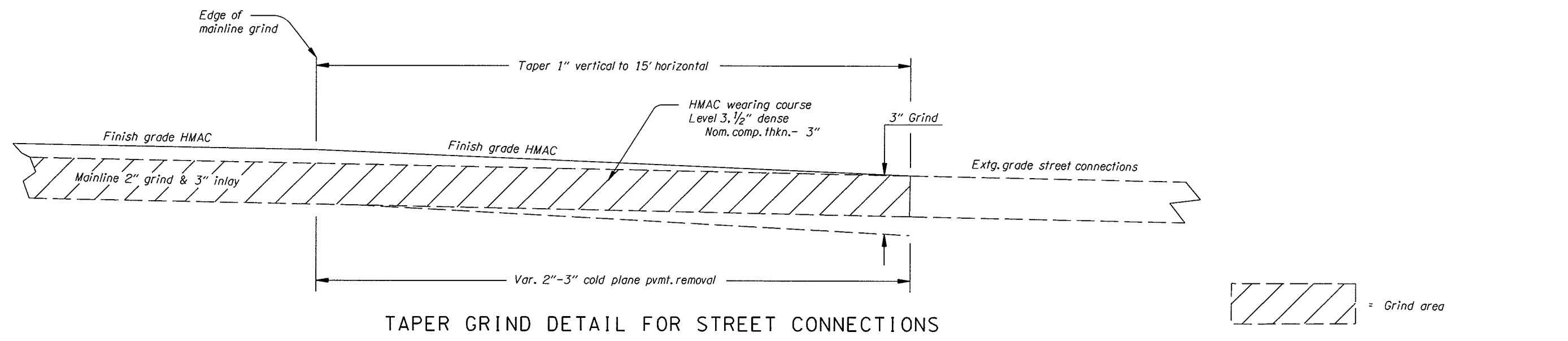

TAPER GRIND DETAIL FOR STREET CONNECTIONS

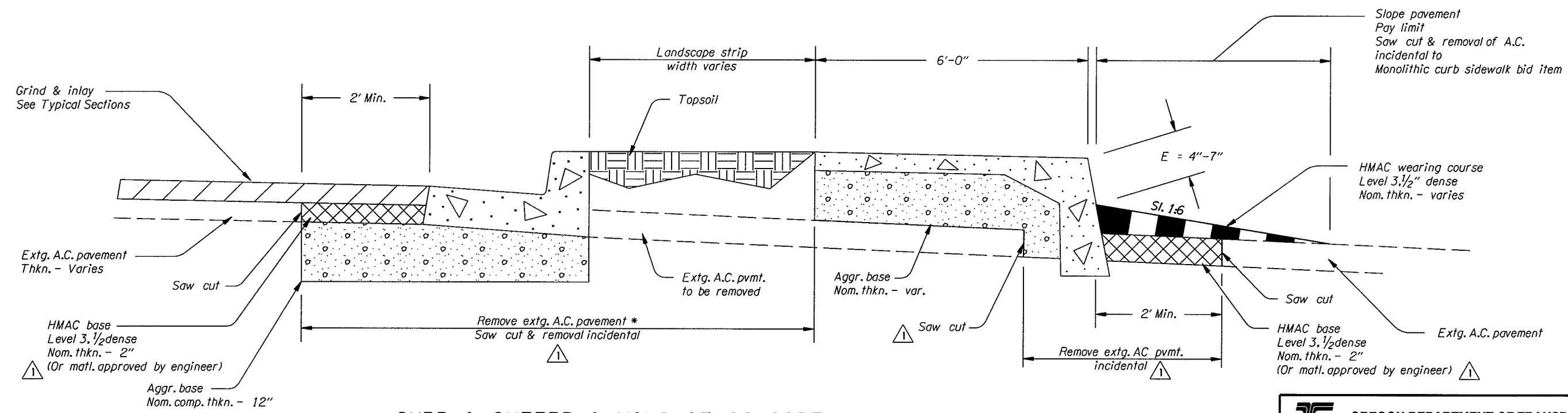

CURB & GUTTER & MONOLITHIC SIDEWALK CONSTRUCTION IN PARKING AREAS

* Sta. "RR" 18+08.03 - Sta. "RR" 26+98.33
Remove to edge of rubblization (See sht. 2A)

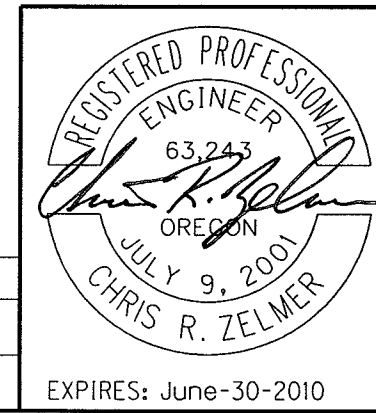

OREGON DEPARTMENT OF TRANSPORTATION

REGION 3 - TECHNICAL CENTER

OR 99/238 PAVING (GRANTS PASS)
ROGUE RIVER / JACKSONVILLE HIGHWAY
JOSEPHINE COUNTY

Design Team Leader - Chris Zelmer
Designed By - Bob Branch
Drafted By - David Knox

DETAILS

SHEET NO. **2B**

| Rev. No. | Description | Date | Engineer |
|----------|----------------------------------------|--------|--------------|
| 1 | Changed monolithic curb sidewalk shape | 1-9-09 | Chris Zelmer |

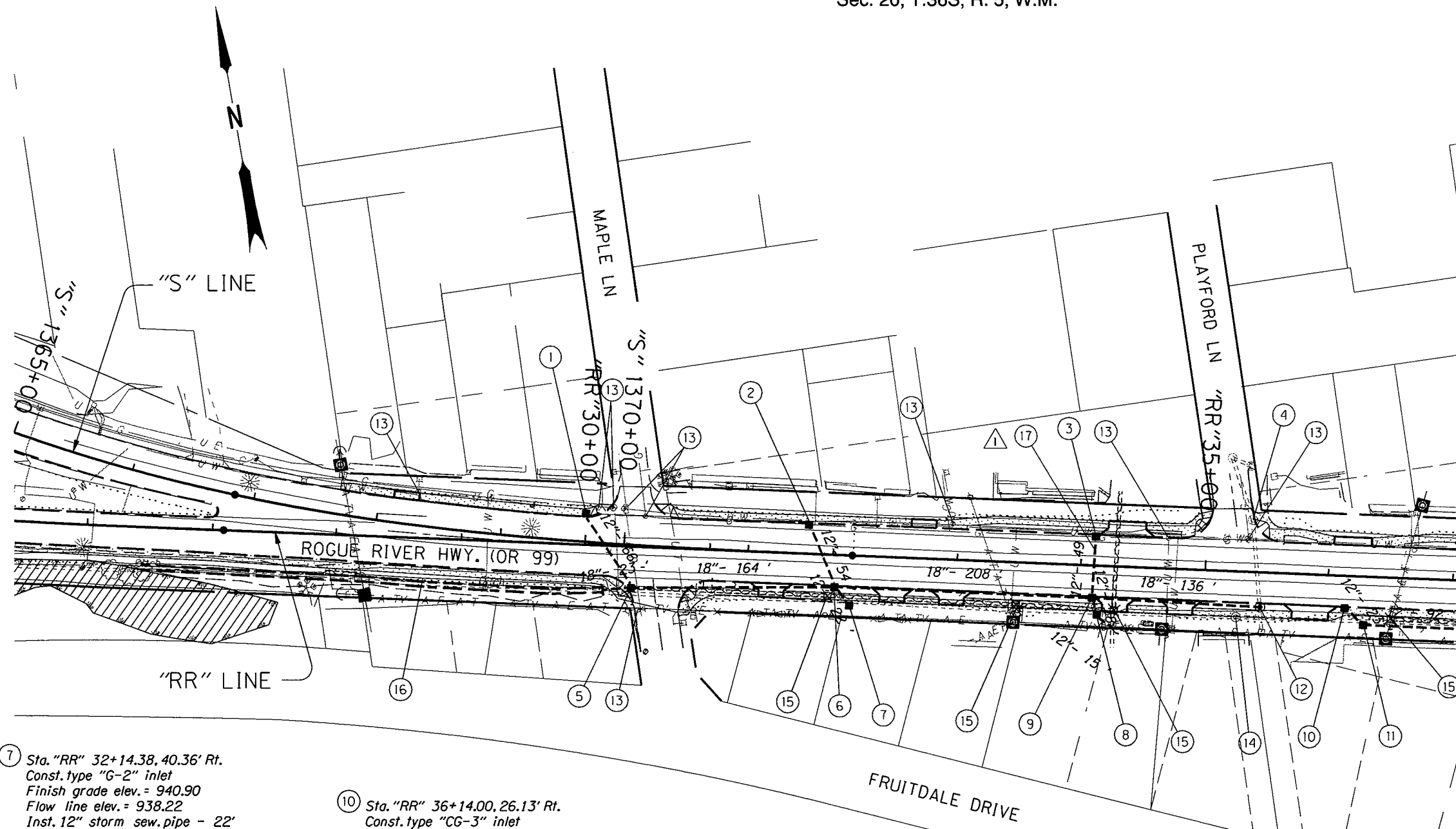

- ① Sta. "RR" 29+99.74, 25.17' Lt.
Const. type "CG-3" inlet
Finish grade elev. = 943.53
Flow line elev. = 940.00
(See std. drg. no. RD302)
- ② Sta. "RR" 31+79.25, 23.55' Lt.
Const. type "CG-2" inlet
Finish grade elev. = 942.00
Flow line elev. = 938.37
- ③ Sta. "RR" 34+11.16, 23.55' Lt.
Const. type "CG-2" inlet
Finish grade elev. = 940.24
Flow line elev. = 936.24
- ④ Major adjust manhole
- ⑤ Sta. "RR" 30+38.20, 33.49' Rt.
Const. type "CG-3" inlet
Finish grade elev. = 942.96
Flow line elev. = 939.72
Inst. 12" storm sew. pipe - 66'
5' depth
Inst. 18" storm sew. pipe - 23'
5' depth
Trench resurfacing - 31 sq. yd.
- ⑥ Sta. "RR" 32+02.00, 26.13' Rt.
Const. type "CG-3" inlet
Finish grade elev. = 942.13
Flow line elev. = 938.13
Inst. 12" storm sew. pipe - 76'
5' depth
Inst. 18" storm sew. pipe - 164'
5' depth
Trench resurfacing - 33 sq. yd.

- ⑦ Sta. "RR" 32+14.38, 40.36' Rt.
Const. type "G-2" inlet
Finish grade elev. = 940.90
Flow line elev. = 938.22
Inst. 12" storm sew. pipe - 22'
5' depth
(See drg. no. RD364)
- ⑧ Sta. "RR" 34+14.48, 39.51' Rt.
Const. type "G-2" inlet
Inst. 12" storm sew. pipe - 15'
5' depth
Finish grade elev. = 938.37
Flow line elev. = 934.55
Conn. to extg. pipe using conc. closure collar
- ⑨ Sta. "RR" 34+10.00, 26.13' Rt.
Const. type "CG-3" inlet
Finish grade elev. = 939.65
Flow line elev. = 934.29
Inst. 12" storm sew. pipe - 67'
5' depth
Inst. 18" storm sew. pipe - 208'
5' depth
Trench resurfacing - 31 sq. yd.

- ⑩ Sta. "RR" 36+14.00, 26.13' Rt.
Const. type "CG-3" inlet
Finish grade elev. = 937.99
Flow line elev. = 923.51
- ⑪ Sta. "RR" 36+51.60, 38.46' Rt.
Const. type "G-2" inlet
Finish grade elev. = 936.88
Flow line elev. = 932.42
Inst. 12" storm sew. pipe - 23'
5' depth
Trench resurfacing - 10 sq. yd.
- ⑫ Sta. "RR" 34+45.50, 28.08' Rt.
Const. manhole
Finish grade elev. = 938.19
Flow line elev. = 933.95
Inst. 18" storm sew. pipe - 136'
5' depth
- ⑬ Adjust box - 12

- ⑭ Minor adjust manhole
- ⑮ Remove inlet - 5
- ⑯ Sta. "RR" 26+25.00 - 30+14.64 Rt.
Const. V bottom ditch with 1:2 side slopes
Ditch exc. - 93 cu. yd.
- ⑰ Inst. 6" PVC Pre-plumbed
Irrigation sleeve in common trench
with storm drain (See landscape plan)

Notes:
1. Station & offset call outs for type CG-2, CG-3 & G-2 inlets and call outs to manholes are to the center of structure.

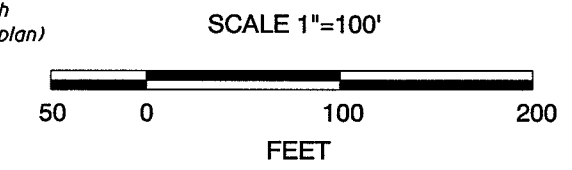

| Rev. No. | Description | Date | Engineer |
|----------|---------------|---------|--------------|
| 1 | Added note 17 | 1-12-09 | Chris Zelmer |

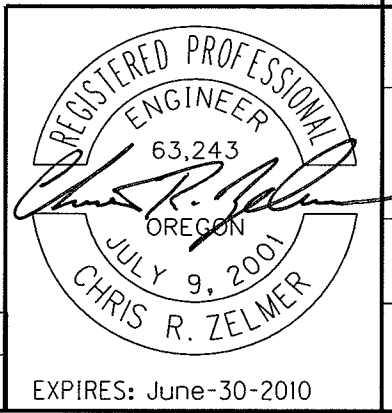

OREGON DEPARTMENT OF TRANSPORTATION

REGION 3 - TECHNICAL CENTER

OR 99/238 PAVING (GRANTS PASS)
ROGUE RIVER/JACKSONVILLE HIGHWAY
JOSEPHINE COUNTY

Design Team Leader - Chris Zelmer
Designed By - Bob Branch
Drafted By - David Knox

DRAINAGE AND UTILITIES

SHEET NO.
4B



Notes:

1. Station & offset call outs for type CG-2, CG-3 & G-2 inlets and call outs to manholes are to the center of structure.

Abandon or remove pipe shown thus:

SCALE 1"=100'

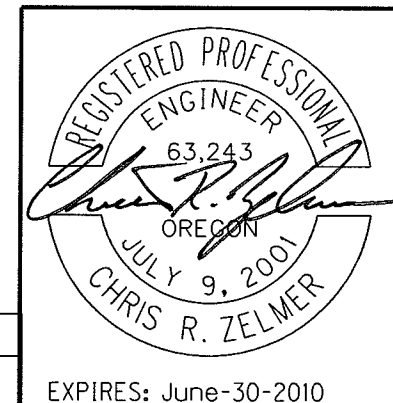
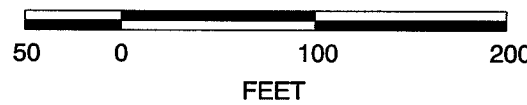

| Rev. No. | Description | Date | Engineer |
|----------|---------------|---------|--------------|
| 1 | Added note 20 | 1-12-09 | Chris Zelmer |

EXPIRES: June-30-2010

| | |
|-----------------------------------------------------------------------------------------------|------------------------|
| OREGON DEPARTMENT OF TRANSPORTATION | |
| REGION 3 - TECHNICAL CENTER | |
| OR 99/238 PAVING (GRANTS PASS) ROGUE RIVER/JACKSONVILLE HIGHWAY JOSEPHINE COUNTY | |
| Design Team Leader - Chris Zelmer Designed By - Bob Branch Drafted By - David Knox | |
| DRAINAGE AND UTILITIES | SHEET NO. 5B |

- ① Sta. "RR" 37+21.20, 39.48' Rt.
Const. type "G-2" inlet
Finish grade elev. = 936.51
Flow line elev. = 932.03
Inst. 12" storm sew. pipe - 158'
5' depth
Trench resurfacing - 80 sq. yd.
- ② Remove manhole
Conn. 12" pipe to extg. 6" using conc. closure collar.
- ③ Sta. "RR" 38+09.00, 26.13' Rt.
Const. type "CG-3" inlet
Finish grade elev. = 936.67
Flow line elev. = 931.80
Inst. 12" storm sew. pipe - 113'
5' depth
Trench resurfacing - 11 sq. yd.
- ④ Sta. "RR" 38+17.98, 44.05' Rt.
Const. type "G-2" inlet.
Finish grade elev. = 935.02
Flow line elev. = 931.89
- ⑤ Remove inlet
- ⑥ Sta. "RR" 39+79.00, 26.13' Rt.
Const. manhole with CG-3 inlet
Finish grade elev. = 935.91
Flow line elev. = 928.69
Inst. 12" storm sew. pipe - 73'
10' depth
Inst. 18" storm sew. pipe - 170'
10' depth
Conn. to extg. manhole
Trench resurfacing - 23 sq. yd.
(See drg. no. RD348)
- ⑦ Sta. "RR" 37+19.00, 23.55' Lt.
Const. type "CG-2" inlet
Finish grade elev. = 937.31
Flow line elev. = 933.30
Inst. 12" storm sew. pipe - 30'
5' depth
Trench resurfacing - 14 sq. yd.
- ⑧ Sta. "RR" 37+41.13, 43.85' Lt.
Const. type "G-2" inlet
Finish grade elev. = 935.90
Flow line elev. = 934.75
- ⑨ Sta. "RR" 39+60.00, 23.55' Lt.
Const. type "CG-2" inlet
Finish grade elev. = 936.02
Flow line elev. = 932.02
- ⑩ Sta. "RR" 41+88.00, 23.55' Lt.
Const. type "CG-2" inlet
Finish grade elev. = 935.55
Flow line elev. = 931.05
- ⑪ Sta. "RR" 42+15.84, 26.13' Rt.
Const. manhole with "CG-3" inlet
Finish grade elev. = 934.81
Flow line elev. = 928.08
Inst. 12" storm sew. pipe - 75'
10' depth
Inst. 18" storm sew. pipe - 237'
10' depth
- ⑫ Sta. "RR" 44+14.00, 23.55' Lt.
Const. type "CG-2" inlet
Finish grade elev. = 936.05
Flow line elev. = 932.05
- ⑬ Sta. "RR" 43+24.00, 34.66' Rt.
Const. manhole with "CG-3" inlet
Finish grade elev. = 935.52
Flow line out elev. = 927.81
Inst. 12" storm sew. pipe - 6'
10' depth
Inst. 18" storm sew. pipe - 109'
10' depth
Trench resurfacing - 11 sq. yd.
- ⑭ Sta. "RR" 42+11.41, 40.90' Rt.
Const. type "G-2" inlet
Finish grade elev. = 933.80
Flow line elev. = 930.90
- ⑮ Sta. "RR" 43+24.95, 46.20' Rt.
Const. type "G-2" inlet
Finish grade elev. = 934.39
Flow line elev. = 930.64
- ⑯ Sta. "RR" 44+34.68, 40.36' Rt.
Const. manhole with "CG-3" inlet
Finish grade elev. = 934.77
Flow line elev. = 927.52
Inst. 12" storm sew. pipe - 66'
10' depth
Inst. 18" storm sew. pipe - 111'
10' depth
Trench resurfacing - 23 sq. yd.
- ⑰ Sta. "RR" 44+87.64, 26.37' Rt.
Const. manhole, cast in place
Finish grade elev. = 934.92
Conn. to extg. storm sew. pipe
Flow line in = 927.36
Flow line out = 925.76
Inst. 18" storm sew. pipe - 64'
10' depth
Trench resurfacing - 28 sq. yd.
Conn. to extg. storm sew. pipe
- ⑱ Adjust box - 8
- ⑲ Minor adjustment of manhole - 3
- ⑳ Inst. 6" PVC Pre-plumbed
Irrigation sleeve in common trench
with storm drain (See landscape plan)

| Rev. No. | Description | Date | Engineer |
|----------|---------------|---------|--------------|
| 1 | Added note 20 | 1-12-09 | Chris Zelmer |

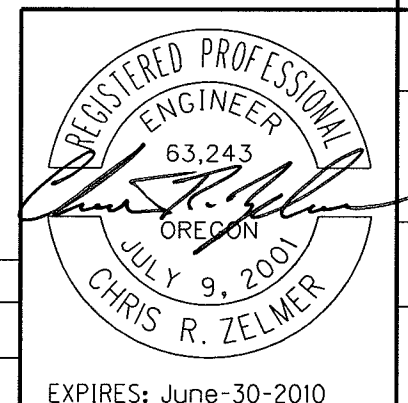

| | |
|-----------------------------------------------------------------------------------------------|------------------------|
| OREGON DEPARTMENT OF TRANSPORTATION | |
| REGION 3 - TECHNICAL CENTER | |
| OR 99/238 PAVING (GRANTS PASS) ROGUE RIVER/JACKSONVILLE HIGHWAY JOSEPHINE COUNTY | |
| Design Team Leader - Chris Zelmer Designed By - Bob Branch Drafted By - David Knox | |
| DRAINAGE AND UTILITIES | SHEET NO. 5C |

"RR" LINE (Left Side)

Profile grade at center line of highway
to match extg. ground at center line.

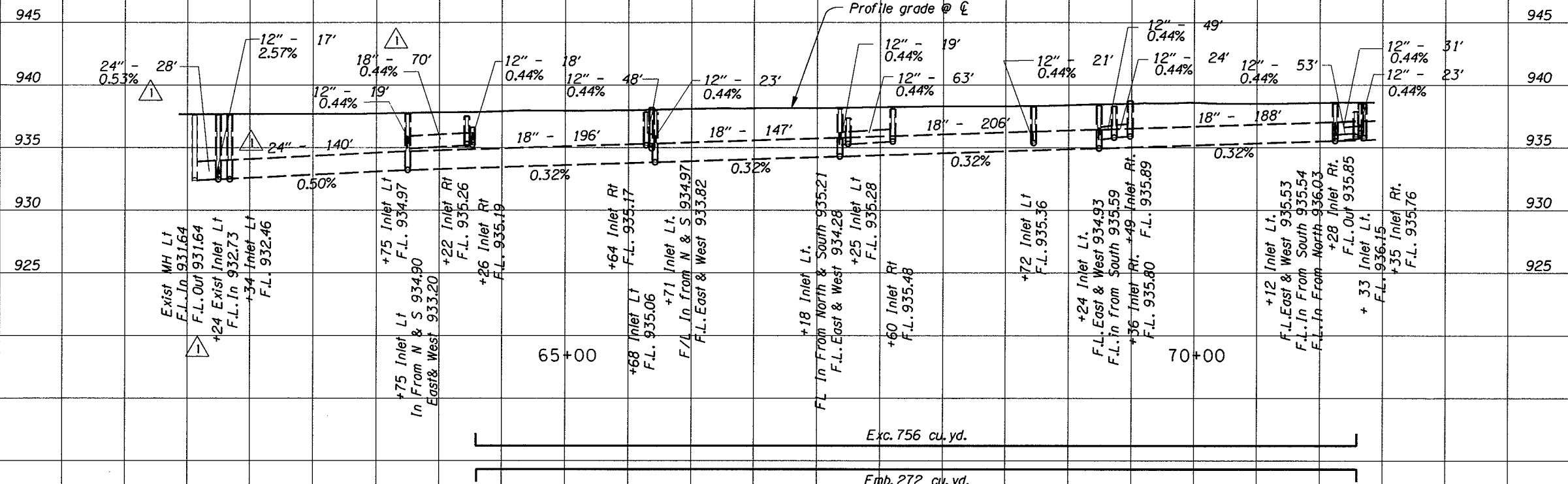

Exc. 756 cu. yd.
Emb. 272 cu. yd.

Scale
Horizontal 1"=100'
Vertical 1"=10'

| Rev. No. | Description | Date | Engineer |
|----------|----------------------------------------------------------------------------|--------|--------------|
| △ | Increased pipe diameters 12" to 18" & 18" to 24" F.L Out was: 932.28 | 1-9-09 | Chris Zelmer |

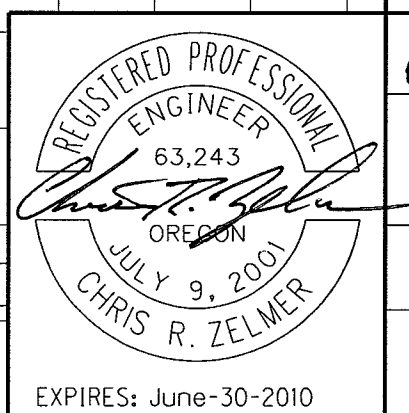

OREGON DEPARTMENT OF TRANSPORTATION

REGION 3 - TECHNICAL CENTER

OR 99/238 PAVING (GRANTS PASS)
ROGUE RIVER / JACKSONVILLE HIGHWAY
JOSEPHINE COUNTY

Design Team Leader - Chris Zelmer
Designed By - Bob Branch
Drafted By - David Knox

PROFILE

SHEET NO. 7A

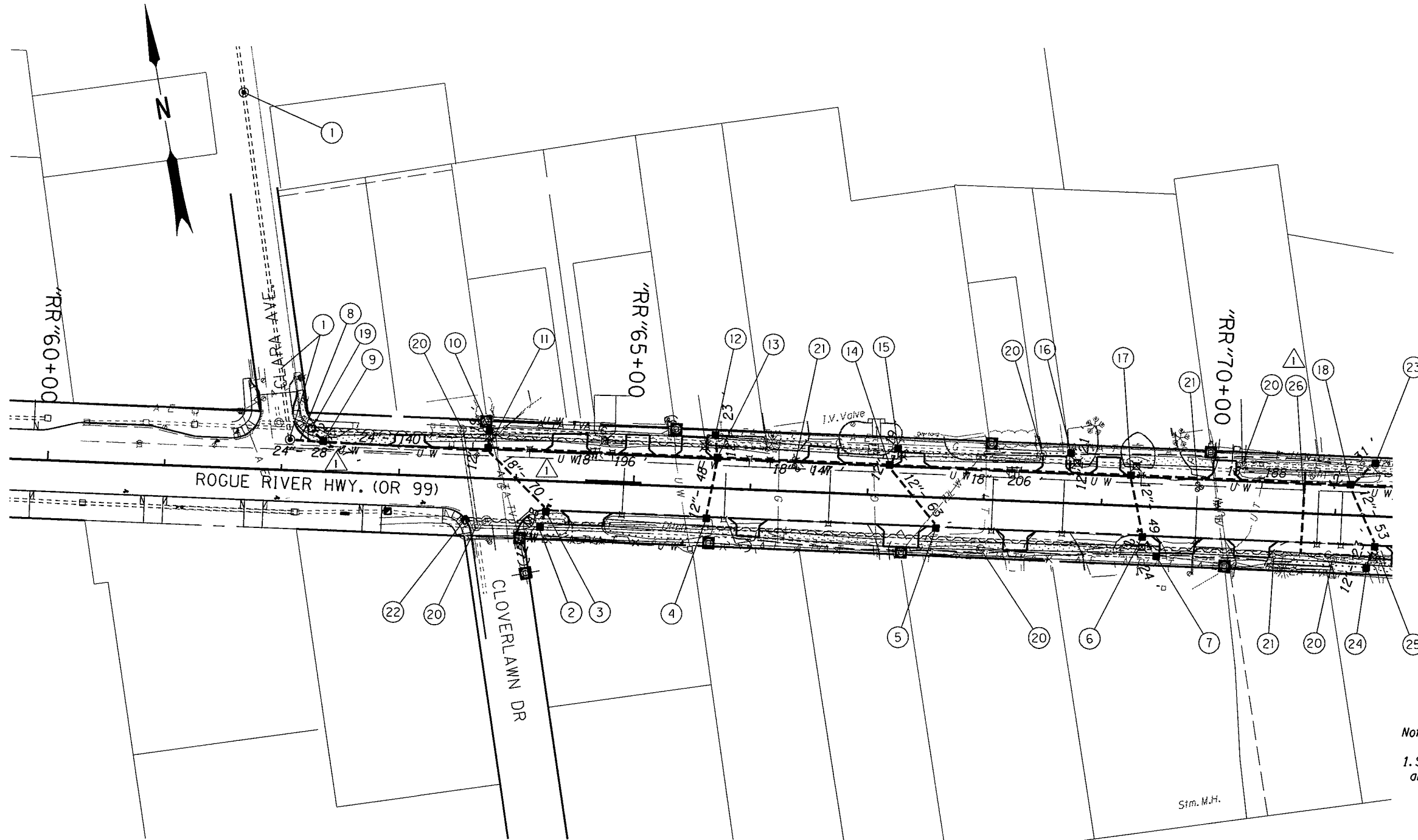

Notes:
 1. Station & offset call outs for type CG-2, CG-3 & G-2 inlets and call outs to manholes are to the center of structure.

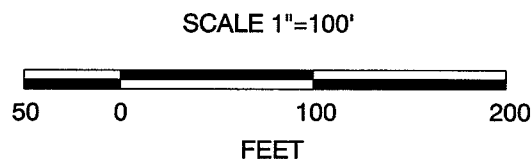

Remove inlet shown thus:

Abandon or remove pipe shown thus:

| Rev. No. | Description | Date | Engineer |
|----------|---------------------------------------|---------|--------------|
| 1 | Chgd notes: 8, 9, & 11, added note 26 | 1-12-09 | Chris Zelmer |

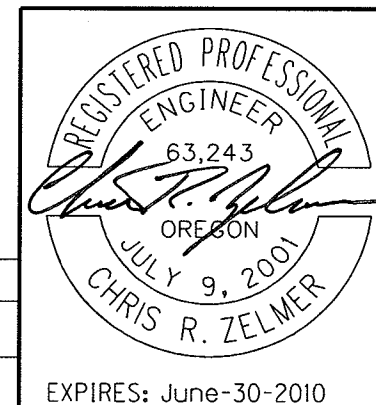

| | |
|------------------------------------------------------------------------------------------|------------------------|
| OREGON DEPARTMENT OF TRANSPORTATION | |
| REGION 3 - TECHNICAL CENTER | |
| OR 99/238 PAVING (GRANTS PASS) ROGUE RIVER/JACKSONVILLE HIGHWAY JOSEPHINE COUNTY | |
| Design Team Leader - Chris Zelmer Designed By - Bob Branch Drafted By - David Knox | |
| DRAINAGE AND UTILITIES | SHEET NO. 7B |

① Manhole & storm drain outfall by others

② Sta. "RR" 64+22.02, 39.57' Rt.
Const. type "G-2" inlet
Finish grade = 937.50
Flow line elev. = 935.26

③ Sta. "RR" 64+26.43, 26.13 ft. Rt.
Const. type "CG-3" inlet
Finish grade = 937.18
Flow line elev. = 935.19
Inst. 12" storm sew. pipe - 18'
5' depth

④ Sta. "RR" 65+63.74, 26.13' Rt.
Const. type "CG-3" inlet
Finish grade = 937.83
Flow line elev. = 935.17

⑤ Sta. "RR" 67+60.00, 26.13 ft. Rt.
Const. type "CG-3" inlet
Finish grade = 938.07
Flow line elev. = 935.48

⑥ Sta. "RR" 69+36.09, 26.13' Rt.
Const. type "CG-3" inlet
Finish grade = 938.29
Flow line elev. = 935.80
Inst. 12" storm sew. pipe - 24'
5' depth

⑦ Sta. "RR" 69+48.77, 42.16' Rt.
Const. type "G-2" inlet
Finish grade = 938.73
Flow line elev. = 935.89

⑧ Sta. "RR" 62+07.56, 26.13' Lt.
Inst. 24" storm sew. pipe - 28'
5' depth
Flow line In = 932.46
Flow line Out = 931.64
Conn. to extg. manhole

⑨ Sta. "RR" 62+34.64, 26.13' Lt.
Const. type "CG-3" inlet
Finish grade = 937.61
Flow line elev. = 932.46
Inst. 12" storm sew. pipe - 17'
5' depth
Inst. 24" storm sew. pipe - 140'
5' depth

⑩ Sta. "RR" 63+75.55, 40.81' Lt.
Const. type "G-2" inlet
Finish grade = 936.75
Flow line elev. = 934.97

⑪ Sta. "RR" 63+75.00, 26.13 ft. Lt.
Const. type "CG-3" inlet
Finish grade = 937.70
Flow line elev. = 933.20
Inst. 12" storm sew. pipe - 19'
5' depth, Class E backfill under roadway
Inst. 18" storm sew. pipe - 266'
5' depth
Trench resurfacing - 31 sq. yd.

⑫ Sta. "RR" 65+68.34, 45.27' Lt.
Const. type "G-2" inlet
Inst. 12" storm sew. pipe - 23'
5' depth
Finish grade = 938.18
Flow line elev. = 935.06

⑬ Sta. "RR" 65+71.00, 26.13' Lt.
Const. type "CG-3" inlet
Finish grade = 937.94
Flow line elev. = 933.82
Inst. 12" storm sew. pipe - 48'
5' depth, Class E backfill under roadway
Inst. 18" storm sew. pipe - 147'
5' depth
Trench resurfacing - 21 sq. yd.

⑭ Sta. "RR" 67+18.00, 26.13' Lt.
Const. type "CG-3" inlet
Finish grade = 938.09
Flow line elev. = 934.28
Inst. 12" storm sew. pipe - 63'
5' depth, Class E backfill under roadway
Inst. 18" storm sew. pipe - 206'
5' depth
Trench resurfacing - 28 sq. yd.

⑮ Sta. "RR" 67+24.51, 40.26' Lt.
Const. type "G-2" inlet
Inst. storms sew. pipe - 19'
5' depth
Finish grade = 937.35
Flow line elev. = 935.28

⑯ Sta. "RR" 68+72.24, 42.90' Lt.
Const. type "G-2" inlet
Finish grade = 938.26
Flow line elev. = 935.36
Inst. 12" storm sew. pipe - 21'
5' depth
Blind conn. to 18" storm sewer
(For details, see sht. 2B-3)

⑰ Sta. "RR" 69+24.00, 26.13' Lt.
Const. type "CG-3" inlet
Finish grade = 938.37
Flow line elev. = 934.93
Inst. 12" storm sew. pipe - 49'
5' depth, Class E backfill under roadway
Inst. 18" storm sew. pipe - 188'
5' depth
Trench resurfacing - 18 sq. yd.

⑱ Sta. "RR" 71+12.00, 26.13' Lt.
Const. type "CG-3" inlet
Finish grade = 938.51
Flow line elev. = 935.53
Inst. 12" storm sew. pipe - 84'
5' depth, Class E backfill under roadway
Inst. 18" storm sew. pipe - 129'
5' depth
Trench resurfacing - 24 sq. yd.

⑲ Cap inlet

⑳ Minor Adjustment of manhole - 6

㉑ Adjust box - 6

㉒ Sta. "RR" 63+58.18, 35.99' Rt.
Plug outlet on east side of inlet

㉓ Sta. "RR" 71+32.52, 45.27' Lt.
Const. type "G-2" inlet
Finish grade = 938.50
Flow line elev. = 936.15

㉔ Sta. "RR" 71+29.75, 39.17' Rt.
Const. type "G-2" inlet
Finish grade = 937.22
Flow line elev. = 935.85

㉕ Sta. "RR" 71+35.00, 26.13' Rt.
Const. type "CG-3" inlet
Finish grade = 938.49
Flow line elev. = 935.76
Inst. 12" storm sew. pipe - 23'
5' depth

㉖ Inst. 6" PVC Pre-plumbed Irrigation sleeve in common trench with storm drain (See landscape plan)

| Rev. No. | Description | Date | Engineer |
|----------|---------------------------------------|---------|--------------|
| ① | Chgd notes: 8, 9, & 11, Added note 26 | 1-12-09 | Chris Zelmer |

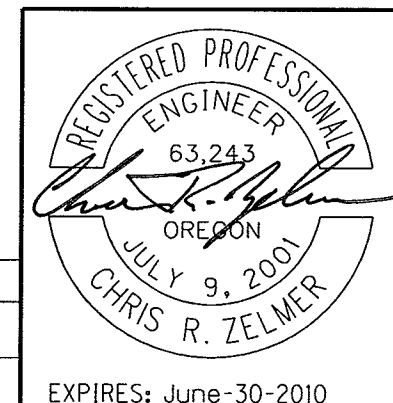

EXPIRES: June-30-2010

| | |
|------------------------------------------------------------------------------------------|-----------------|
| OREGON DEPARTMENT OF TRANSPORTATION | |
| REGION 3 - TECHNICAL CENTER | |
| OR 99/238 PAVING (GRANTS PASS) ROGUE RIVER/JACKSONVILLE HIGHWAY JOSEPHINE COUNTY | |
| Design Team Leader - Chris Zelmer Designed By - Bob Branch Drafted By - David Knox | |
| DRAINAGE AND UTILITIES | SHEET NO. 7C |

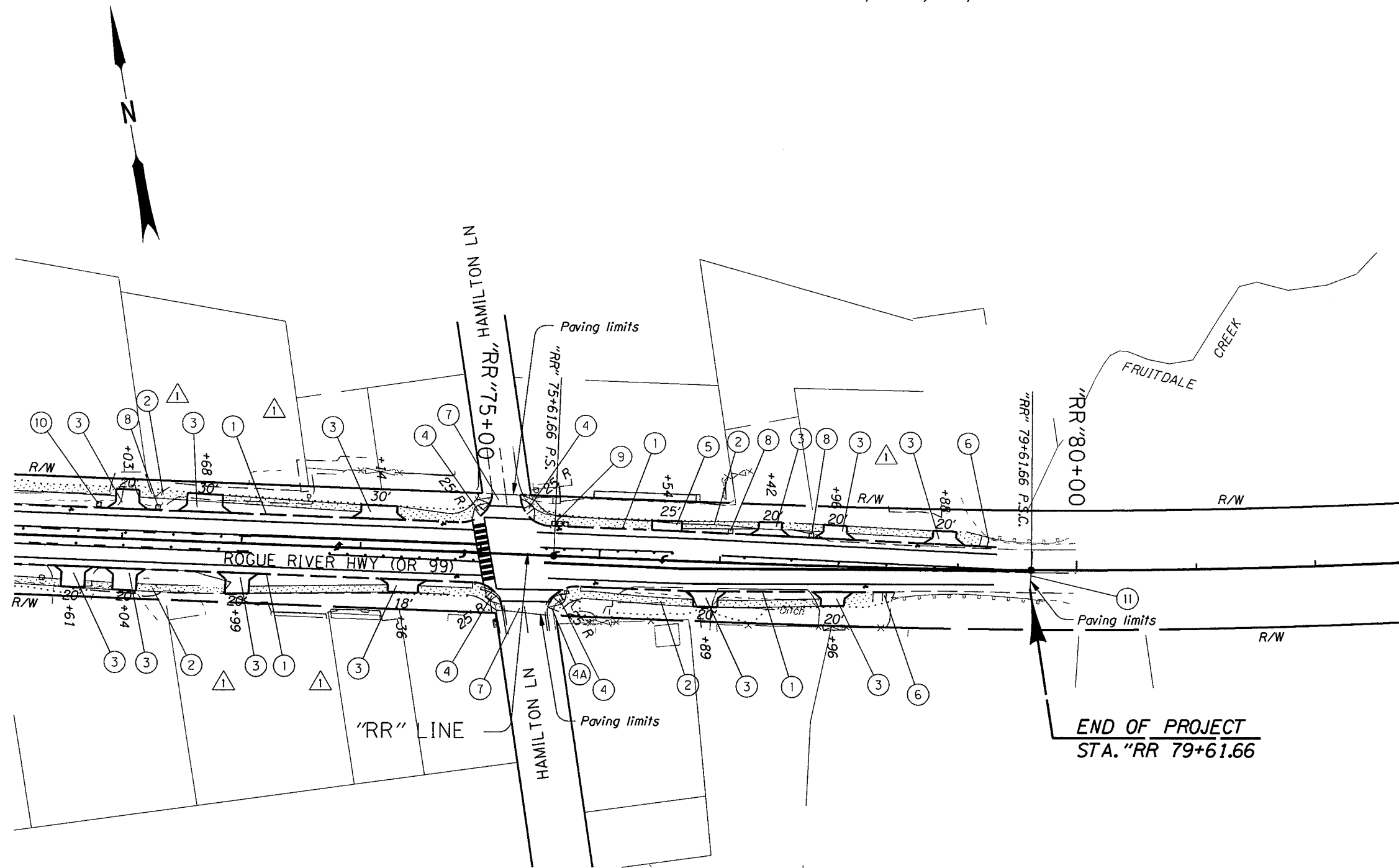

- ① Const. curb & gutter
2' gutter, E = 7"
- ② Const. P.C. conc. sidewalk
- ③ Const. P.C. conc. dwy., Option "C" - 12
- ④ Const. sidewalk ramp (perpendicular) - 4
- ④A Match extg. sidewalk
Protect extg. valve boxes
- ⑤ Const. P.C. conc. dwy., Option "G"
- ⑥ Const end of S.W. ramp - 2
(For details, see sht. 2B-2)
- ⑦ Taper grind street conn. - 2
(For details, see sht. 2B)
- ⑧ Const. multiple mailbox support - 2
- ⑨ Salvage & reinstall cluster box unit
(For details, see sht. 2B-6)
- ⑩ Const. single mailbox support
- ⑪ Const. asphalt conc. pavement match
(See drg. no. RD610)

END OF PROJECT
STA. "RR" 79+61.66

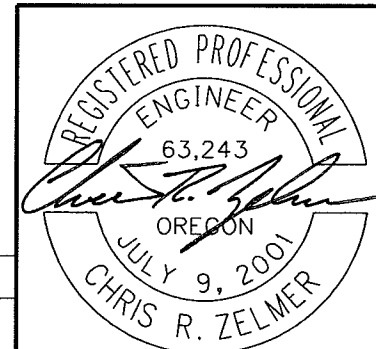
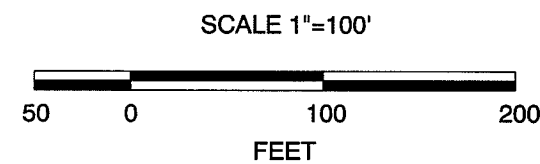

EXPIRES: June-30-2010

| Rev. No. | Description | Date | Engineer |
|----------|------------------------------|---------|--------------|
| ① | Remove extra note 11 bubbles | 1-12-09 | Chris Zelmer |

OREGON DEPARTMENT OF TRANSPORTATION

REGION 3 - TECHNICAL CENTER

OR 99/238 PAVING (GRANTS PASS)
ROGUE RIVER / JACKSONVILLE HIGHWAY
JOSEPHINE COUNTY

Design Team Leader - Chris Zelmer
Designed By - Bob Branch
Drafted By - David Knox

ALIGNMENT & GENERAL CONSTRUCTION

SHEET NO. **8**