



# Oregon

Theodore R. Kulongoski, Governor

Department of Transportation  
Technical Services  
Roadway Engineering Section  
355 Capitol Street NE, Room 222  
Salem, OR 97301-3871  
Telephone 503-986-3714  
FAX 503-986-3749

DATE: November 10, 2009

Addenda No. 6

TO: PLAN HOLDERS  
PREPARED BY: Shane Terwilliger P.L.S.  
Shane Terwilliger  
APPROVED BY: Edward Cantrell P.E.  
Edward Cantrell

SUBJECT: Region 2 Fish Passage (Bergsvik Creek) Section  
Necanicum Highway  
Clatsop County  
Grading, Drainage, Structures, & Paving Project  
(Bids to be opened and read November 19, 2009)

**The following changes are made to the Project Bid Booklet:**

1. COVER PAGE - The date on the Bid Booklet cover page is replaced with:  
  
NOVEMBER 19, 2009.
2. DESCRIPTION OF WORK page - The first paragraph under TIME AND PLACE OF RECEIVING BIDS is replaced with the following:

Bids for the work described above will be opened and read at the Oregon Department of Transportation, 455 Airport Road SE, Building E, Salem, Oregon, at 9:00 a.m. on the 19<sup>th</sup> day of November, 2009.

3. The following Quantity changes are made to the Project Bid Items:

Number	Item	Quantity	
		Original	New
0110	Matting	5,400	2,900
0160	Sediment Barrier	625	650
0210	General Excavation	3,000	1,400
0220	Stone Embankment	2,200	4,080
0240	Subgrade Geotextile	1,130	1,400
0370	Aggregate Base	1,600	1,310
0500	Topsoil	637	730

Make a copy of and use the new attached Bid Sheets. A Bid **not** including these new Bid Sheets **will be rejected as non-responsive.**

**The following changes are made to the Project Special Provisions:**

1. COVER PAGE - The date on the Special Provisions cover page is replaced with:  
  
NOVEMBER 19, 2009.
2. DESCRIPTION OF WORK page - The paragraph under TIME AND PLACE OF RECEIVING BIDS is replaced with the following:  
  
Bids for the work described above will be opened and read at the Oregon Department of Transportation, 455 Airport Road SE, Bldg. E, Salem, Oregon 97301-5348, at 9:00 a.m. on the 19th day of November, 2009.
3. Subsection 00120.05 Request for Solicitation Documents – Replace “October 2009” with “November 2009”.
4. Subsection **00330.16 (a) Requirements** - This subsection is added after subsection **00330.03**:

**00330.16 (a) Requirements** – Add the following:

All embankment material used within the roadway prism shall be stone embankment.

The top 12" of stone embankment placed beneath topsoil shall be mixed with native material obtained from on-site excavations. The mixture shall contain 30% - 50% of 1" - 0 materials. The material will be accepted visually, based on examination by the Engineer.

5. Subsection **00330.94 Embankment Basis Payment** - This subsection is replaced with the following subsection:

**00330.94 Embankment Basis Payment** - Add the following to the paragraph that begins “Item (b) includes.....”:

Item (b) also includes all materials, equipment, labor, and incidentals for mixing and placing the stone embankment/native material mixtures.

Delete the paragraph that begins "Excavation of unsuitable...".

**The following changes are made to the Project Plans:**

Plan sheets 1, 2, 2A-2, 3A, GA-1 are replaced with revised plan sheets 1, 2, 2A-2, 3A, GA-1.

These changes will be included in the Contract for this Project. It is understood that your Bid will be submitted accordingly.

Make copies of the new Bid Sheets to replace the Special Provisions Bid Schedule Sheets.

Region 2 Fish Passage (Bergsvik Creek) Section  
Necanicum Highway  
Clatsop County  
Grading, Drainage, Structures, & Paving Project  
(Bids to be opened and read November 19, 2009)

Addenda No.6

**Contractor Information:**

The following ftp site has been set up for this project to provide highway cross sections. These documents are for information only.

[ftp://ftp.odot.state.or.us/web\\_docs/Region\\_2\\_Fish\\_Passage\(Bergsvik\\_Cr\)/](ftp://ftp.odot.state.or.us/web_docs/Region_2_Fish_Passage(Bergsvik_Cr)/)

Attachments: New Bid Sheets  
Revised Plan Sheets

BID SCHEDULE

CONTRACT ID: 14121

PROJECT: REGION 2 FISH PASSAGE (BERGSVIK CREEK)

PROJECT KEY: 13809

ADDENDUM NUMBER: 6

ITEM NO	ITEM DESCRIPTION	QUANTITY AND UNITS	UNIT PRICE (IN FIGURES)	BID AMOUNT (IN FIGURES)
---------	------------------	--------------------	----------------------------	----------------------------

SECTION 0001 TEMPORARY FEATURES AND APPURTENANCES

0010	0210-0100000A MOBILIZATION	LS	ALL	
0020	0225-0100000A TEMPORARY PROTECTION AND DIRECTION OF TRAFFIC	LS	ALL	
0030	0225-0102000J TEMPORARY SIGNS	SQFT	550.00	
0040	0225-0105000E TEMPORARY BARRICADES, TYPE III	EACH	8.00	
0050	0225-0145000E TEMPORARY PLASTIC DRUMS	EACH	35.00	
0060	0225-0149000E TEMPORARY FLEXIBLE PAVEMENT MARKERS	EACH	400.00	
0070	0225-0164000E PORTABLE CHANGEABLE MESSAGE SIGNS	EACH	3.00	
0080	0225-0168000T FLAGGERS	HOUR	400.00	
0090	0240-0100000A TEMPORARY DRAINAGE FACILITIES	LS	ALL	
0100	0280-0100000A EROSION CONTROL	LS	ALL	
0110	0280-0105000J MATTING	SQYD	2,900.00	
0120	0280-0106000E CHECK DAM	EACH	20.00	

BID SCHEDULE

CONTRACT ID: 14121

PROJECT: REGION 2 FISH PASSAGE (BERGSVIK CREEK)

PROJECT KEY: 13809

ADDENDUM NUMBER: 6

ITEM NO	ITEM DESCRIPTION	QUANTITY AND UNITS	UNIT PRICE (IN FIGURES)	BID AMOUNT (IN FIGURES)
0130	0280-0110000E CONSTRUCTION ENTRANCE	EACH 1.00		
0140	0280-0112000F SEDIMENT FENCE, SUPPORTED	FOOT 25.00		
0150	0280-0113000F SEDIMENT FENCE, UNSUPPORTED	FOOT 900.00		
0160	0280-0115000F SEDIMENT BARRIER	FOOT 650.00		
0170	0290-0100000A POLLUTION CONTROL PLAN	LS ALL		

SECTION 0002 ROADWORK

0180	0305-0100000A CONSTRUCTION SURVEY WORK	LS ALL		
0190	0310-0106000A REMOVAL OF STRUCTURES AND OBSTRUCTIONS	LS ALL		
0200	0320-0100000A CLEARING AND GRUBBING	LS ALL		
0210	0330-0105000K GENERAL EXCAVATION	CUYD 1,400.00		
0220	0330-0126000K STONE EMBANKMENT	CUYD 4,080.00		
0230	0331-0106000J 12 INCH SUBGRADE STABILIZATION	SQYD 300.00		
0240	0350-0105000J SUBGRADE GEOTEXTILE	SQYD 1,400.00		

BID SCHEDULE

CONTRACT ID: 14121

PROJECT: REGION 2 FISH PASSAGE (BERGSVIK CREEK)

PROJECT KEY: 13809

ADDENDUM NUMBER: 6

ITEM NO	ITEM DESCRIPTION	QUANTITY AND UNITS	UNIT PRICE (IN FIGURES)	BID AMOUNT (IN FIGURES)
0250	0390-0108000K LOOSE RIPRAP, CLASS 100	1.00 CUYD		

SECTION 0003 DRAINAGE AND SEWERS

0260	0430-0100120F 12 INCH DRAIN PIPE	90.00 FOOT		
0270	0445-010012AF 12 INCH CULVERT PIPE, 5 FT DEPTH	40.00 FOOT		
0280	0445-010018AF 18 INCH CULVERT PIPE, 5 FT DEPTH	48.00 FOOT		
0290	0480-0100000F DRAINAGE CURBS	290.00 FOOT		
0300	0495-0100000J TRENCH RESURFACING	17.00 SQYD		

SECTION 0004 BRIDGES

0310	0510-0100000A SHORING, CRIBBING AND COFFERDAMS	ALL LS		
0320	0510-0101000A STRUCTURE EXCAVATION	ALL LS		
0330	0510-0108000A GRANULAR STRUCTURE BACKFILL	ALL LS		
0340	0595-0100000F REINFORCED CONCRETE BOX CULVERTS	124.00 FOOT		
0350	0595-0102000A WINGWALLS AND APRONS	ALL LS		

SECTION 0005 BASES

BID SCHEDULE

CONTRACT ID: 14121

PROJECT: REGION 2 FISH PASSAGE (BERGSVIK CREEK)

PROJECT KEY: 13809

ADDENDUM NUMBER: 6

ITEM NO	ITEM DESCRIPTION	QUANTITY AND UNITS	UNIT PRICE (IN FIGURES)	BID AMOUNT (IN FIGURES)
0360	0620-0104000J COLD PLANE PAVEMENT REMOVAL, 0 - 2 INCHES DEEP	SQYD 490.00		
0370	0641-0102000M AGGREGATE BASE	TON 1,310.00		

SECTION 0006 WEARING SURFACES

0380	0744-0302000M LEVEL 3, 1/2 INCH DENSE MHMAC MIXTURE	TON 520.00		
0390	0744-0331000M LEVEL 3, 1/2 INCH DENSE MHMAC MIXTURE IN LEVELING	TON 12.00		
0400	0749-0100000E EXTRA FOR ASPHALT APPROACHES	EACH 4.00		

SECTION 0007 PERMANENT TRAFFIC SAFETY AND GUIDANCE DEVICES

0410	0810-0104000F GUARDRAIL, TYPE 2A	FOOT 538.00		
0420	0810-0120000E GUARDRAIL ANCHORS, TYPE 1 MODIFIED	EACH 1.00		
0430	0810-0130000E GUARDRAIL TERMINALS, FLARED	EACH 3.00		
0440	0860-0200000F LONGITUDINAL PAVEMENT MARKINGS - PAINT	FOOT 1,550.00		

SECTION 0008 RIGHT-OF-WAY DEVELOPMENT AND CONTROL

0450	1030-0102000E SEEDING MOBILIZATION	EACH 1.00		
------	---------------------------------------	-----------	--	--

BID SCHEDULE

CONTRACT ID: 14121

PROJECT: REGION 2 FISH PASSAGE (BERGSVIK CREEK)

PROJECT KEY: 13809

ADDENDUM NUMBER: 6

ITEM NO	ITEM DESCRIPTION	QUANTITY AND UNITS	UNIT PRICE (IN FIGURES)	BID AMOUNT (IN FIGURES)
0460	0000-0100000A DELETED BID ITEM	LS ALL	0.00	0.00
0470	1030-0108000R PERMANENT SEEDING	ACRE 1.10		
0480	1030-0128000R NATIVE PLANT SEEDING	ACRE 1.10		
0490	1030-0140000R MULCHING	ACRE 1.10		
0500	1040-0101000K TOPSOIL	CUYD 730.00		
0510	1040-0154000E SHRUBS, NO. 2 CONTAINER	EACH 5.00		
0520	1040-0155000E SHRUBS, NO. 3 CONTAINER	EACH 11.00		
0530	1040-0156000E SHRUBS, NO. 5 CONTAINER	EACH 1.00		
0540	1040-0190000K BARK MULCH	CUYD 2.00		
0550	1091-0100000A STREAMBED ENHANCEMENT	LS ALL		
	TOTAL BID			

INDEX OF SHEETS	
SHEET NO.	DESCRIPTION
1	Title Sheet
1A	Index Of Sheets Cont'd. & Std. Drg. Nos.

STATE OF OREGON  
 DEPARTMENT OF TRANSPORTATION  
 PLANS FOR PROPOSED PROJECT  
**GRADING, DRAINAGE, STRUCTURES & PAVING**  
**REGION 2 FISH PASSAGE**  
**(BERGSVIK CREEK) SEC.**  
**NECANICUM HIGHWAY**  
**CLATSOP COUNTY**  
**NOVEMBER 2009**

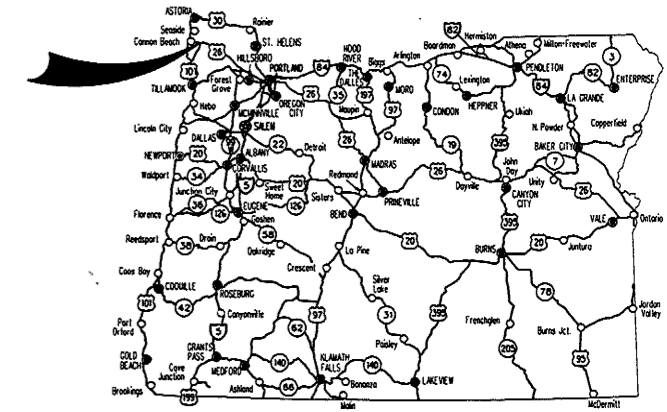

Overall Length Of Project - 0.1 Miles

**ATTENTION:**  
 Oregon Law Requires You To Follow Rules Adopted By The Oregon Utility Notification Center. Those Rules Are Set Forth In OAR 952-001-0010 Through OAR 952-001-0090. You May Obtain Copies Of The Rules By Calling The Center. (Note: The Telephone Number For The Oregon Utility Center Is (503) 232-1987.)



**OREGON TRANSPORTATION COMMISSION**

- |                    |                            |
|--------------------|----------------------------|
| Gail Achterman     | CHAIR                      |
| Michael Nelson     | VICE-CHAIR                 |
| Janice Wilson      | COMMISSIONER               |
| Alan Brown         | COMMISSIONER               |
| David Lohman       | COMMISSIONER               |
| Matthew L. Garrett | DIRECTOR OF TRANSPORTATION |

These plans were developed using ODOT design standards. Exceptions to these standards, if any, have been submitted and approved by the ODOT Chief Engineer or their delegated authority.

By: Sonny P.A. Chickering 11-12-09  
 Signature & date

Sonny Chickering - R2 Tech Center Manager  
 Print name and title

Sonny  
 Concurrence by ODOT Chief Engineer

**REGION 2 FISH PASSAGE**  
**(BERGSVIK CREEK) SEC.**  
**NECANICUM HIGHWAY**  
**CLATSOP COUNTY**

FEDERAL HIGHWAY ADMINISTRATION	PROJECT NUMBER	SHEET NO.
OREGON DIVISION	X-STP-S046(004)	1

**BEGINNING OF PROJECT**  
**X-STP-S046(004)**  
**STA. "L"801+91.79 (M.P. 2.17)**

**END OF PROJECT**  
**X-STP-S046(004)**  
**STA. "L"807+52.12 (M.P. 2.28)**

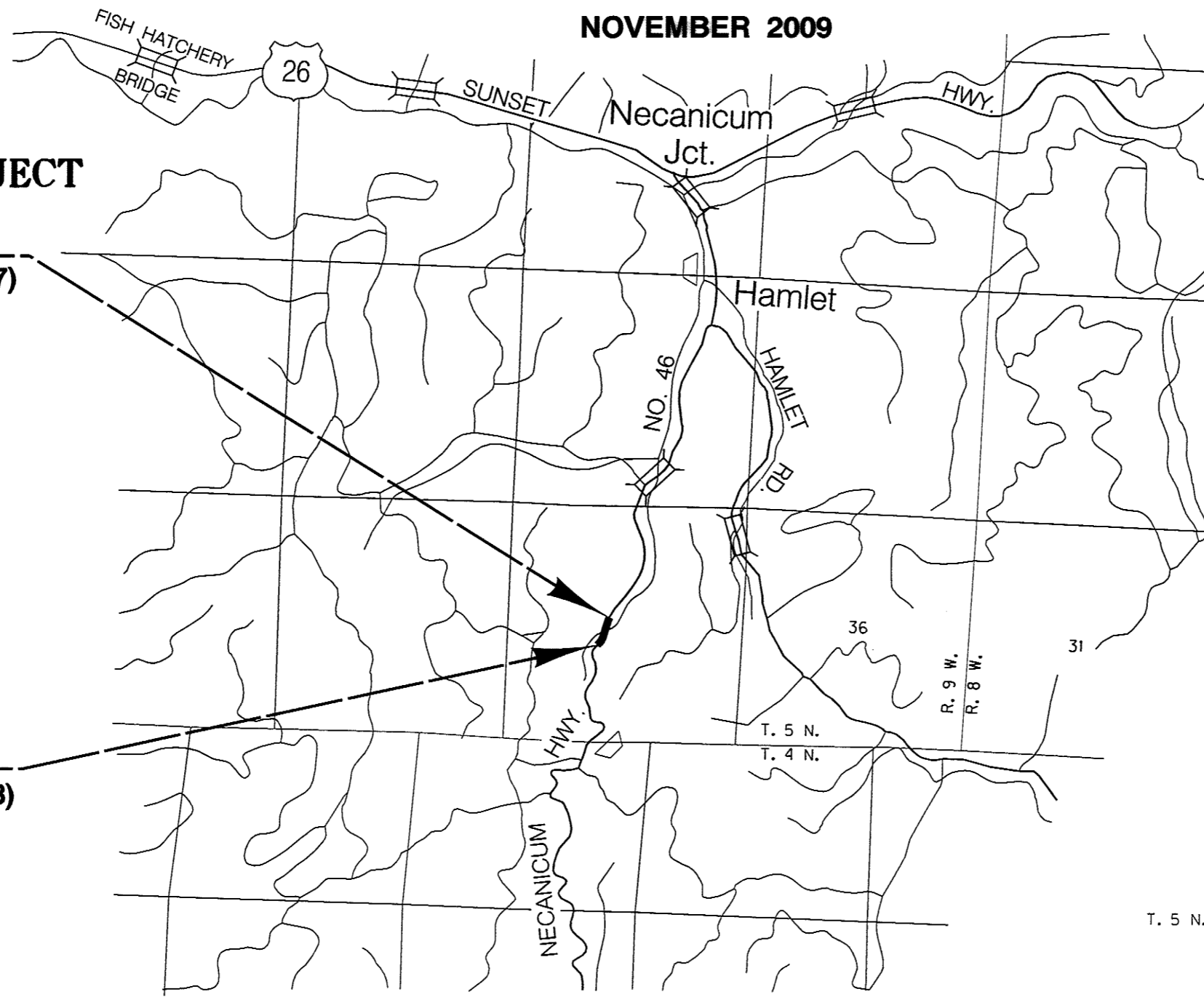

T. 5 N., R. 9 W., W.M.



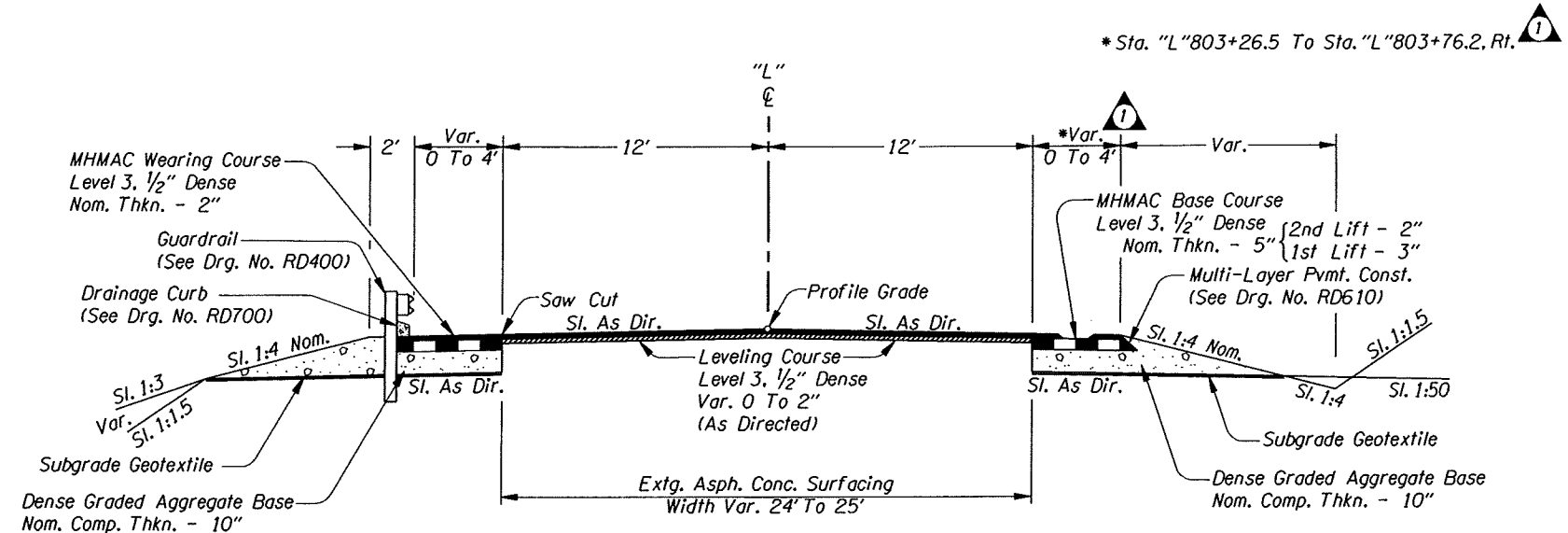

STA. "L"801+91.79 To STA. "L"803+70.20 (Taper Section)  
 "L"806+57.20 To "L"807+52.12 (Taper Section)

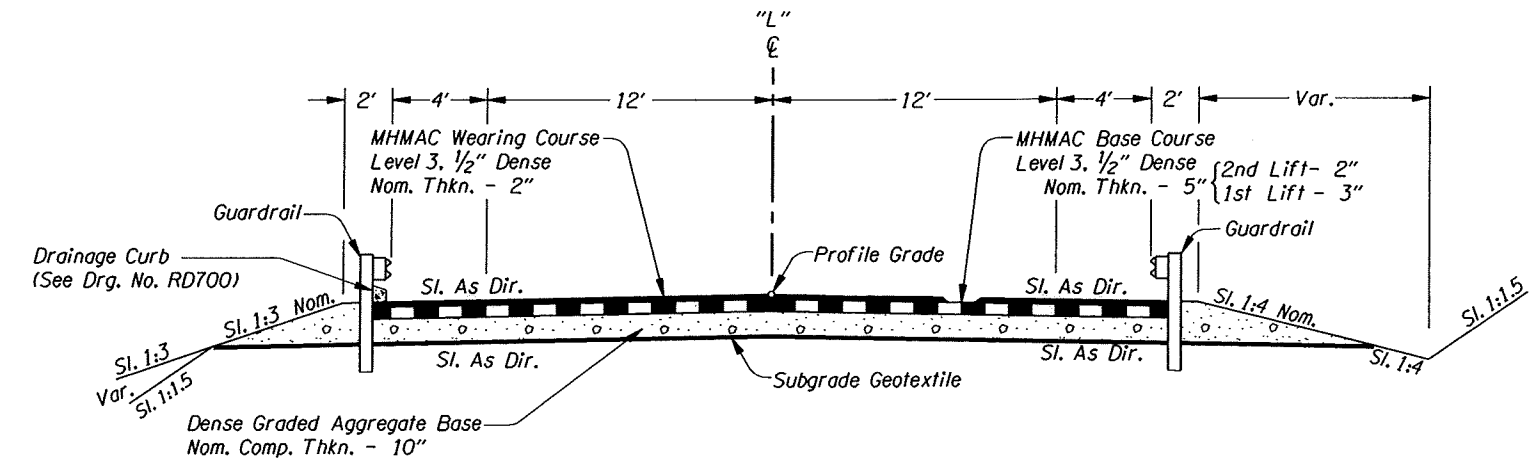

"L"803+70.20 To STA "L"806+57.20

11-9-09 Modified elevation

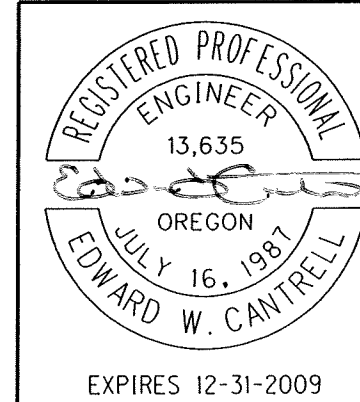

OREGON DEPARTMENT OF TRANSPORTATION	
REGION 2 TECH CENTER	
REGION 2 FISH PASSAGE (BERGSVIK CREEK) SEC. NECANICUM HIGHWAY CLATSOP COUNTY	
Design Team Leader - Carol Cartwright Designed By - Lee Kim Drafted By - M. Skelton/K. Wright-Bayless	
TYPICAL SECTIONS	SHEET NO. 2

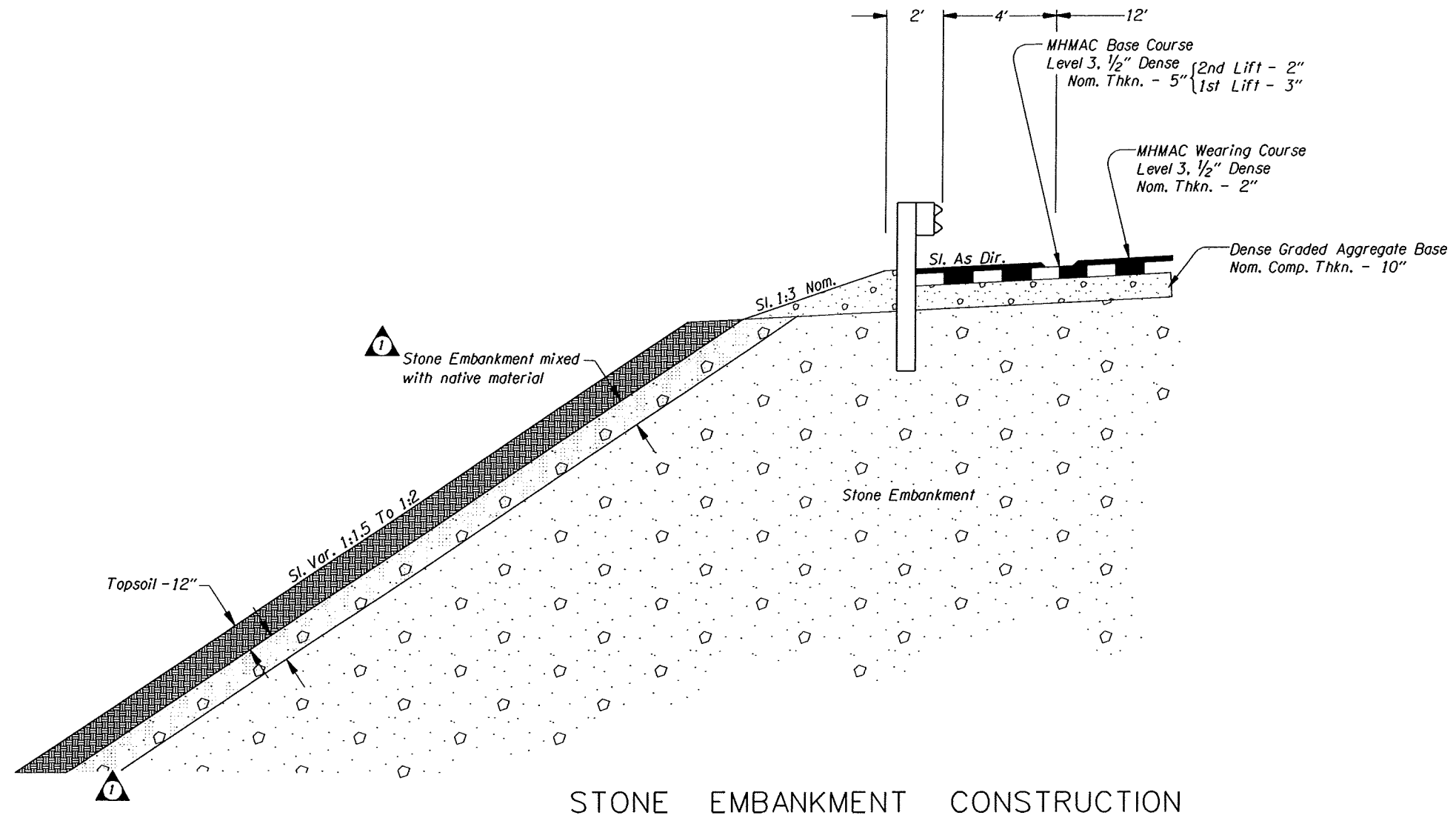

11-9-09 Modified detail

**OREGON DEPARTMENT OF TRANSPORTATION**

**REGION 2 TECH CENTER**

**REGION 2 FISH PASSAGE  
(BERGSVIK CREEK) SEC.  
NECANICUM HIGHWAY  
CLATSOP COUNTY**

Design Team Leader - Carol Cartwright  
Designed By - Lee Kim  
Drafted By - M. Skelton/K. Wright-Bayless

**DETAILS**

SHEET NO.  
**2A-2**

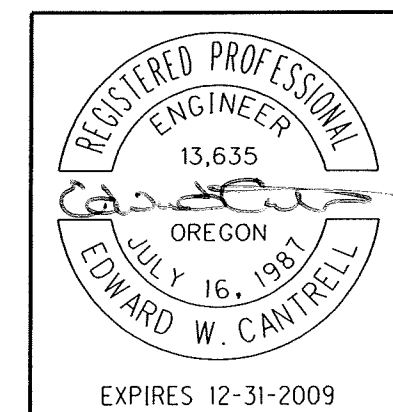

"L" LINE

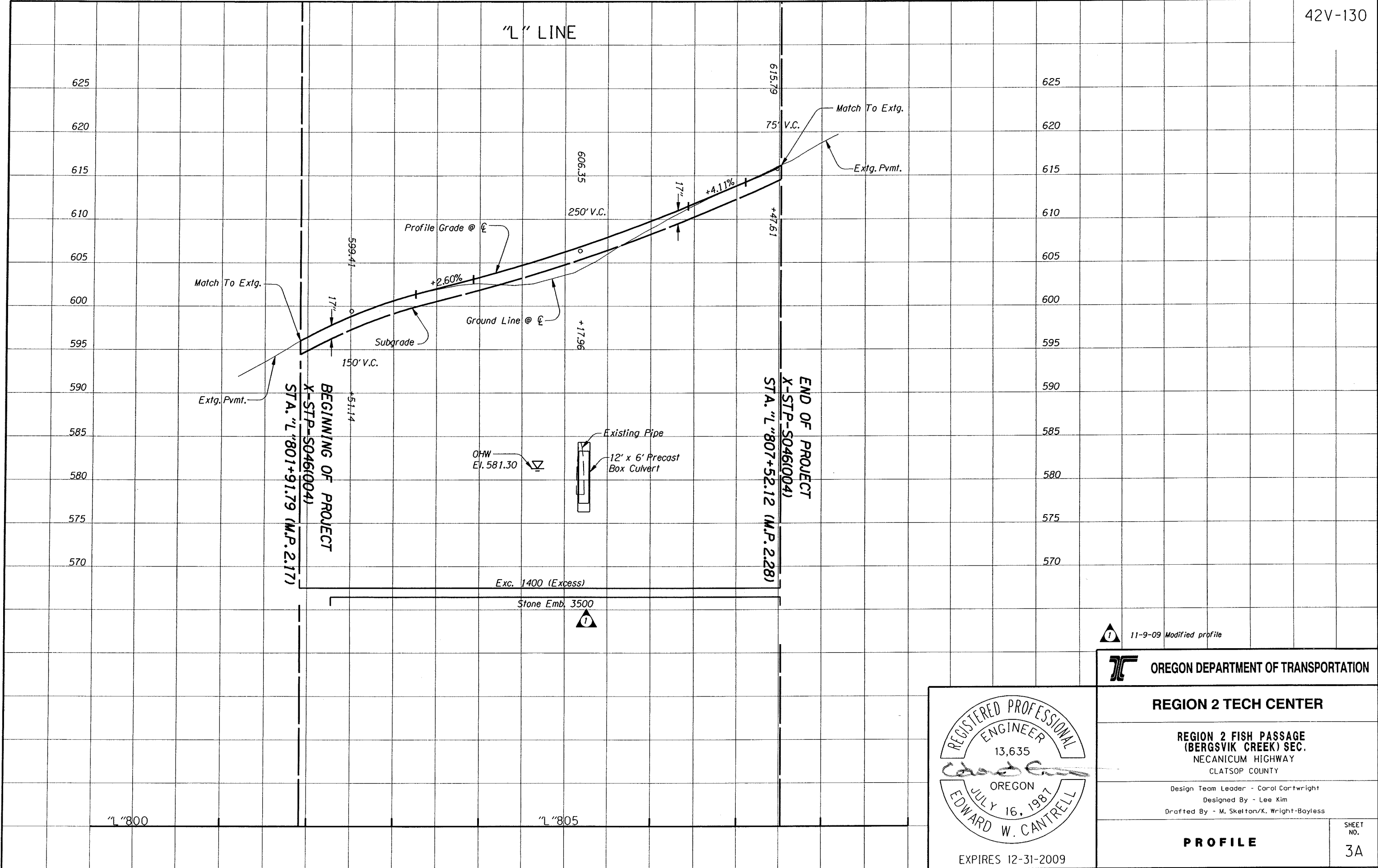

11-9-09 Modified profile

**OREGON DEPARTMENT OF TRANSPORTATION**

**REGION 2 TECH CENTER**

**REGION 2 FISH PASSAGE  
(BERGSVIK CREEK) SEC.  
NECANICUM HIGHWAY  
CLATSOP COUNTY**

Design Team Leader - Carol Cartwright  
Designed By - Lee Kim  
Drafted By - M. Skelton/K. Wright-Bayless

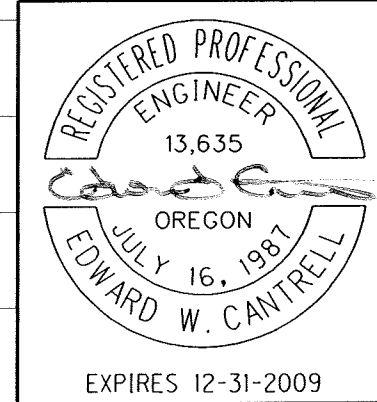

**PROFILE**

SHEET NO.  
**3A**

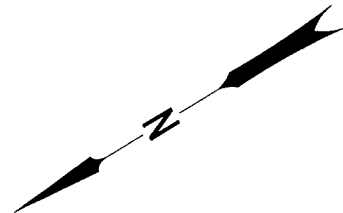

STRUCTURAL DETAILS CHECKED

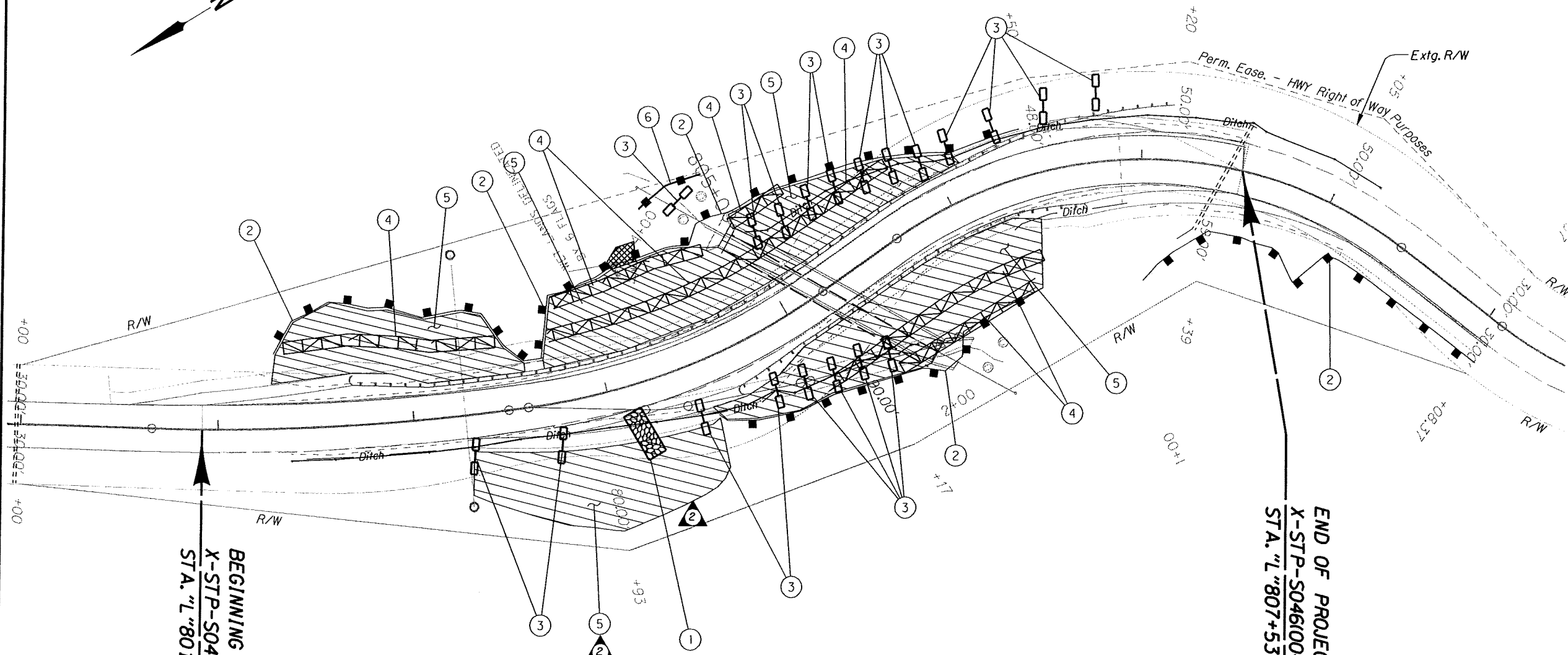

- ① Const. Construction Entrance  
(See Drg. No. RD1000)
- ② Const. Sediment Fence  
Unsupported  
(See Drg. No. RD1040)
- ③ Const. Check Dam  
(See Drg. No. RD1005)
- ④ Install Sediment Barrier  
(Type 3, Straw Wattle) **1**  
(See Drg. No. RD1035)
- ⑤ Install Matting  
(Erosion Control)  
(See Drg. No. RD1055)
- ⑥ Const. Sediment Fence  
Supported  
(See Drg. No. RD1040)

LEGEND

- Fill slope
- Cut slope
- Sediment Fence, Unsupported
- Check Dam In Ditch Section
- ▭ Sediment Barrier
- ▨ Construction Entrance
- ▩ Erosion Control Matting
- Sediment Fence, Supported
- ▧ Wetland and No Work Area

- 1** 9-28-09 Added detail, note and modified note
- 2** 11-9-09 Added matting area

GENERAL NOTES:

The construction, adjustment, maintenance, and upgrading of these Erosion Control measures is the responsibility of the contractor for the duration of the project.

Erosion Control measures shown on this plan are for anticipated site conditions. Adjust or upgrade these measures for unexpected storm events to ensure that sediment and sediment-laden water does not leave the site.

Develop a revised plan of the Erosion Control measures shown as required by Section 00280, Oregon Standard Specifications for Construction. Implement this plan for all clearing and grading activities and in segments applicable to each staging phase. Construct in such a manner so as to ensure that sediment and sediment-laden water does not enter the roadway or drainage system, or violate applicable water standards.

Install measures within the right-of-way unless directed otherwise.

Install stabilized construction entrances at the beginning of construction and maintain for the duration of the project. Additional measures may be required to insure that all paved areas are kept clean.

Construct sediment fence 5 feet downslope from the toe of fill slopes where sediment-laden water has a potential of entering waterways or leaving the R/W.

Protect all inlets during surface grinding, paving, and earthwork operations to prevent pollutants from entering storm water systems.

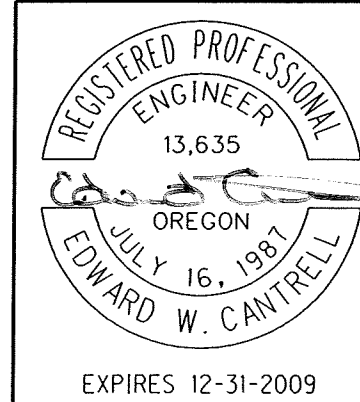

<b>OREGON DEPARTMENT OF TRANSPORTATION</b>	
<b>REGION 2 TECH CENTER</b>	
REGION 2 FISH PASSAGE (BERGSVIK CREEK) SEC. NECANICUM HIGHWAY CLATSOP COUNTY	
Design Team Leader - Carol Cortwright Designed By - Lee Kim Drafted By - Michael Skelton	
<b>EROSION CONTROL PLAN</b>	SHEET NO. <b>GA-1</b>