



Oregon

Theodore R. Kulungoski, Governor

Department of Transportation
Technical Services
Roadway Engineering Section
355 Capitol Street NE, Room 222
Salem, OR 97301-3871
Telephone 503-986-3714
FAX 503-986-3749

DATE: April 9, 2009

Addenda No. 3

TO: PLAN HOLDERS

PREPARED BY: Christy R. Dute

APPROVED BY: Jan P. Ruff P.E.

SUBJECT: US101: Bethel Cr – Crystal Cr Paving
Oregon Coast Highway
Coos County & Curry County
Paving Project
(Bids to be opened and read April 16, 2009)

The following changes are made to the Project Bid Booklet:

1. The following changes are made to the Project Bid Items:

a. Quantity changes:

<u>Number</u>	<u>Item</u>	<u>Quantity</u>	
		<u>Original</u>	<u>New</u>
0060	TEMPORARY FLEXIBLE PAVEMENT MARKERS	24,130.00	28,110.00
0090	FLAGGERS	2,770.00	3,226.00
0100	TRAFFIC CONTROL SUPERVISOR	45.00	52.00
0180	PREPARATION OF SHOULDERS	9.70	11.30
0250	COLD PLANE PAVEMENT REMOVAL, 2 INCHES DEEP	216,412.44	246,493.44
0270	EMULSIFIED ASPHALT FOR TACK COAT	62.00	70.70
0280	LEVEL 3, 1/2 INCH DENSE LIME TREATED HMAC	33,162.40	36,786.99
0300	PG 64-22 ASPHALT IN HMAC	1,993.60	2,193.08
0330	GUARDRAIL, TYPE 2A	3,987.50	4,587.50
0370	GUARDRAIL TERMINALS, FLARED	1.00	2.00
0380	EXTRA FOR 8 FOOT POSTS	64.00	84.00
0410	BI-DIRECTIONAL YELLOW TYPE 1 MARKERS	1,509.00	1,805.00
0420	THERMOPLASTIC, WET WEATHER PATTERN, EXTRUDED	210,676.00	240,244.00

Make a copy of and use the new attached Bid Sheets. A Bid **not** including these new Bid Sheets **will be rejected as non-responsive.**

US101: Bethel Cr – Crystal Cr Paving
Oregon Coast Highway
Coos County & Curry County
Paving Project
(Bids to be opened and read April 16, 2009)

Addenda No. 3

The following changes are made to the Project Special Provisions:

1. SPECIAL PROVISIONS page - The first paragraph under WORK TO BE DONE is replaced with the following:

The Work to be done under this Contract consists of the following on the US101: Bethel Cr – Crystal Cr Paving Section of the Oregon Coast Highway between MP 282.76 and 294.95 in Coos and Curry Counties:

2. Subsection 00195.11(d) Fuel Price Adjustment - The paragraph that begins with the words "Fuel requirements for..." is replaced with the following:

Fuel requirements for constructing the Project have been estimated at 117,826.00 gallons, based on fuel factors shown.

The following changes are made to the Project Plans:

1. Plan sheets 1, 2, 2B-2, and 2B-8 are replaced with revised plan sheets 1, 2, 2B-2, and 2B-8.

These changes will be included in the Contract for this Project. It is understood that your Bid will be submitted accordingly.

Make copies of the new Bid Sheets to replace the Special Provisions Bid Schedule Sheets.

_____:_____

Attachments: New Bid Sheets
Revised Plan Sheets

BID SCHEDULE

CONTRACT ID: 14009

PROJECT: US101: BETHEL CR - CRYSTAL CR
PAVING

PROJECT KEY: 15012

ADDENDUM NUMBER: 3

ITEM NO	ITEM DESCRIPTION	QUANTITY AND UNITS	UNIT PRICE (IN FIGURES)	BID AMOUNT (IN FIGURES)
SECTION 0001 TEMPORARY FEATURES AND APPURTENANCES				
0010	0210-0100000A MOBILIZATION	LS	ALL	
0020	0225-0100000A TEMPORARY PROTECTION AND DIRECTION OF TRAFFIC	LS	ALL	
0030	0225-0102000J TEMPORARY SIGNS	SQFT	620.00	
0040	0225-0105000E TEMPORARY BARRICADES, TYPE III	EACH	6.00	
0050	0225-0145000E TEMPORARY PLASTIC DRUMS	EACH	55.00	
0060	0225-0149000E TEMPORARY FLEXIBLE PAVEMENT MARKERS	EACH	28,110.00	
0070	0225-0162000E SEQUENTIAL ARROW SIGNS	EACH	2.00	
0080	0225-0164000E PORTABLE CHANGEABLE MESSAGE SIGNS	EACH	2.00	
0090	0225-0168000T FLAGGERS	HOUR	3,226.00	
0100	0225-0169000E TRAFFIC CONTROL SUPERVISOR	EACH	52.00	
0110	0225-0172000T PILOT CARS	HOUR	500.00	
0120	0280-0100000A EROSION CONTROL	LS	ALL	

BID SCHEDULE

CONTRACT ID: 14009

PROJECT: US101: BETHEL CR - CRYSTAL CR
PAVING

PROJECT KEY: 15012

ADDENDUM NUMBER: 3

ITEM NO	ITEM DESCRIPTION	QUANTITY AND UNITS	UNIT PRICE (IN FIGURES)	BID AMOUNT (IN FIGURES)
0130	0280-0114000E INLET PROTECTION	EACH 3.00		
0140	0290-0100000A POLLUTION CONTROL PLAN	LS ALL		

SECTION 0002 ROADWORK

0150	0305-0100000A CONSTRUCTION SURVEY WORK	LS ALL		
0160	0310-0101000F REMOVAL OF CURBS	FOOT 422.00		
0170	0310-0113000A REMOVAL OF GUARDRAIL	LS ALL		
0180	0334-0100000L PREPARATION OF SHOULDERS	MILE 11.30		

SECTION 0003 DRAINAGE AND SEWERS

0190	0480-0100000F DRAINAGE CURBS	FOOT 422.00		
0200	0490-0105000E ADJUSTING INLETS	EACH 3.00		

SECTION 0004 BRIDGES (BR00912)

0210	0503-0101000J BRIDGE DECK COLD PLANE PAVEMENT REMOVAL, 0-2 INCHES DEEP	SQYD 54.00		
------	---	------------	--	--

SECTION 0005 BRIDGES (BR00910A)

BID SCHEDULE

CONTRACT ID: 14009

PROJECT: US101: BETHEL CR - CRYSTAL CR
PAVING

PROJECT KEY: 15012

ADDENDUM NUMBER: 3

ITEM NO	ITEM DESCRIPTION	QUANTITY AND UNITS	UNIT PRICE (IN FIGURES)	BID AMOUNT (IN FIGURES)
0220	0503-0101000J BRIDGE DECK COLD PLANE PAVEMENT REMOVAL, 0-2 INCHES DEEP	SQYD 458.00		

SECTION 0006 BASES

0230	0620-0104000J COLD PLANE PAVEMENT REMOVAL, 0 - 2 INCHES DEEP	SQYD 1,088.90		
0240	0620-0112000J COLD PLANE PAVEMENT REMOVAL, 2 - 4 INCHES DEEP	SQYD 489.00		
0250	0620-0120000J COLD PLANE PAVEMENT REMOVAL, 2 INCHES DEEP	SQYD 246,493.44		
0260	0640-0101000M AGGREGATE SHOULDERS	TON 1,000.00		

SECTION 0007 WEARING SURFACES

0270	0730-0100000M EMULSIFIED ASPHALT FOR TACK COAT	TON 70.70		
0280	0745-0322000M LEVEL 3, 1/2 INCH DENSE LIME TREATED HMA	TON 36,786.99		
0290	0745-0334000M LEVEL 3, 1/2 INCH DENSE LIME TREATED HMA IN LEVELING	TON 33.00		
0300	0745-0620000M PG 64-22 ASPHALT IN HMA	TON 2,193.08		
0310	0748-0120000J 37 INCH ASPHALT CONCRETE PAVEMENT REPAIR	SQYD 360.00		

BID SCHEDULE

CONTRACT ID: 14009

PROJECT: US101: BETHEL CR - CRYSTAL CR
PAVING

PROJECT KEY: 15012

ADDENDUM NUMBER: 3

ITEM NO	ITEM DESCRIPTION	QUANTITY AND UNITS	UNIT PRICE (IN FIGURES)	BID AMOUNT (IN FIGURES)
0320	0749-0100000E EXTRA FOR ASPHALT APPROACHES	18.00 EACH		

SECTION 0008 PERMANENT TRAFFIC SAFETY AND GUIDANCE DEVICES

0330	0810-0104000F GUARDRAIL, TYPE 2A	4,587.50 FOOT		
0340	0810-0107000F GUARDRAIL, TYPE 3	50.00 FOOT		
0350	0810-0126000E GUARDRAIL TRANSITION	6.00 EACH		
0360	0810-0129000E GUARDRAIL TERMINALS, NON-FLARED	9.00 EACH		
0370	0810-0130000E GUARDRAIL TERMINALS, FLARED	2.00 EACH		
0380	0810-0133000E EXTRA FOR 8 FOOT POSTS	84.00 EACH		
0390	0812-0101000F ADJUSTING GUARDRAIL	1,112.50 FOOT		
0400	0855-0100000E MONO-DIRECTIONAL WHITE TYPE 1 MARKERS	342.00 EACH		
0410	0855-0102000E BI-DIRECTIONAL YELLOW TYPE 1 MARKERS	1,805.00 EACH		
0420	0865-0114000F THERMOPLASTIC, WET WEATHER PATTERN, EXTRUDED	240,244.00 FOOT		
0430	0865-9Z90000E NO PASSING ZONE PADDLE MARKERS	50.00 EACH		

BID SCHEDULE

CONTRACT ID: 14009

PROJECT: US101: BETHEL CR - CRYSTAL CR
PAVING

PROJECT KEY: 15012

ADDENDUM NUMBER: 3

ITEM NO	ITEM DESCRIPTION	QUANTITY AND UNITS	UNIT PRICE (IN FIGURES)	BID AMOUNT (IN FIGURES)
0440	0867-0103000E PAVEMENT LEGEND, TYPE B: ARROWS	2.00 EACH		
0450	0867-0145000J PAVEMENT BAR, TYPE B	420.00 SQFT		
TOTAL BID				

INDEX OF SHEETS

SHEET NO.	DESCRIPTION
1	Title Sheet
1A	Index Of Sheets Cont'd. & Std. Dwg. Nos.

STATE OF OREGON
DEPARTMENT OF TRANSPORTATION
 PLANS FOR PROPOSED PROJECT
PAVING

42V-83

US101: BETHEL CR - CRYSTAL CR PAVING

OREGON COAST HIGHWAY
 COOS COUNTY & CURRY COUNTY
 APRIL 2008

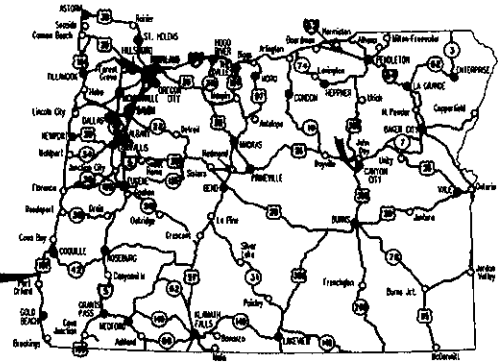

Overall Length Of Project - 12.19 Miles

BEGINNING OF PROJECT X-NH-0009(337)
 MP 282.76

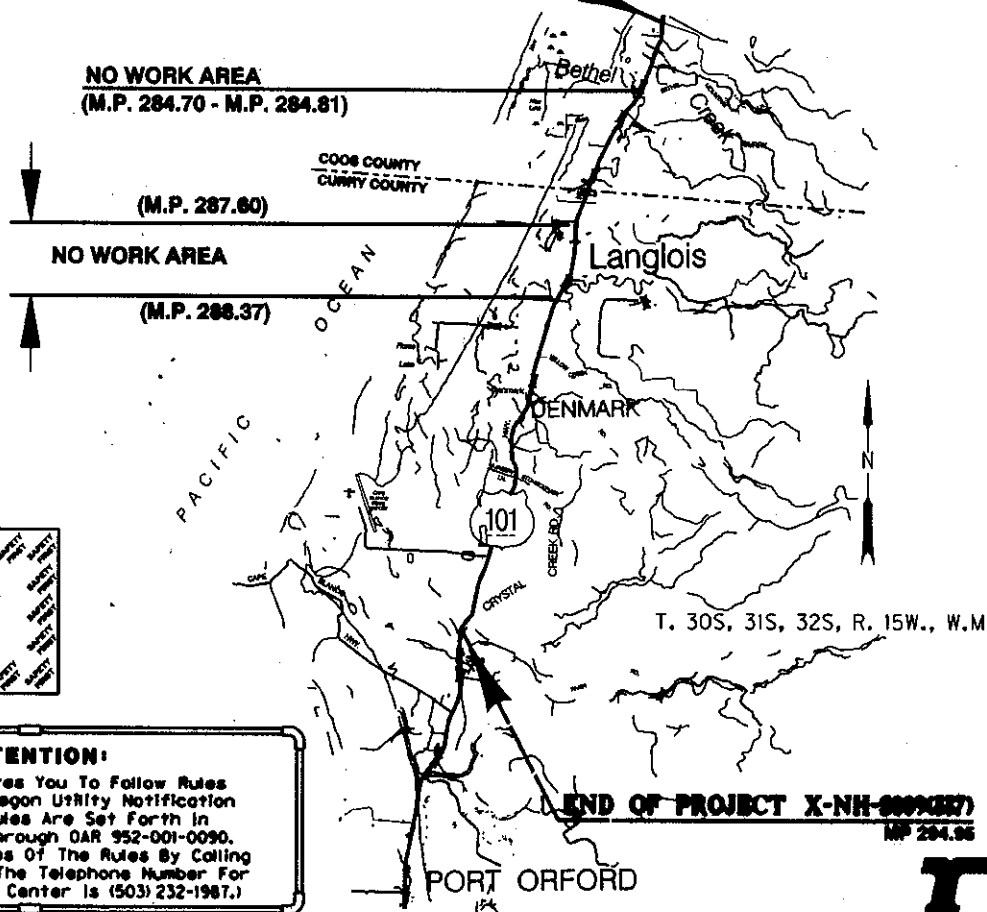

NO WORK AREA
 (M.P. 284.70 - M.P. 284.81)

(M.P. 287.60)

NO WORK AREA

(M.P. 288.37)



ATTENTION:
 Oregon Law Requires You To Follow Rules Adopted By The Oregon Utility Notification Center. These Rules Are Set Forth In OAR 952-001-0010 Through OAR 952-001-0090. You May Obtain Copies Of The Rules By Calling The Center. (Note: The Telephone Number For The Oregon Utility Center Is (503) 232-1987.)

These plans were developed using ODOT design standards. Exceptions to these standards, if any, have been submitted and approved by the ODOT Chief Engineer or their delegated authority.

Approving Authority:

M. Thompson
 Signature & date 4/8/09

Mark Thompson Reg. 3 Tech. Ctr. Mgr.

Print name and title

J.M. All
 Concurrence by ODOT Chief Engineer

OREGON TRANSPORTATION COMMISSION

- | | |
|--------------------|----------------------------|
| Gail Achterman | CHAIR |
| Michael Nelson | VICE-CHAIR |
| Janice Wilson | COMMISSIONER |
| Alan Brown | COMMISSIONER |
| David Lohman | COMMISSIONER |
| Matthew L. Garrett | DIRECTOR OF TRANSPORTATION |

US101: BETHEL CR. - CRYSTAL CR. PAVING
 OREGON COAST HIGHWAY
 COOS COUNTY & CURRY COUNTY

FEDERAL HIGHWAY ADMINISTRATION	PROJECT NUMBER	SHEET NO.
OREGON DIVISION	X-NH-S009(337)	1

US101: BETHEL CR - CRYSTAL CR PAVING

42V-83

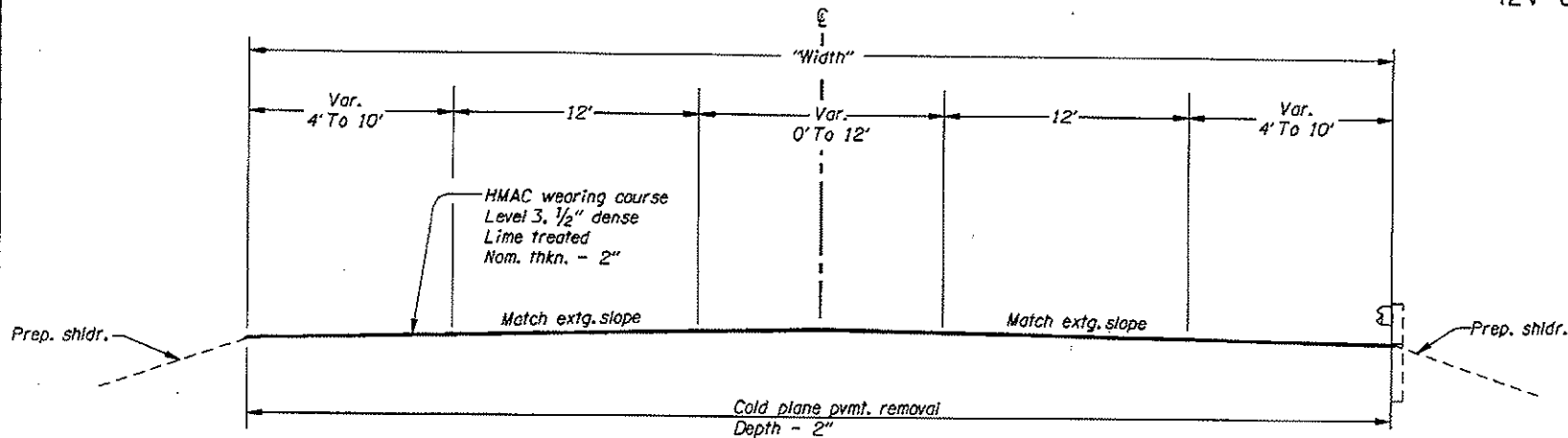

M.P. To M.P.	"Width"
282.76 To 284.33	32.0'
284.33 To 284.36	32.0' To 44.0'
284.36 To 284.68	44.0'
284.68 To 284.70	44.0' To 55.0'
284.70 To 284.81	NO WORK ZONE
284.81 To 284.83	44.0'
284.83 To 284.85	44.0' To 50.0'
285.51 To 287.60	32.0'
287.60 To 288.37	NO WORK ZONE
287.60 To 288.54	NO PAVEMENT AREA
290.21 To 290.32	32.0'
290.32 To 290.34	32.0' To 41.0'
290.34 To 290.40	41.0'
290.40 To 290.41	41.0' To 32.0'
290.41 To 291.21	32.0'
291.21 To 291.25	32.0' To 36.0'
291.25 To 291.38	36.0'
291.86 To 293.43	33.0'
293.43 To 293.45	33.0' To 46.0'
293.45 To 293.68	46.0'
293.68 To 293.70	46.0' To 32.0'

M.P. To M.P.	"Width"
293.70 To 294.45	32.0'
294.45 To 294.48	32.0' To 42.0'
294.48 To 294.66	42.0'
294.66 To 294.68	42.0' To 32.0'
294.68 To 294.95	32.0'

- Notes:
- Mile post locations provided are referenced from existing mile post markers posted in the field.
 - See sheets 2B-5 and BR dwg. 81517 for specific information on paving operations near bridge ends.
 - See sheets 2B-5 for specific information on bridge and joint treatments.

Rev. No.	Description	Date	Engineer
	Added data to table	04-08-09	

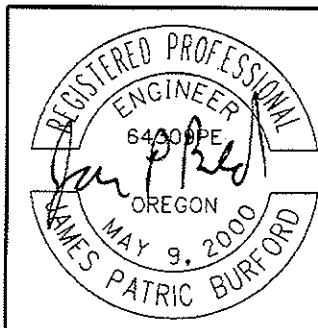

OREGON DEPARTMENT OF TRANSPORTATION

REGION 3 - TECHNICAL CENTER

US101: BETHEL CR. - CRYSTAL CR. PAVING
OREGON COAST HIGHWAY
COOS COUNTY & CURRY COUNTY

Design Team Leader - James P. Burford
Designed By - Joshua Fredrickson
Drafted By - Billy Shafer

TYPICAL SECTIONS

SHEET NO. **2**

PROJECT LIMITS
US 101: BETHEL CR. - CRYSTAL CR. PAVING

42V-83

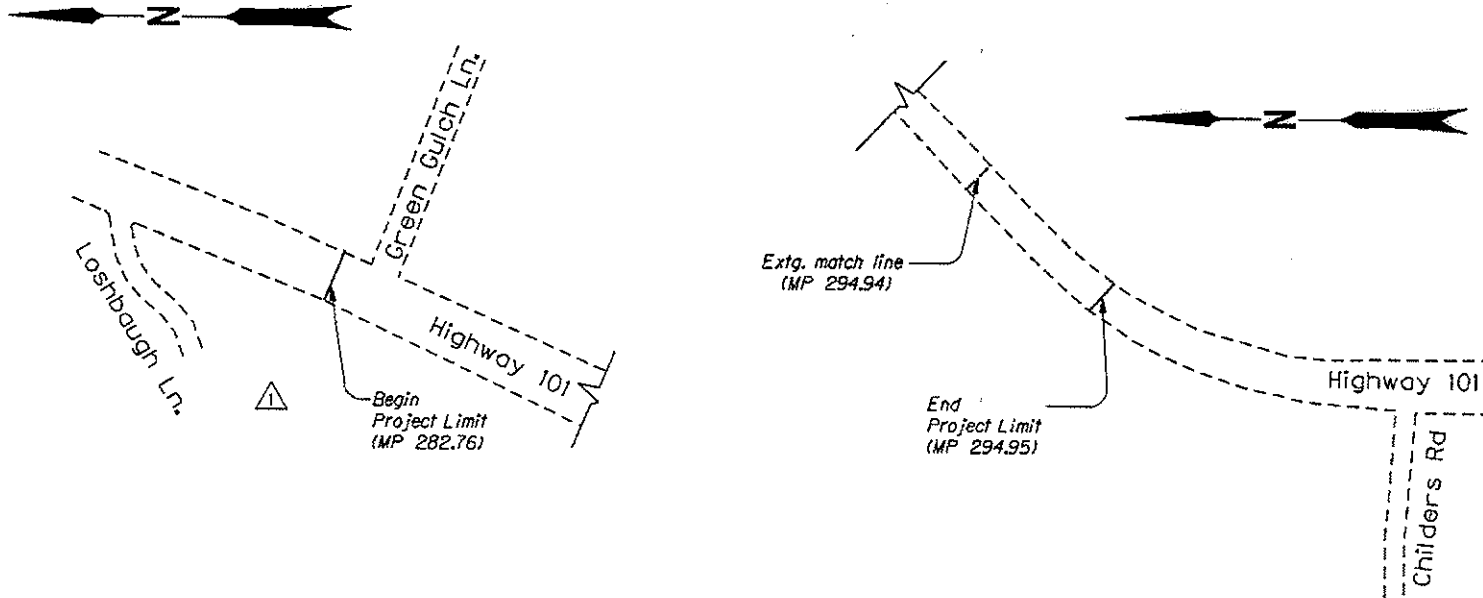

 OREGON DEPARTMENT OF TRANSPORTATION

 REGION 3 - TECHNICAL CENTER

US101: BETHEL CR. - CRYSTAL CR. PAVING
 OREGON COAST HIGHWAY
 COOS COUNTY & CURRY COUNTY

Design Team Leader - James P. Burford
 Designed By - Joshua Fredrickson
 Drafted By - Billy Shofer

DETAILS

SHEET NO.
2B-2

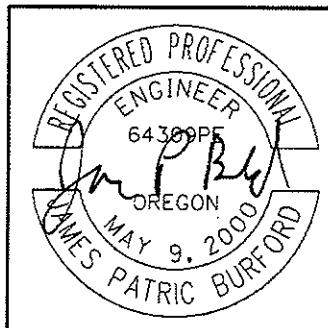

EXPIRES: 12-31-2009

Rev. No.	Description	Date	Engineer
①	Changed Project Limits map	04-08-09	
②			

US 101: BETHEL CR. - CRYSTAL CR. PAVING

42V-83



M.P. To M.P.	North bound	South bound	Remove Extg. Guardrail (ft.)	Adj. Guardrail Ht. (ft.)	Install Type 3 (ft)	Install Type 2A (ft)	Install Terminal	Terminal Type/Flare	Transition (ea)	Std. Dwg. For Transition	Comments
284.10 To 284.13	X		162.5'			125'	1	Flared			Match extg. terminals
284.10 To 284.13		X	475'			475'					Match extg. terminals
285.34 To 285.51	X		87.5'	Adj. Height		12.5'	2	Non-flared/flared			No adj. holes in post
288.37 To 288.43	X		312.5'			275'		Reuse terminal	1	BR203	
288.38 To 288.42		X	225'			187.5'		Reuse terminal	1	BR203	
288.54 To 288.77		X	1214'		12.5'	1150'	1	Non-flared	1	BR203	
288.54 To 288.78	X		1267'		12.5'	1200'	1	Non-flared	1	BR203	
289.28 To 289.32		X	87.5'	Adj. Height		12.5'	2	Non-flared			
289.50 To 289.54	X		212.5'	Adj. Height		137.5'	2	Non-flared			No adj. holes in post
290.33 To 290.35	X		60'		12.5'	37.5'	1	Non-flared	1	BR203	Long posts req.
290.37 To 290.39	X		60'		12.5'	37.5'	1	Non-flared	1	BR203	Long posts req.
291.19 To 291.31		X	637.5'			562.5'		Reuse terminal			Long posts req.
291.29 To 291.33	X		212.5'			137.5'		Reuse terminal			
291.75 To 291.81		X	312.5'			237.5'		Reuse terminal			No adj. holes in post

DRAINAGE CURB REMOVAL & REPLACEMENT	
M.P. To M.P.	North bound
289.50 To 289.54	X
291.29 To 291.33	X

OREGON DEPARTMENT OF TRANSPORTATION

REGION 3 - TECHNICAL CENTER

US101: BETHEL CR. - CRYSTAL CR. PAVING
OREGON COAST HIGHWAY
COOS COUNTY & CURRY COUNTY

Design Team Leader - James P. Burford
Designed By - Joshua Fredrickson
Drafted By - Billy Shafer

DETAILS

SHEET NO.
2B-8

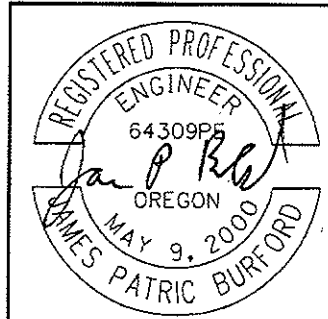

EXPIRES: 12-31-2009

Rev. No.	Description	Date	Engineer
1	Added data to table	04-08-09	
2			