



Oregon

Theodore R. Kulongoski, Governor

Department of Transportation
Technical Services
Roadway Engineering Section
355 Capitol Street NE, Room 222
Salem, OR 97301-3871
Telephone 503-986-3714
FAX 503-986-3749

DATE: Feb 4, 2010

Addenda No. 2

TO: PLAN HOLDERS

PREPARED BY: Dan C. Keeley
Dan C. Keeley, P.E.
Marion County

APPROVED BY: Dan C. Keeley P.E.
Dan C. Keeley, P.E.
Marion County

SUBJECT: SIGNAL REPLACEMENT
LANCASTER DRIVE AT DURBIN AVENUE
MARION COUNTY

(Bids to be opened and read February 11, 2010)

The following changes are made to the Project Special Provisions:

1. **Section 00950.42 Salvaging and Stockpiling Materials** – Revise the list of materials to be salvaged and stockpiled to read as follows:

Materials	Stockpile Location
Controller Cabinet and Contents	On Site
Radio and associated Siamese cable from SE pole	On Site
Pole mounted 3 section head from NE pole	On Site
4 Signal Poles and 2 Mast Arms	On Site

The following changes are made to the Project Plans:

1. Plan sheet 3 is replaced with revised plan sheet 3. (Inlet and manhole elevations added)

These changes will be included in the Contract for this Project. It is understood that your Bid will be submitted accordingly.

Attachments: Revised Plan Sheet

CONSTRUCTION NOTES:

- 1 CONSTRUCT SHALLOW MANHOLE OVER EXISTING PIPE, SEE STD. DRG. RD342 - 2 EA.
- 2 CONSTRUCT CONC. INLET, TYPE G-2 WITH TYPE 2 GRATE OVER EXISTING PIPE, SEE STD. DRG. RD364 - 2 EA.
- 3 REMOVE CONC. INLET, INSTALL 8" STORM SEWER PIPE, 0-5 FT TRENCH EXCAV. = 3 CU. YD.
- 4 CONSTRUCT RETAINING WALL, PREFABRICATED MODULAR - 78 SQ. FT., SEE SHEET 2
- 5 REMOVE AND REINSTALL EXISTING SIGN (BUS STOP)
- 6 REMOVE AND REINSTALL MAILBOX
- 7 REMOVE AND REPLACE PAVEMENT AS DIRECTED
- 8 CONSTRUCT CONC. CURB AND WALK, SEE CURB AND WALK SECTION ON SHEET 2
- 9 INSTALL SIDEWALK RAMP, SEE STD. DRG. RD757 & RD759
- 10 MOVE EXISTING HYDRANT, SEE DETAIL ON SHT. 1A
- 11 ADJUST MANHOLE, BY OTHERS
- 12 RELOCATE SPRINKLER HEAD
- 13 CONSTRUCT SEEDED LAWN
- 14 PLACE TOP SOIL - 8 CY
- 15 PLACE BARK MULCH - 4 CY
- 16 CONSTRUCT CONC. CURB - 26

CURB RETURN NOTES

CURVE NO.	RADIUS	DELTA ANGLE	TFOC ELEVATION
1	30	PC - 24+43.15	222.68
		1/4	222.45
		1/2	221.95
		3/4	220.90
		PT	220.35
2	30	PT	219.50
		3/4	220.21
		1/2	220.98
		1/4	221.73
		PC - 23+40.25	221.91
3	30	PC - 23+32.5	224.35
		1/4	224.40
		1/2	224.37
		3/4	224.20
		PT	223.90
4	30	PT	224.36
		3/4	224.68
		1/2	224.80
		1/4	224.83
		PC - 24+30.80	224.86

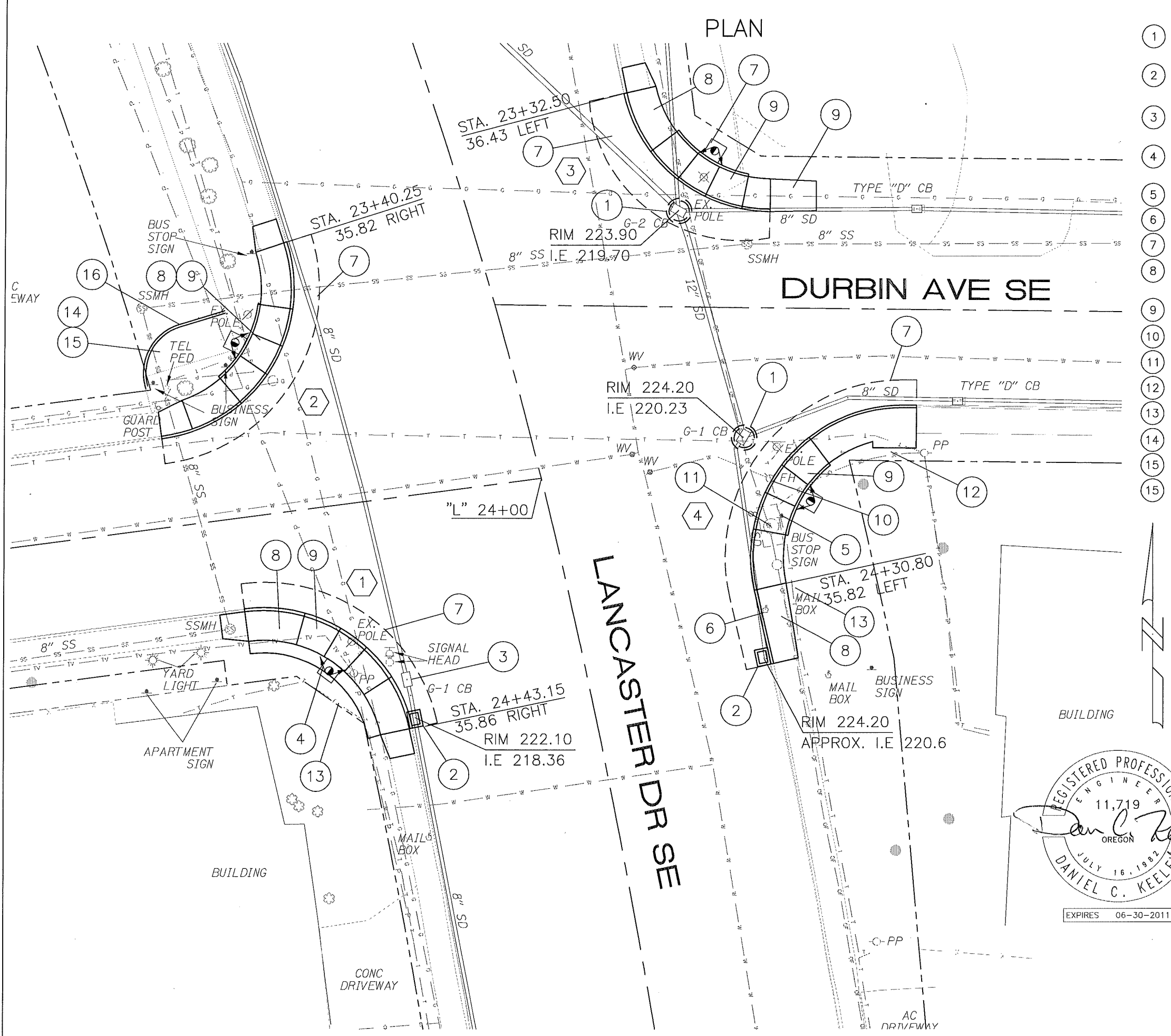

D. KEELEY DESIGN		ROAD PLAN LANCASTER DRIVE AT DURBIN AVENUE			
S. WATSON DRAWN					
D. CHAMNESS APPROVED		FEDERAL HIGHWAY ADMINISTRATION	PROJECT NUMBER	SHEET NO.	
		REGION 10	OREGON DIVISION	X-STP-C047(048)	3

G:\Engineering\ProjectCentral\Projects\Durbin_Lancaster_Signal\Model\LDP_Durbin_Lancaster.dwg, 2/1/2010 3:04:50 PM