



PROJECT PROSPECTUS

Part 1 — Project Request (Page 1 of 2)

Key Number:

Jurisdiction:

Section: NINE MILE SLOUGH (CR. 106) BRIDGE #25A82

Region: 5

Area: SEACT AREA

District: 14

AB Highway Name: Mile Point From: 4.61 To: 4.66 Length: (mi) .05 (km)

City: MPO: Within UGB: Yes No County: HARNEY ROAD/STREET NAME: LAWEN - HARNEY ROAD (COUNTY ROAD 106)

Route No.: NHS YES NO HPMS: FC: 07 Applicant (If other than State): HARNEY COUNTY

US Congressional District: 2 State Senate District: 30 State Representative District: 60

Cost Estimates (x \$ 1,000) Project Components Right Of Way

Preliminary Engineering \$54 Grading X Files (#) 2

Right Of Way \$15 Paving X Acres (#) 1

Utility Reimbursement Structures X Relocations (#)

Signing Acquisitions (#)

Roadway \$51 Signals Easements (#)

Structures \$117 Illumination Work By: State / Consultant / Applicant

Signals \$0 Preliminary Engineering (S,C,A) C

Illumination \$0 Construction Engineering (S,C,A) C

Temp. Protection \$10 Right of Way Descriptions (S,C,A) C

Const. Contingencies \$36 Right Of Way Acquisitions (S,C,A) C

Const. Engineering \$32 Project Categories Constructed By

Remove Exist Bridge \$11 Environmental Class (1, 2, 3, PCE) 2

Other \$14 Design Category (1-7) 7

Total CE and Construction: \$271 Work Type Code (1-13) 5

Total Estimate: \$ 339 Primary STIP Work Type:

Recommended Let Date By Federal Fiscal Year (Quarter-Year):

PE Fund: R/W Fund: UR Fund: CE-CN Fund:

PE EA: R/W EA: UR EA: CE-CN EA:

Item Existing Proposed Define The Problem:

Travel Lanes (#) 2 2 The existing structure is structurally deficient with a sufficiency rating of 39.2. Bridge is posted for 27 tons. The width of the bridge is substandard

Structures (#) 1 1

Signals (#) 0 0

Bike Way (#) N N

Average Daily Traffic 113 159

Year of ADT 2001 2021

Throughway Y/N

Describe Proposed Solution: - Attach Sketch Map

Replace with a 35 foot single span X 32 foot wide prestressed slab structure and install guardrail to meet standards. Widen approaches in order to accommodate a 32 foot wide structure.

Prepared By: Date: OTC Approval Date: Program Year: Funding Amount:

X



PROJECT PROSPECTUS

Part 1 Project Request (Page 2 of 2)

Key Number:

Jurisdiction:

Section: NINE MILE SLOUGH (CR. 106) BRIDGE #25A82

Region:
5

Area:
SEACT AREA

District:
14

Project Justification

This timber structure originally was constructed in 1985 and serves as a link between agricultural ground and US 395 (State Highway 48/State Highway 7) and Oregon Route 78 (State Highway 442). Bridge inspection reports indicate that rot was found in both the cap and piles. Reports also indicate that splits are starting to occur in the girders, cap, and piles. These factors combined with the narrow width make it undesirable and unsafe for two-way truck traffic. Due to these conditions, Harney County as requested that Ninemile Slough (Lawen-Harney Road) Bridge #25A82 be submitted for replacement under the OTIA III Program.

This project is consistent with the Department of Transportation's and Harney County's goal of replacing or rehabilitating deficient structures.

(The legal description for Ninemile Slough (Lawen-Harney Road) Bridge #25A82 is as follows: T23S R32E S25.)

Additional Information For Project Requested By Local Jurisdictions

Responsible Local Office To Be Contacted For The Following Activities:

- | | | |
|--|----------------|---------------|
| 1. Public Hearing /
Citizen Involvement | _____ (Office) | _____ (Phone) |
| 2. Environmental / Planning | _____ (Office) | _____ (Phone) |
| 3. Pre-Engineering | _____ (Office) | _____ (Phone) |

This Official Request is From:

City of: _____	and/or	_____ HARNEY County
By: _____	By:	KERRY LANDERS, ROADMASTER
By: _____	By:	_____
	By:	_____

Applicable Intergovernmental Agreements:

IGA Number:	Jurisdiction Name:	Agreement Date:
_____	_____	_____
_____	_____	_____
_____	_____	_____

Administrative Recommendation

Bridge Prospectus Cost Estimate

	NBIS Bridge No.		
Applicant:	HARNEY COUNTY		
Project /	NINE MILE SLOUGH (CO 106)	Region:	Area:
Section	BRDIGE #25A82	5	NEACT AREA
			District: 0

New Bridge / Roadway Configuration:		Existing Bridge:	
Left Side Rail	35 feet	Bridge Length	25 feet
Left Sidewalk	feet	Bridge Width	28.3 feet
Shoulder	4 feet	Area	707.5 square ft.
Lane 2	feet		
Lane 1	12 feet	New AC Top Width	32 feet
---CL---	feet	New AC Depth	4 inches
Lane 1	12 feet	New Base Depth	12 inches
Lane 2	feet	Project Length	335 feet
Shoulder	4 feet	Net Road Work Length	300 feet
Right Sidewalk	feet	X-S Side Slope	1:3
Right Side Rail	35 feet	AC Avg Width	32 feet
		Base Avg Width	32 feet
Bridge Length	35 feet	Asphalt Density	140.63 pounds/ cu ft
Bridge Width	32 feet	Base Density	147.5 pounds/ cu ft
New Area	1120 square ft.	New AC Received	240 tons
		New Base Required	704 tons

COST ESTIMATE:	Quantity	Unit	Price per unit	Cost (\$x1000s)
Right-of-Way	1.00	Acre	\$ 15,000	\$15
==Roadway==				
Clear & Grub	\$ 4,000	lump sum		\$4
Erosion Control	\$ 1,000	lump sum		\$1
General Excavation	100	cubic yards	\$ 10.00	\$1
Embankment in Place	200	cubic yards	\$ 20.00	\$4
Pavement Removal		square feet	\$ 9.00	\$0
Aggregate Base	704	tons	\$ 11.00	\$8
Asphalt Concrete	240	tons	\$ 36.00	\$9
Curb		feet		\$0
Sidewalk		feet		\$0
Riprap	100	cubic yards	\$ 52.00	\$5
Guardrail, Type 2A	150	feet	\$ 20.00	\$3
Guardrail, Type 3	50	feet	\$ 40.00	\$2
Guardrail Trans	4	each	\$ 1,700.00	\$7
Other		specify unit		\$0
Other		specify unit		\$0
Other		lump sum		\$0
Other		lump sum		\$0
Flared Terminals	4	each	\$ 1,800.00	\$7
Subtotal Roadway				\$51
Structures	1,120	square feet	\$ 90.00	\$101
Bridge Rail	70	feet	\$ 95.00	\$7
Remove Existing Bridge	708	square feet	\$ 15.00	\$11
Other		specify unit		\$0
Other		specify unit		\$0
Detour		lump sum		\$0
Const. Survey Work	\$ 10,000	lump sum		\$10
Subtotal Structures				\$128

Bridge Prospectus Cost Estimate

		NBIS			
		Bridge No.			
Applicant:	HARNEY COUNTY			Region:	Area:
Project /	NINE MILE SLOUGH (CO 106)			5	NEACT AREA
Section	BRIDGE #25A82				District:
					0
Mobilization	8	percent of (Roadway + Structure)			\$14
Signals		lump sum			\$0
Illumination		lump sum			\$0
Temporary Protection	\$ 10,000	lump sum			\$10
Detour Route		feet			\$0
Other		specify unit			\$0
Other		specify unit			\$0
Other		lump sum			\$0
Other		lump sum			\$0
Mobilization & Traffic					\$24
Subtotal Construction					\$203
==Engineering==					
Construction Engineering	18	percent of (Roadway + Structure)			\$32
Contingency	20	percent of (Roadway + Structure)			\$36
Subtotal Const. Eng.					\$68
Preliminary Engineering					
Consultant	28	percent of (Roadway + Structure)			\$50
State		percent of (Roadway + Structure)			\$0
County	2	percent of (Roadway + Structure)			\$4
Subtotal PE					\$54
Total Estimate					\$339

Bridge Project Prospectus Additional Bridge Information

Applicant: HARNEY COUNTY		NBIS Bridge Number: 0						
Project Name / Section: NINE MILE SLOUGH (CR. 106) BRIDGE #25A82		Region: 5	Area: SEACT AREA	District: 14				
Funding Preferred Source: <input checked="" type="checkbox"/> OTIA III <input type="checkbox"/> Federal HBRR Acceptable Source: <input checked="" type="checkbox"/> OTIA III <input checked="" type="checkbox"/> Federal HBRR	Heavy Vehicle Usage <table style="width: 100%; border: none;"> <tr> <td style="text-align: center;">Existing</td> <td style="text-align: center;">Proposed</td> </tr> <tr> <td>Truck AADT: <input style="width: 50px;" type="text" value="6"/></td> <td><input style="width: 50px;" type="text" value="8"/></td> </tr> </table> Fire Truck Usage: <input type="checkbox"/> YES, at least 25% of trips use bridge. <input checked="" type="checkbox"/> No. Less than 25% of trips	Existing	Proposed	Truck AADT: <input style="width: 50px;" type="text" value="6"/>	<input style="width: 50px;" type="text" value="8"/>	Detour Detour Route: Length: <input style="width: 50px;" type="text" value="27"/> Map: (Please attach map)		
Existing	Proposed							
Truck AADT: <input style="width: 50px;" type="text" value="6"/>	<input style="width: 50px;" type="text" value="8"/>							
Regional Freight Corridor Analysis: No posted bridges on detour or freight corridor. SEE DETOUR/CORRIDOR MAP								
Special Consideration:								



APPROACH VIEWING N S E W



ELEVATION VIEWING N S E W

BRIDGE NAME:	Alcornville Slough
BRIDGE NO.:	25A30
DATE:	9/19/90



ANDERSON ENGINEERING AND SURVEYING, INC.
 PROFESSIONAL ENGINEERS AND LAND SURVEYORS

HC 84 Box 24, Lakeview, Oregon 97630
 (541) 947-4407 Fax (541) 947-2321

539 SW 7th Street, Redmond, Oregon 97756
 (541) 923-4307 Fax (541) 923-4308

OREGON

HWY.

NO. 7

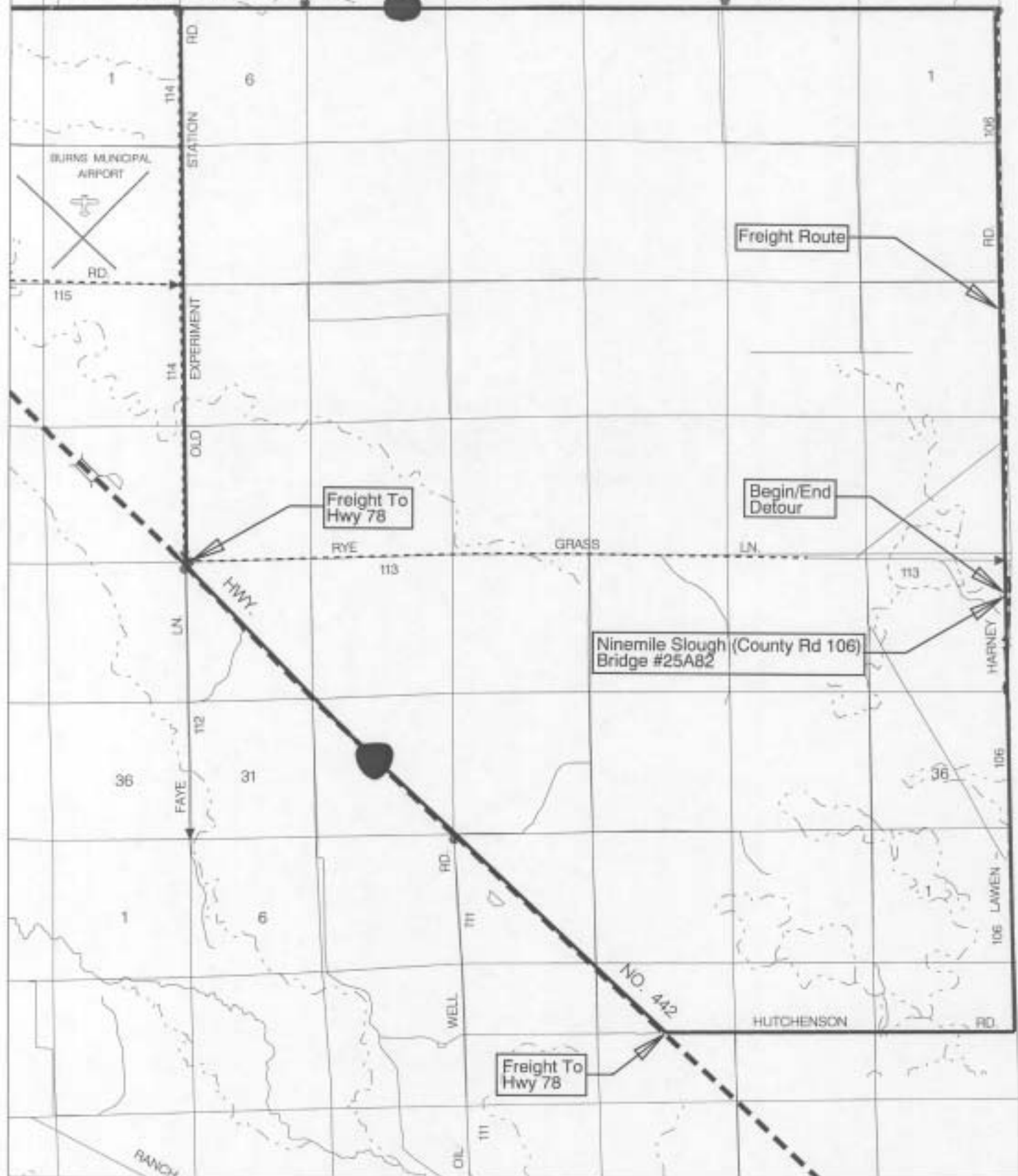

Freight Route

Freight To Hwy 78

Begin/End Detour

Ninemile Slough (County Rd 106) Bridge #25A82

Freight To Hwy 78