

OREGON DEPARTMENT OF TRANSPORTATION
PROJECT DEVELOPMENT BRANCH
TRAFFIC MANAGEMENT SECTION

SIGN POLICY AND GUIDELINES

Chapter 1: Introduction

The Oregon Department of Transportation is responsible for furnishing and maintaining directional, regulatory, warning, and informational signing on the state highway system.

The Department's sign policy is a combination of State of Oregon Revised Statutes, Administrative Rules, Federal Highway Administration rules and guidelines, and engineering judgment. The Oregon Transportation Commission has adopted the Federal manual on Uniform Traffic Control Devices (MUTCD) with Oregon Supplements as the signing manual for the State of Oregon. Since the Manual on Uniform Traffic Control Devices has been adopted as policy, this document deals exclusively with items not included in the Manual or items that need further clarification as they are used on the state highway system

It is important to remember that if a policy exists and the sign meets the necessary criteria, the sign will be erected only when there is adequate space along the highway or freeway, and only if the designated location generates a large enough traffic volume to justify the placement of the sign. Existing signs that are not in conformance with this policy should be brought into compliance on a replacement basis.

SIGN TYPES

1. REGULATORY:

- Colors: Black, red, or green letters on white background.
Types: Black letters - requires person to follow regulation on sign.
Red letters - prohibits action listed on sign.
Red circle and slash (symbol signs) prohibits action depicted on sign.
Green circle (symbol signs) allows action depicted on sign.
Green letters - Allows action listed on sign.
Exceptions: STOP and YIELD signs, disabled person's parking sign.

2. WARNING

- Colors: Black letters or symbol on yellow background.
Type: Warns driver of existing or anticipated condition.
Exceptions: STOP, YIELD, and SIGNAL AHEAD signs.

3. CONSTRUCTION

- Colors: Black letters or symbol on orange background.
Type: Gives direction or warning in construction or maintenance areas.
Exception: Regulatory and warning signs may also be posted in construction zones (i.e., STOP signs).

4. DESTINATION GUIDE SIGNS

- Colors: White letters or symbol on green background.
Type: Identifies city, town, or destination.

5. RECREATIONAL GUIDE SIGNS

- Colors: White letters or symbol on brown background.
Type: Identifies recreational opportunities or destination.

6. MOTORIST SERVICE SIGNS

- Colors: White letters on blue background.
Type: Can be either word message or a symbol identifying services such as food, gas, lodging, camping, police, viewpoint, phone, hospital, diesel, tourist, and rest areas.

7. LOGO SIGNS*

Colors: White letters on blue background with business logo.
Type: Gas, food, lodging, camping.

8. TOURIST ORIENTED DIRECTIONAL SIGNS (TODS*)

Colors: White letters on blue background.
Type: Business identification and direction information for tourist-oriented businesses and services. Identifies cultural and historical features. Used only on the primary and secondary systems, not the interstate.

9. HISTORICAL and CULTURAL SIGNS

Colors: White letters on brown background, if single destination.
White letters on green background, if used with other destinations.
White letters on blue background, if off interstate. *
Type: Identifies historical or cultural features available on the interstate system. **

* Refer requests for signing to: Cheryl Gribkov, Director, Oregon Travel Experience, 1500 Liberty Street SE, Salem, Oregon 97302 (503) 378-4508.

** Refer requests for signing to: Outdoor Advertising Sign Permits, ODOT Right-of-Way Project Administration, 4040 Fairview Industrial Dr., Salem, Oregon 97302 (503) 986-3650.

**The following signs are not allowed on the state highway system.
The State Traffic Engineer may allow certain exceptions.**

Advertising
Amusement Parks
Animal Shelter
Billboards
Churches
Commercial Businesses (see traffic generator signing, page 5-189)
Day Care Centers
Death Markers
Drive-in Theaters
Drug Free School Zone
Educational Service District
Field Burning
Fraternity-Sorority
Green River Ordinance
Kindergartens
Memorial Highways (See Blue Star Rest Area Signing)
Miniature Golf
Neighborhoods
Neighborhood Watch
Nuclear Free Zone
Nursing Homes
Political Signs
Public Open Market
Public Agency (See Section 5)
Private Agencies
Recycling Centers (Private)
Residential Complexes
Retirement Homes
Rodeos
Rustic Signs for Chamber of Commerce
Service Clubs
Skating Rinks
Special Interest Districts (See T.O.D. Signing)
Sports Clubs
Stockyards
Trade Schools
Veterans' Affairs Offices
Waste Transfer Stations

SIGNING AGREEMENT
US FOREST SERVICE AND OREGON DEPARTMENT OF TRANSPORTATION

The following items of agreement cover the signing portion of Memorandum of Understanding NFS 02-MU-11060000-111, entered into February 1, 2002 by and between ODOT and the USDA Forest Service (USFS), Pacific Northwest Region:

1. **Installing and Maintaining Signs.** ODOT has authority and responsibility for the installation and maintenance of all signs within the right-of-way of the State Highway System, except as noted in paragraphs 3.b. and 3.e. in this section. All such signing will be in accordance with the Manual on Uniform Traffic Control Devices (MUTCD), the Oregon Supplements to the MUTCD, and the "Sign Policy and Guidelines for the State Highway System".
2. **USFS Post-mounted Signs.** Sign maintenance and/or replacement requests will be made to the ODOT District Manager at least 30 days in advance by the Forest Supervisor. ODOT is responsible for maintaining and replacing existing post-mounted signs in the four categories listed below. Any reimbursement between parties will be authorized by a separate appropriate document.
 - a. Approach signs for National Forest facilities.
 - b. Directional signs will be limited to no more than three destinations at any single location, using location names identified on public use maps.
 - c. Junction signs for National Forest arterial routes will utilize the M1-7 route marker, and will be provided only for those routes that are signed and marked in accordance with the MUTCD and Oregon State supplements thereto.
 - d. Boundary, guide, and identification signs for areas of National significance that have been designated by an Act of Congress of the United States and other distinctive design as may be deemed necessary by ODOT and USFS shall be in accordance with the MUTCD. Sign requests under this category will be submitted with a plan showing proposed design and site layout.
3. **Signs Furnished by USFS.** The following category of signs will be furnished by the USFS:
 - a. USFS recreation and administrative signs within the state highway right-of-way will be furnished by USFS, but installed and maintained by ODOT. USFS may request ODOT to install or remove recreation and administrative signs. Sign requests will be made to the ODOT District Manager at least 30 days in advance by the Forest Supervisor.

- b. Signs needed by the USFS on State highways that normally have large bases will be furnished, installed, and maintained by the USFS. The following signs are included in this category: National Forest Boundary (FE or FL); Recreation Site (RS); Headquarters (A or AS); and special interpretive signs. These signs are normally located outside the highway right-of-way or at parking areas. A permit from ODOT is required for placement within the highway rights-of-way. All installations will meet the requirements of applicable Highway Safety Program standards, or will be removed when requested by ODOT.
 - c. Northwest Forest Pass logo signs will be provided by the USFS. ODOT will install the logo signs on existing guide signs that direct motorists to National Forest facilities where the public can purchase a Pass.
 - d. USFS will provide National Forest scenic byway signs as appropriate.
 - e. USFS will furnish, install, and maintain all temporary warning, regulatory, and guide signs; other traffic control devices (such as delineators, barricades, and temporary pavement markings); and all other appropriate devices which are needed to warn and control traffic during emergencies, construction, or maintenance activities, for which the USFS is responsible.
4. **Highway Advisory Radio Signs.** USFS will coordinate with and abide by State requirements to obtain a permit for Highway Advisory Radio (HAR) signs. Requirements are listed in ODOT's "Guidelines for Highway Advisory Radios" and in the "Sign Policy and Guidelines for the State Highway System". These signs will provide the USFS the capability to communicate forest information to motorists using the vehicle's AM radio receiver. The Forest Service "shield", "National Forest" logo, and "Northwest Forest Pass" logo may be incorporated into the HAR sign layout. USFS will reimburse ODOT for all costs involved in the fabrication, installation, and maintenance of the HAR signs. Any reimbursement(s) will be authorized by a separate appropriate document.
5. **Signs Off the Right-of-way.** Signs installed off the right-of-way, and visible to highway travelers, will comply with: The Federal Highway Beautification Act of 1965, Part 750, Subpart B, National Standards for Official and Directional Signs (750.153 and 750.154); the Oregon Motorist Information Act; and ORS 377.505 to 377.545. Permits for such signage will be obtained from ODOT – Outdoor Advertising Unit.
6. **USFS Shield.** The USFS "shield" will be allowed and should be used as agency identification as approved by the USFS. USFS script logo "National Forest" will also be allowed. USFS logo is not needed on a sign if specific words such as "National Forest" are used.

- 7. Destination Signs.** The following conditions apply to destination signs:
- a. At areas where there are more than one agency's facilities from one point on the highway, a generic recreation sign will be used with the represented agencies' logos below the generic message.
 - b. Up to four symbol plaques may be used on single destination signs, but they will not be used on generic multi-agency signs.
 - c. Local road numbers as well as agency road numbers may be used where appropriate. USFS provided distinctive route marker(s) may be used.
 - d. Advance destination signs will ONLY be used where special emphasis is required. Examples are limited sight distance; high traffic volumes; multi-lane (more than 2) highways; and high-speed areas.
 - e. Agencies are encouraged to work together to develop specific signing to multiple destinations. Such signs will be placed off the highway on the intersecting roadway.
- 8. Fire Emergency Signs.** During a fire suppression emergency, USFS and ODOT maintenance personnel will coordinate to identify the signing requirements and accomplish the installation of signs and traffic control devices as soon as possible after the emergency occurs. The signs and traffic control devices provided by ODOT are chargeable to the fire suppression activity. ODOT will work with USFS to identify any hazards that may not be visible at night, and have the necessary signs, barricades, and flashers in place prior to darkness to protect both the traveling public and fire fighting personnel.

STANDARD SIGNING FOR PASSING OR CLIMBING LANES

Guide for sign layout

Posted or 85th percentile speed (mph)	"d" (feet).
25	325
30	460
35	565
40	670
45	775
50	885
55	990
60	1100
65	1200

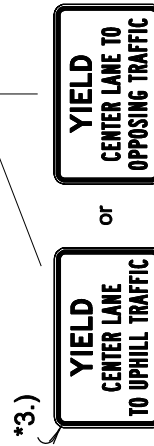
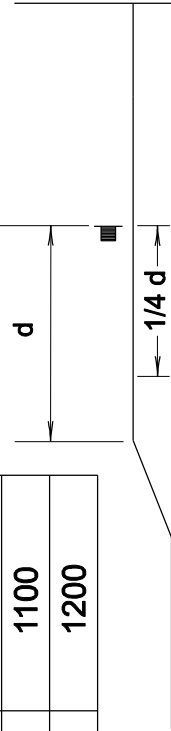
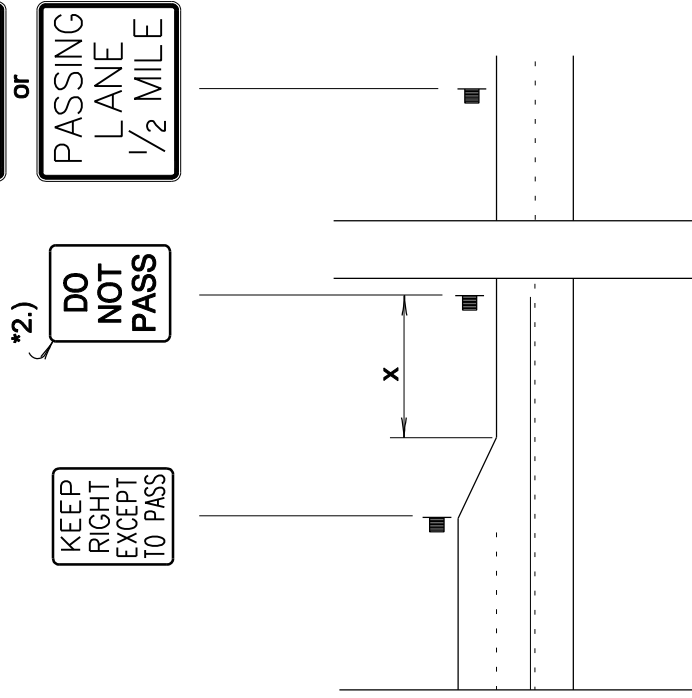

General Notes:

- 1) "Do Not Pass" sign may be omitted if section is already a no passing zone.
- 2) Sign no. OR4-11 and OR4-11a optional. Install as per pg. 3-53 of this manual.
- 3) See Traffic Line Manual for Striping Standards.

NO PASSING ZONE TABLE

Posted or 85th percentile speed (mph)	25	30	35	40	45	50	55	60	65	70
"x" (feet).	450	500	550	600	700	800	900	1000	1100	1200

STANDARD SIGNING FOR SLOW MOVING VEHICLE TURNOUTS

* Minimum spacing—
provide more if
adequate space
is available

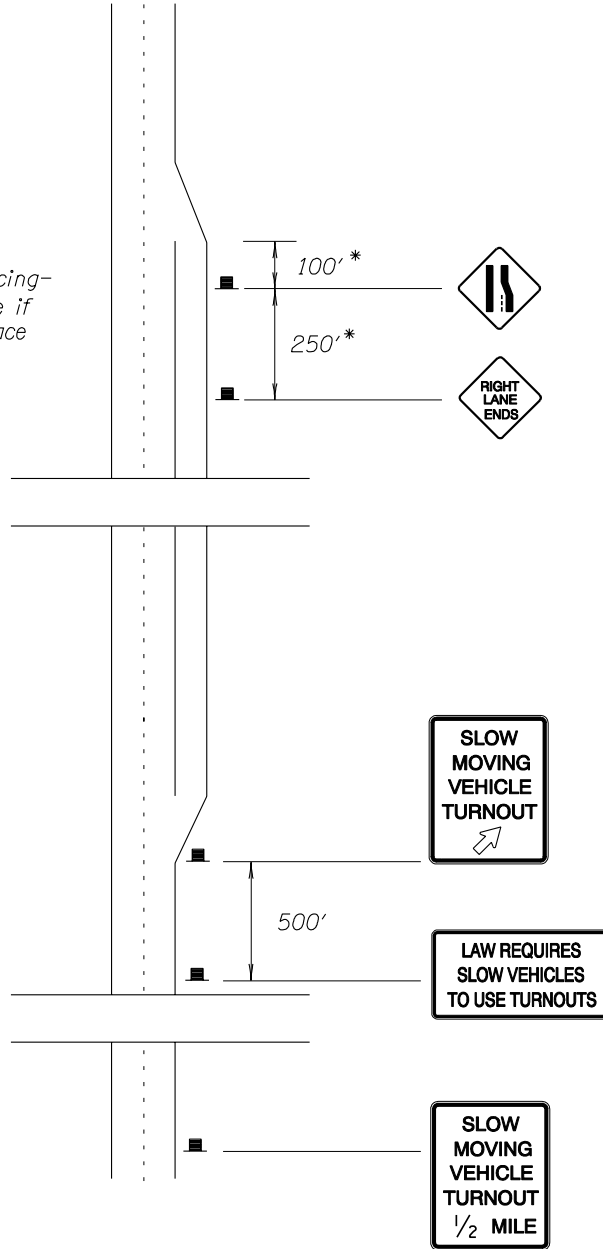

SIGNSTDPG.F.11

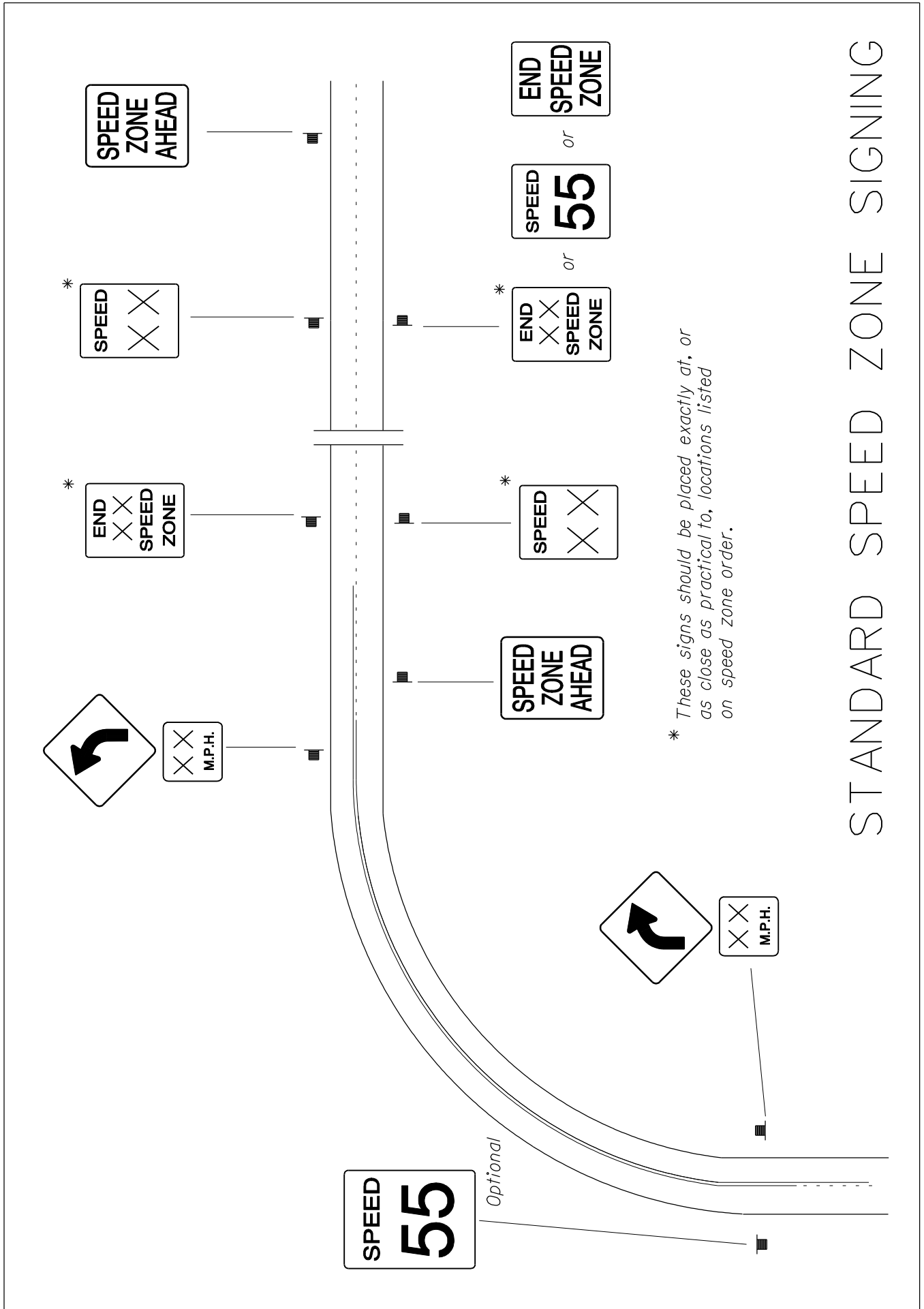

STANDARD SPEED ZONE SIGNING

STANDARD SIGNING FOR SAFETY CORRIDORS

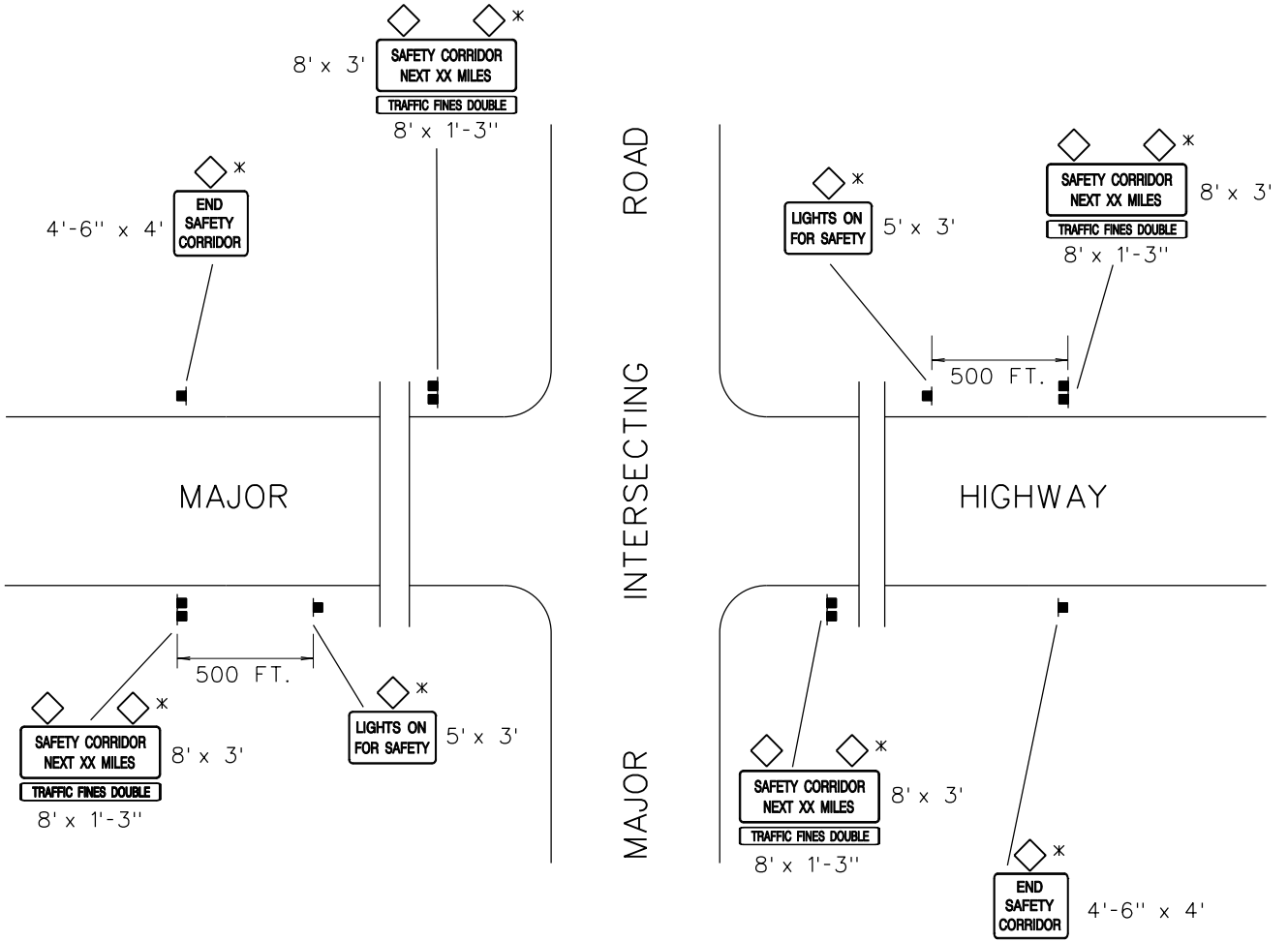

* Flagboards Optional

SIGNSTD.PG.F.11

OREGON DEPARTMENT OF TRANSPORTATION

Approved By: S.T.E.

Date: 2/07

Publication Date: 2/07