

Region 1 District 2B / Region 2 District 1

TUALATIN VALLEY HIGHWAY No. 29

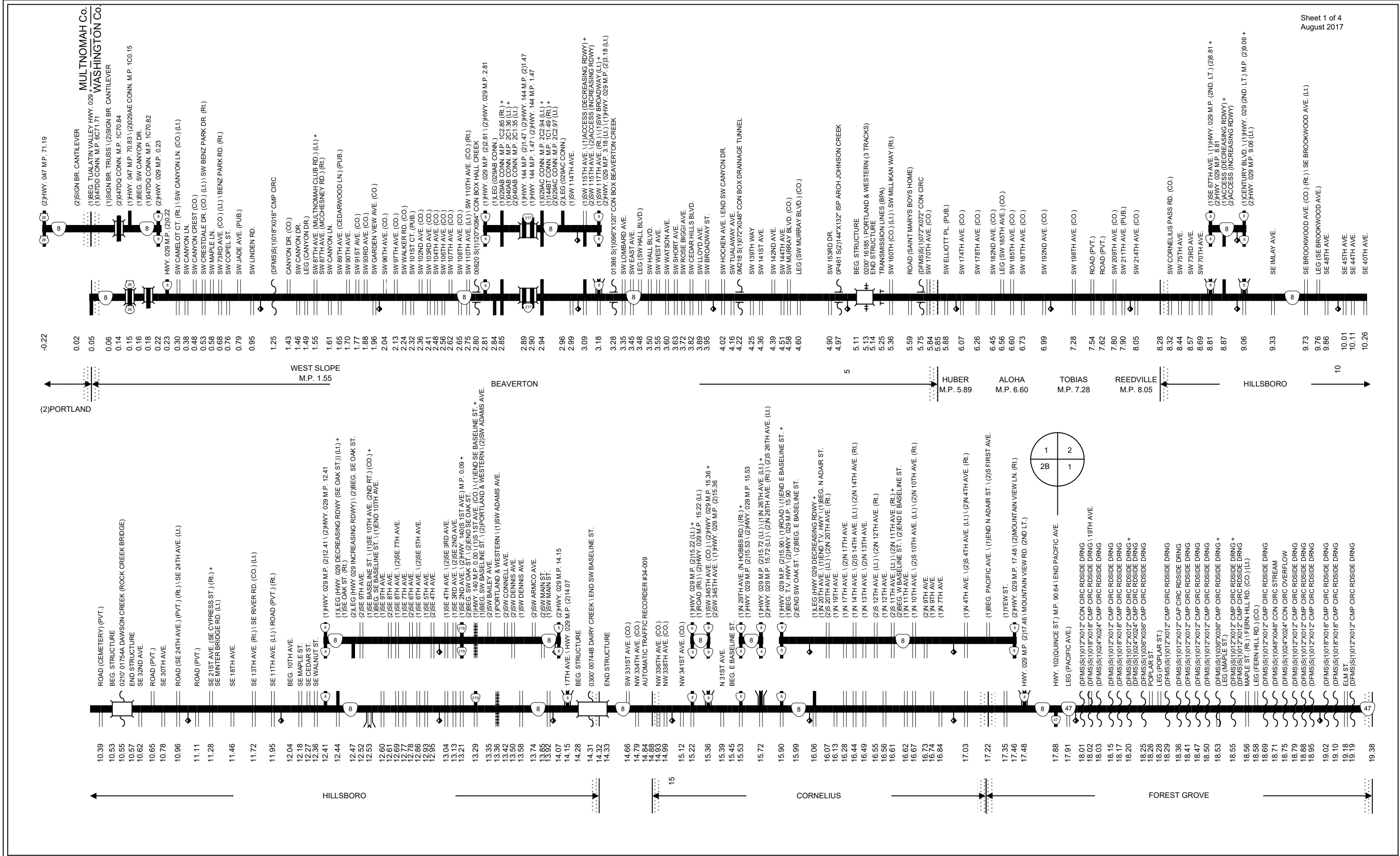

This product is for informational purposes and may not be suitable for legal, engineering, or surveying purposes. Users of this product should review and consult the primary data sources to determine the usability of the information. Conclusions drawn from such information are the responsibility of the user.

Region 2 District 1 / District 3

TUALATIN VALLEY HIGHWAY No. 29

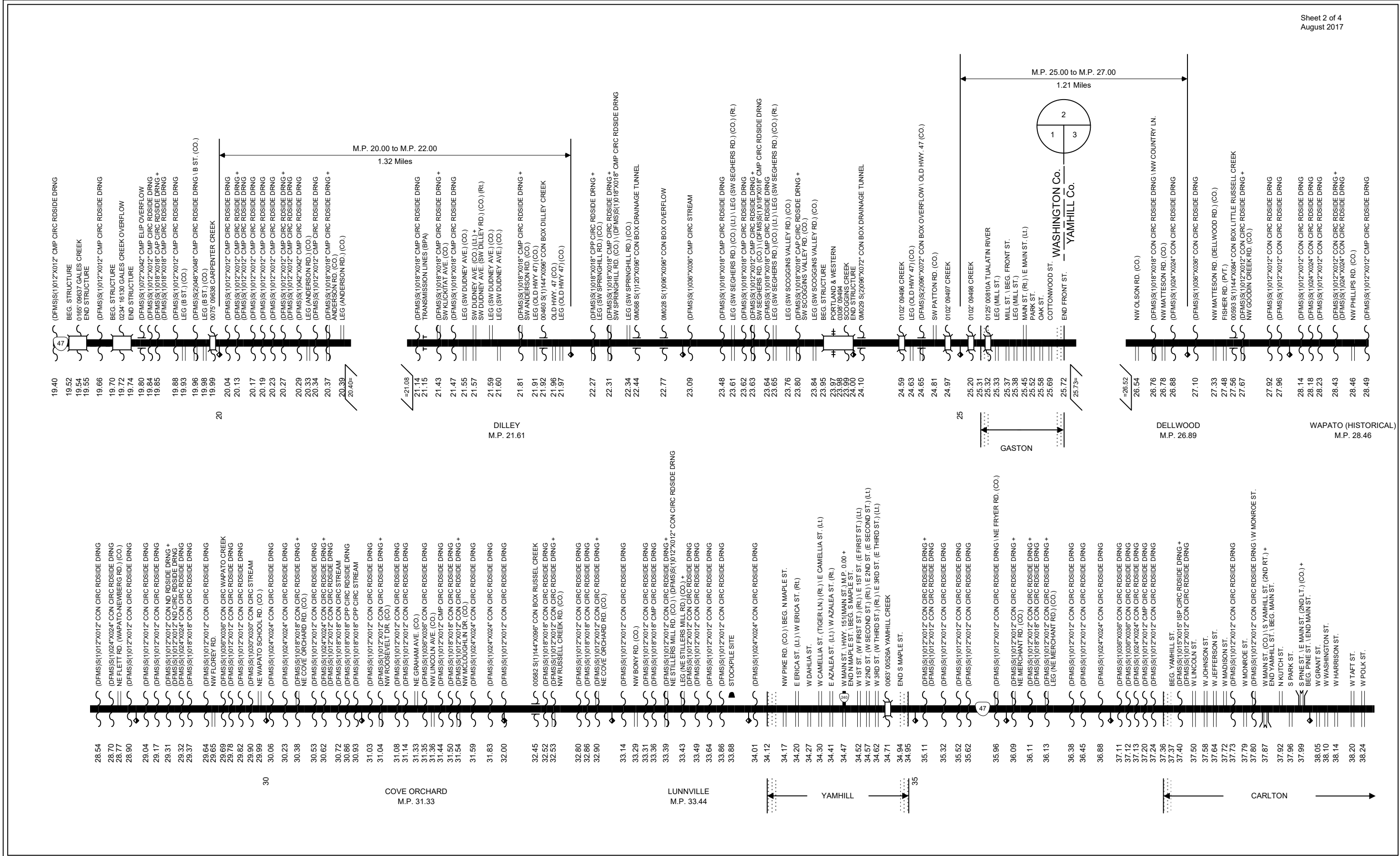

This product is for informational purposes and may not be suitable for legal, engineering, or surveying purposes. Users of this product should review and consult the primary data sources to determine the usability of the information. Conclusions drawn from such information are the responsibility of the user.

Region 2 District 3

TUALATIN VALLEY HIGHWAY No. 29

Sheet 3 of 4
August 2017

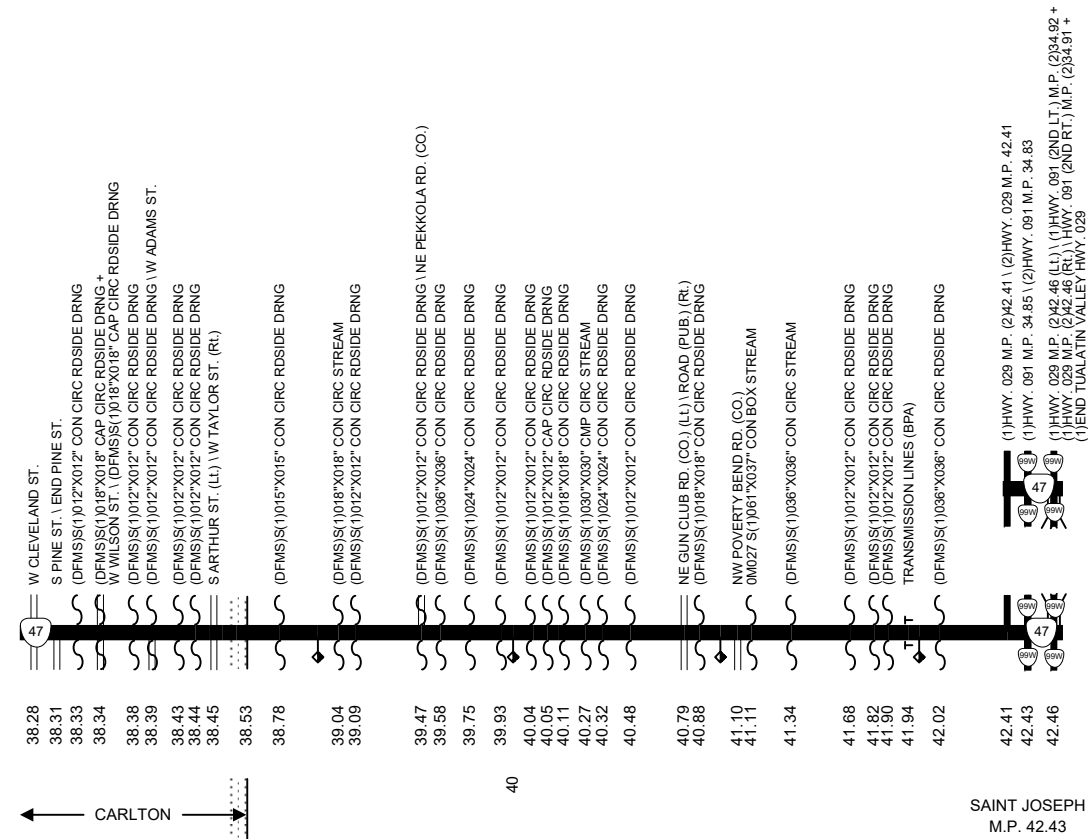

SYLVAN INTCHGE. CONNECTION

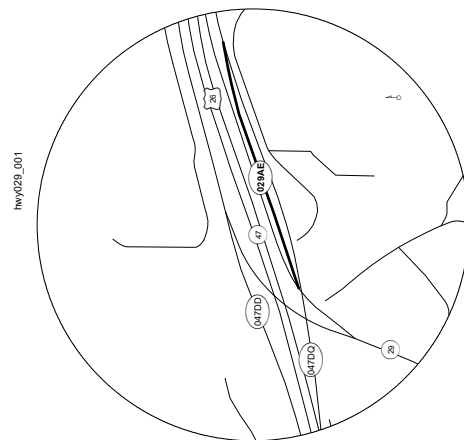

CONNECTION No. 1 (029AE)

0.15 HWY. 029 M.P. (2)0.15
 0.23 047DD CONN. M.P. 1C71.09
 0.41 WASHINGTON Co.
 MULTNOMAH Co.

Total Length 0.26 Miles

E BEAVERTON CONNECTIONS

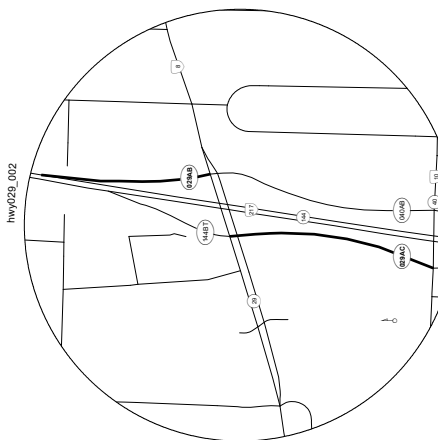

CONNECTION No. 1 (029AB)

2.85 HWY. 029 M.P. 2.85
 2.87 LEG (FROM HWY. 029)
 2.95 06618 S(1)207X096* CON BOX HALL CREEK
 3.08 HWY. 144 M.P. 1.22

Total Length 0.23 Miles

CONNECTION No. 2 (029AC)

2.94 HWY. 029 M.P. 2.94
 2.97 HWY. 029 M.P. (2)2.94
 2.99 LEG (HWY. 029)
 3.22 HWY. 040 M.P. 0.97+
 SW BEAVERTON HILLSDALE HWY.

Total Length 0.28 Miles

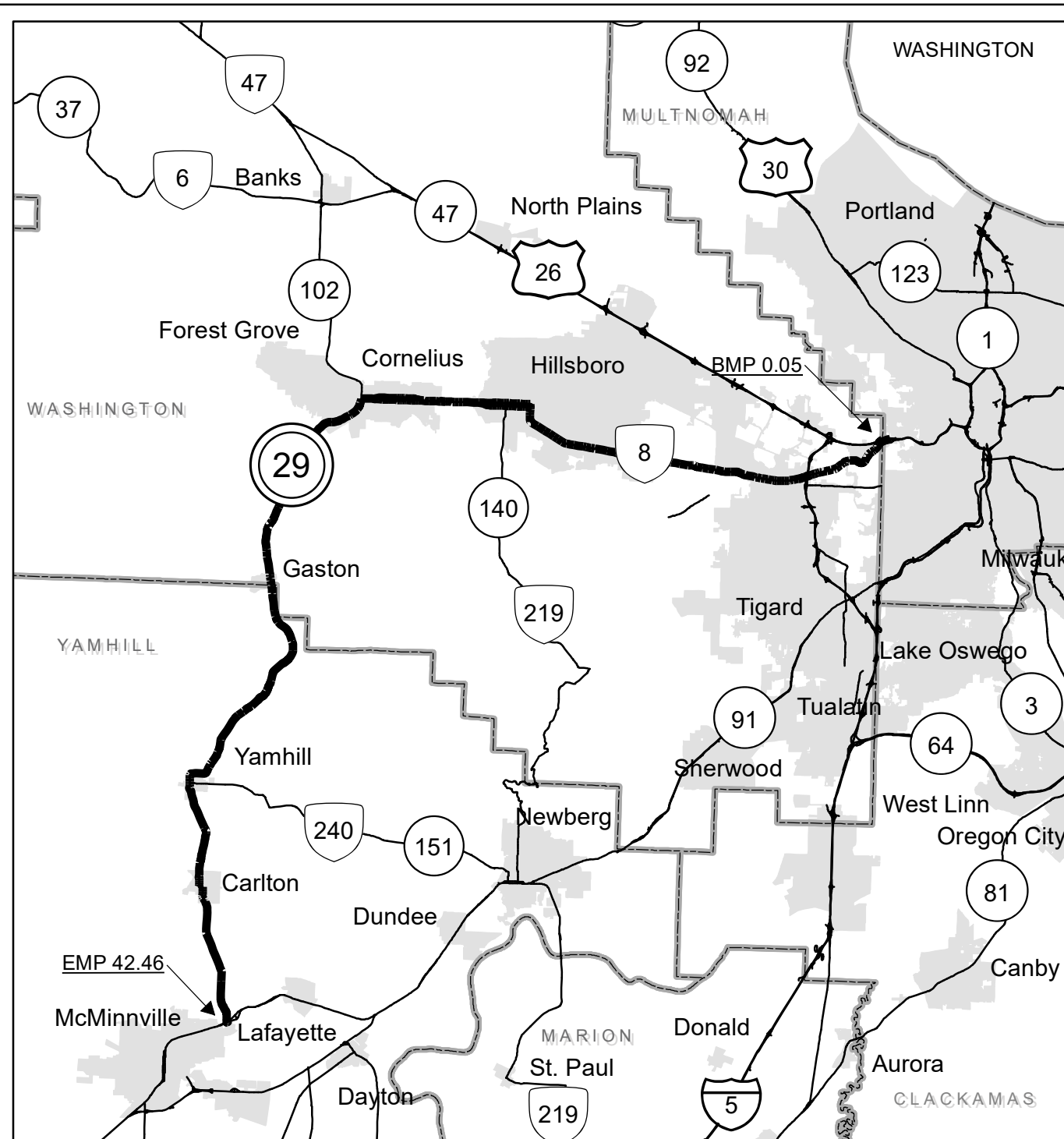

Legend

- State Highway No. 29
- State Highways
- County Boundaries
- City Boundaries

Interstate, US Route, State Route Markers

State Highways

0 1.75 3.5 7 Miles

The same information displayed on the Straightline Charts is updated monthly and available in tabular form on ODOT's Internet site. Use the Highway Inventory Summary report for more detailed information.
<https://www.oregon.gov/ODOT/DATA/Pages/Road-Assets-Mileage.aspx>
 NOTE: Milepoints on Straightline Chart are not to scale.

Note:
Jurisdiction of intersecting local roads as of:

Multnomah County	2017
Washington County	2017
Yamhill County	2017