

Region 1 District 2C

HISTORIC COLUMBIA RIVER HIGHWAY No. 100

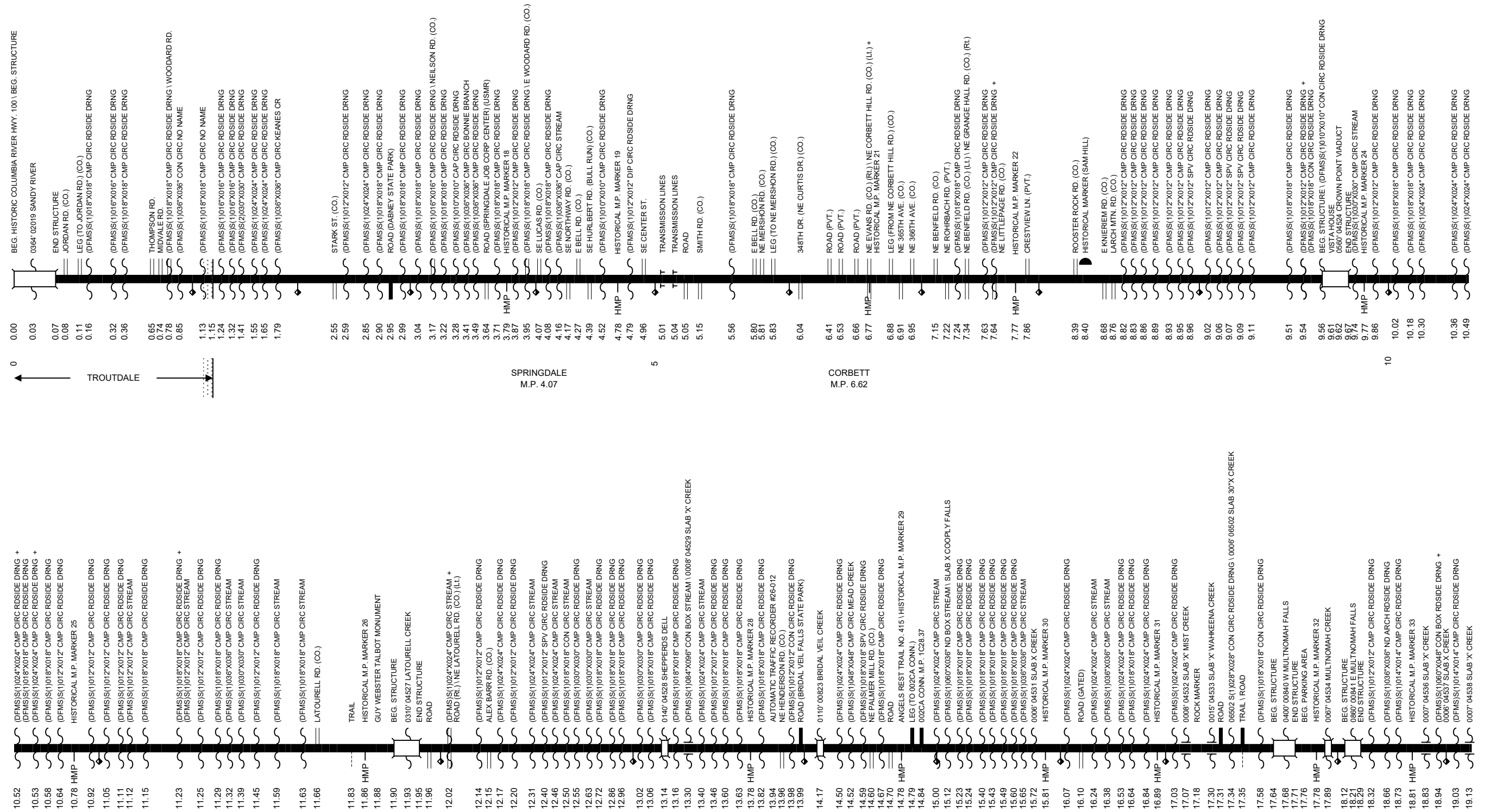

Region 1 District 2C / Region 4 District 9

HISTORIC COLUMBIA RIVER HIGHWAY No. 100

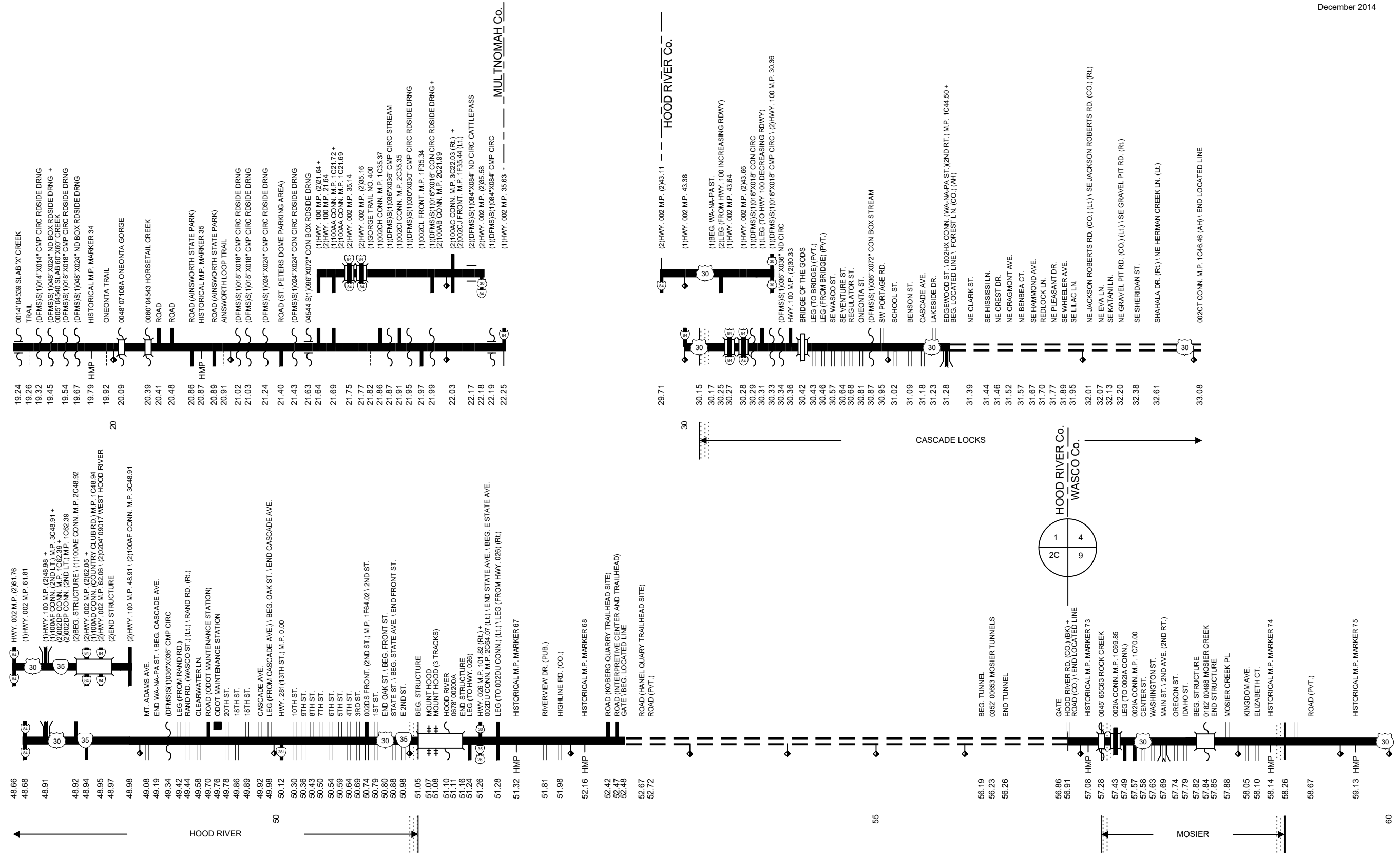

Region 4 District 9

HISTORIC COLUMBIA RIVER HIGHWAY No. 100

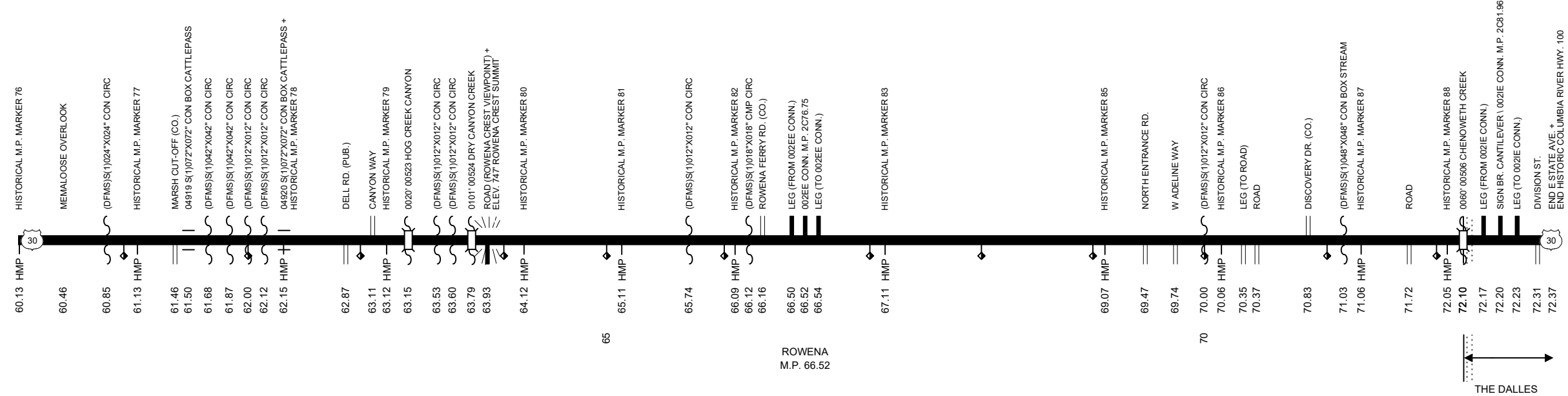

ROWENA
M.P. 66.52

THE DALLES

DODSON INTCHG CONNECTIONS

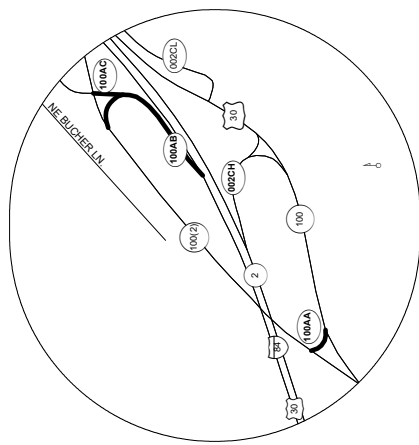

CONNECTION No. 1 (100AA)

21.69	HWY. 100 M.P. (2)21.69
21.72	HWY. 100 M.P. 21.69

Total Length 0.03 Miles

CONNECTION No. 2 (100AB)

21.99	HWY. 100 M.P. (2)21.99
22.03	100AC CONN. M.P. 3C22.06
22.14	HWY. 002 M.P. (2)35.31

Total Length 0.15 Miles

CONNECTION No. 3 (100AC)

22.03	HWY. 100 M.P. (2)22.03
22.06	100AB CONN. M.P. 2C22.03

Total Length 0.03 Miles

W HOOD RIVER CONNECTIONS

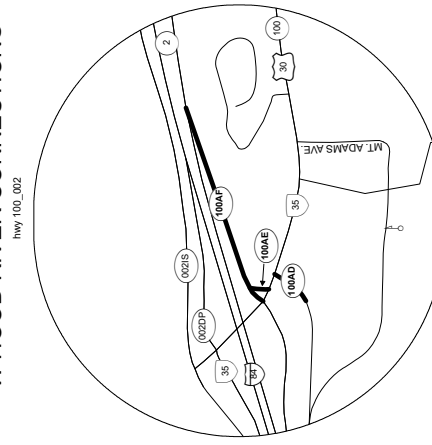

CONNECTION No. 1 (100AD)

48.94	HWY. 100 M.P. 48.94
48.98	COUNTRY CLUB RD. (CO.) (AH)

Total Length 0.04 Miles

CONNECTION No. 2 (100AE)

48.92	HWY. 100 M.P. 48.92
48.94	100AF CONN. M.P. 3C48.93

Total Length 0.02 Miles

CONNECTION No. 3 (100AF)

48.91	HWY. 100 M.P. 48.91 (RL) HWY. 100 M.P. (2)48.98 (LL)
48.93	100AE CONN. M.P. 2C48.94
49.13	HWY. 002 M.P. 62.29

Total Length 0.22 Miles

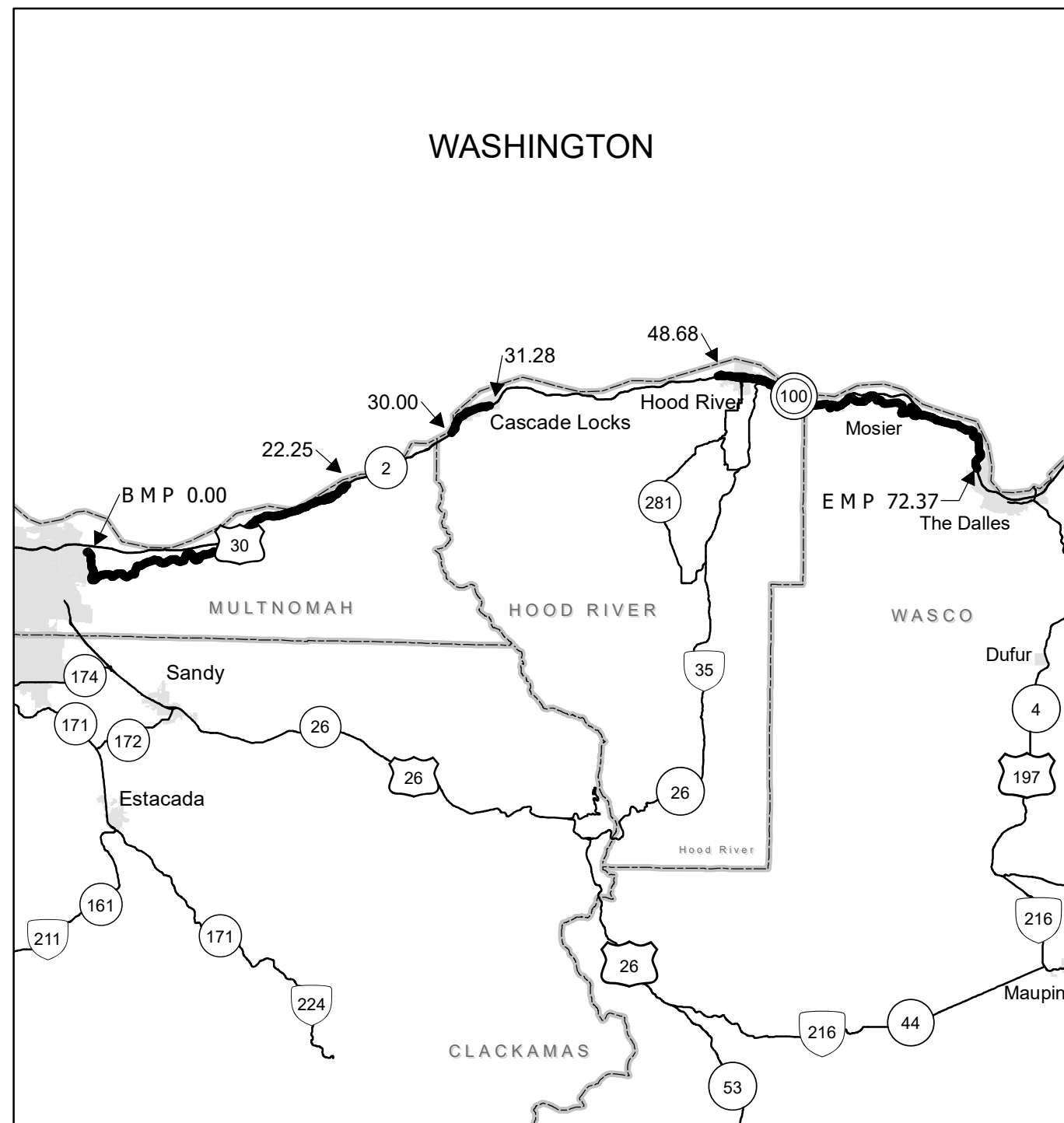

The same information displayed on the Straightline Charts is updated monthly and available in tabular form on ODOT's Internet site. Use the Highway Inventory Summary report for more detailed information.

<https://www.oregon.gov/ODOT/DATA/Pages/Road-Assets-Mileage.aspx>

NOTE: Milepoints on Straightline Chart are not to scale.

Note:

Jurisdiction of intersecting local roads as of:

Multnomah County	2012
Hood River County	2012
Wasco County	2012

Legend

- State Highway No. 100
- State Highways
- County Boundaries
- City Limits

- Interstate, US Route, State Route Markers
- State Highways

