

Region 2 District 4

SILETZ HIGHWAY No. 181

Sheet 1 of 3
October 2014

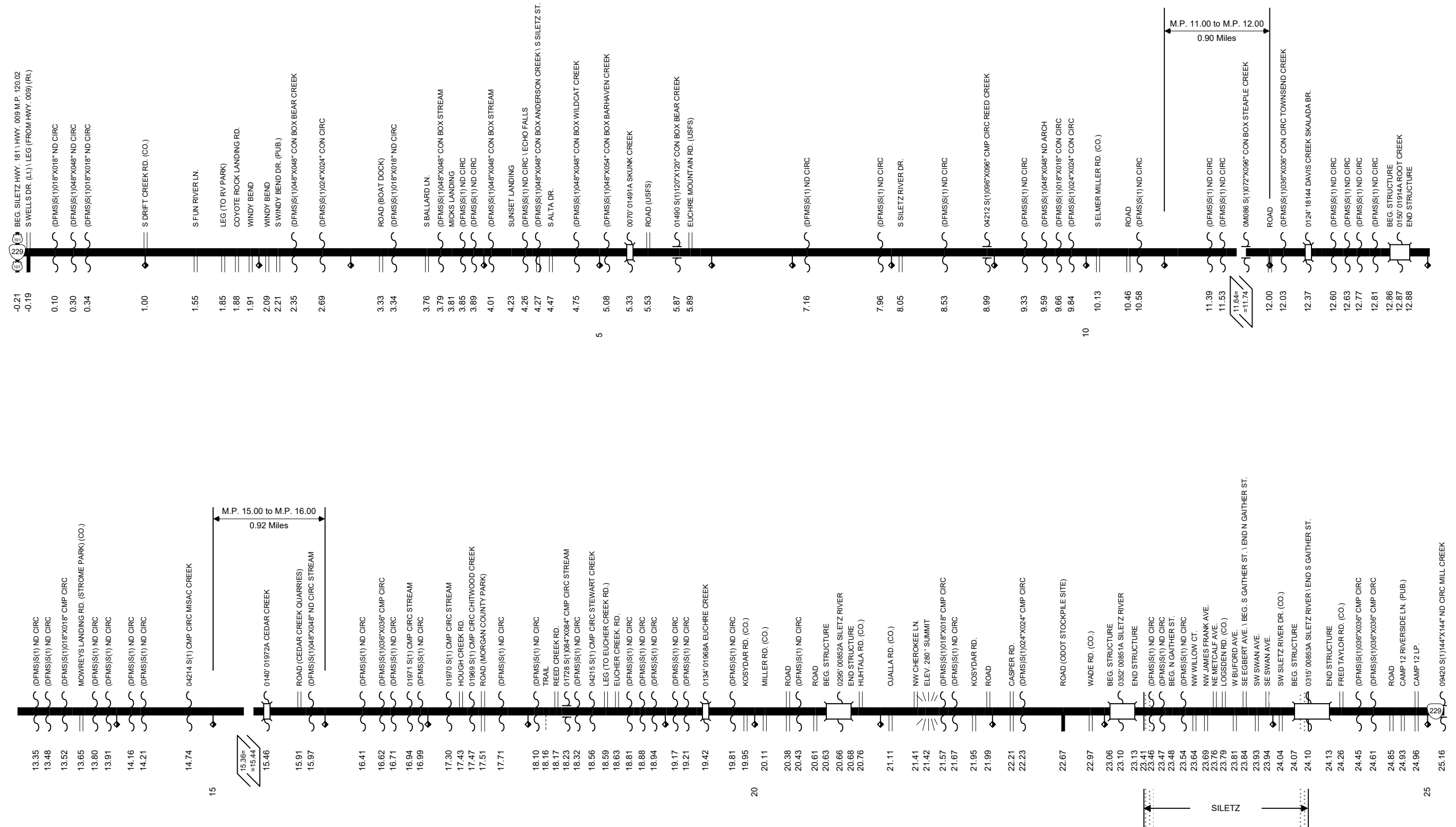

Region 2 District 4

SILETZ HIGHWAY No. 181

Sheet 2 of 3
 October 2014

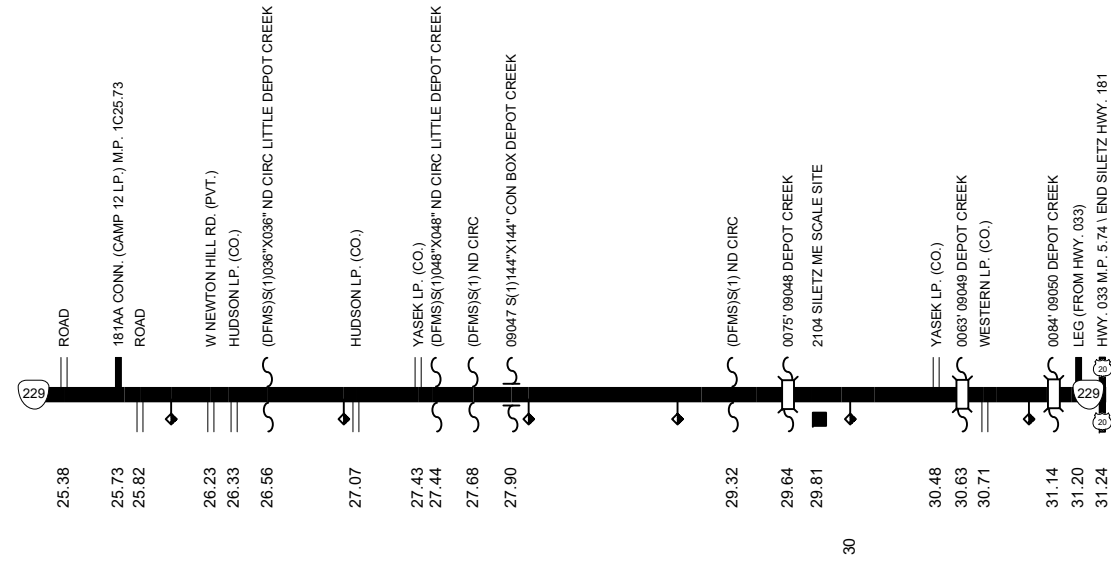

FRONTAGE RD. NO. 1
hwy181_002

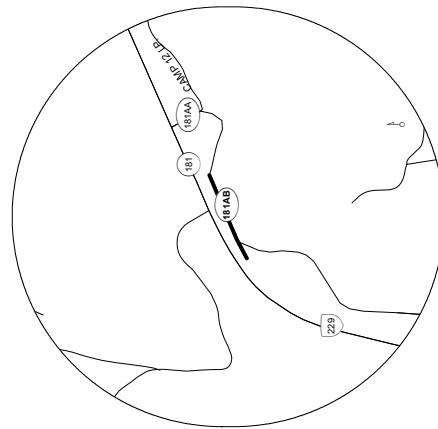

FRONTAGE RD. (181AB)

25.79 FRONTAGE RD. NO. 1 + ROAD (PUB.) (BK)
 25.88 ROAD (PUB.) (AH)

Total Length 0.09 Miles

FRONTAGE RD. NO. 2
hwy181_003

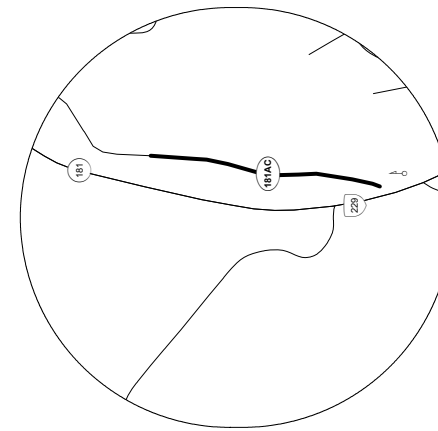

FRONTAGE RD. (181AC)

26.09 FRONTAGE RD. NO. 2 \ ROAD (PUB.) (BK)
 26.33 END FRONTAGE RD.

Total Length 0.24 Miles

COUNTY RD. CONNECTION
hwy181_001

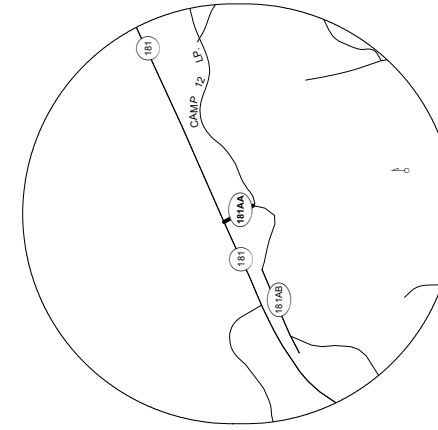

CONNECTION No. 1 (181AA)

25.73 HWY. 181 M.P. 25.73
 25.76 CAMP 12 LP. (CO.) (L1) \ ROAD (RL)

Total Length 0.03 Miles

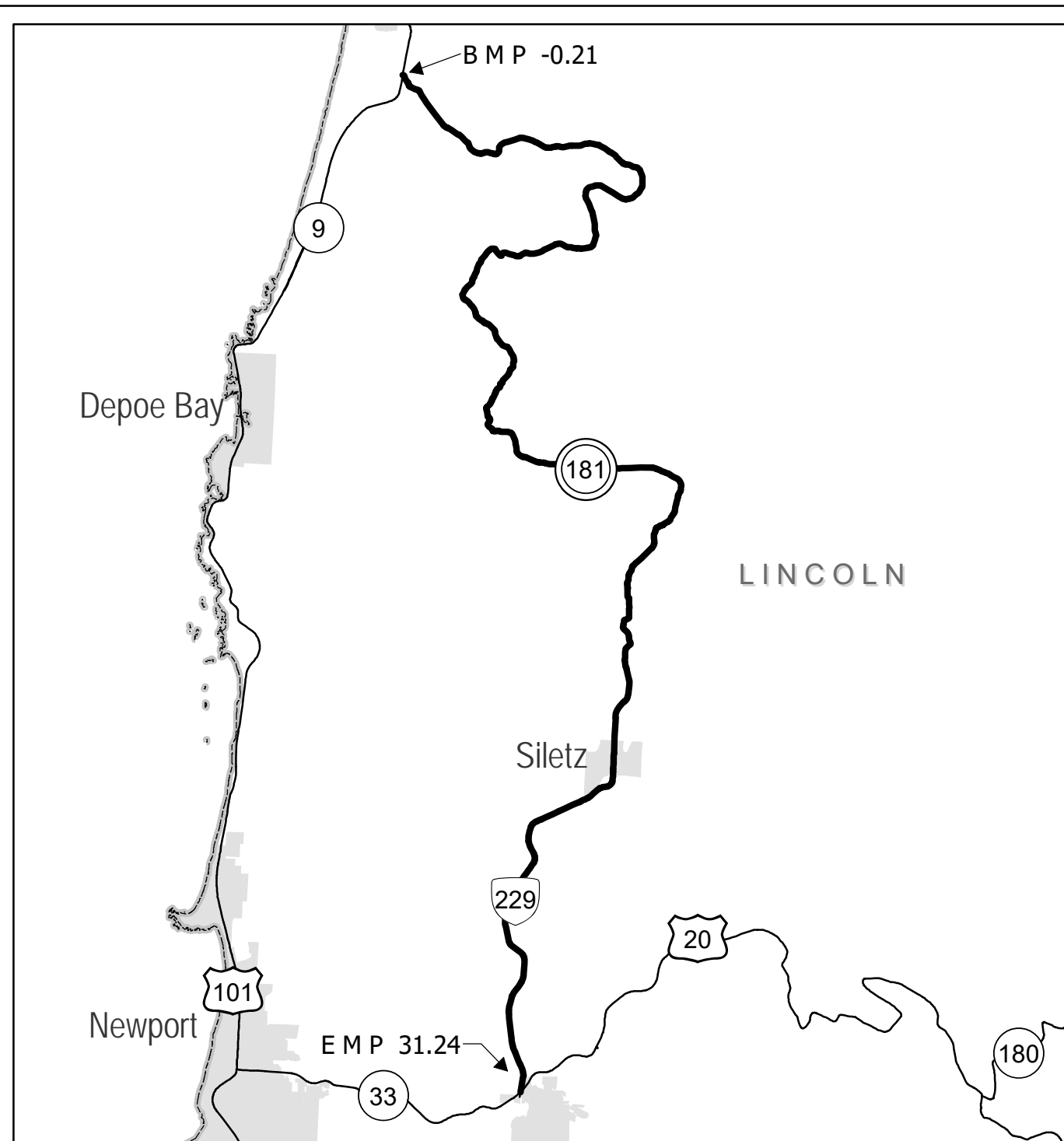

Legend

- State Highway 181
- State Highways
- counties
- City Limits

Interstate, US Route, State Route Markers

State Highways

0 1 2 4 Miles

The same information displayed on the Straightline Charts is updated monthly and available in tabular form on ODOT's Internet site. Use the Highway Inventory Summary report for more detailed information.

<https://www.oregon.gov/ODOT/DATA/Pages/Road-Assets-Mileage.aspx>

NOTE: Milepoints on Straightline Chart are not to scale.

Note:

Jurisdiction of intersecting local roads as of:

Lincoln County 2013