

Region 3 District 8 / Region 4 District 11

LAKE OF THE WOODS HIGHWAY No. 270

Sheet 1 of 4
January 2015

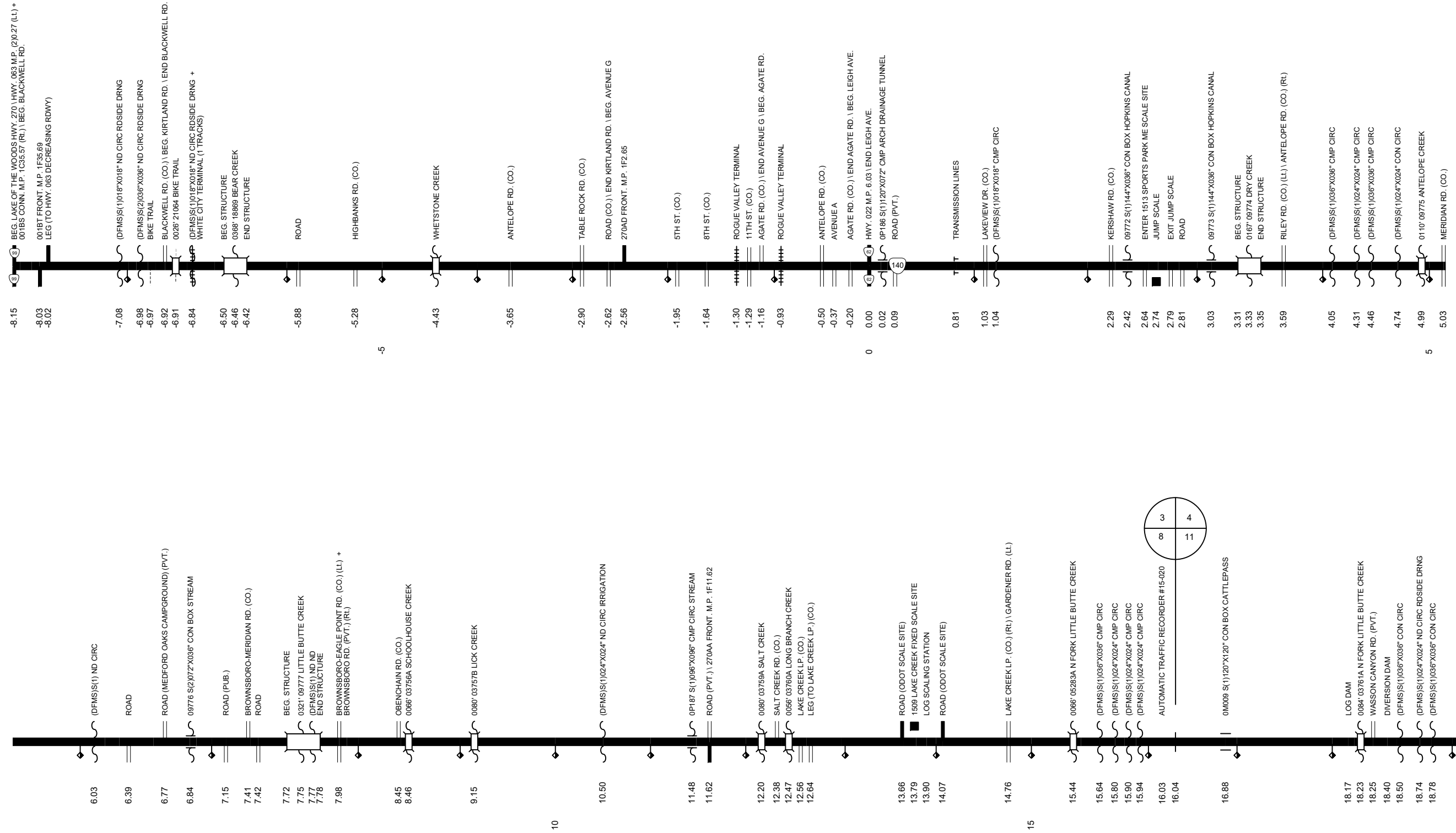

Region 4 District 11

LAKE OF THE WOODS HIGHWAY No. 270

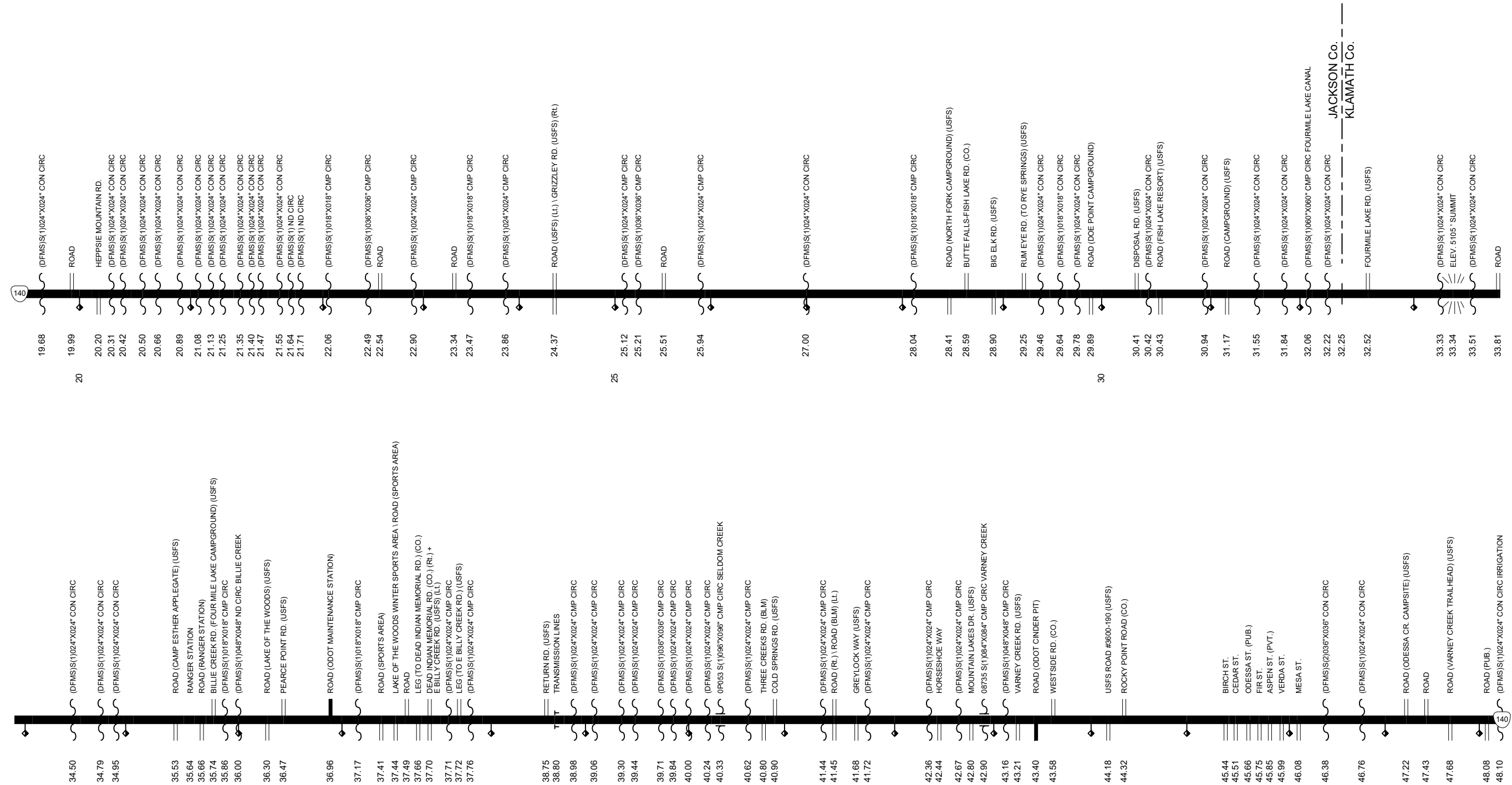

Region 4 District 11

LAKE OF THE WOODS HIGHWAY No. 270

Sheet 3 of 4
January 2015

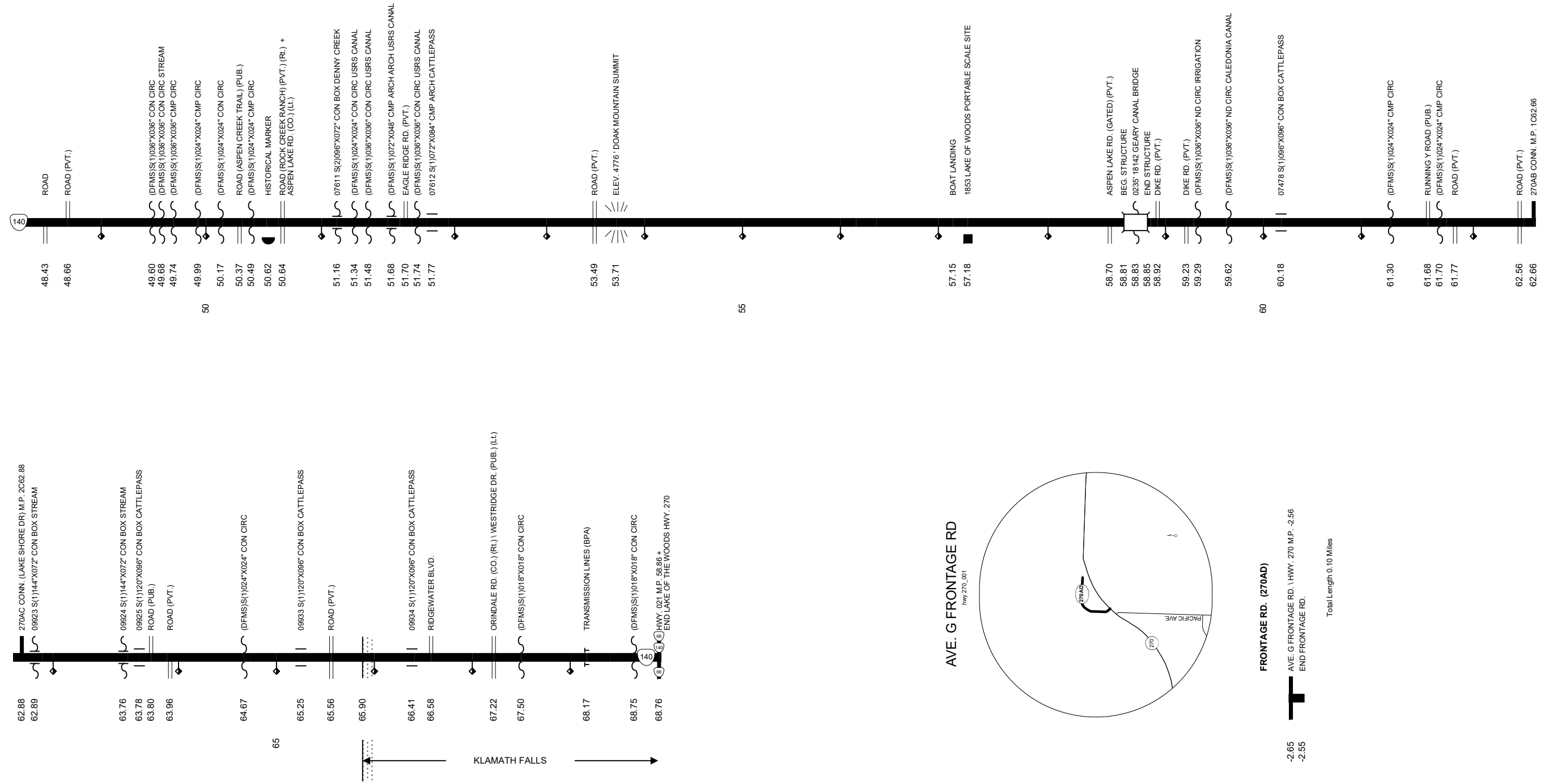

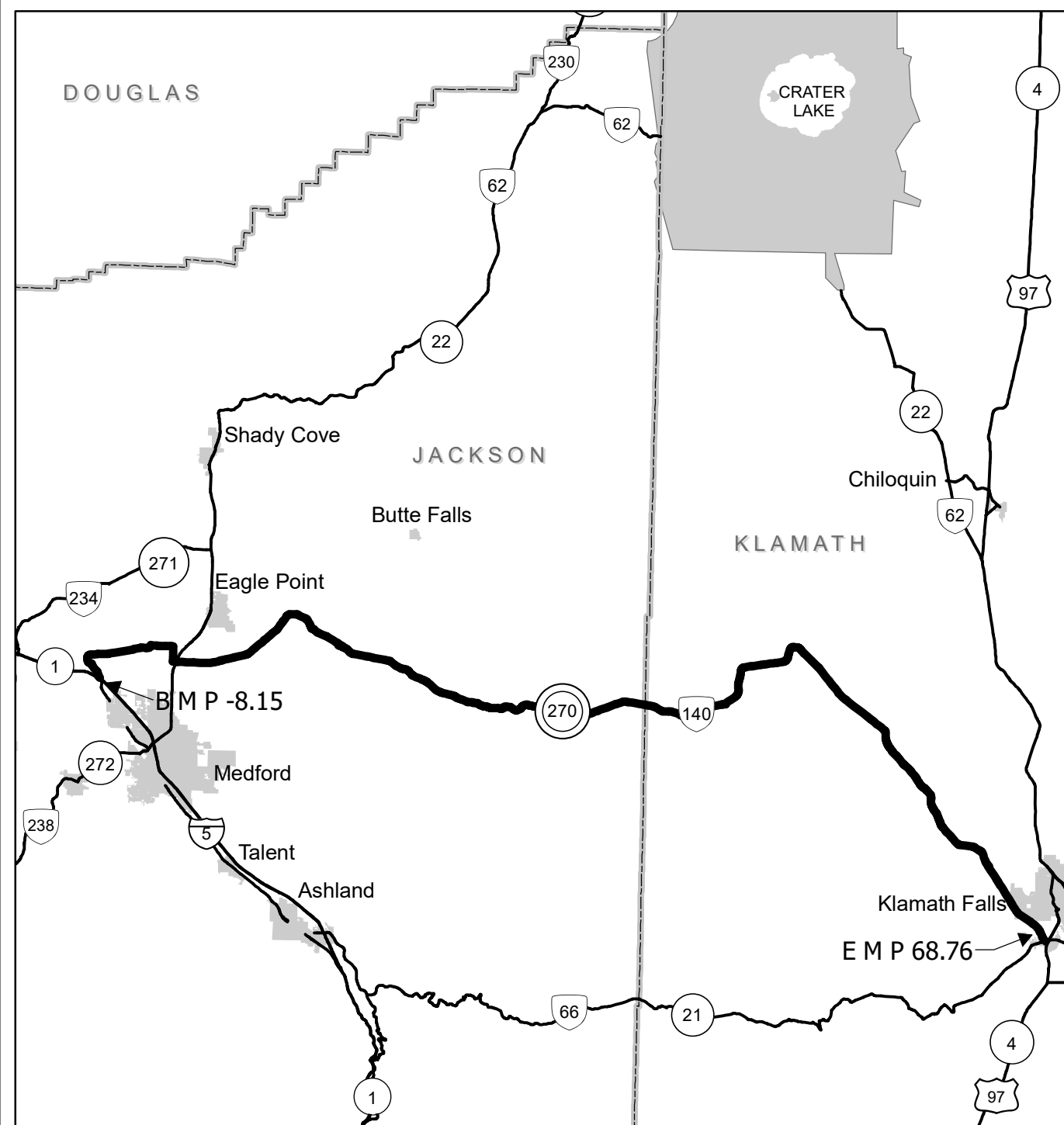

Legend
 — State Highway No. 270
 — State Highways
 [] County Boundaries
 [] City Limits

[] Interstate, US Route, State Route Markers
 [] State Highways

0 4 8 16 Miles

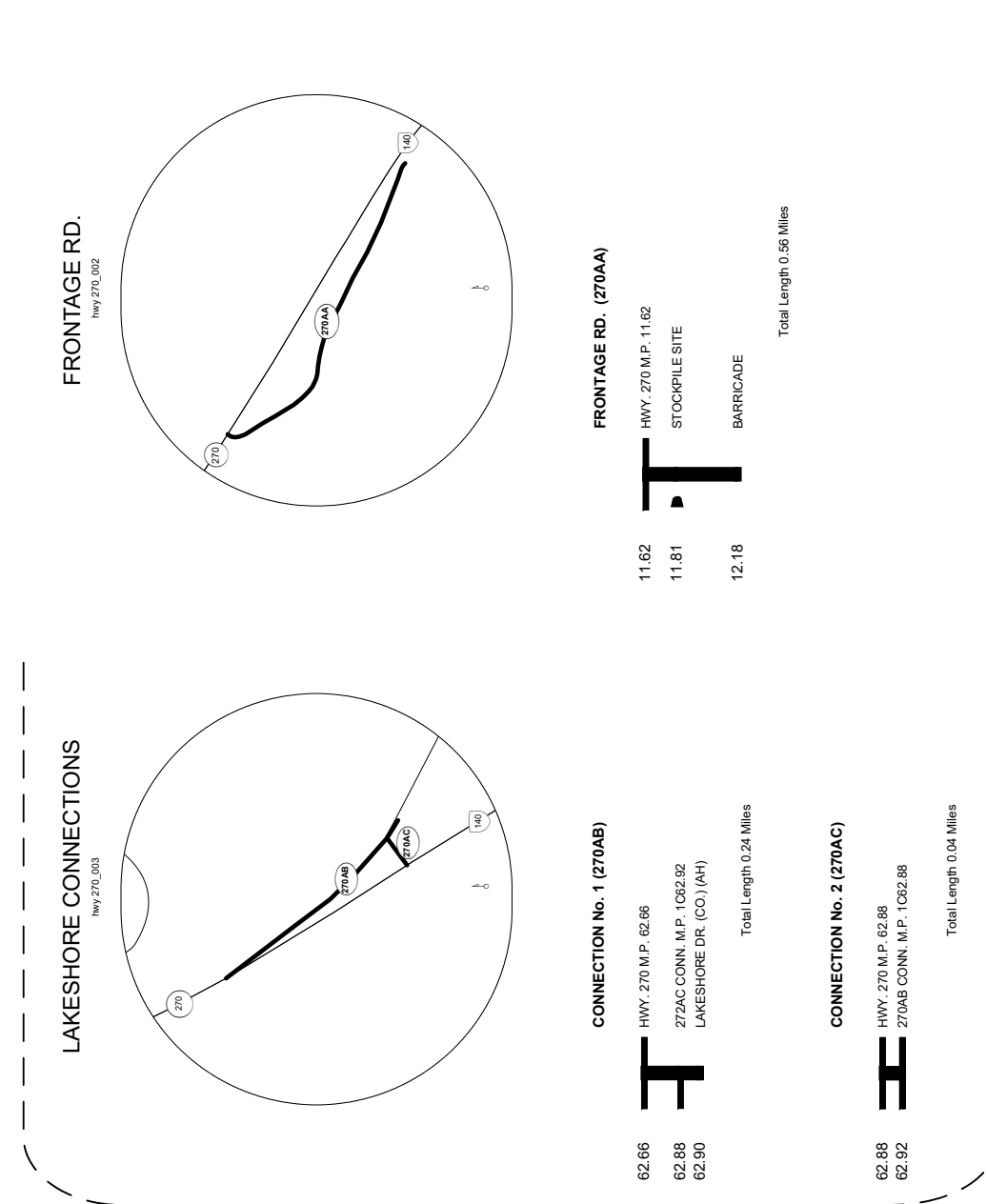

The same information displayed on the Straightline Charts is updated monthly and available in tabular form on ODOT's Internet site. Use the Highway Inventory Summary report for more detailed information.

<https://www.oregon.gov/ODOT/DATA/Pages/Road-Assets-Mileage.aspx>

NOTE: Milepoints on Straightline Chart are not to scale.

Note:

Jurisdiction of intersecting local roads as of:

Jackson County	2013
Klamath County	2013