

# Region 4 District 10

# ANTELOPE HIGHWAY No. 293

Sheet 1 of 2  
July 2015

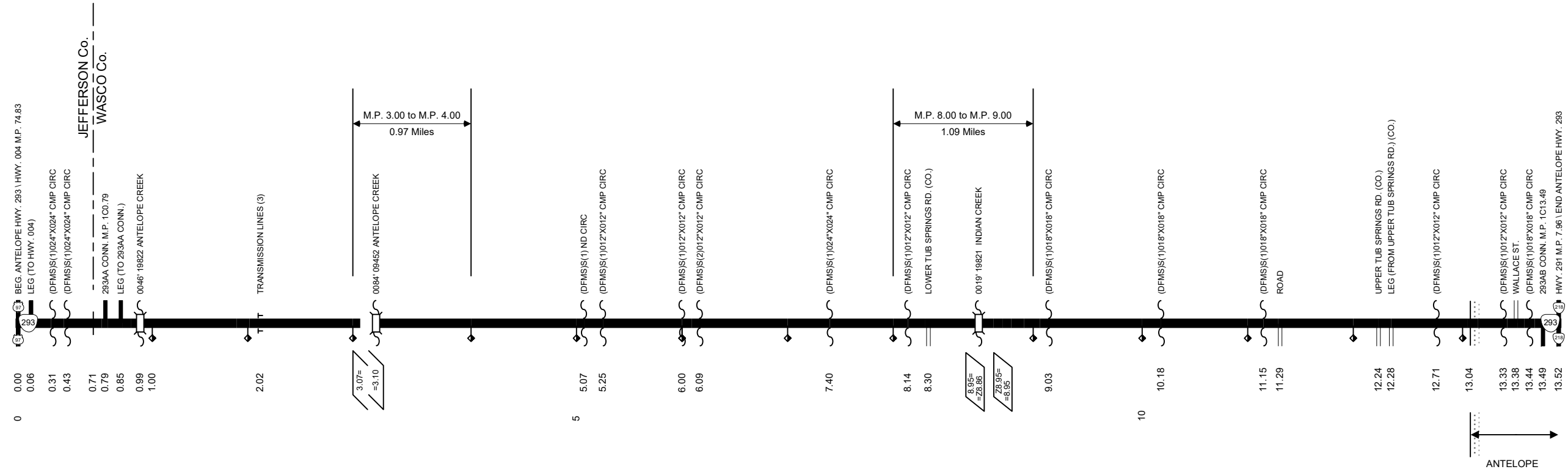

THE DALLES-CALIF HWY CONNECTION  
hwy293\_001

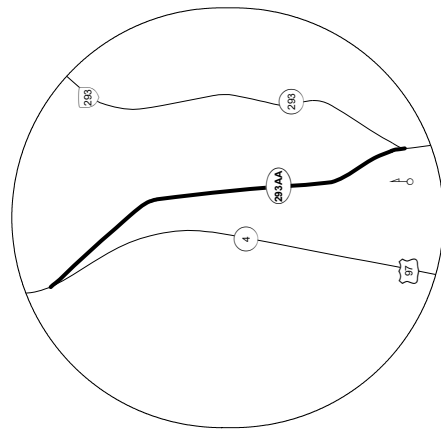

CONNECTION No. 1 (293AA)

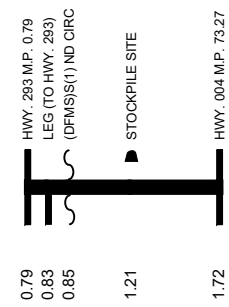

Total Length 0.93 Miles

SHANIKO-FOSSIL HWY CONNECTION  
hwy293\_002

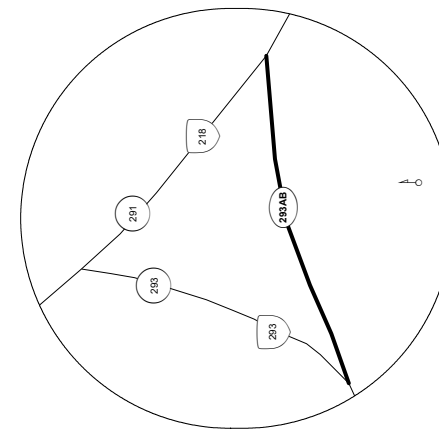

CONNECTION No. 1 (293AB)



Total Length 0.04 Miles

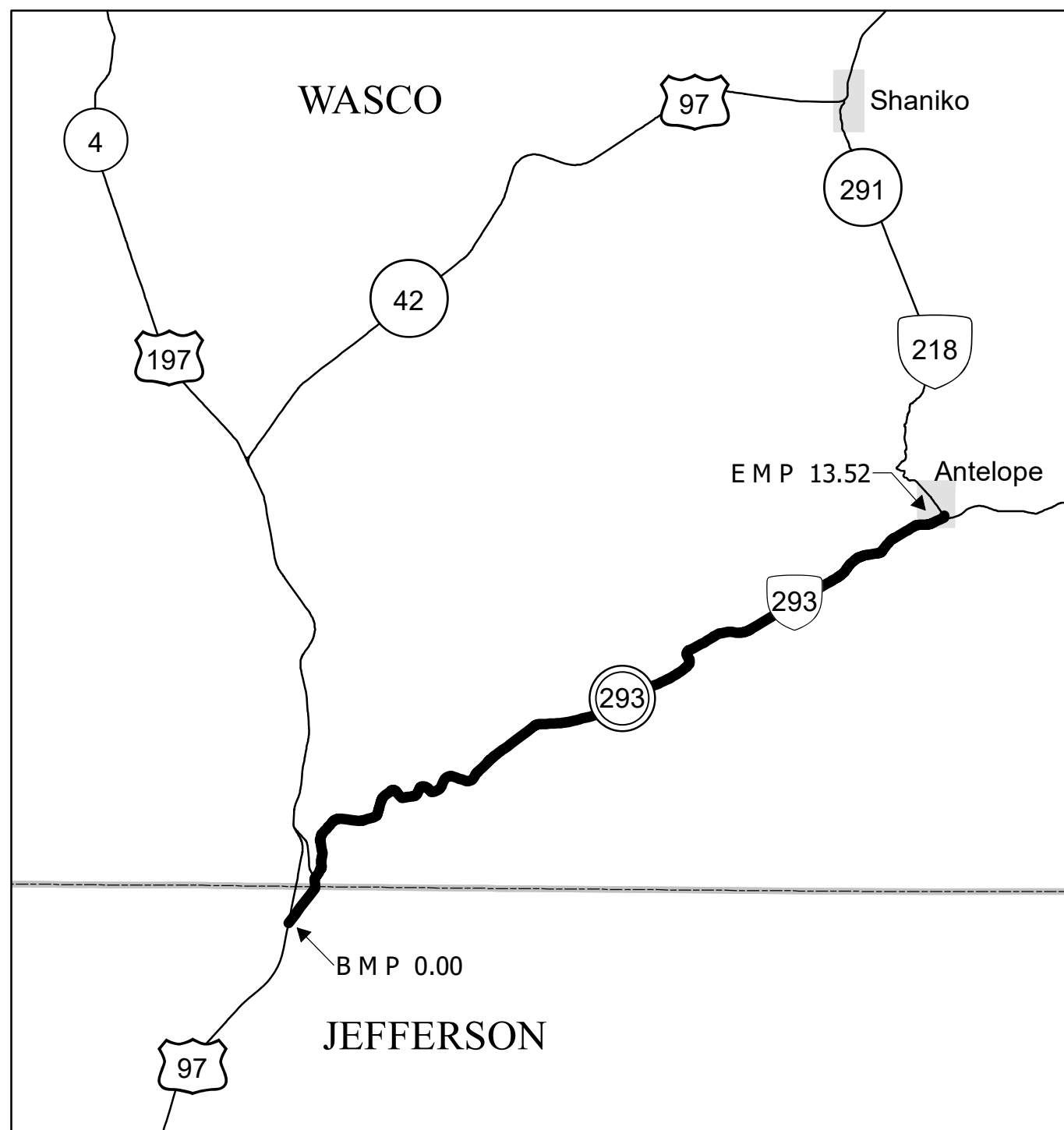

**Legend**

- State Highway No. 293
- State Highways
- County Boundaries
- City Limits

Interstate, US Route, State Route Markers

State Highways

0 1 2 4 Miles

The same information displayed on the Straightline Charts is updated monthly and available in tabular form on ODOT's Internet site. Use the Highway Inventory Summary report for more detailed information.

<https://www.oregon.gov/ODOT/DATA/Pages/Road-Assets-Mileage.aspx>

NOTE: Milepoints on Straightline Chart are not to scale.

Note:

Jurisdiction of intersecting local roads as of:

Jefferson County 2015

Wasco County 2015