

Workday Mobile App

Installation Quick Reference Guide

INSTALLING WORKDAY

Get the Workday mobile application on your device and set it up to access your account.

ANDROID

1. From your device, navigate to the **Google Play Store**.
2. Tap **Search** and enter *Workday*.
3. **Install** the Workday mobile app.
4. **Open** the Workday mobile app, once the app is downloaded.
5. Complete the initial setup by following the on-screen prompts.
6. The following screen will appear, and you will need to enter **Oregon** as your Company ID.
7. Select the appropriate login option
8. Enter your username (OR#), password, and then tap to Sign In

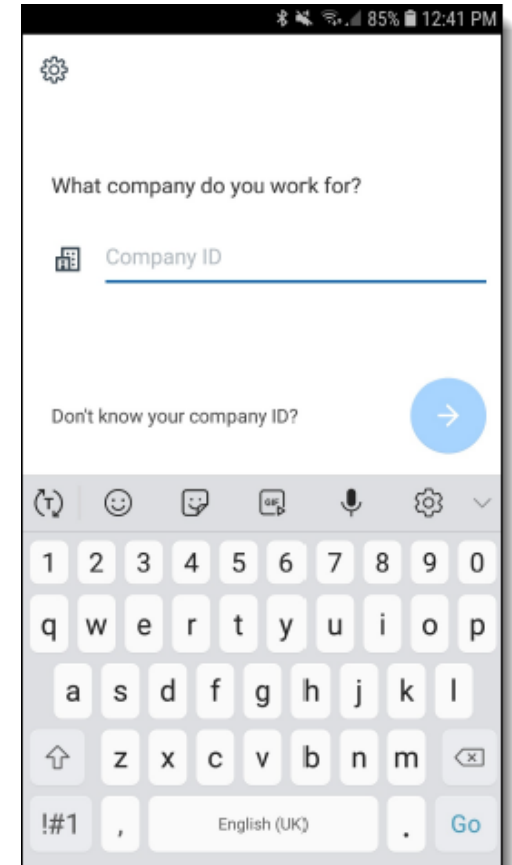

Workday Mobile App

Installation Quick Reference Guide

IPHONE AND IPAD

1. From your device, navigate to the **App Store**.
2. Enter *Workday* in the search field and select **Workday** from the search results.
3. Tap **Get** to install the Workday mobile app.
4. **Open** the Workday mobile app, once the app is downloaded.
5. Complete the initial setup by following the on-screen prompts.
6. The following image on the right will appear, enter "**Oregon**" as Company ID.
7. Select the appropriate login option
8. Enter your username (OR#), password, and then tap to Sign In

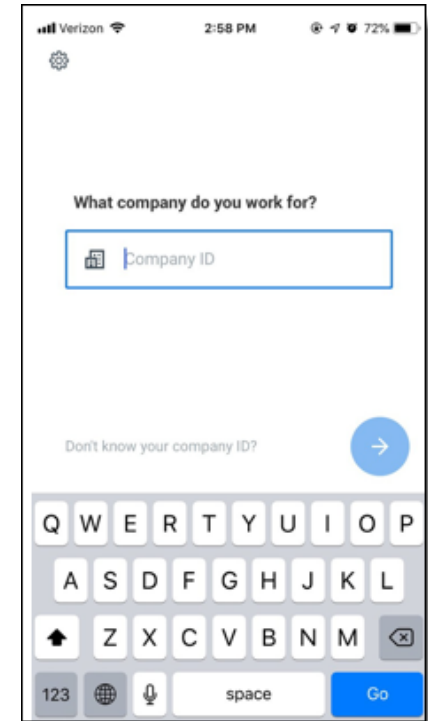

Additional Notes:

- You will need to click the “Notice to Users” link under the “sign in” button to read the security notice.
- The mobile version is great, but some features on the web version are not available for mobile.
- To add the Internet browser version to your mobile device, add it to your bookmarks.

You Can Access Workday Here: <https://wd5.myworkday.com/oregon/login.html>