

GHG reporting for fuel distributors training will begin shortly.

- Call in using the conference line – we will not be using the VOIP option
- Select dial in on the connection set up screen
- Follow instructions in the next pop-up to join the conference call

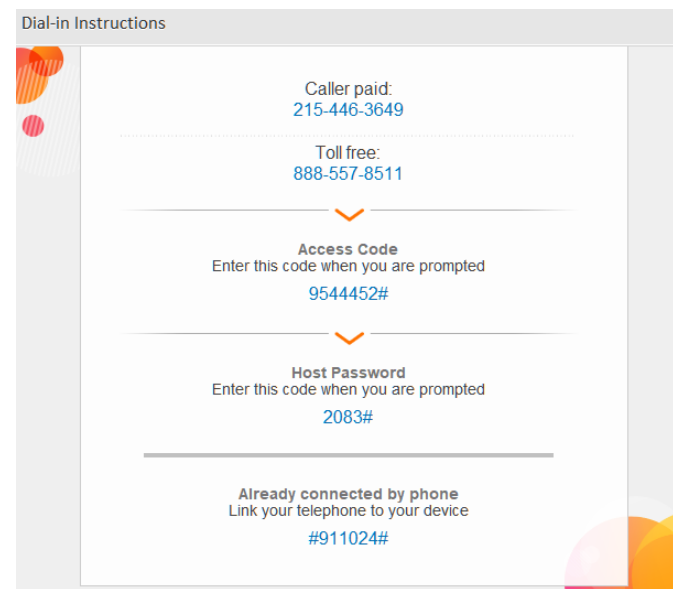
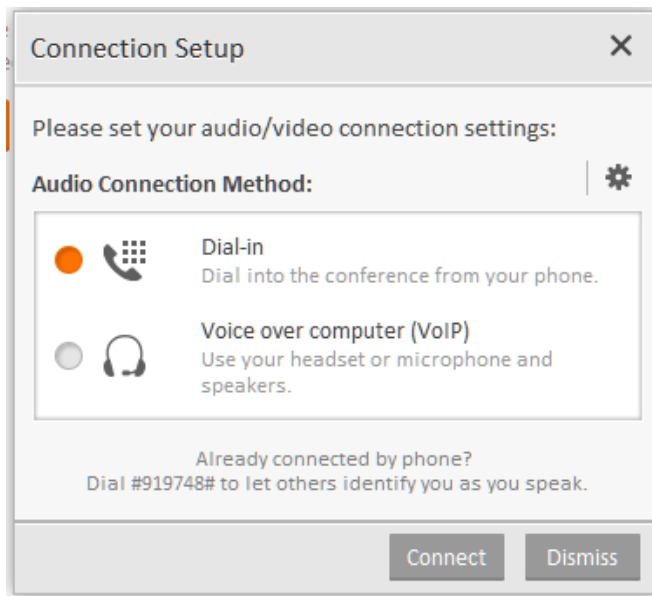

Greenhouse Gas Reporting

Greenhouse gas reporting for fuels

September 2018

Greenhouse Gas Reporting Background

Reported fuel quantity in barrels
2010-2017

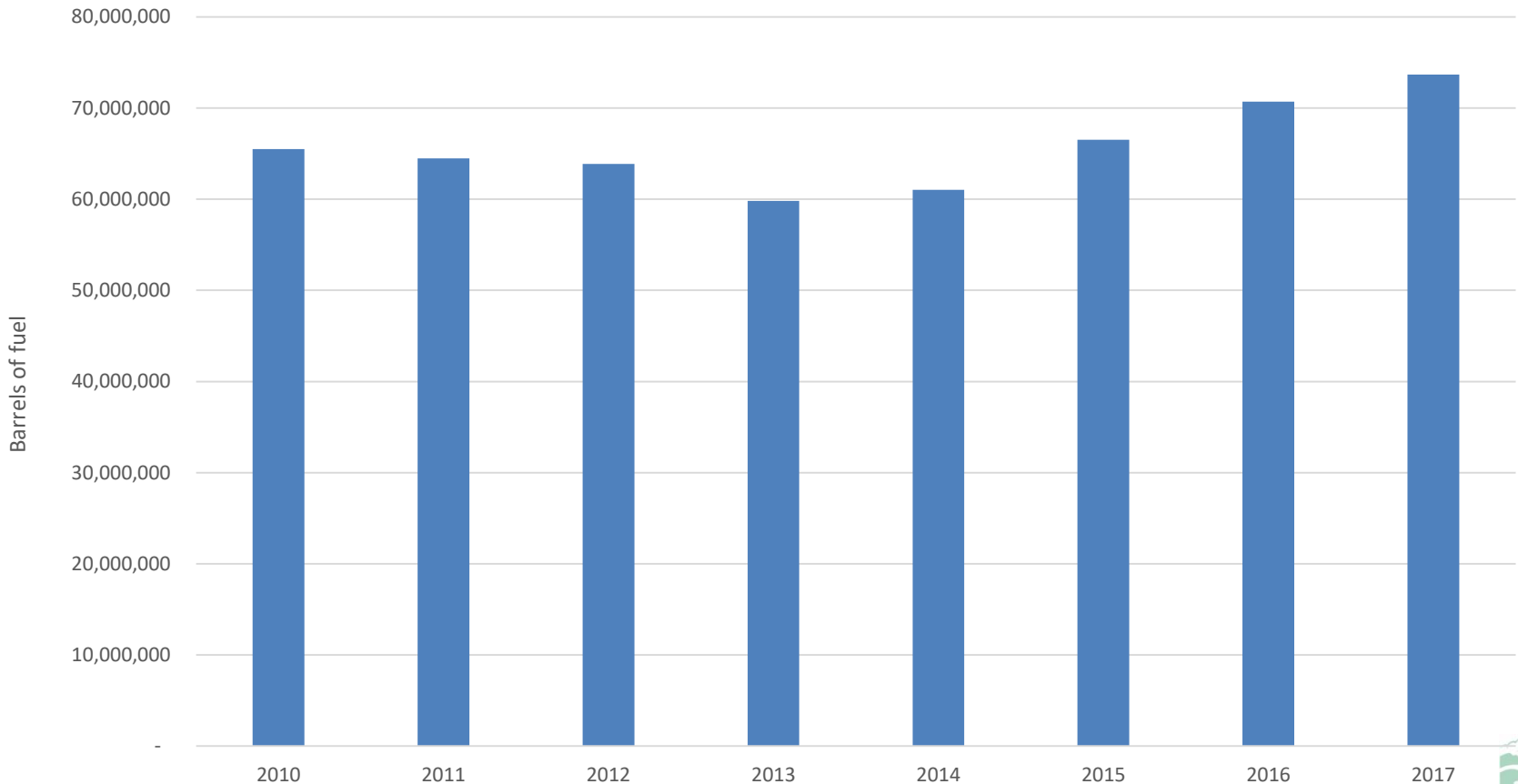

How is this data currently used?

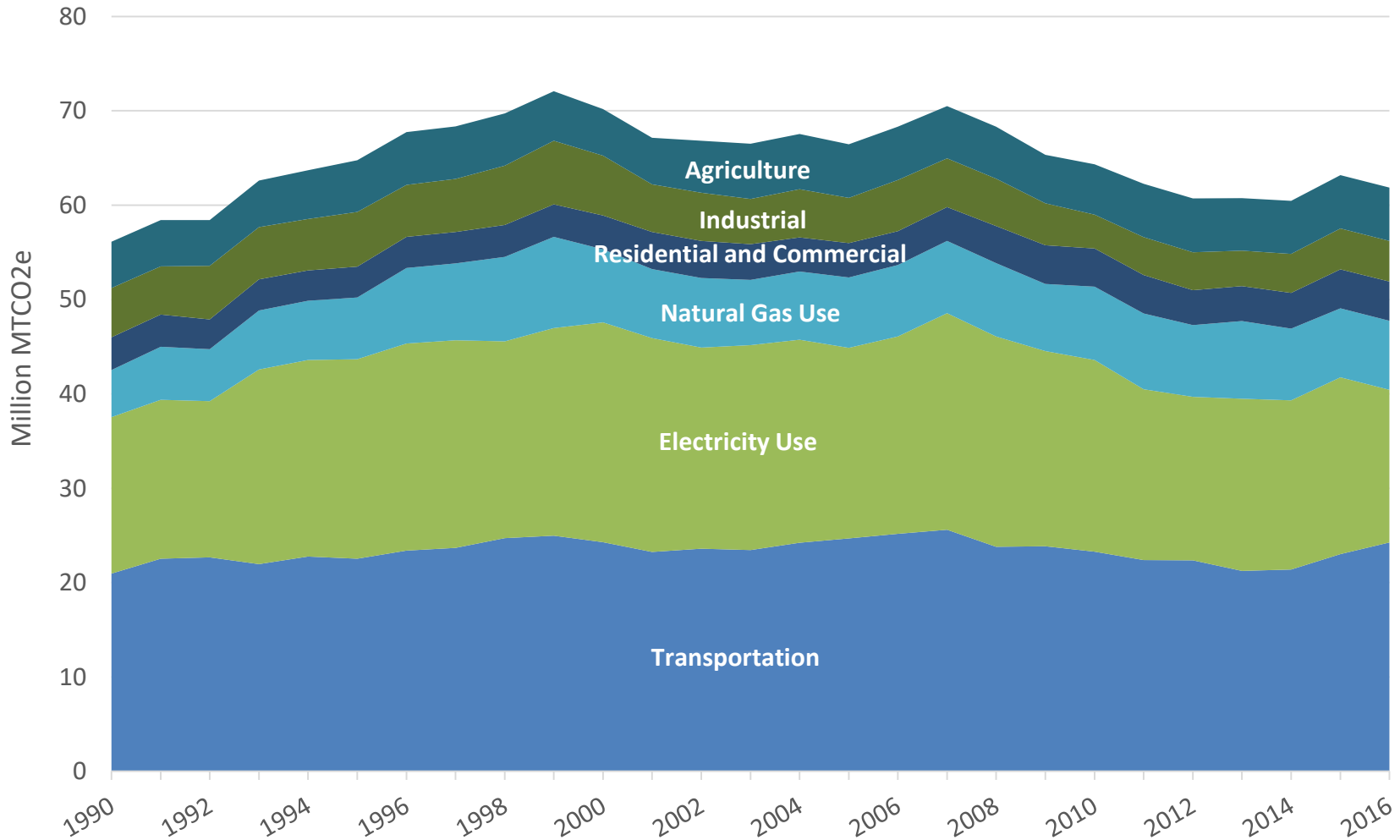

Who is required to report?

Distributor Categories

Position Holders

A person or company, who holds position at a terminal in Oregon.

Only position holders who own the fuel as it is being dispensed from the terminal report to our program.

Fuel Importers

Any person or company that brings fuel into the state of Oregon, by any means (barge, rail, truck, etc.), for use in Oregon.

For the purposes of the GHG RP, this category does not report any fuel brought into the state and subsequently stored at a terminal.

What does each category report?

Position Holder

- Report net volume of any fuel type transported by any means (barge, pipeline, etc.) into Oregon that the company or person owns as it is being dispensed at the rack
- Regardless of what that fuel is being used for – transportation, non-transportation, stationary combustion, etc.
- Exclude any quantity of fuel that is known to be exported out of the state.

Fuel Importer

- Report net volume of any fuel type transported into Oregon, by any means, for use in the state.
- Exclude fuel transported in and subsequently stored at an Oregon terminal.
- Exclude any quantity of fuel that is known to be exported out of the state.

What to report

Fuel Types

Report net volumes, in barrels of fuel, by fuel type as defined in EPA 40 CFR Part 98 Subpart MM

- Currently the tool accepts the following fuel types: gasoline, distillate fuel types, propane, kerosene, residual fuel oil

Gasoline is categorized as

- summer vs winter
- reformulated vs conventional, and
- regular, midgrade, or premium

Distillate fuel oil is categorized as #1, #2, or #4

Report diesel type unknown or gasoline formulation unknown, if do not know details about the fuel

Reporting Details

Include all fuel, regardless of end use

- i.e., dyed diesel, fuel intended for stationary combustion (home heating, etc.)

Volumes must be reported in barrels and not gallons

- 42 gallons = 1 Barrel

Report blended ethanol and biodiesel as a percentage of net total barrels

What not to report

All reporters

Do not report exported fuel volumes

Position Holder

To prevent double counting:

Do not report fuel volumes that your company does not hold title to as it is being dispensed from terminal.

Fuel Importer

To prevent double counting:

Do not report in this category any fuel imported by rail, truck, marine vessel or other method where that fuel is subsequently stored at an Oregon terminals. Any fuels stored at an Oregon terminal will be reported using the position holder category.

Reporting Deadline & Application for Reporting

Deadline: March 31st following the previous calendar year.

On March 31st, 2019 all data for the 2018 calendar year must be submitted.

Reporting Tool: Use DEQ's online reporting tool, EZ-Fuels. Data must be entered and submitted.

Please note: It is important that all users go through the final submittal stage in the tool to be in compliance with the reporting requirement. This signifies to us that you have finished reporting.

Report Status

Emissions Year	2017
Submittal Status	Submitted
Editing Status	Un-locked
Last Status Update	3/29/2018 1:55:50 PM
Status Update By	Example



Electronic Reporting with EZ-Fuels



Oregon Department of Environmental Quality

Fuel Distributor Online Reporting Tool > Home Page

DEQ
Home

EZ-Fuels Online Reporting Tool for Fuel Distributors

EZ-Fuels is the online reporting tool that gasoline, diesel, propane, and aircraft fuel distributors must use to register and report greenhouse gas emissions to the Oregon Department of Environmental Quality. This tool replaces the reporting form used in previous years.

EZ-Fuels makes the reporting process easier and more reliable by automating the calculation process for fuel suppliers, retaining facility information so a reporter does not have to re-enter this information in future years and providing a simple structure to complete the annual emissions report.

Click [here](#) for more information about how to use the EZ-Fuels Reporter tool.

Fuel distributors must annually report by March 31 following the distribution year.

Please note: To register and access EZ-Fuels, users will need a fuel distributor identification number provided by DEQ. Reporters who don't currently have a fuel distributor identification number should contact the DEQ greenhouse gas program staff for assistance. For additional information please see [this page](#) for the reporting protocols gasoline, diesel, propane, and aircraft fuel distributors are required to use.

Contact Us @ GHGReport@deq.state.or.us
Oregon Department of Environmental Quality
Headquarters: 700 NE Multnomah Street, Suite 600 Portland, OR 97232
Phone: 503-229-5696 or toll free in Oregon 1-800-452-4011

User Name:
Password:

[Forgot User Name or Password](#)
[New User Registration](#)

Website: <https://www.deq.state.or.us/EZFuels>

Emissions Calculations

$$\text{CO}_{2i} = \text{Product}_i * \text{EF}_i \quad (\text{Eq. MM-1})$$

CO2 emissions in metric tons =
barrels of fuel * emission factor (kg CO2/barrel) *.001 metric ton/kg

CO2 emissions are the only greenhouse gas emissions calculated in EZ-Fuels

Data posted on our website includes methane (CH4) and nitrous oxide (N2O) emissions estimates from fuel combustion.

Verification and Enforcement

Annual Verification

Data is reviewed for unusual changes and anomalies

- Includes a year to year comparison of quantities by fuel type
- A comparison to data collected by the Clean Fuels Program
- A comparison to ODOT fuel tax data

Enforcement

We have never had to go fully down this path – thank you!

Reporting is a regulatory requirement, an entity triggers enforcement when it:

- Does not submit a report by March 31
- Does not respond to requests for correction of submitted information
- Falsifies information on their reporting

Frequently Asked Questions & Issues

What is summer/winter fuel?

- Summer fuel is a category based on the RVP of the fuel at that time of year, RVP should be on the bill of lading
- Generally, summer fuel is any fuel sold between May 1 & Sept 15 because it is a federal regulation that the fuel be made to that specification

I reported to the Clean Fuels Program, do I have to report to you?

- Yes, CFP is a separate program and you must report to both if you import over 500,000 gallons of finished fuels. If you report less than 500,000 gallons you only need to report to GHG RP.

Is there a threshold for your program?

- Unlicensed sellers importing less than 5,500 gallons of tax-exempt fuel do not need to report.
- All licensed fuel sellers and dealers must report.

GHG & The Clean Fuels Program

Major differences between the programs

- The GHG program requires the reporting of all fuel types for any use while the CFP program is focused on transportation fuels.
- The GHG program requires reporting by small importers – defined as fuel importers bringing in less than 500,000 gallons of finished fuels in a calendar year – only report to CFP if over 500,000 gallons.
- The GHG program is an annual report while the CFP program has both quarterly and annual reporting requirements.
- The GHG program requires reporting of net volumes while the CFP requires transactional reporting including exported volumes.

Contact information

General Contact:

GHGreport@deq.state.or.us

Staff Contacts:

Stephanie Summers

Email: Summers.Stephanie@deq.state.or.us

Phone: 503-229-6918

Elizabeth Elbel

Email: Elbel.Elizabeth@deq.state.or.us

Phone: 503-229-6476

Documents can be provided upon request in an alternate format for individuals with disabilities or in a language other than English for people with limited English skills. To request a document in another format or language, call DEQ in Portland at 503-229-5696, or toll-free in Oregon at 1-800-452-4011, ext. 5696; or email deqinfo@deq.state.or.us.