

NW Metals Inc. Shredding Division Activity Discription

- NW Metals shredding division accepts useful and valuable processed ferrous and non ferrous scrap which include ELV's, sheets metals, left over metal used during manufacturing from industrial and commercial facilities such as auto wreckers, dismantlers, machine shops, manufacturing facilities, body shops, etc.
- All material brought to NW Metals is weighted and accepted.
- Materials are sorted into shredd or torch material.
- Torch materials are cut into small pieces either by a plasma cutter or torch.
- Shred material are feed into the Arjes Shredder. shredded material is conveyed to a separation system. A magnet drum captures and separates the ferrous material. Non ferrous material is then separated into zorba(aluminum fractions) and fluff by a non-ferrous separator.
- Recovered ferrous scrap and Zorba (aluminum fractions) are sold nationally and internationally.
- fluff is disposed of at an authorized landfill.

N Columbia Blvd

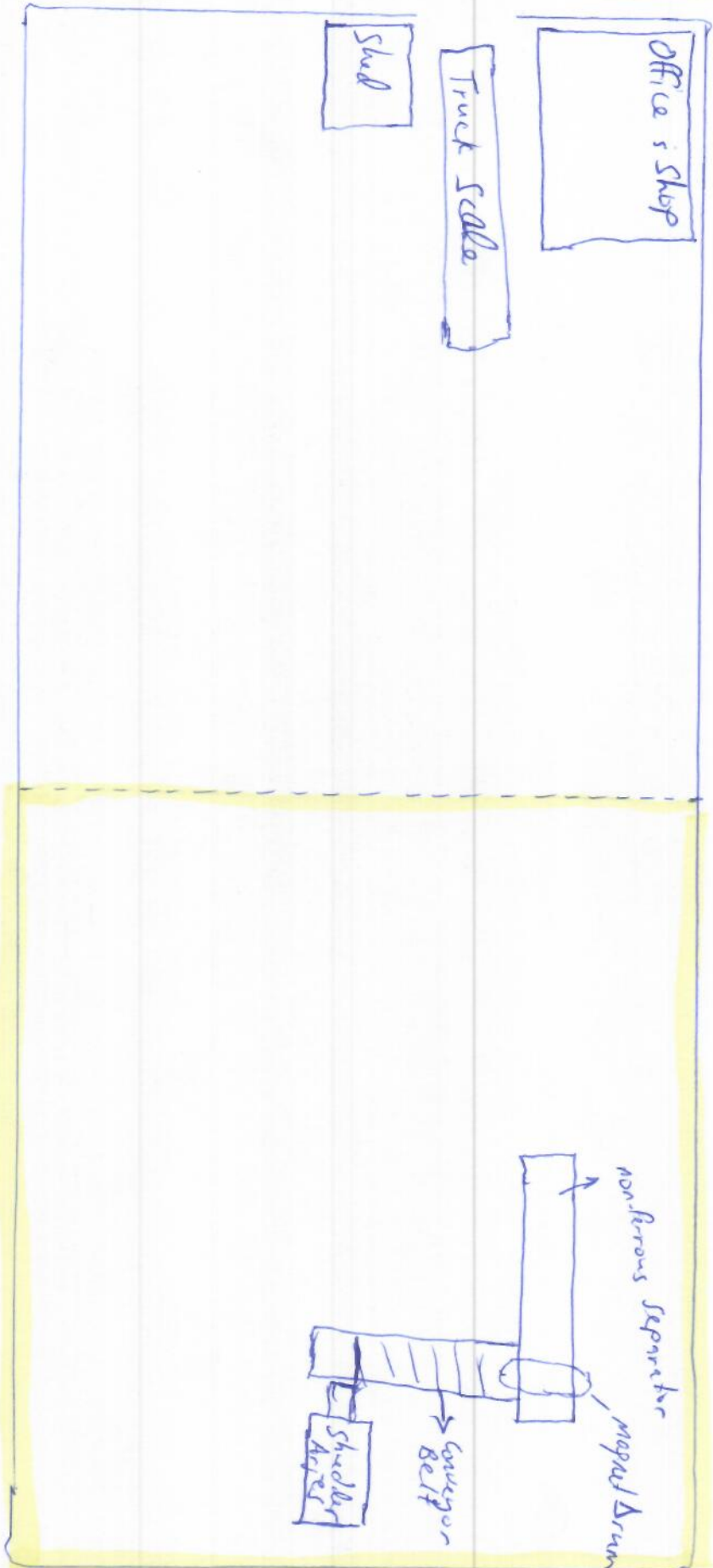

NW Metals Inc Shredding Division
Process flow Diagram Conducted in yellow box

