

Township No. 32 South

Range No. 8 West

Willamette Meridian, Oregon.

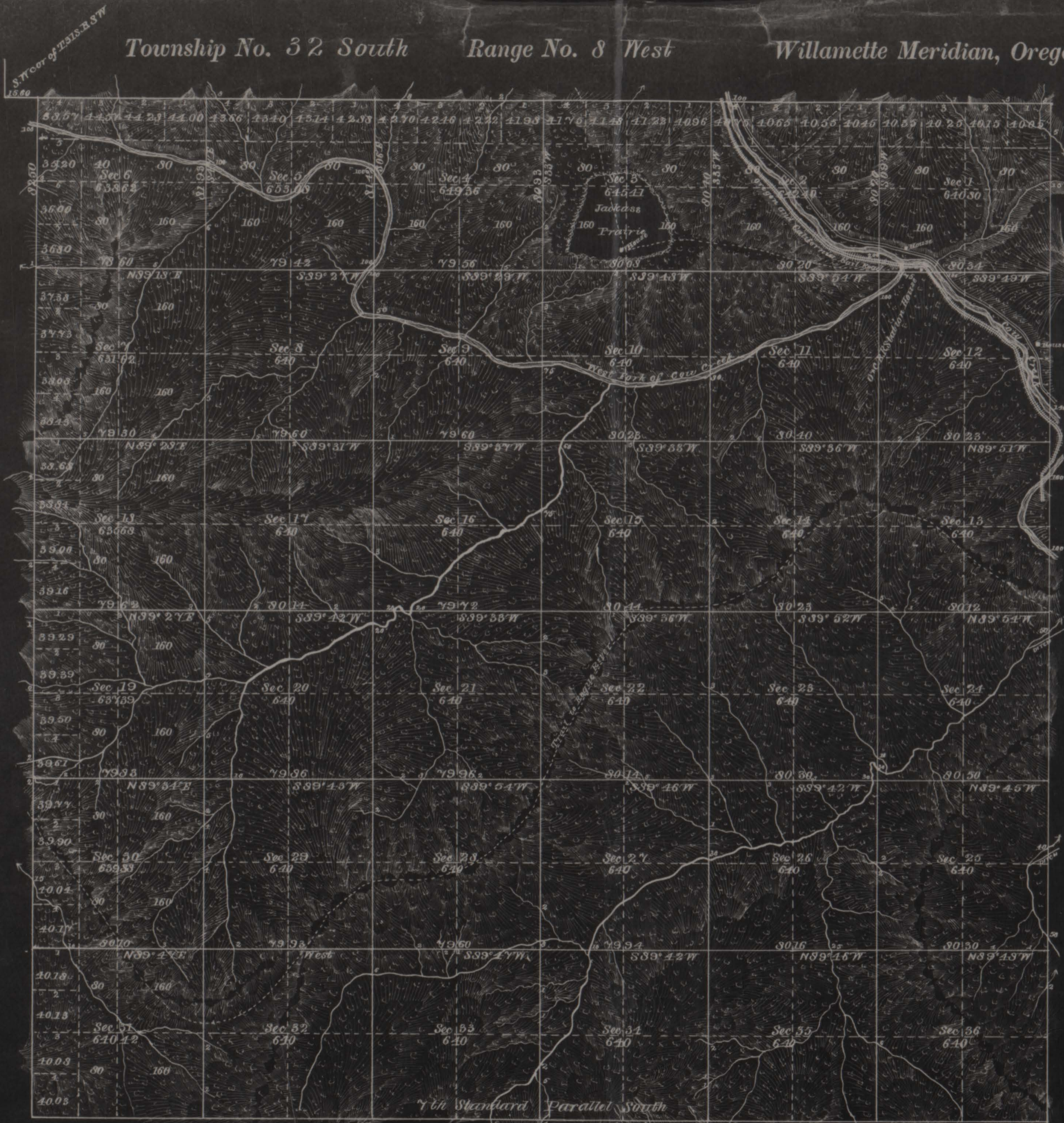

ACCEPTED BY THE HON. COMMISSIONER G. L. O. December 7, 1883

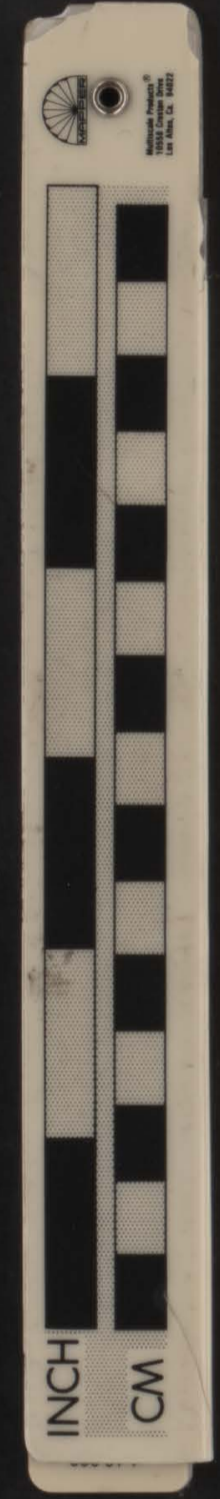

431667

Total number of Acres 23051.66

SURVEYS DESIGNATED.	BY WHOM SURVEYED.	NO.	DATE OF CONTRACT.	AMOUNT OF SURVEYS.			WHEN SURVEYED.	MEAN DECLINATION.
				Miles.	Chains.	Links.		
Township Lines	Richmond S. Dickerson	174	May 10, 1883					
Subdivisions	do do do	do	do do do	60	03	33	June 19th to July 10, 1883	19° 52' 30" E
Connections	do do do	do	do do do		15	60		

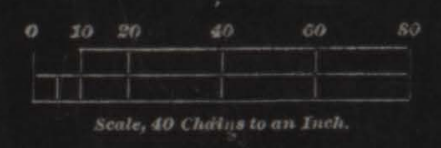

The above map of the Subdivisions... of Township No. 32 South... of Range No. 8 West... of the Willamette Meridian, Oregon, is strictly conformable to the Field Notes of the survey thereof on file in this office, which have been examined and approved.

U. S. Surveyor-General's Office,
Portland, Oregon,
Nov. 8, 1883. James C. Tolman
Surveyor-General of Oregon.



441537

