

431684

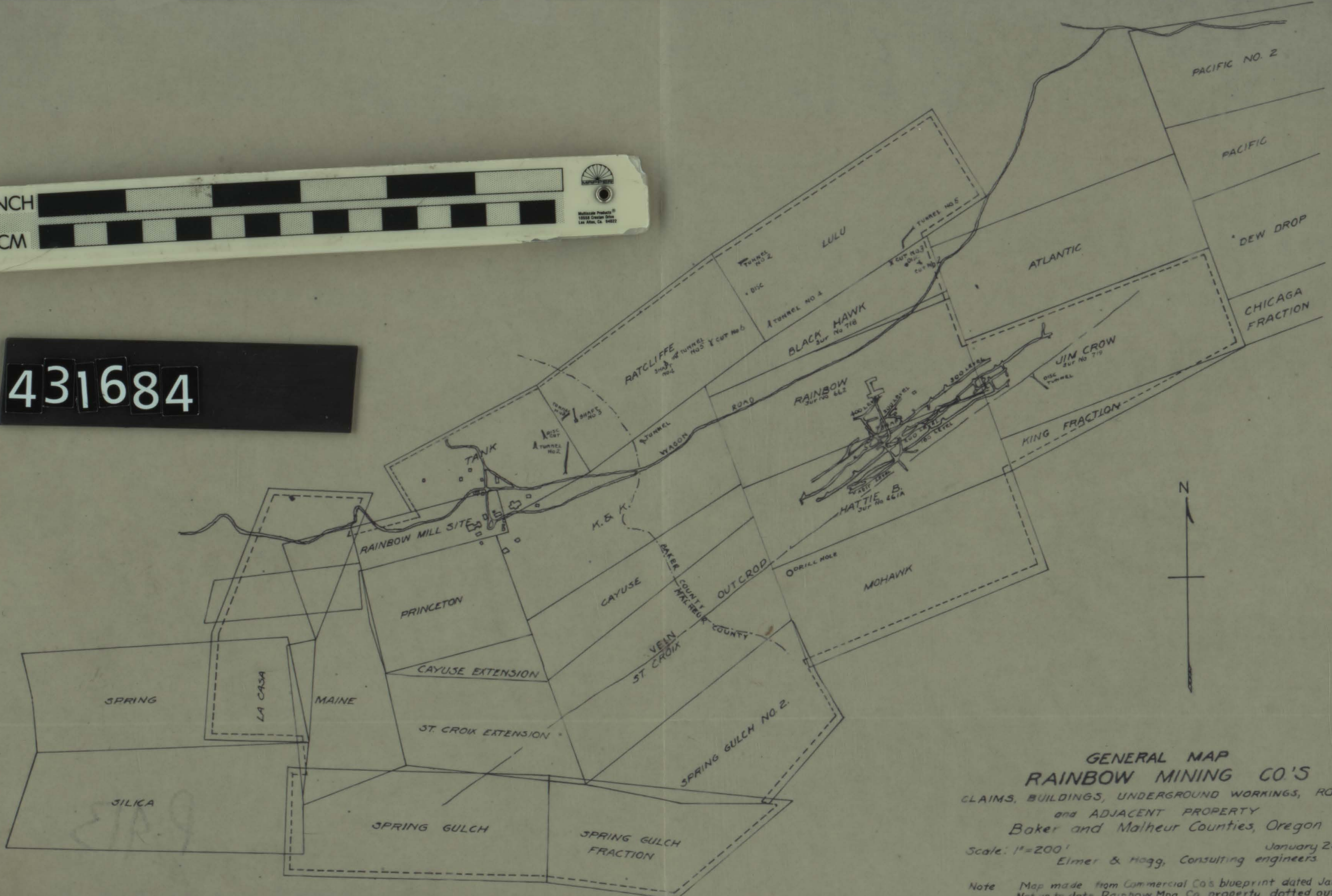

GENERAL MAP
RAINBOW MINING CO'S
CLAIMS, BUILDINGS, UNDERGROUND WORKINGS, ROADS,
and ADJACENT PROPERTY
Baker and Malheur Counties, Oregon
Scale: 1"=200' January 25, '23
Elmer & Hagg, Consulting engineers

Note Map made from Commercial Co's blueprint dated Jan 1 1916
Not up to date Rainbow Mng Co property dotted outline

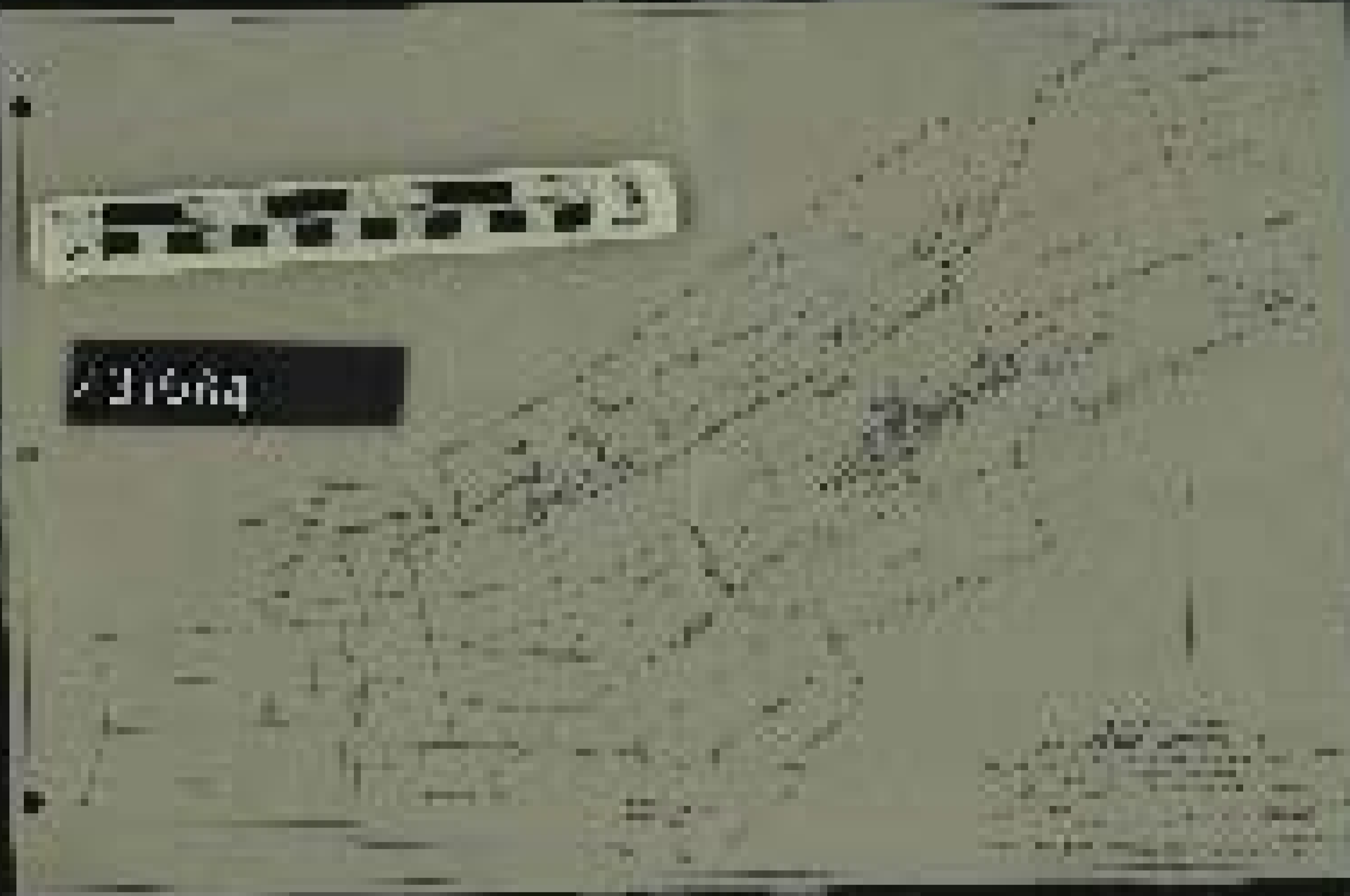

3108a

10

11

12