

TRENCH NO 5

FROM	TO	WIDTH FT.	NO.	AU. OZ.
0.0	4.5	4.5	63151	00
2.9	3.5	0.6	63161	02
4.9	5.4	0.5	63162	04
5.2	10.0	4.8	63163	01
5.2	4.1	0.9	63164	03
6.2	7.5	1.3	63165	05
7.2	4.2	0.4	63166	07
8.2	18.0	9.8	63167	08
10.5	25.0	14.5	63168	09
24.0	24.4	0.4	63169	02
24.0	38.2	14.2	63170	03
26.5	31.0	4.5	63171	04
28.2	31.0	2.8	63172	05
32.5	33.5	1.0	63173	01
33.5	34.5	1.0	63174	02

TRENCH NO 6

FROM	TO	WIDTH FT.	NO.	AU. OZ.
0.0	1.0	1.0	63175	03
0.0	7.5	7.5	63176	04
1.0	2.5	1.5	63177	05
2.5	3.5	1.0	63178	06
2.5	3.5	1.0	63179	07
3.5	4.1	0.6	63180	08

TRENCH NO 2

FROM	TO	WIDTH FT.	NO.	AU. OZ.	AG. OZ.
0.0	2.3	2.3	11157	TR	44
2.3	3.3	1.0	11159	411	4.00
3.3	8.3	5.0	11162	51	-
8.3	15.8	7.5	11163	53	-
15.8	19.3	3.5	11164	61	-
NORTH SIDE OF CUT					
0.0	3.5	3.5	11164	01	-
3.5	4.5	1.0	11165	02	-

TRENCH NO 7

FROM	TO	WIDTH FT.	NO.	AU. OZ.
0.0	3.0	3.0	63175	01
3.0	8.0	5.0	63176	02
8.0	10.0	2.0	63177	01

TRENCH NO 3

FROM	TO	WIDTH FT.	NO.	AU. OZ.
0.0	3.5	3.5	63175	05
3.5	7.0	3.5	63176	TR
7.0	24.0	17.0	63177	TR
24.0	39.0	15.0	63178	TR

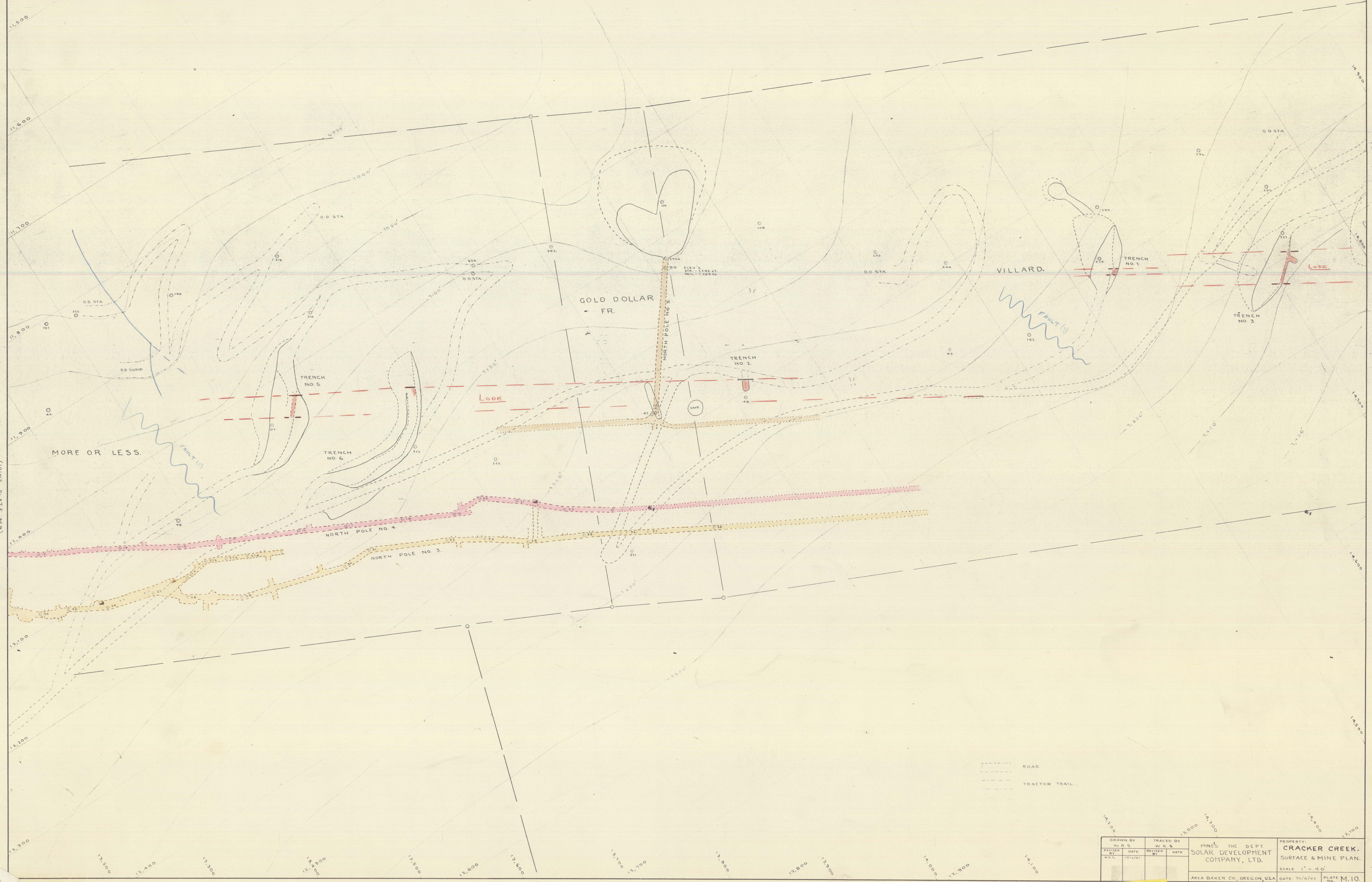
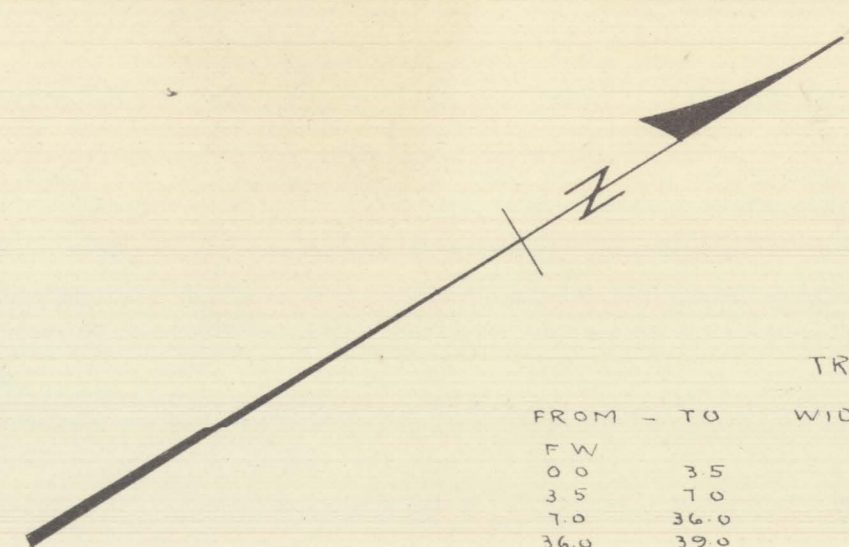

DRAWN BY W. R. S.	TRACED BY W. R. S.	PROPERTY MINES THE DEPT. SOLAR DEVELOPMENT COMPANY, LTD.
REVISED BY W. R. S.	REVISED BY W. R. S.	CRACKER CREEK. SURFACE & MINE PLAN.
DATE 10/2/47	DATE 10/2/47	SCALE 1" = 40'
		AREA BAKER CO., OREGON, USA DATE: 30/8/47 PLATE M.10.

BAK0243