



LIMESTONE AREA IV
 S $\frac{1}{2}$, SW $\frac{1}{4}$, Sec. 27, N $\frac{1}{2}$, NW $\frac{1}{4}$, Sec. 34

 Inferred acreage - 17.18
 Indicated acreage - 26.27

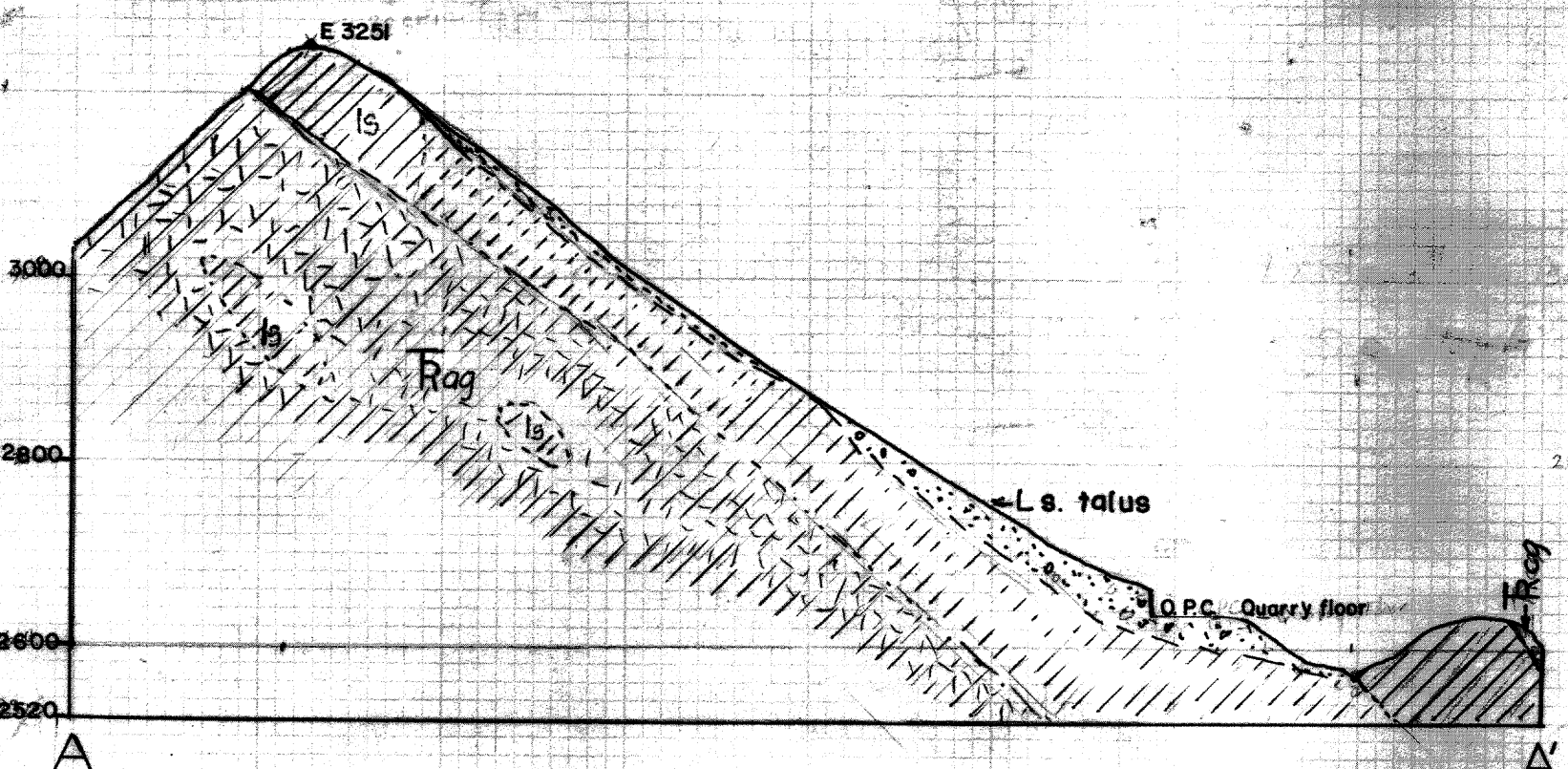
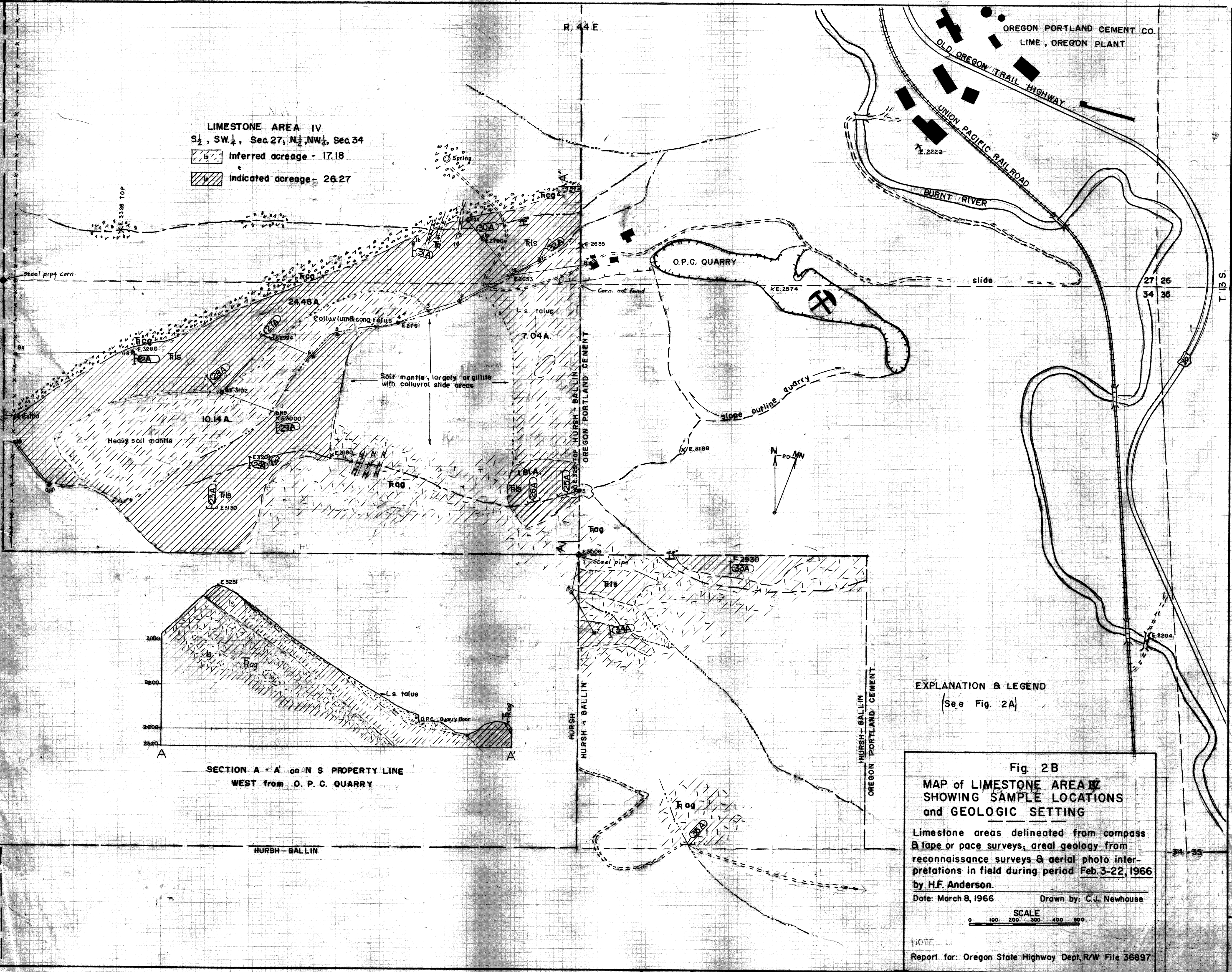

SECTION A - A on N S PROPERTY LINE
 WEST from O. P. C. QUARRY

EXPLANATION & LEGEND
 (See Fig. 2A)

Fig. 2B
MAP of LIMESTONE AREA IV
SHOWING SAMPLE LOCATIONS
and GEOLOGIC SETTING

Limestone areas delineated from compass & tape or pace surveys, areal geology from reconnaissance surveys & aerial photo interpretations in field during period Feb. 3-22, 1966 by H.F. Anderson.

Date: March 8, 1966 Drawn by: C.J. Newhouse

SCALE
 0 100 200 300 400 500

NOTE:
 Report for: Oregon State Highway Dept, R/W File 36897