

INTERNATIONAL GOLD CORPORATION PROPERTY.
BAKER COUNTY, OREGON.

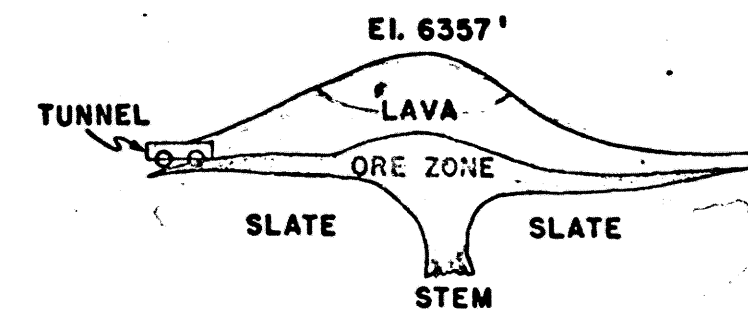

SECTIONAL VIEW LOOKING NORTH THROUGH CENTER OF DOME.

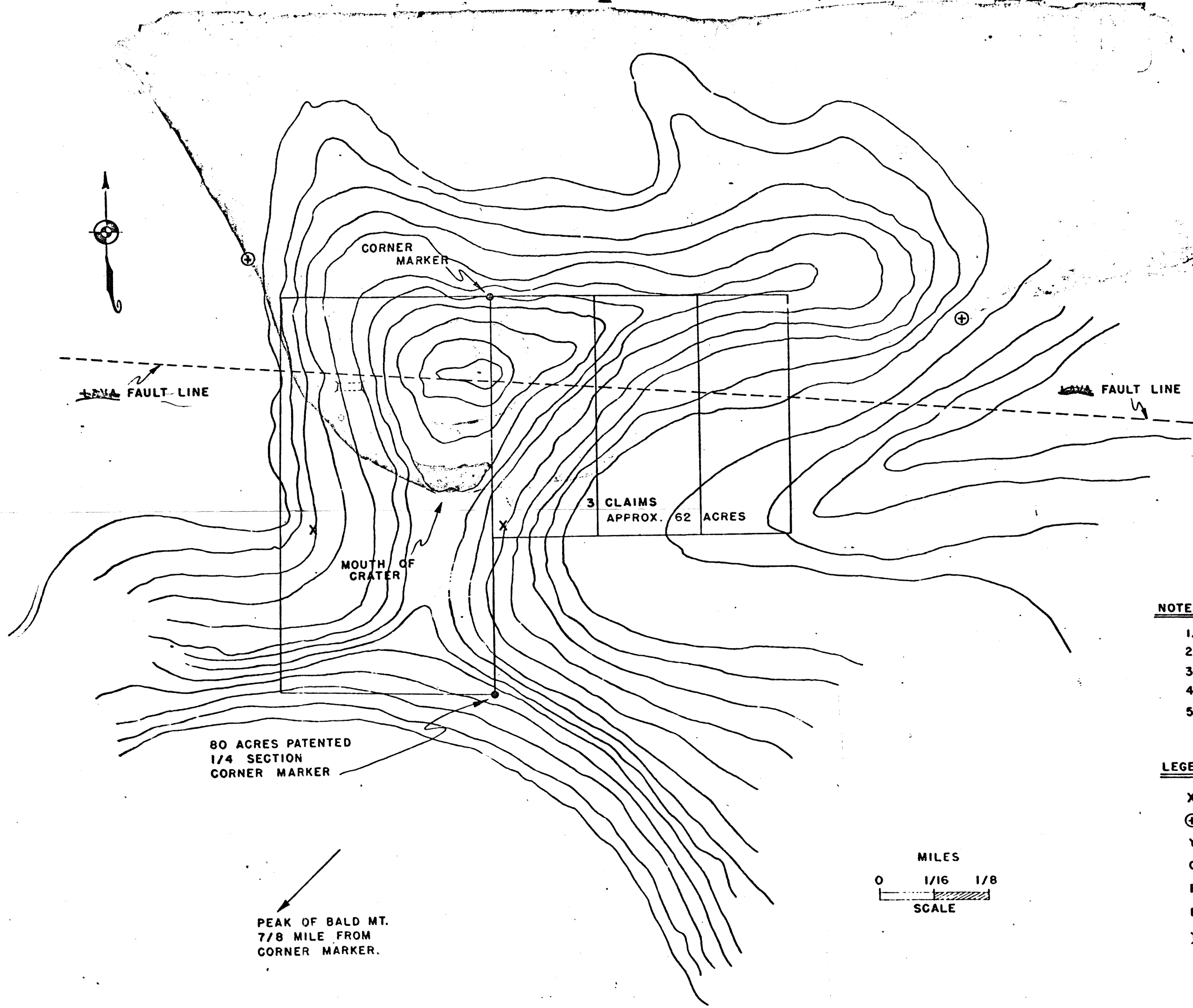
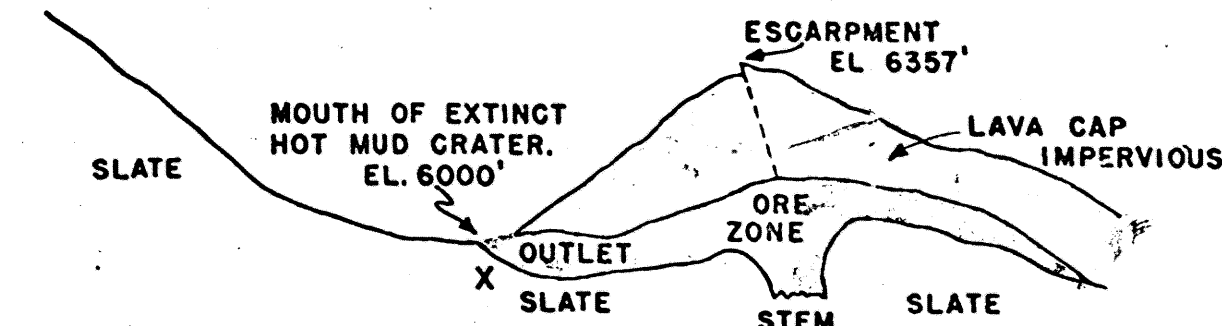

SECTIONAL VIEW LOOKING WEST.

NOTES:

- 1.- CRATER = 6000' ELEVATION.
- 2.- TOP OF DOME = 6357' ELEVATION.
- 3.- BALD MOUNTAIN = 6700' ELEVATION.
- 4.- CONTOURS INTERVAL = 50'.
- 5.- WHEN LAVA CAP ROCK IS PENETRATED THE DRILL SHOULD BE IN "ORE".

LEGEND:

- X = CINNABAR & GOLD FLOAT.
- ⊕ = CINNABAR FLOAT.
- YELLOW = LAVA CAP.
- ORANGE = MOUTH OF CRATER, & ORE ZONE
- RED = DRILL ANYWHERE IN THIS AREA.
- BLUE = SLATE.
-)] ON WEST SIDE OF DOME = TUNNEL STARTED HERE.

TOPOGRAPHICAL DETAIL TAKEN FROM U.S. GEOLOGICAL SURVEY