

T8S R38E, W.M., ORE.

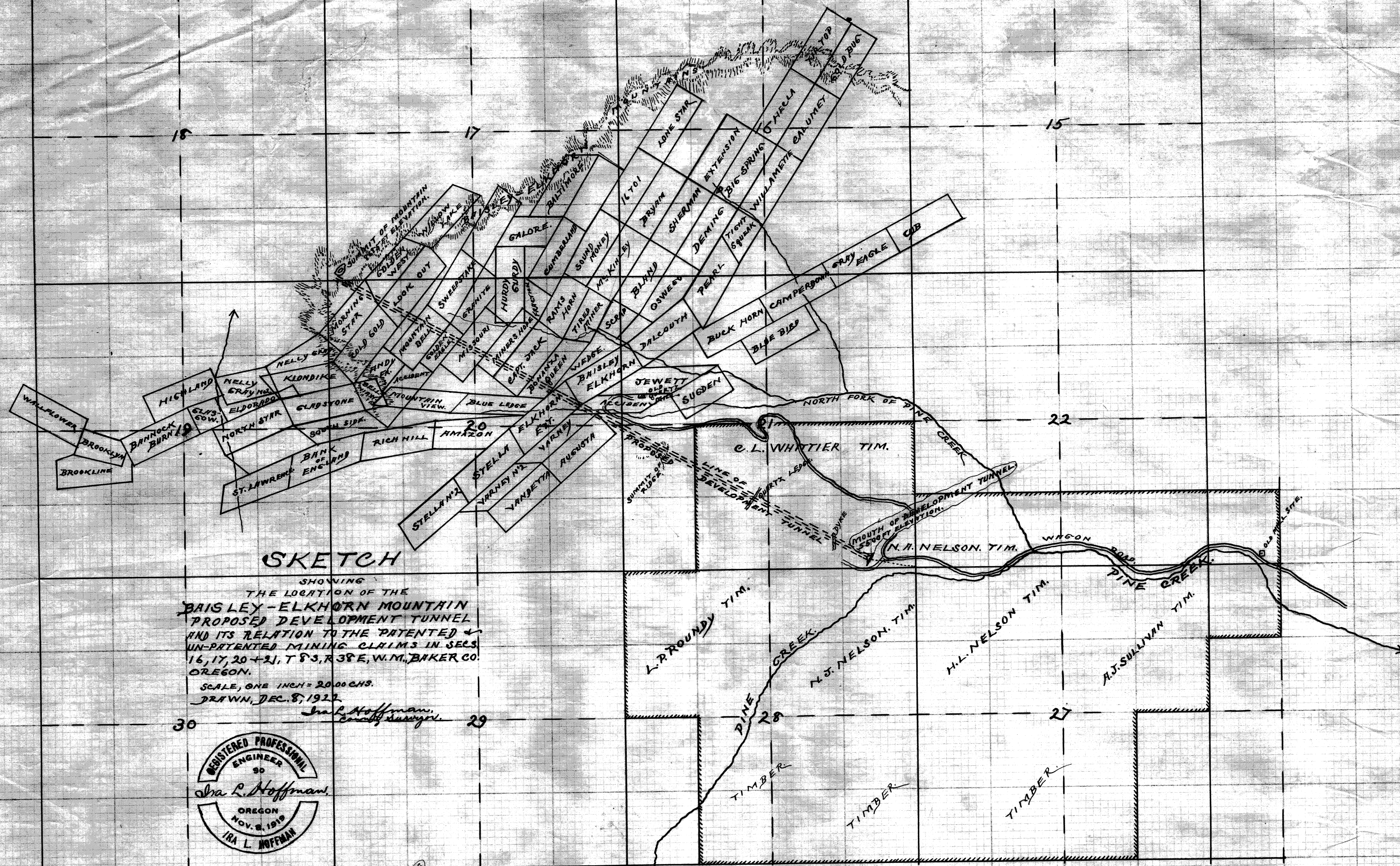

**SKETCH**  
 SHOWING  
 THE LOCATION OF THE  
**BAISLEY-ELKHORN MOUNTAIN**  
**PROPOSED DEVELOPMENT TUNNEL**  
 AND ITS RELATION TO THE PATENTED &  
 UN-PATENTED MINING CLAIMS IN SECS  
 16, 17, 20 & 21, T8S, R38E, W.M., BAKER CO.  
 OREGON.  
 SCALE, ONE INCH = 20,000 CHS.  
 DRAWN, DEC. 8, 1921.  
 Ira L. Hoffmann,  
 Civil Engineer.



**VERTICAL SECTION**  
 OF THE LINE OF THE  
**PROPOSED**  
**BAISLEY-ELKHORN**  
**MOUNTAIN TUNNEL**  
 ALL ELEVATIONS TAKEN WITH  
 AN ANEROID.  
 SCALE, ONE INCH = 500 FT.

