

PLAT
 OF
THE CROWN POINT GROUP
 OF
 QUARTZ MINING CLAIMS
 CABLE COVE, BAKER CO.
OREGON.

SCALE, ONE INCH = 500 FT.
 CLAIMS SURVEYED OCT. 14-21, 1929.

W. H. W. HAMILTON
 - REG. PROF. ENG. NO 1012. -
 MINING ENGINEER.
 BAKER, OREGON.

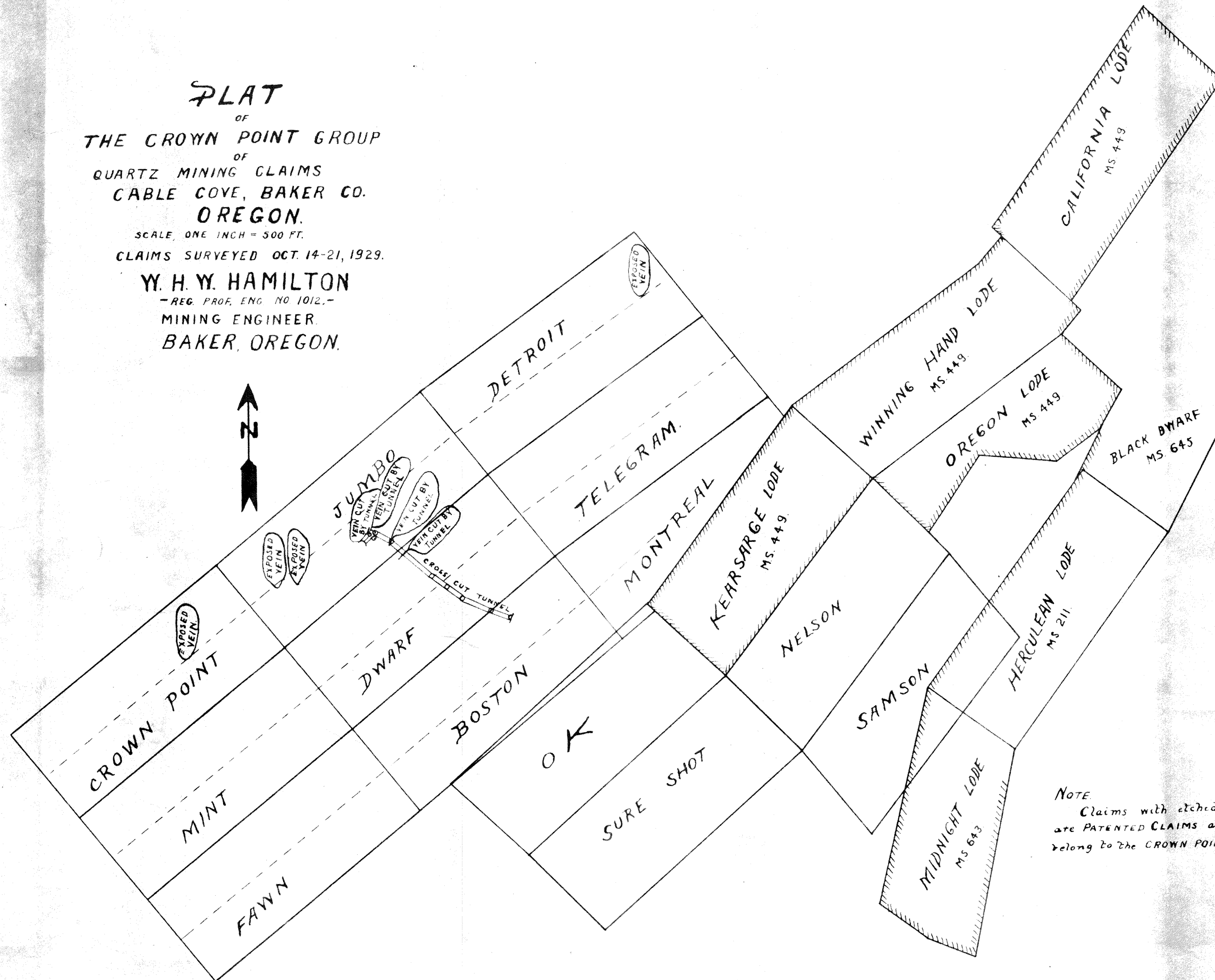

NOTE.
 Claims with etched borders
 are PATENTED CLAIMS and do not
 belong to the CROWN POINT GROUP.