

10/11/1954  
 10/11/1954  
 10/11/1954

**BLOCK "A" PROBABLE**  
 AVERAGE VALUE- \$8.00 ARBITRARY  
 " WIDTH- 2.38  
 TONS- 915  
 TOTAL VALUE- \$7320

**BLOCK "B" ASSURED**  
 AVERAGE VALUE- \$10.25  
 " WIDTH- 2.38'  
 TONS- 793  
 TOTAL VALUE- \$8128

**BLOCK "C" ASSURED**  
 AVERAGE VALUE- \$8.99  
 " WIDTH- 2.15'  
 TONS- 595  
 TOTAL VALUE- \$5349

**BLOCK "D" PROBABLE**  
 AVERAGE VALUE- \$8.99  
 " WIDTH- 2.15'  
 TONS- 682  
 TOTAL VALUE- \$6131

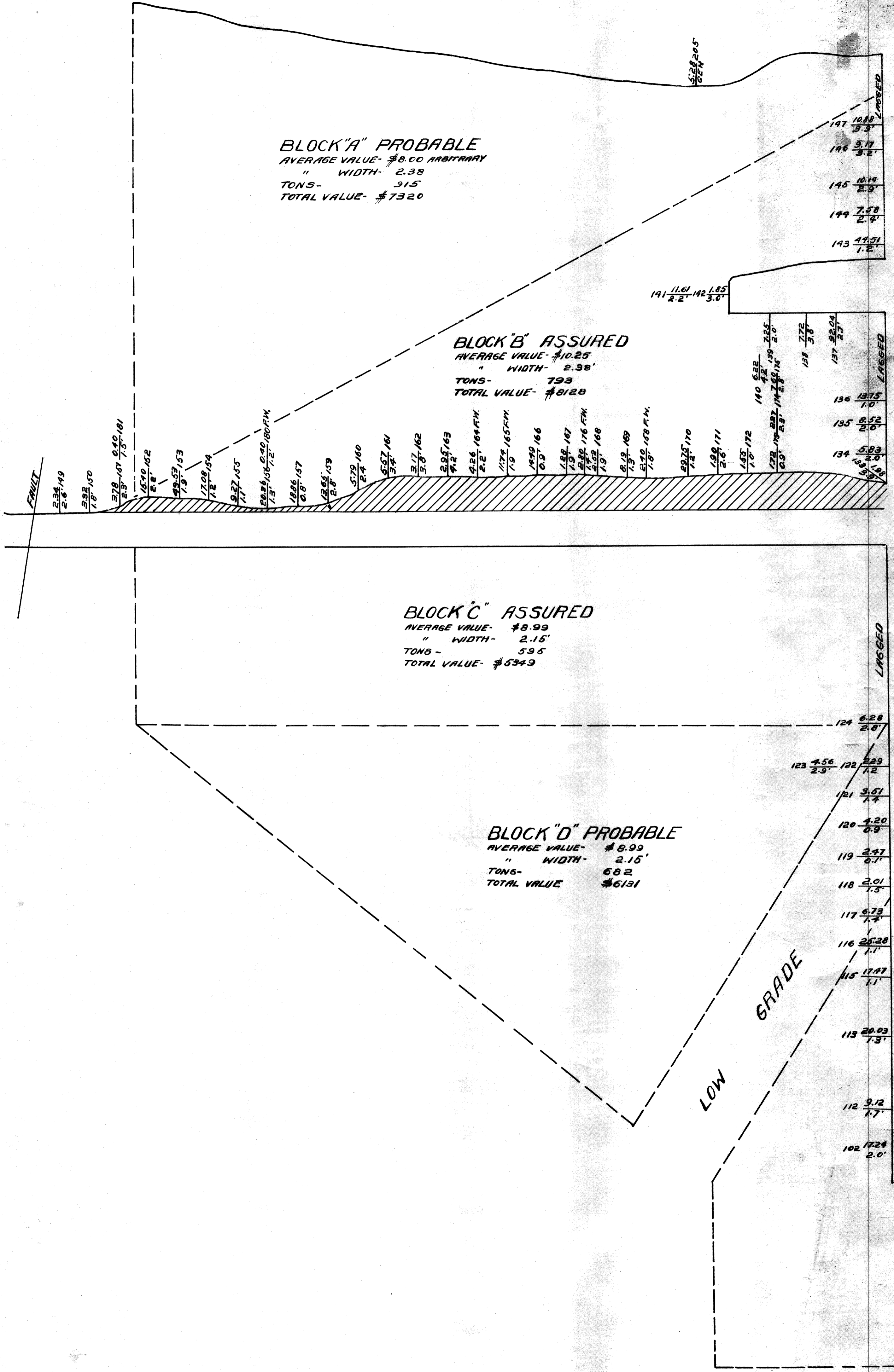

528205  
 024

191 11.61 2.2  
 142 1.65 3.0

FAULT

234 149  
 2.6  
 582 150  
 1.8

278 151 0.40  
 2.3 7.37 1.81

1570 152  
 2.8

495 153  
 1.9

1708 154  
 1.2

927 155  
 1.7

8084 156 0.40 180 F.M.  
 1.3 1.2

1886 157  
 0.8

1355 159  
 2.8

579 160  
 2.4

557 161  
 3.4

317 162  
 3.8

294 163  
 4.2

526 164 F.M.  
 2.2

1172 165 F.M.  
 1.9

1459 166  
 0.9

122 167  
 1.9

282 176 F.M.  
 1.8

552 168  
 1.9

613 169  
 1.9

540 178 F.M.  
 1.8

2975 170  
 1.2

190 171  
 2.6

155 172  
 1.0

140 6.22 4.2  
 139 2.25 2.0  
 172 175 2.87 14.7 175 2.0  
 0.9 5.3

138 2.72 3.8

137 2.04 2.7

136 13.75 1.0

135 8.52 2.0

134 5.83 2.0  
 133 1.88 1.8

LAPPED

124 6.28 2.8

123 4.56 2.3  
 122 2.29 1.2

121 3.51 1.4

120 4.20 0.9

119 2.47 0.7

118 2.01 1.5

117 6.73 1.4

116 25.28 1.1

115 17.47 1.1

113 20.03 1.3

112 9.12 1.7

102 17.24 2.0

LOW GRADE