

SECTION A-A  
ADIT-3  
68° INCLINED WINZE,  
NORTHWEST WALL

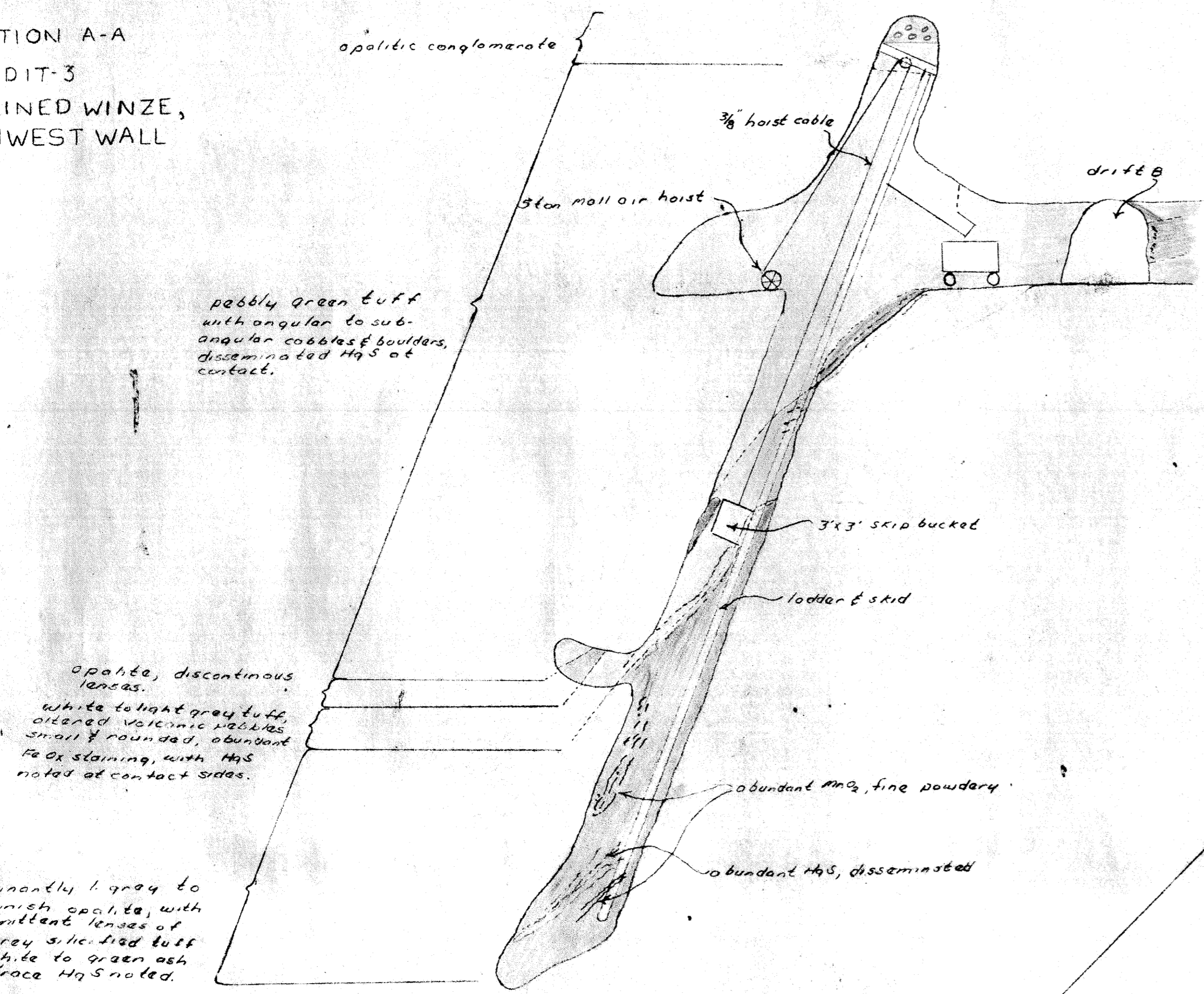

Typical Nomenclature

Sample No.	Width	%Hg	lb/short ton
T-11A	13.75'	.030%	.60 lbs.

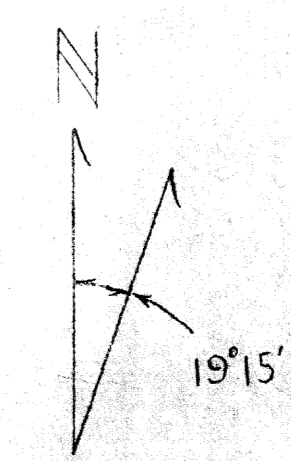

EXPLANATION

- ALLUVIAL AGGREGATE  
pebble to cobble, rounded to sub-rounded, basaltic & andesitic.
- WHITE TO BUFF KAOLINITIC TUFFACEOUS SILTSTONE  
rounded to subrounded pebbles up to cobble size, friable matrix, well decomposed pebbles which break easily, disseminated or diffused bands of FeOx & HgS.
- GREEN TO LIGHT GREEN TUFF  
sandy to pebbly, rounded to subrounded, glassy grains, disseminated HgS only along contact, locally opalized with little or no impregnation of HgS.
- OPALITIC CONGLOMERATE  
highly vitreous with local brecciation, most Hg occurring as fine disseminations within opalitic material with some coating of breccia fragments, light grey to grey.
- SUBVITEROUS TO VITEROUS OPelite  
light grey to buff, HgS restricted to vitreous variety, hard and "chert like" sub vitreous variety.
- DARK GREY TO BLACK SILICIFIED TUFF  
well fractured, vuggy, local brecciation with HgS within fragments & also as a fine disseminated coating, quartz abundant.
- CINNABAR OCCURRENCES & PODS
- STRIKE & DIP
- INFERRED FAULTING
- DRILL & AUGER HOLE  
abbreviated DEAM

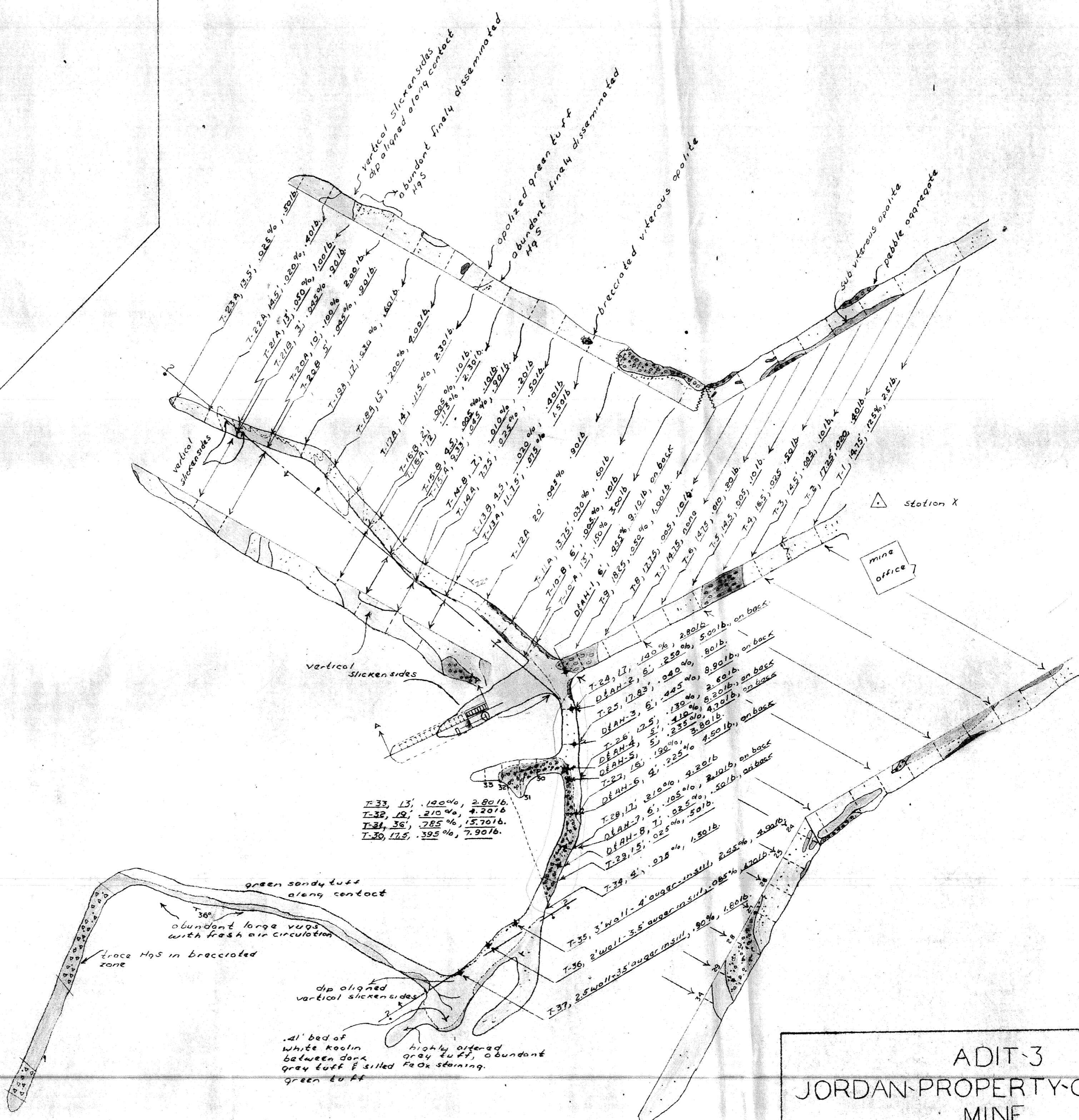

**ADIT-3**  
**JORDAN-PROPERTY-CINNABAR MINE**

SECTION 21, R43E, T17S, MALHUR CO., ORE.

SCALE  
20 0 20 40 60

BRUNTON TAPE SURVEY

BY: R.G. CHARBONEAU  
SUPERVISING GEOLOGIST

APPROVED: PROJECT ENGINEER *S.M. Barton*

H.K. RIDGLE CONTRACT  
IDM E-957, DOCKET  
4050, OMEA.

DATE 12/14/56