

N

Manganese Claims
On

Iron Mountain
of

Lou Royer Coquille
E.W. Spenser Grants Pass
W.H. Peters Portland.

Scale 1" = 500'

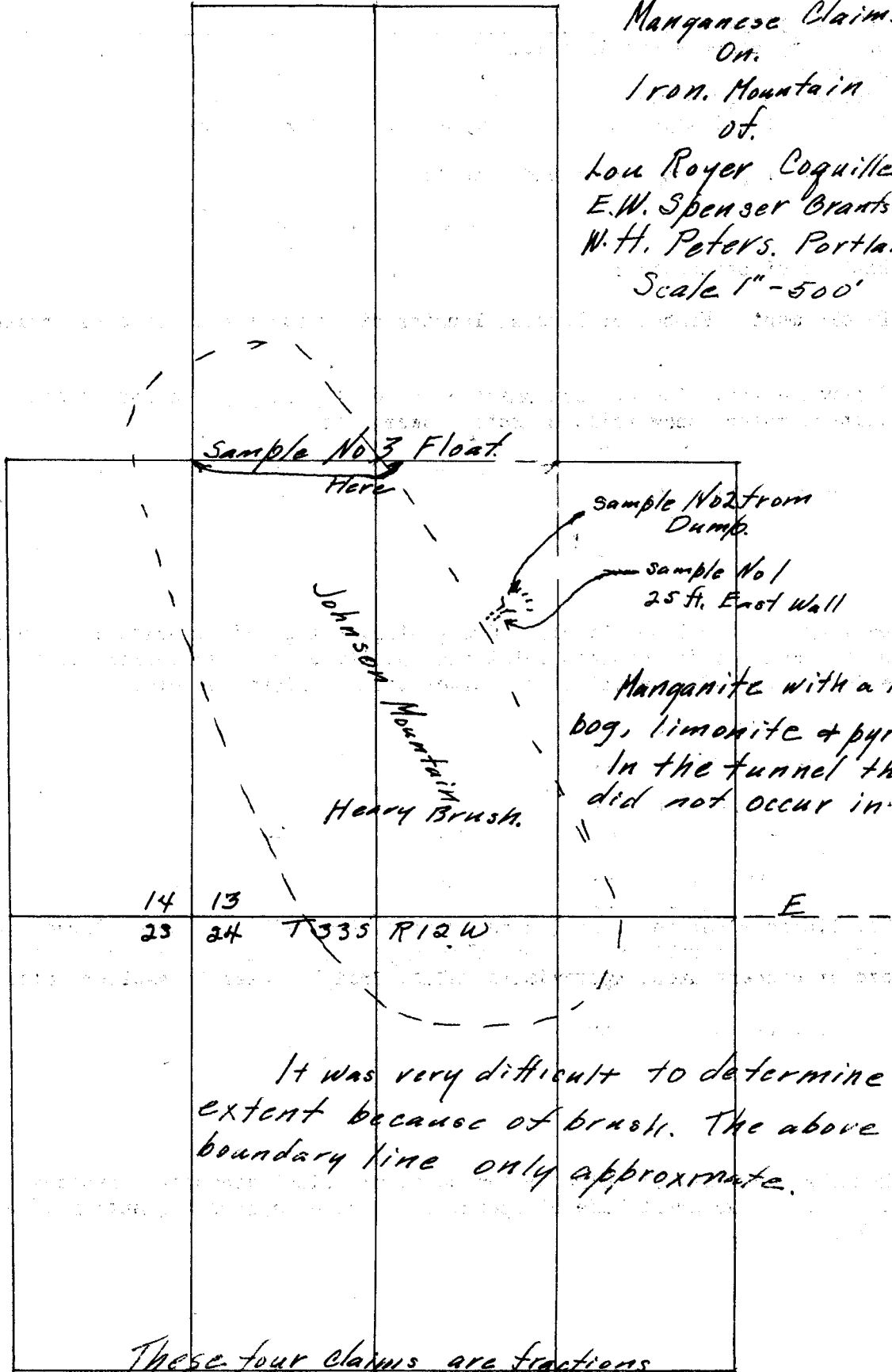

Manganite with a little
bog, limonite & pyrolusite?
In the tunnel the ore
did not occur in layers.

It was very difficult to determine
extent because of brush. The above
boundary line only approximate.

These four claims are fractions
Other claims have prior rights.

S