

Origin of the bog area
is probably an old landslide
Sag pond which has
become filled with
sediment + Vegetation.

Depth of soil zone on
the peridotite probably
quite thick due to the
sliding.

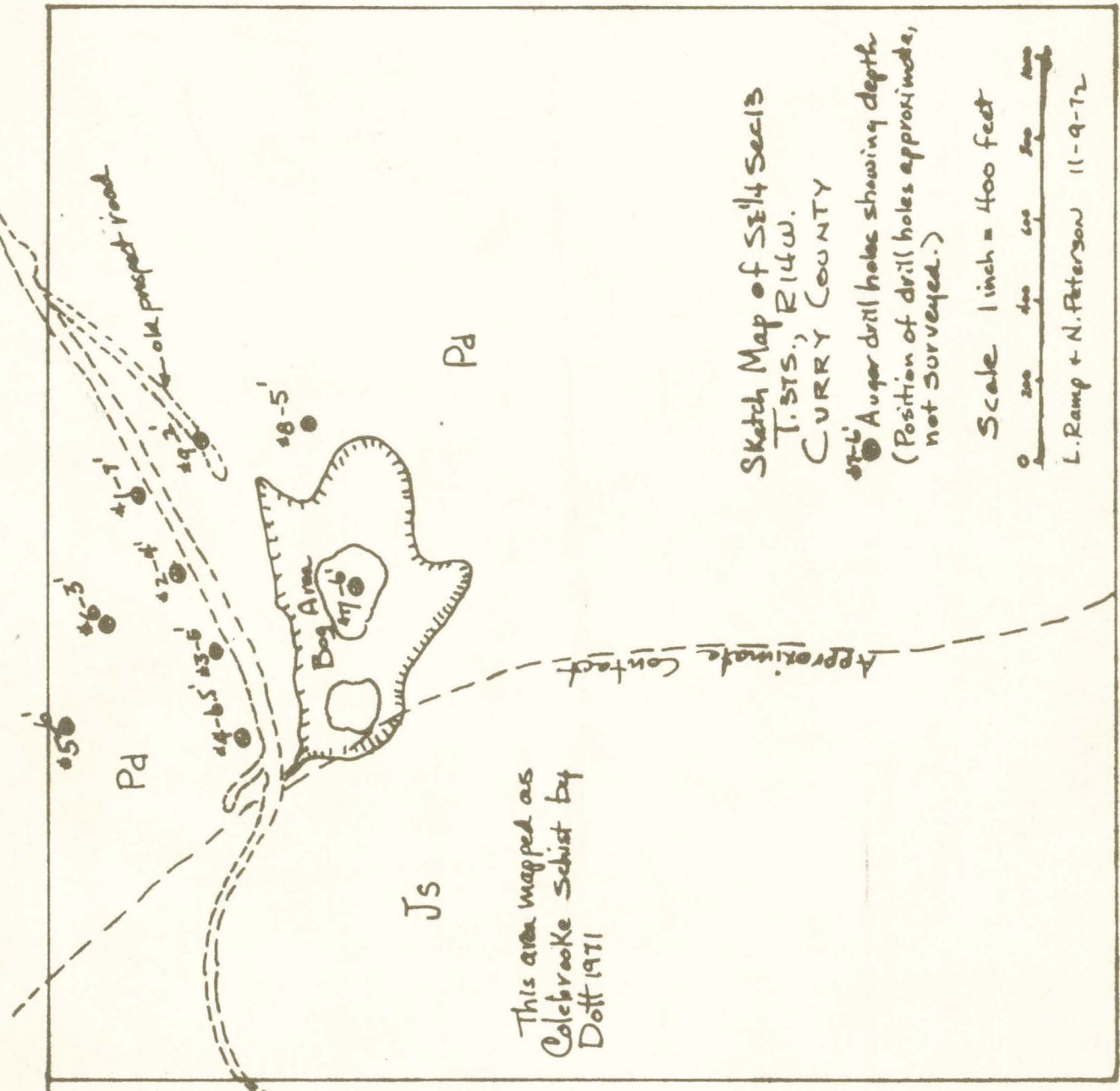

Sketch Map of SE 1/4 Sec 13
T. 51S., R. 14W.
CURRY COUNTY

● Auger drill holes showing depth
(Position of drill holes approximate,
not surveyed.)

Scale 1 inch = 400 feet



L. Ramp + N. Peterson 11-9-72

This area mapped as
Calebroke Schist by
Dott 1971

Pool 368
Pool 368



Hunters

13

Bog → ○

PINE POINT

Pyramid Rock

882643

Flycatcher Spr

2455

30

■ Ni-bearing laterite

R. 14 W. R. 43 W.

2000

2096

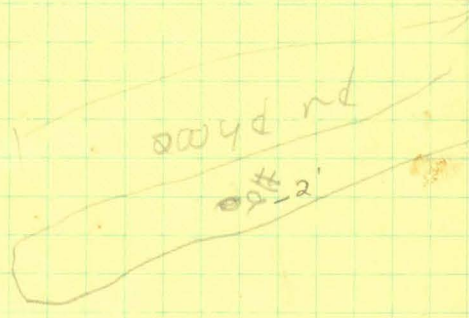
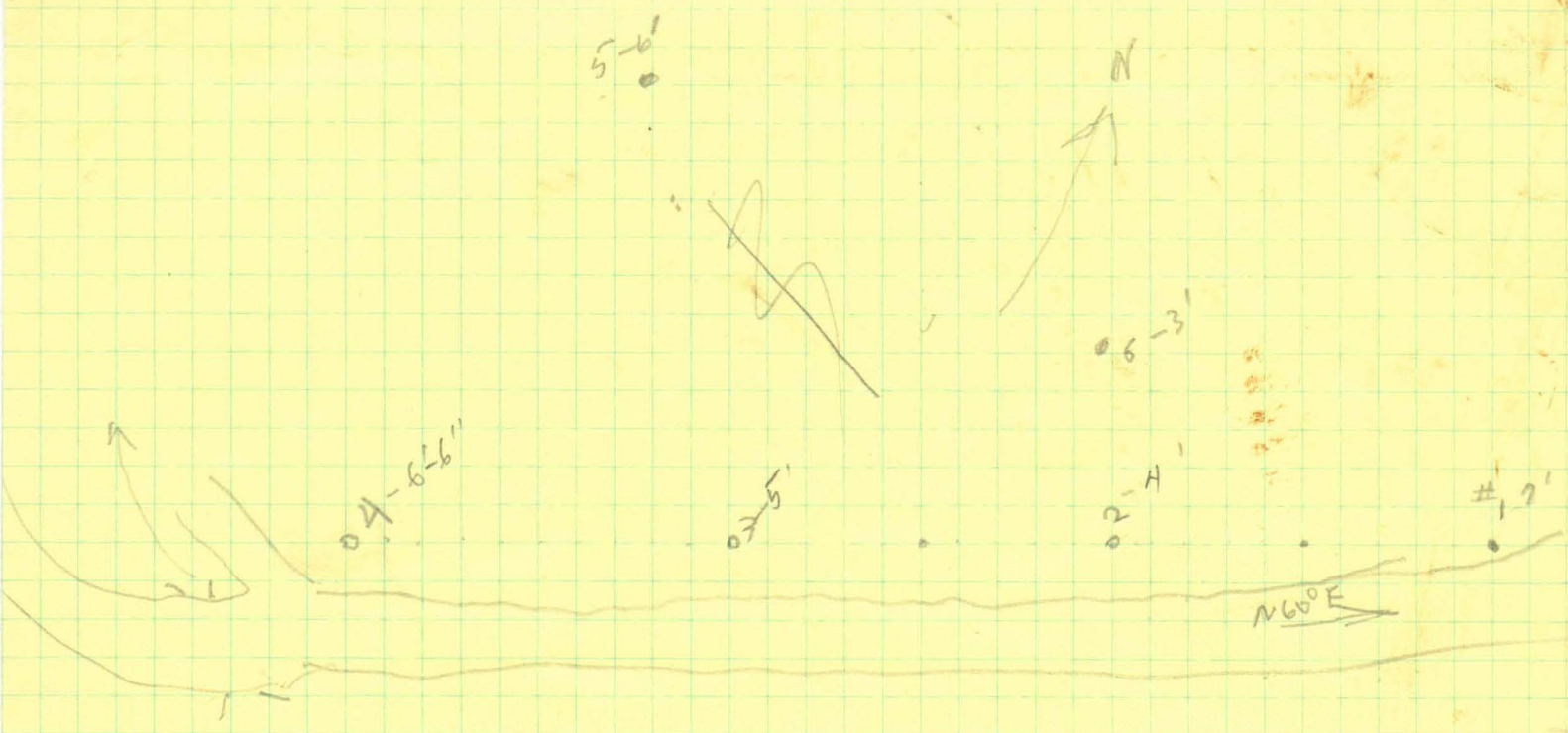

0
 15
 88

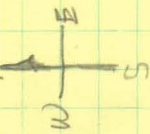

origin of bog area probably old landslide sag pond which has become filled with vegetation and sediment

Depth of soil zone on the pseudofite is probably quite thick due to sliding.

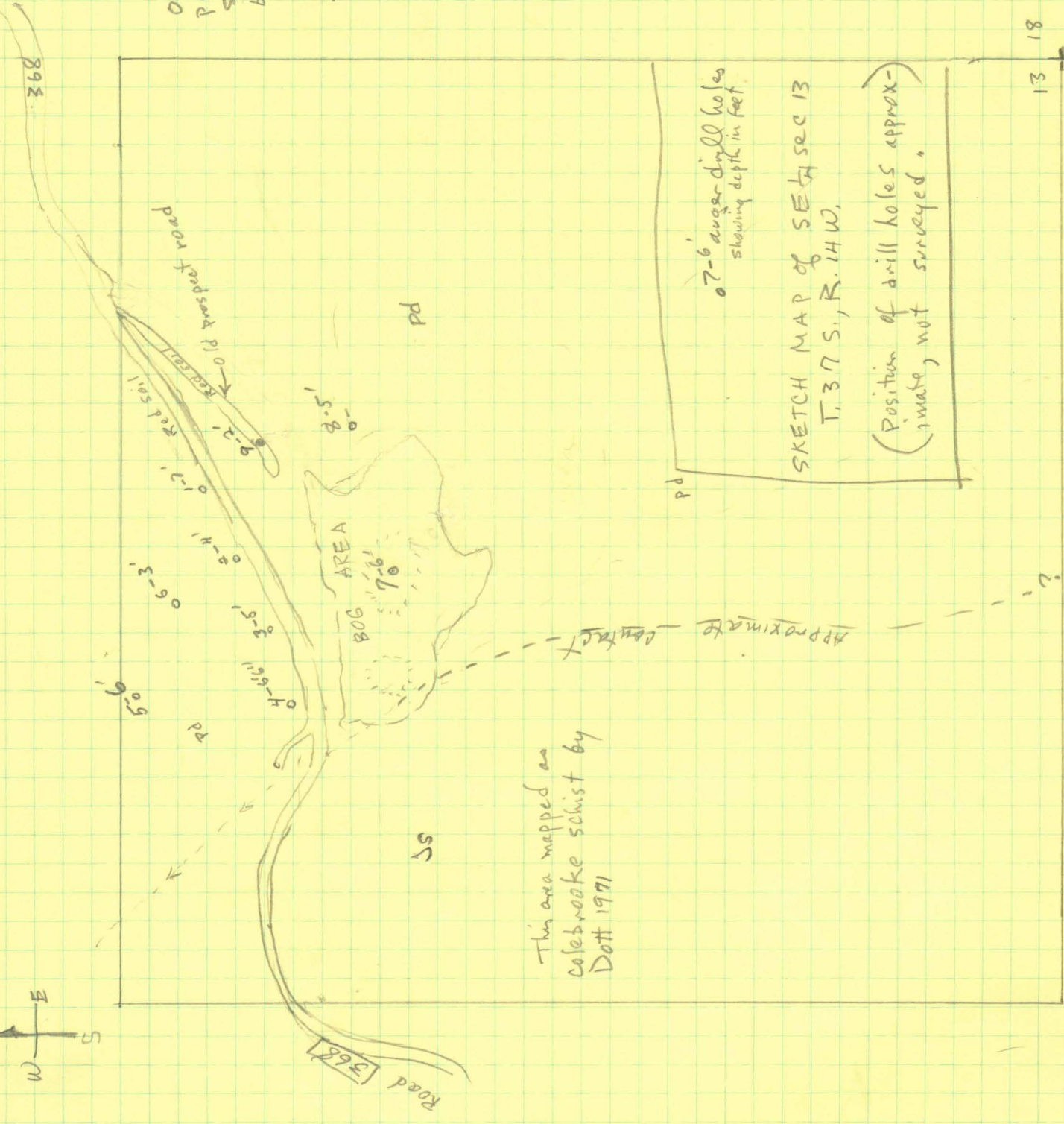

7-6 auger drill holes showing depth in feet

SKETCH MAP OF SE 1/4 SEC 13
T. 37 S., R. 14 W.

(Position of drill holes approximate, not surveyed.)

This area mapped as Colebrook schist by Dott 1971

0 500 1000 feet

1 inch = 400 feet
SCALE

13 18
24 19