

Cliff Side Lode
Grubstake Claim
Curry County
Oregon

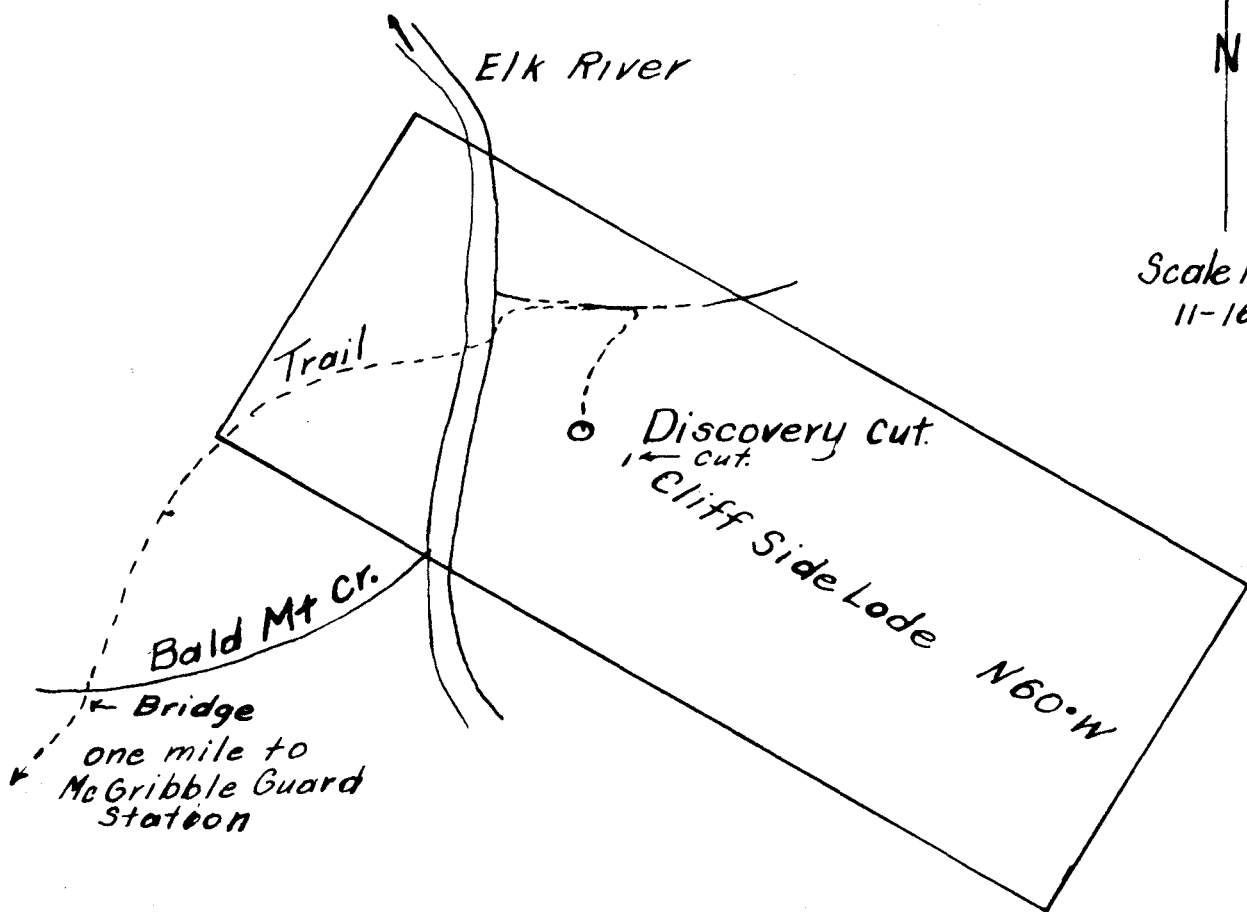
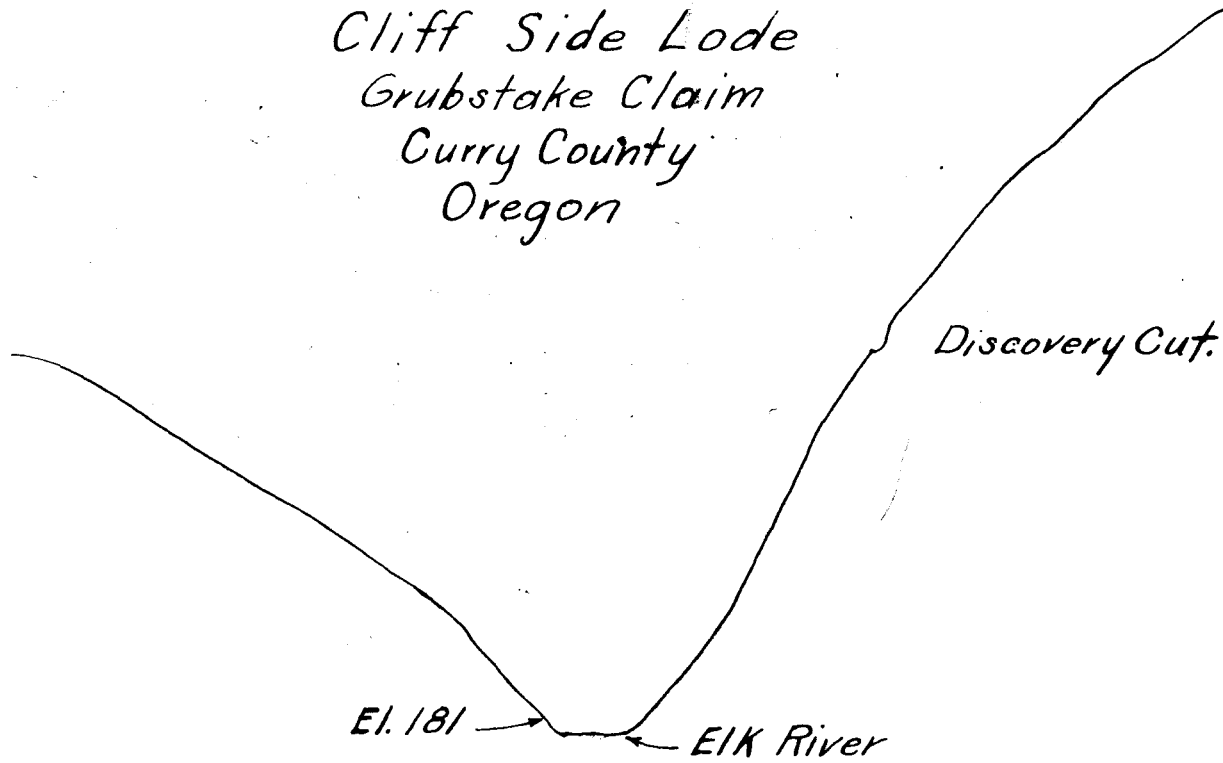

Scale 1" = 500'
11-16-38

Should be near corner of sections
7, 8, 17 & 18 T33S R14W

124° 30'

20'

10'

R.16 W.

R.15 W.

R.14 W.

R.13 W.

R.12 W.

T.29 S.

43° 00'

T.30 S.

T.31 S.

50'

T.32 S.

T.33 S.

40'

T.34 S.

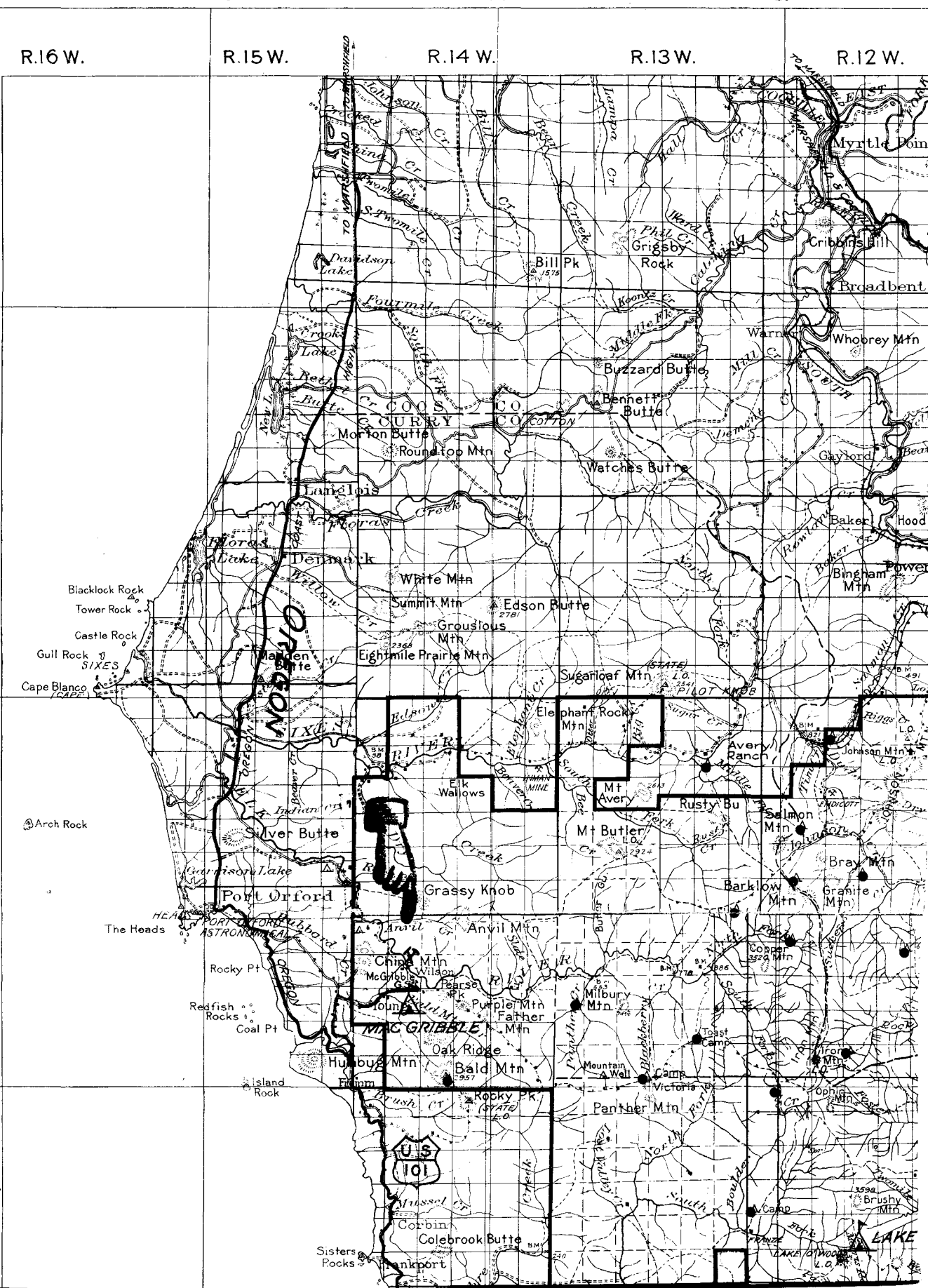

Cliff Side Lode

Sample location map

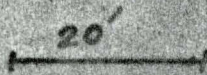
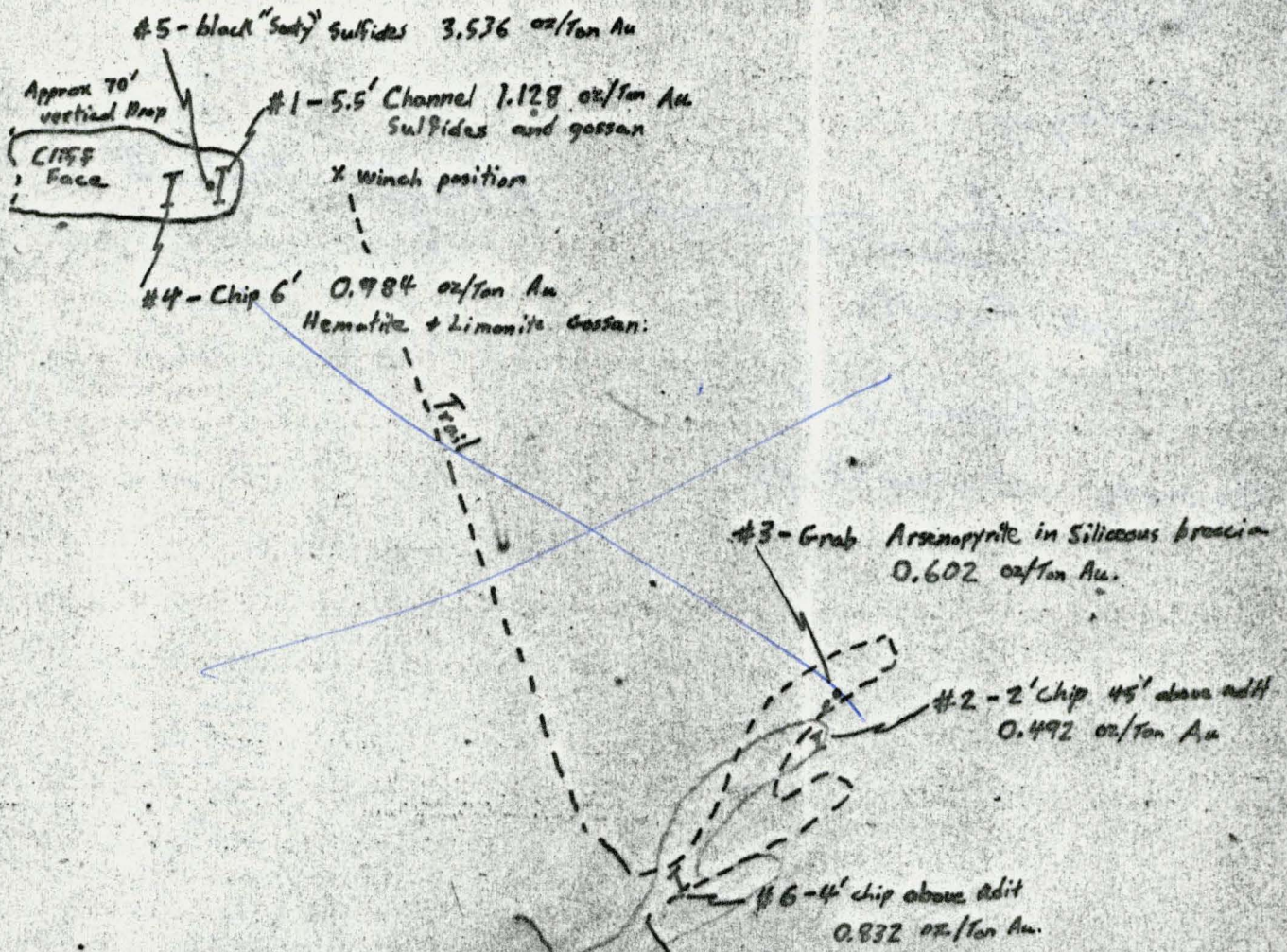

by C. Garcia 10/85

in Sec. 17, Township 33 S. Range 14 W. W.M.

Cliff Side Lode G.S.

3 samples - Two from discovery cut.

- 1 - 5 ft. near bottom of cut.
- 2 - 5 ft. 3 ft above No 1.
- 3 - 3 ft. 75 so + 50 ft. higher than No 1

See other samples take
by Mr. Curt.

Discovery Cut.

.38 - \$13.30
.05 - 1.75
1.72 - 60.20 } Tr of A

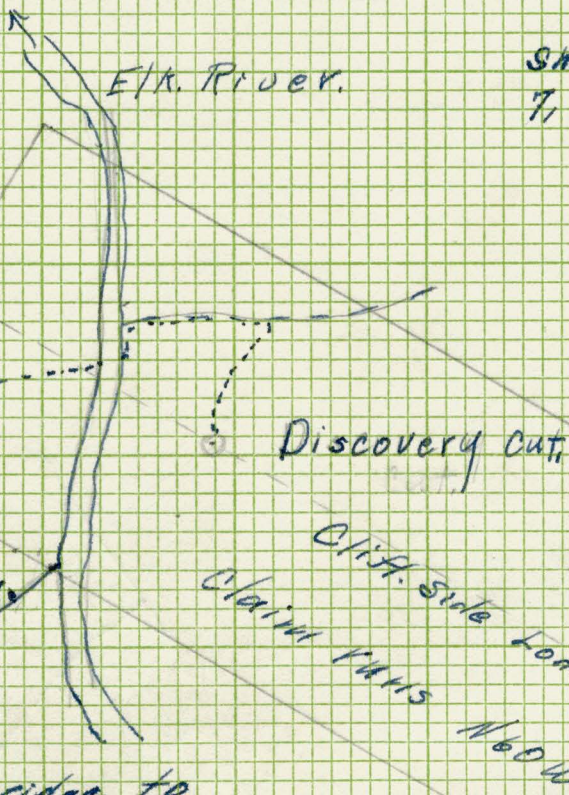
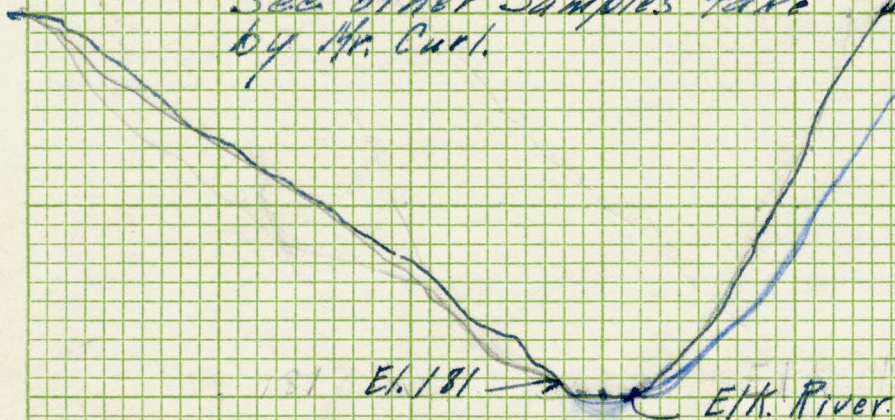

Should be very near cor
7, 8, 17 & 18. § 335 R14W
(NE 1/4 sec 17)

One Mile from bridge to
McBride Guard Station.
4 miles to 101 Highway.
10 miles to Fort Ordford.

See Free Gold claim p 96
Axtell Mine p 18

10/26/38