

PORTAL



S34E  
626

SAMPLE RESULTS

<u>Sample No.</u>	<u>Au</u> ppb	<u>Ag</u> ppm	<u>Cu</u> ppm	<u>Pb</u> ppm	<u>Zn</u> ppm	<u>As</u> ppm	<u>Hg</u> ppb	<u>Interval</u>
27296	310	3.6	200	210	1830	48	3500	4.1 ft.
27297	350	2.3	450	48	4400	240	2600	10.0

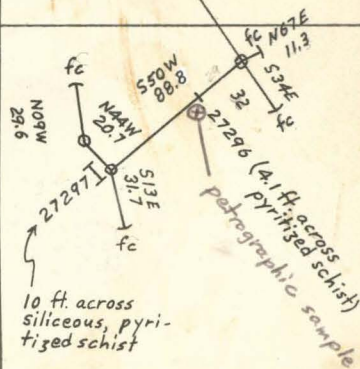

MINE BEAVER SPRINGS (SILVER PEAK AREA)

LEVEL MAIN

NOTES BY RCP

SCALE 1" = 100'

DATE 10/29/76

PORTAL



534E  
626

SAMPLE RESULTS

<u>Sample No.</u>	<u>Au</u> ppb	<u>Ag</u> ppm	<u>Cu</u> ppm	<u>Pb</u> ppm	<u>Zn</u> ppm	<u>As</u> ppm	<u>Hg</u> ppb	<u>Interval</u>
27296	310	3.6	200	210	1830	48	3500	4.1 ft.
27297	350	2.3	450	48	4400	240	2600	10.0

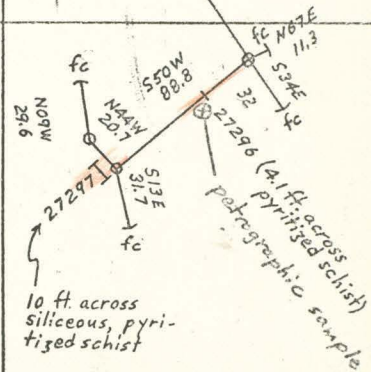

Deaver Springs Mining

Holdings

Silver Peak Mining Dist

L. W. Myer M.E.

Scale 1 in = 30 ft.

