

Development V  
Done in  
Leven's Ledge  
DRAWN By V

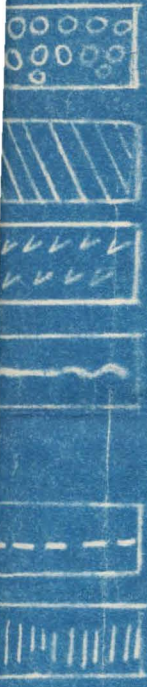

Sloped Out Ground  
Ore blocked Out  
Surface

Present Surface Ground Lines  
Showing cavity's cause by the caving  
of A and B. Raise

Origin Ground Lines

Heavy Shading along Tunnels  
indicate width of Ore veins as worked

Dip of Ore 30 degrees from vertical  
West to East

Map not drawing to scale

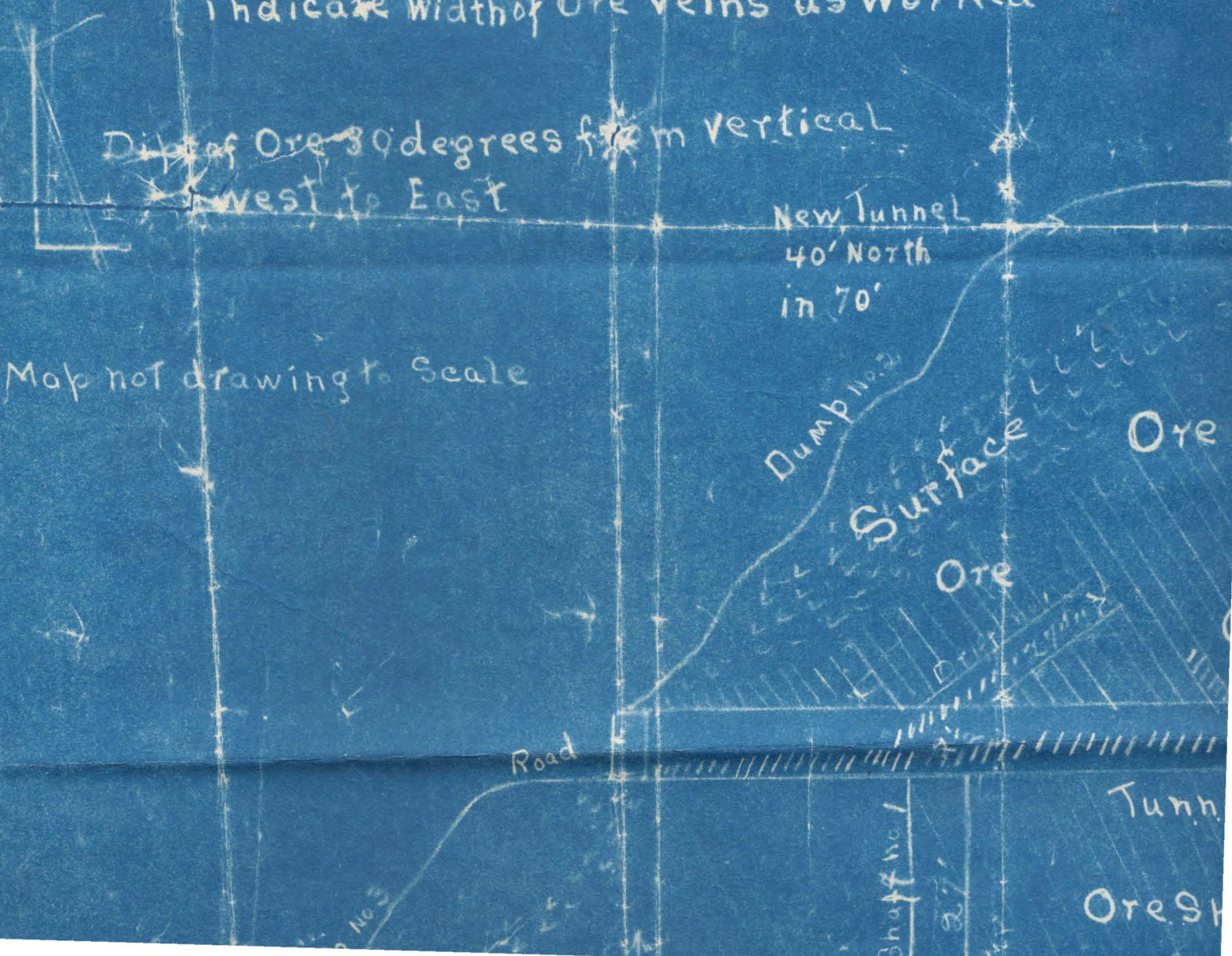

# Origin Ground Lines

Heavy Shading along Tunnels  
indicate Width of Ore veins as worked

Dip of Ore 30 degrees from vertical  
West to East

Map not drawing to Scale

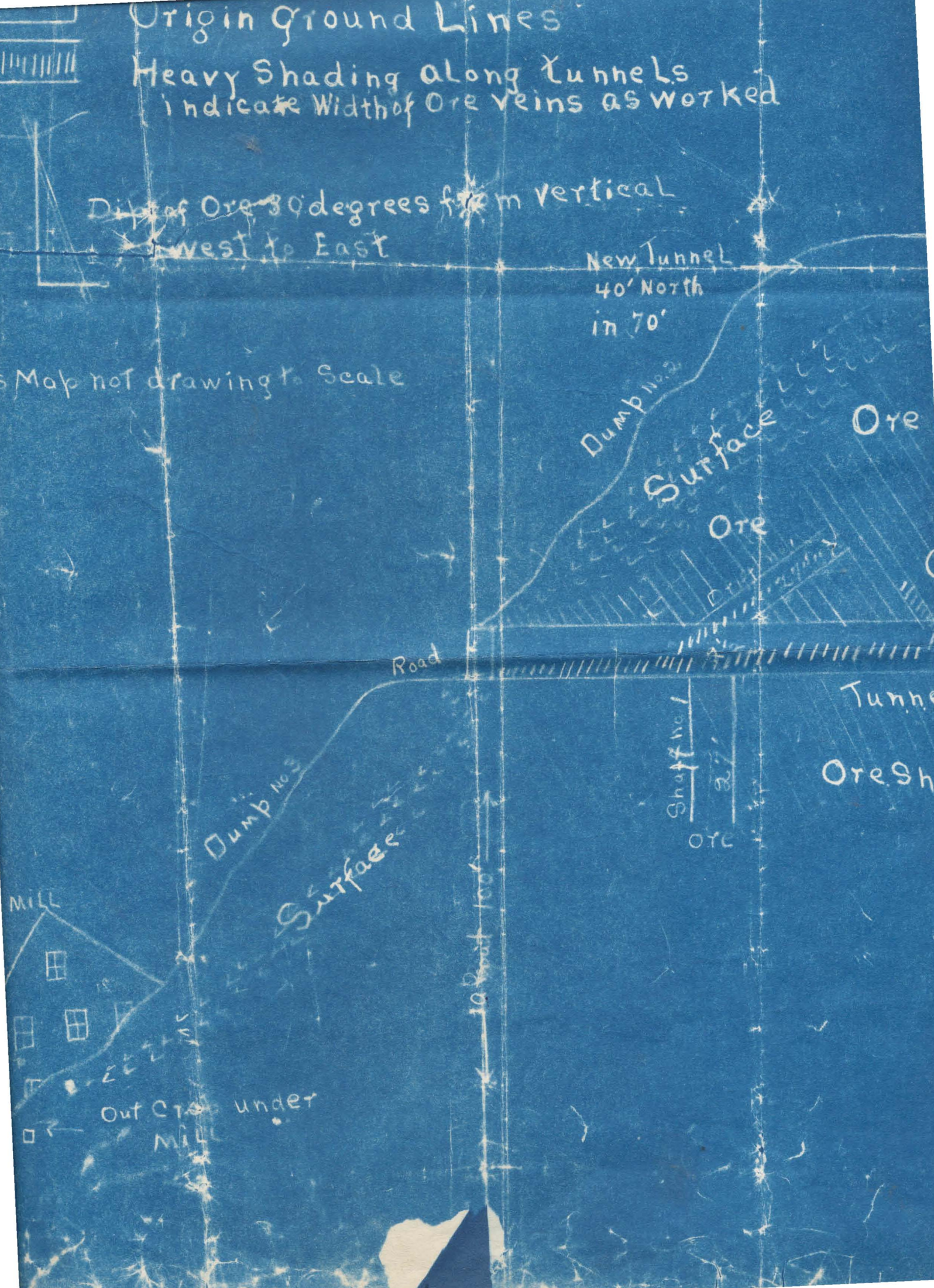

Stoped Out

Tunnel No 2 220'

10'

Stop  
Ore  
4/27

Stoped Out

Raise 23'

Ore

Ore

A Raise 114'

Ore

S.W. Drift

B Raise 47'

15'

Ore

Ore

Ore

Drift Two 80' found cave  
35'

no 3 350'

by shafts

Shaft no 2

32'

Ore

the remote

Surface

Open cut Tunnel No 1

Stoped Out

Tunnel No 2 220'

Stoped Out

Ore

ore

Ore

Ore

S.W. Drift

A Raise 114'

Raise 27'

B Raise 47'

Drift two go found cave

Ore

Ore

ore

Stoped Out

No 3 350'

by shafts

shaft no 2

32'

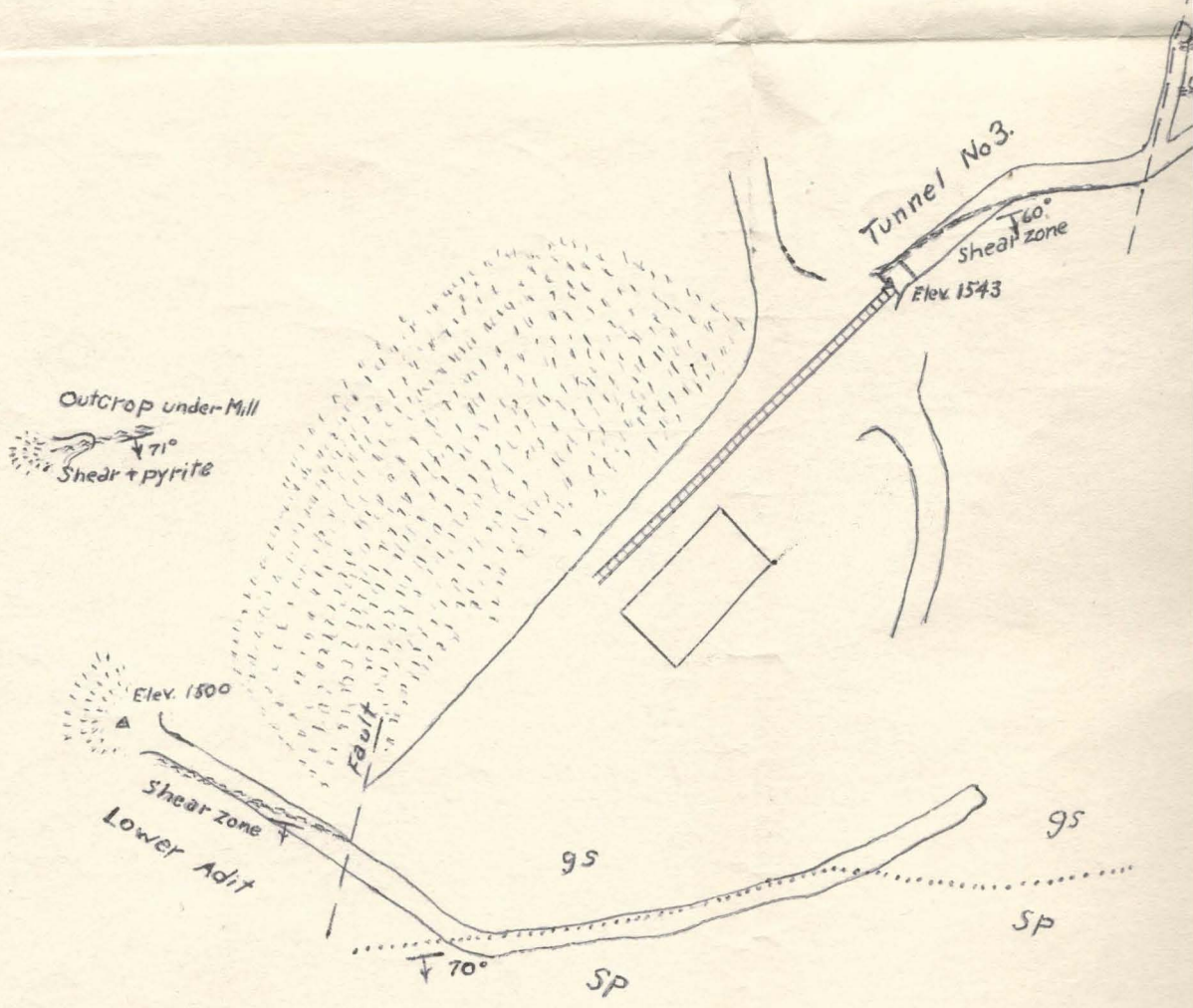
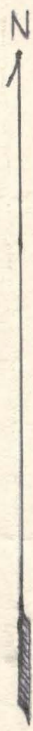

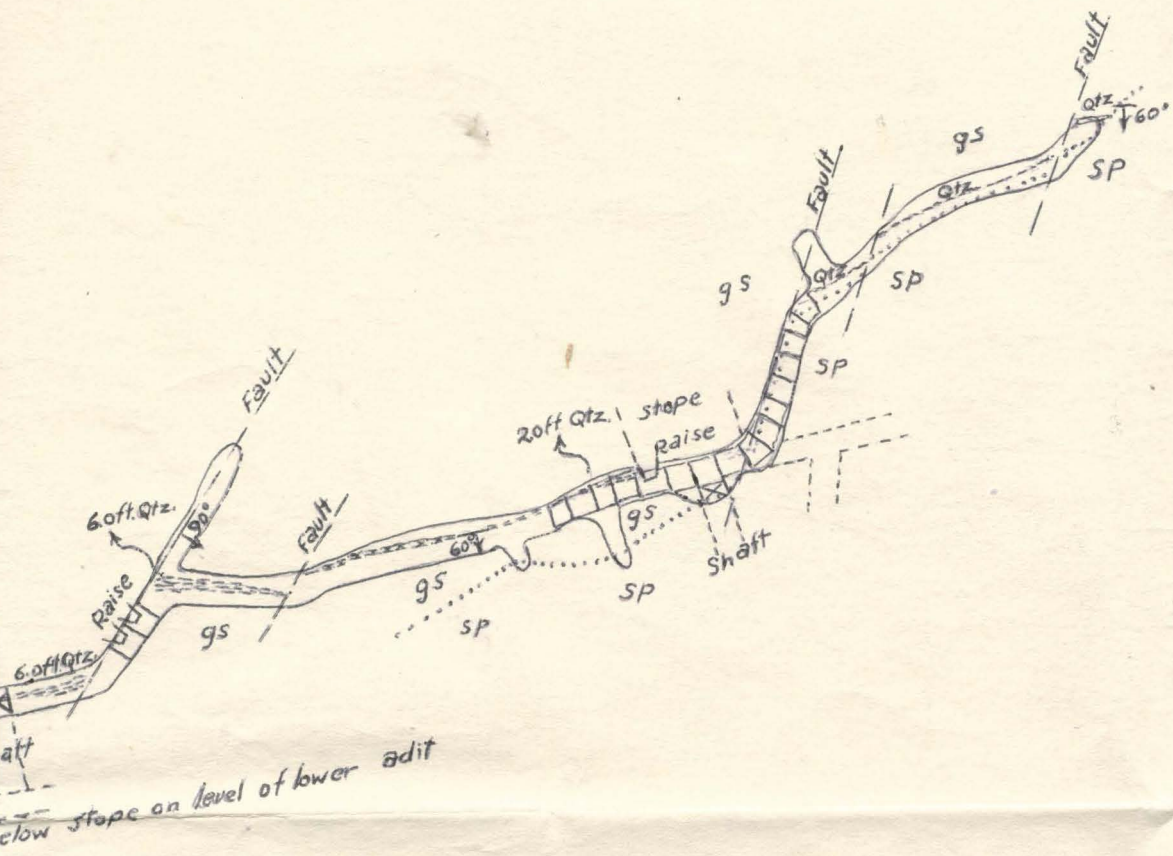

- EX
- gs
- sp
- .....
- 90°
- 90°

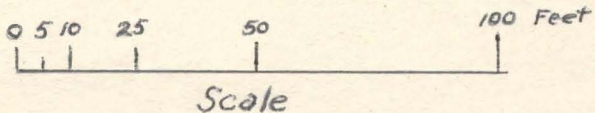

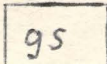

Oregon Dept.  
 Le  
 Canyonville

## EXPLANATION

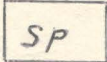
 *Green stone*

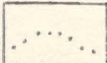
 *Serpentine*

 *Contact*

 *Vein, Qtz and shear*

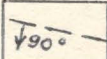
 *Fault*

 *Dump*

*Oregon Dept. of Geology and Mineral Ind.*

*Levens Ledge*

*Canyonville*

*Oregon*

*Brunton Survey and Geology by:*

*Elton A. Youngberg*

*Date: Nov. 29, 1945*

*Field Engineer*





H<sub>0</sub>

Course	Nov. 17.	Mag B		
19-20	24.5	N70E		
20-21	23.0	N79E		
21-22	18.7	N64°E		
22- <del>Face</del>	16.0	S25E		
22-23	32.9	N46E		
23-24	29.5	N19°E	✓	
24-25	9.1	N49E		
25- <del>Face</del>	13.6	N34W		
25-26	26.5	N48E		
26-27	23.3	N73E		
27- <del>Face</del>	15.2	N46E		
1-28	<del>58</del> <sup>59</sup>	N21W	68	-30°

Oct. 110V 27, 1975  
 Cours Mag B Hor II. Stape Vatl.  
 Lovens Ledge Gold Mine

1-2	S60°E	44.5'	
2-3	S55°E	39.3'	
3-4	N84°E	44.8'	
4-5	N75°E	33.2'	
5-Face	N58°E	35.8'	
1-6	N86°E	<del>82.0'</del>	84.0' + 31'
6-7	N46°E	123.0'	✓
7-8	N51°E	35.0'	
8-9	N84°E	29.2'	
9-Face	N12°E	29.8'	✓
9-10	N56°E	45.3'	✓
10-11	N72°E	38.8'	
11-12	N70°E	19.8'	
12-13	N84°E	25.7'	
13-14	N79°E	17.0'	
14-15	S17°E	13.8'	
15-16	N78°E	30.6'	✓
16-17	N75°E	20.8'	
17-18	N30°E	20.9'	
18-Face	N31°E	33.0'	
18-19	S88°E	27.1'	

Course	H.L	Slope D	Hor D	Vert L	HI - HF	Portal
1-2	<sup>229</sup> S 49° W		93'			
2-3	N 48° W	151'	125'	-34°	3.8 - 0	
3-4	<sup>106</sup> S 74° E		49.5'		96.5'	
4-5	S 74° E		11.3'			
5-Face	N 41° E		15.8'			

25' from sta. 3 to portal  
 Sta 3 to 4' South track