

Umpqua Mining Co. (Buena Vista Mine)

Claim Map

T. 29 S., R. 2 W.

Sec. 27

Sec. 34

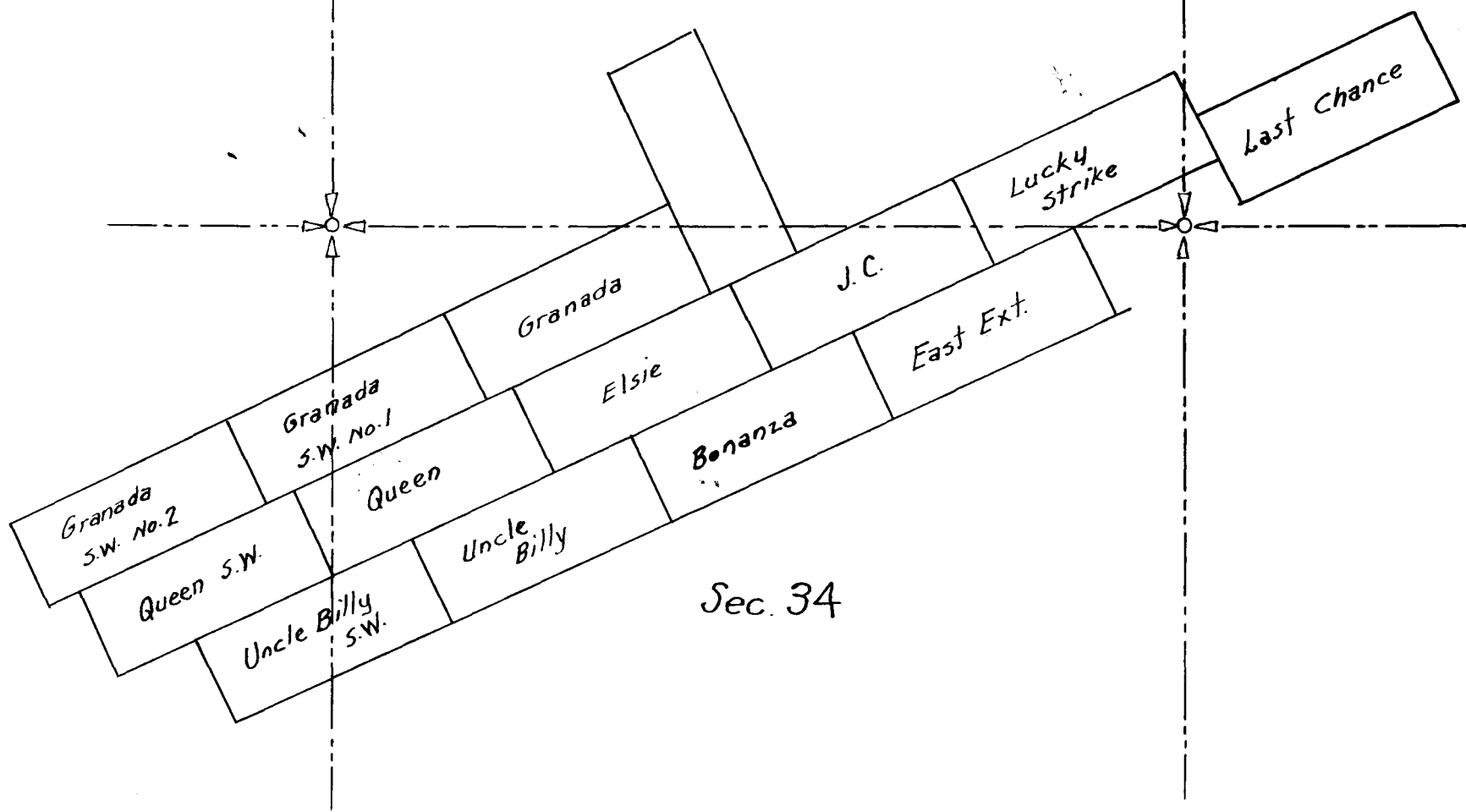

TR95  
R2W

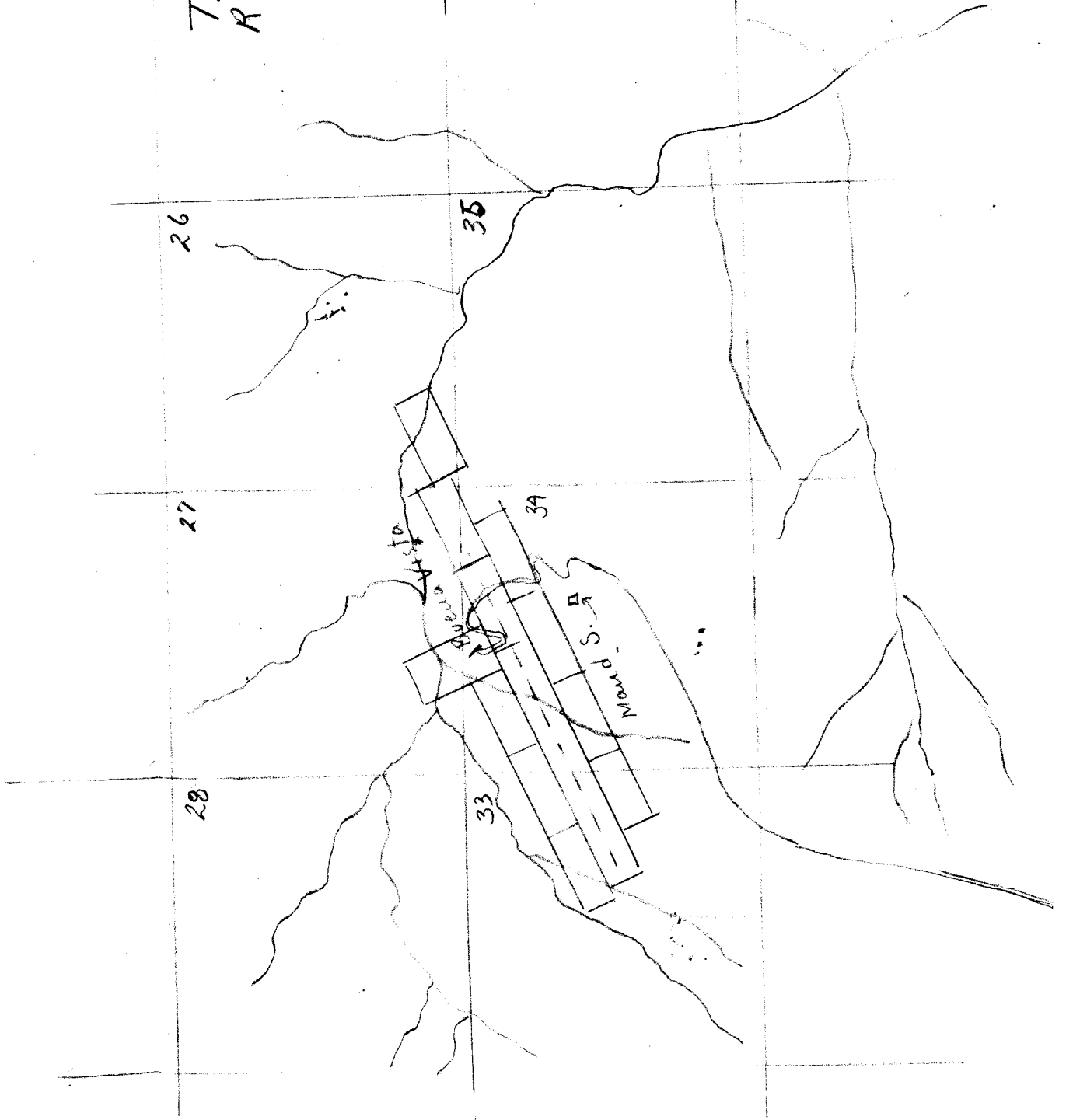
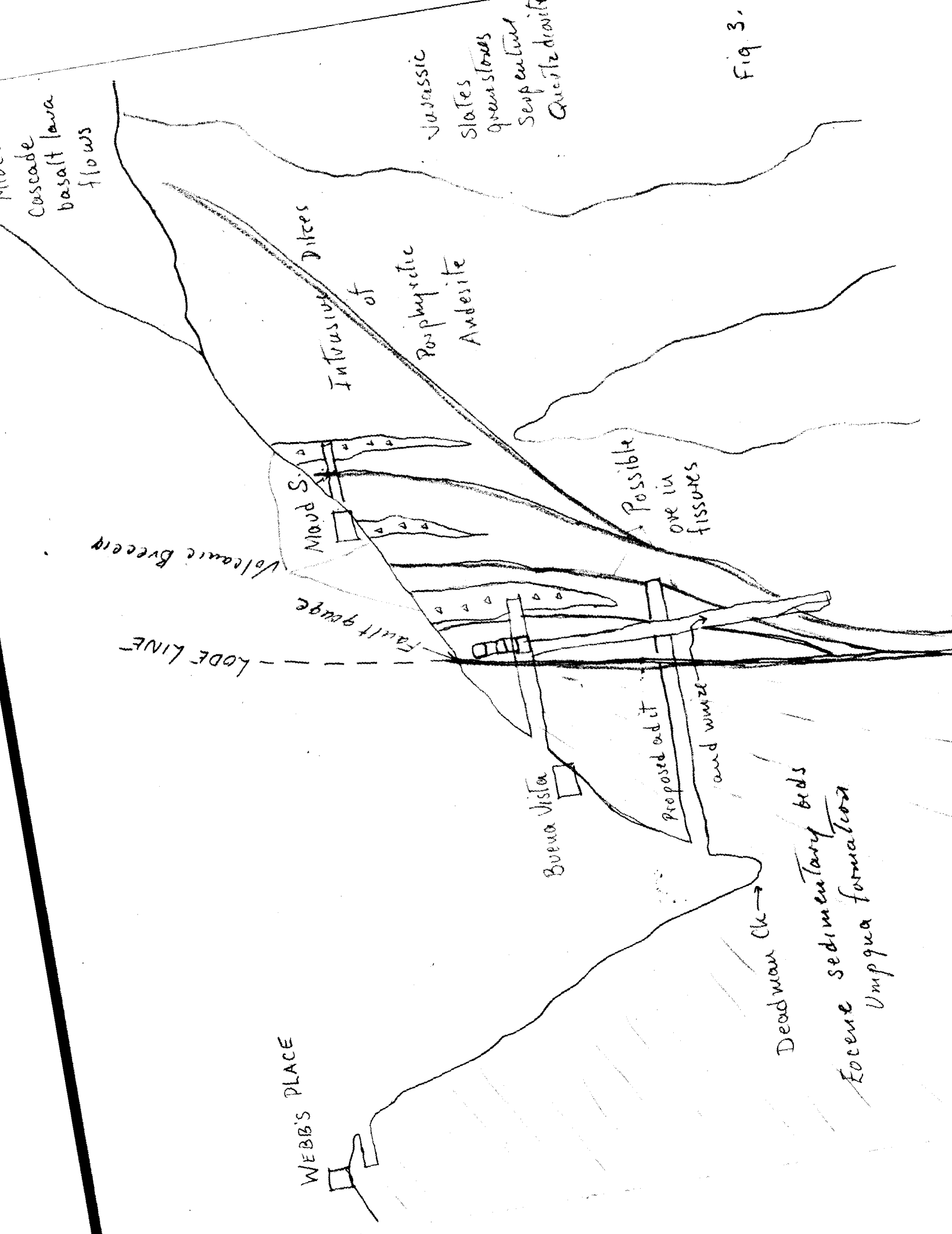

Fig 1



Cascade  
basalt lava  
flows

Jurassic  
slates  
greenstones  
Serpentinized  
Quartzite diorite

Fig. 3.

Intrusions  
of  
Porphyritic  
Andesite

Possible  
ore in  
fissures

Volcanic Breccia

Fault gorge

LODE LINE

Buena Vista

Proposed adit  
and mine

WEBB'S PLACE

Dead man Cr. →

Eocene sedimentary beds  
Umpqua formation

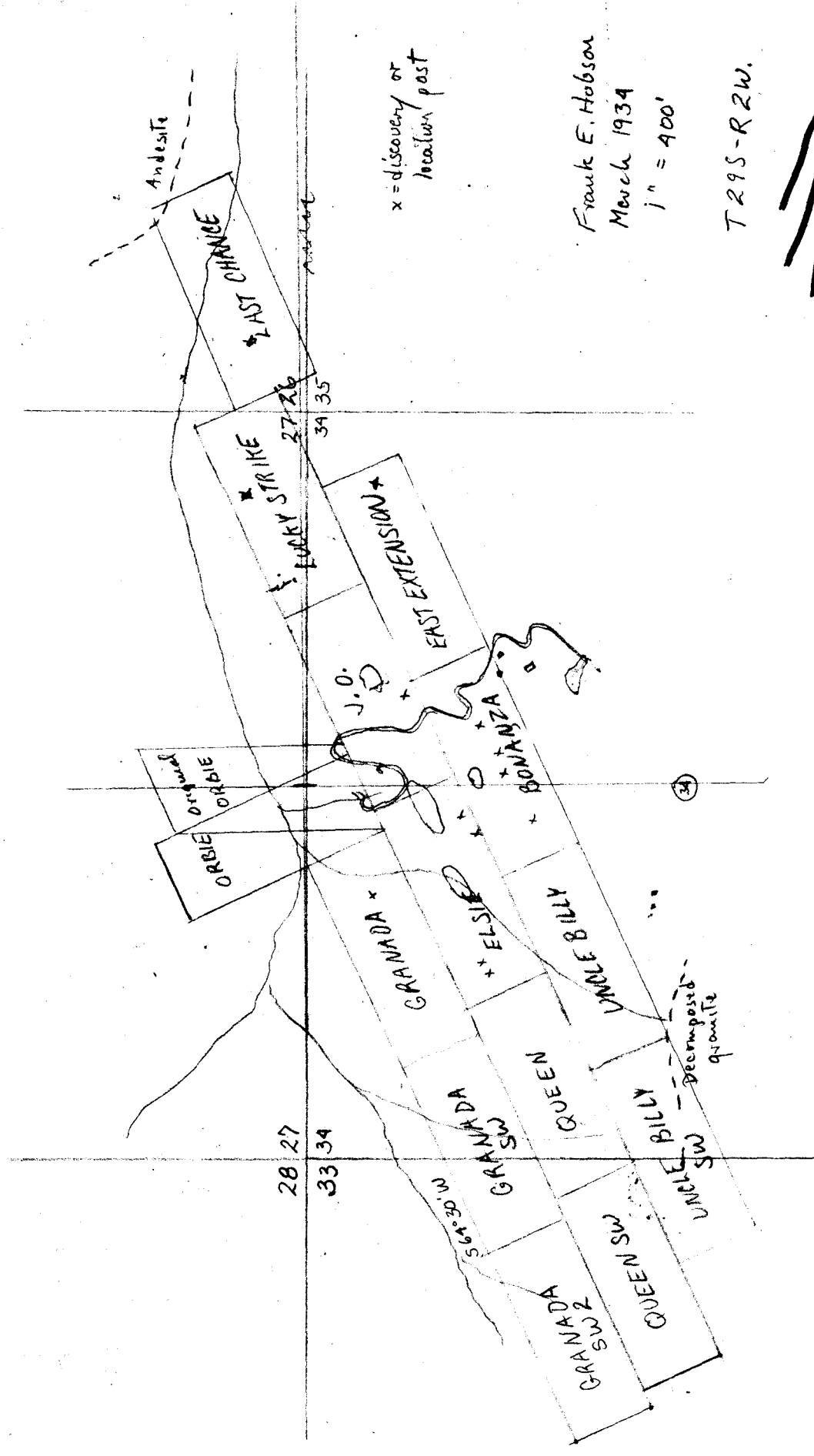

x = discovery or location past

Frank E. Hobson  
March 1934  
1" = 400'

T 29S-R 2W.

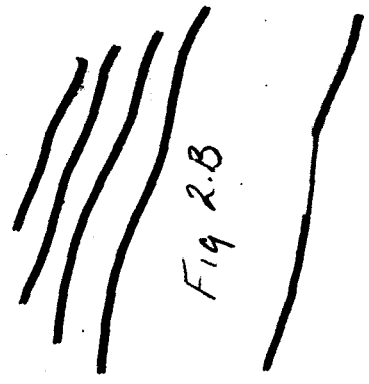

*Umpqua Mining Co. Claims.*

Sec 77

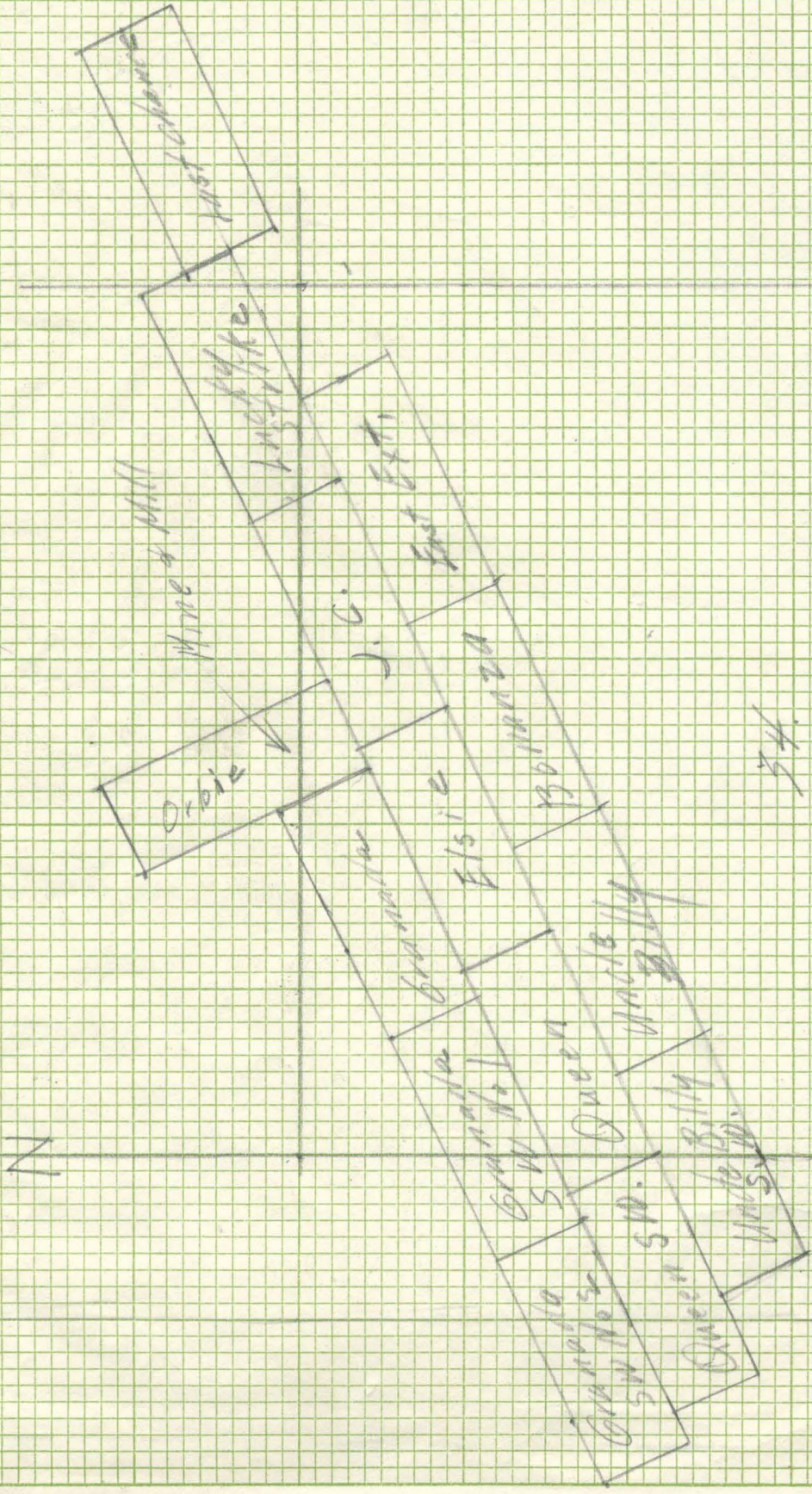

SW

*Buena Vista Mine  
Teller - Down Dist  
Douglas Co.*

WEBB PLACE

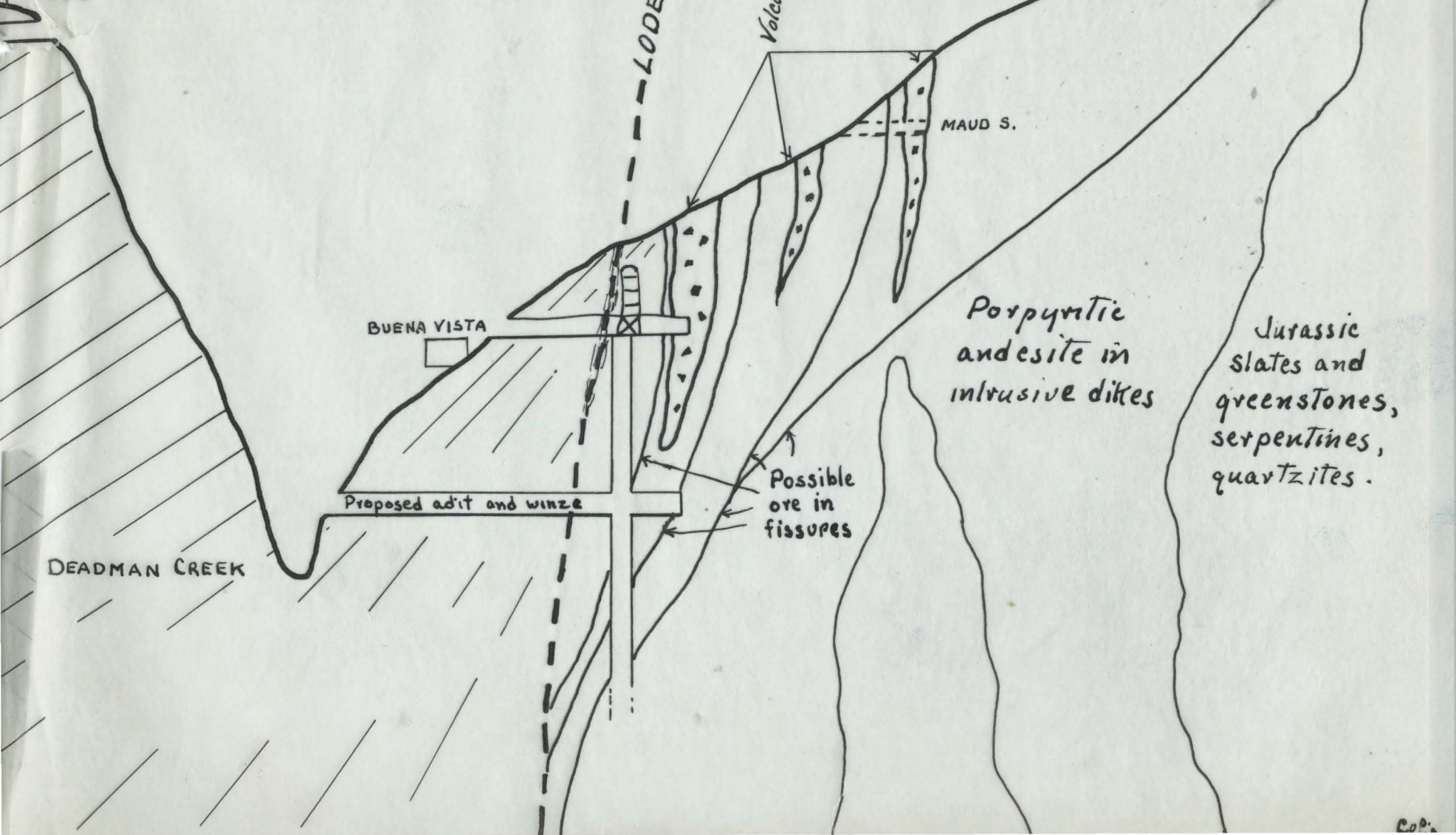

BUENA VISTA

Proposed adit and winze

DEADMAN CREEK

LODE LINE

Volcanic breccia

MAUD S.

Porphyritic  
andesite in  
intrusive dikes

Possible  
ore in  
fissures

Jurassic  
slates and  
greenstones,  
serpentines,  
quartzites.

Cascade basalt  
lava flows (Miocene)