

JOHN DAY RIVER

TO PORTLAND
320 MILES

JOHN DAY HIGHWAY

JOHN DAY

THE STOCKWELL RANCH

1920 A. DEEDED LAND
SECTIONS 27-33 & 34

T. 13 S.
R. 31 E.

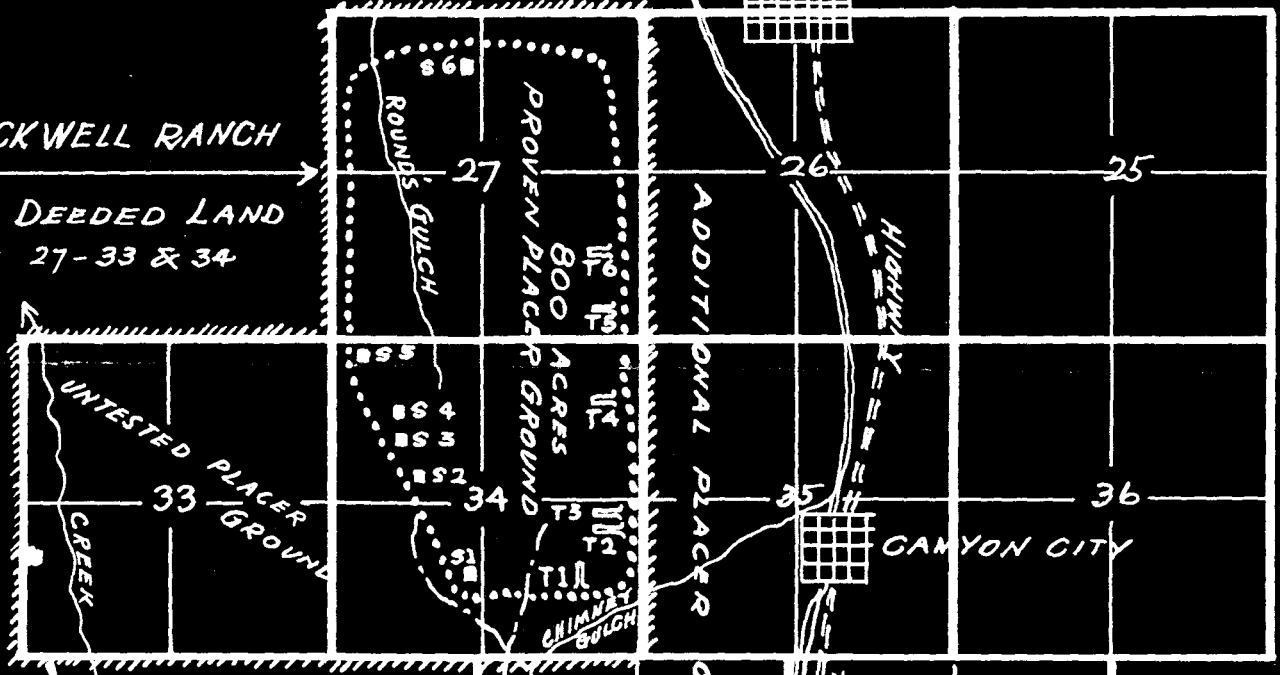

SCHEDULE
OF
TESTS

TUNNEL	#1 =	25¢	CU. YD.
"	2 =	50¢	" "
"	3 =	50¢	" "
"	4 =	1.15	" "
"	5 =	70¢	" "
"	6 =	25¢	" "
SHAFT	*1 =	30¢	" "
"	2 =	55¢	" "
"	3 =	23¢	" "
"	4 =	23¢	" "
"	5 =	65¢	" "
"	6 =	3.00	" "

AVERAGE FOR THE 12
HOLES IS 69¢ PER
CUBIC YARD.

850 LINEAL FEET
represented in the
above work



"	4 =	1.15	"	"
"	5 =	70¢	"	"
"	6 =	25¢	"	"
SHAFT	*1 =	30¢	"	"
"	2 =	55¢	"	"
"	3 =	23¢	"	"
"	4 =	23¢	"	"
"	5 =	65¢	"	"
"	6 =	\$3.00	"	"

AVERAGE FOR THE 12
HOLES IS 69¢ PER
CUBIC YARD.

850 LINEAL FEET
represented in the
above work

MAP of the STOCKWELL RANCH

Located at
Canyon City
Oregon

