

(Deeded Land)

Sketch Map of the
HAMISH BENTONITE PROPERTY
Sec. ⁴ 14 & 9, T 38 S. R 2 E
Asahland District, Jackson County, Oregon
October 1948

0 500 1000 ft.

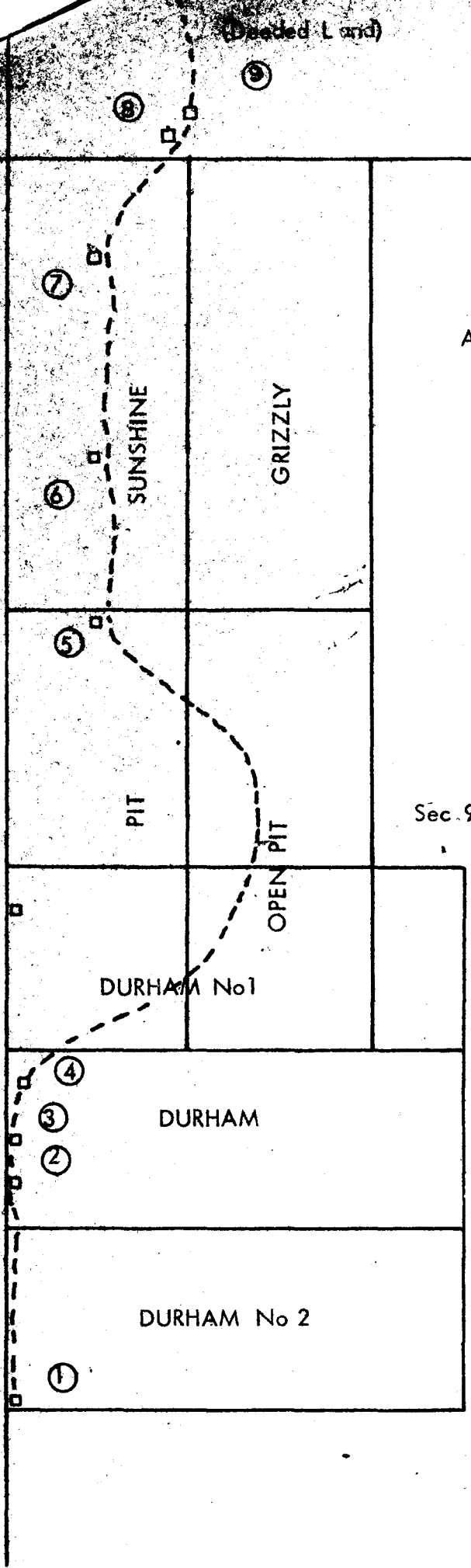

EXPLANATION

- Cut
- ② Samples
- - - Access trail

H.D. WOLFE