

Sec 31, T32, R3W, W.M.  
Jackson Co. Ore.

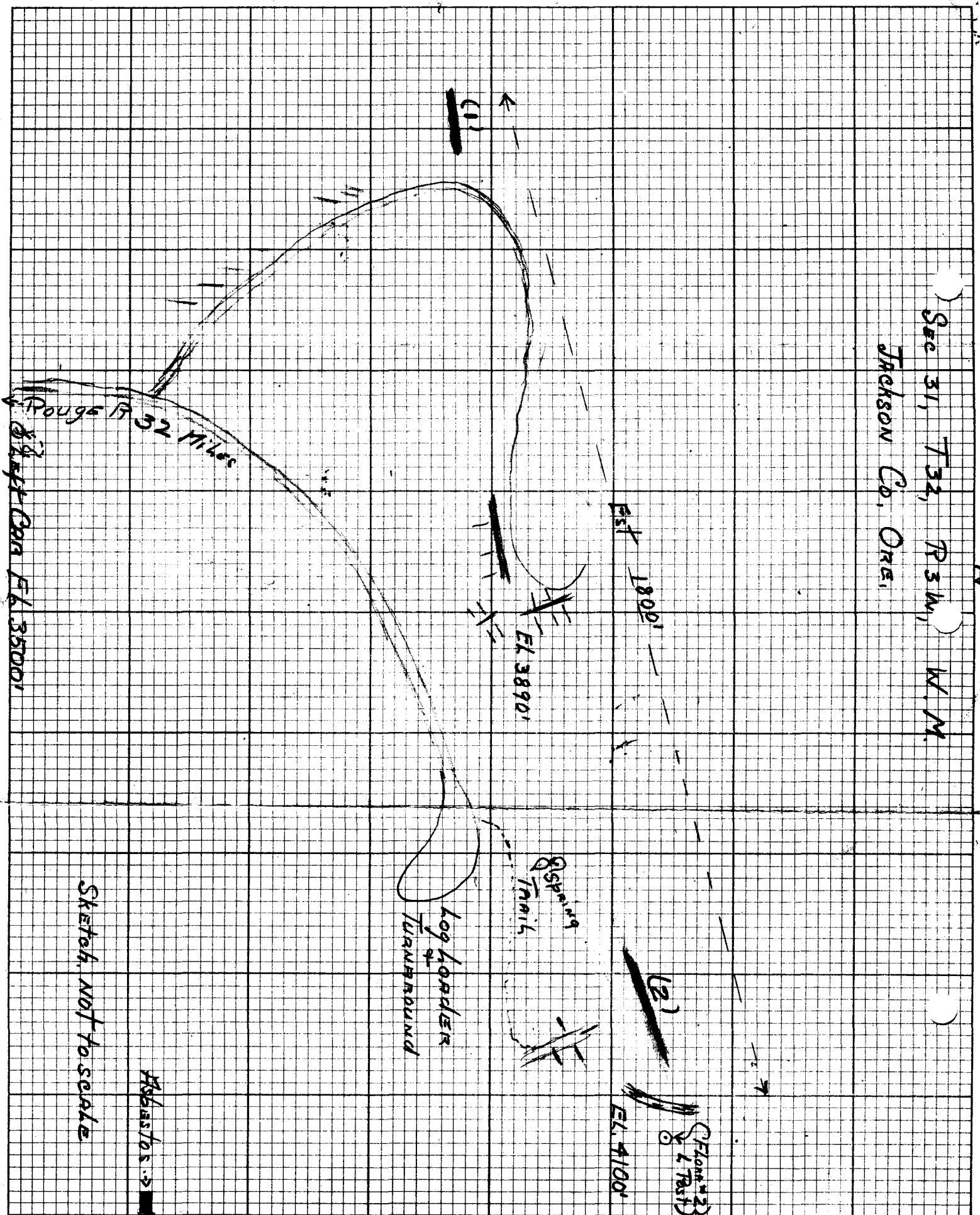

Sketch, not to scale

Declination 21°

Cedar Springs  
Mtn

DOUGLAS COUNTY  
JACKSON COUNTY

Approx. location  
12" fir blazed  
on 4 sides -  
may be quarter corner

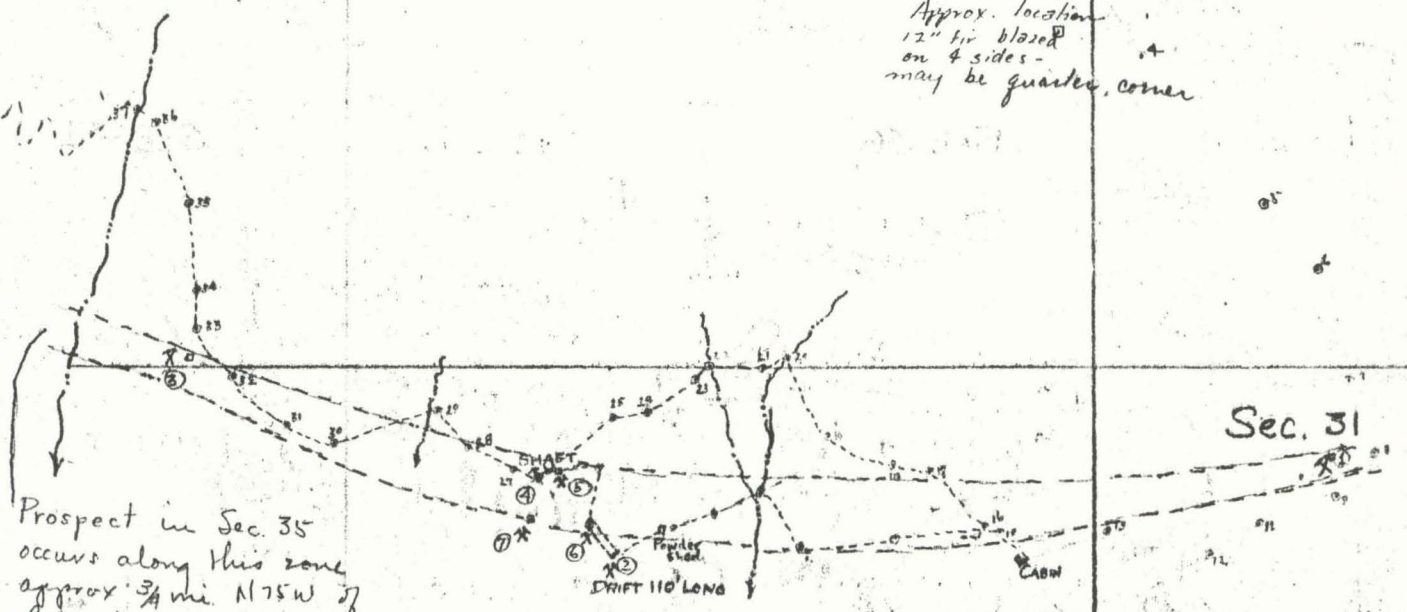

Prospect in Sec. 35  
occurs along this zone  
approx 3/4 mi N75W of  
Prospect 3.

Sec. 36

Sec. 31

R4W  
R3W

T32S  
T33S

Scale: 1" = 400'±

Sec. 6

Sec. 1