

550°E
From Glory Hole
at surface to
upper tunnel.

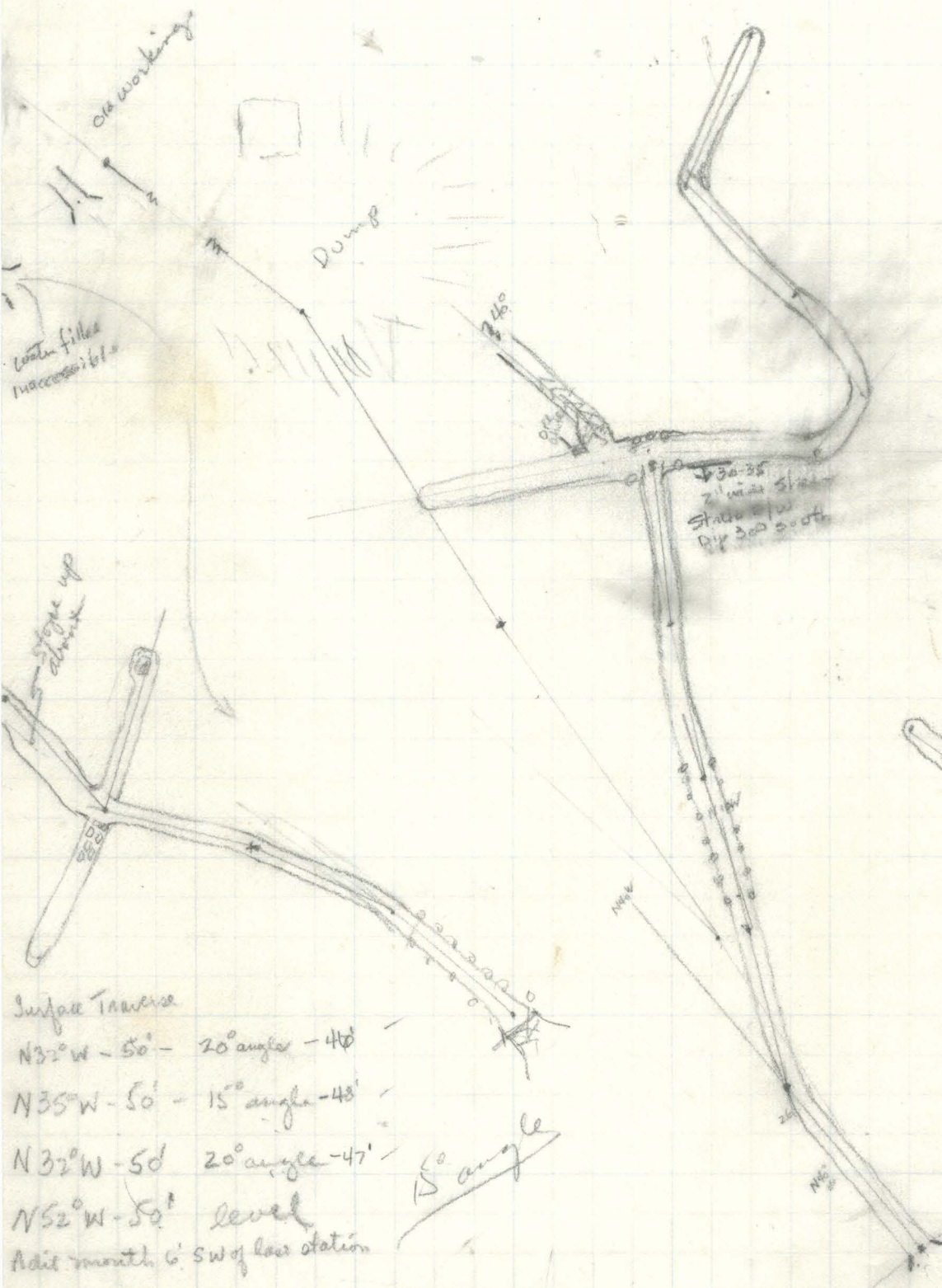

Surface Inverse
 N32°W - 50' - 20° angle - 40'
 N35°W - 50' - 15° angle - 48'
 N32°W - 50' 20° angle - 47'
 N52°W - 50' level
 Adit mouth 6' SW of base station

Upper Tunnel

N65°W - 20'
 N75°W - 19'
 drift N15°E - 20'
 up slope N40°W - 20'

for 25' on
 N38°W - 20' - overhead stop
 N55°W - 35' to end of drift - Cross Cut - N40°E -

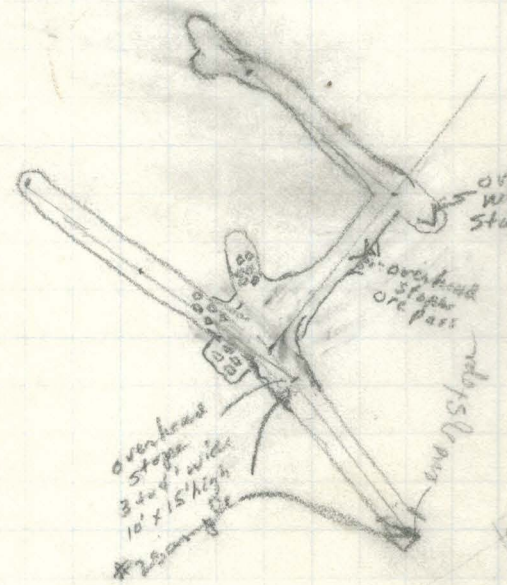

- #1 20' N40°W
- #2 20' N10°W
- #3 20' N15°W
- #4 20' N10°W
- #5 20' N5°W
- #6 30' 58°W
- Raise N50°W
- #7 20' E
- #8 10' N40°E
- #9 14' N35°W
- #10 20' N30°W
- NE

Owl Hollow

Glory Hole to
Upper Tunnel



1 Stope
25' high
3 to 4' wide
15' long

2 Mill

Upper Level

Water filled

Tool House

872 collapsed

Dump

Oct 1963

Brunton & Tape NVP

Scale - 50' = 1"



872 collapsed

Tool Shed

Dump

and
Sift

Cabin