

# BLACK BEAR COAL MINE

W $\frac{1}{2}$  Sec. 36, T. 37S., R. 1W.

Main Level. Alignment by transit Survey  
June 20, 1942 E.E.S.

Pace survey for details July 22, 1943 R.C.T.

SCALE: 1 inch = 100 feet.

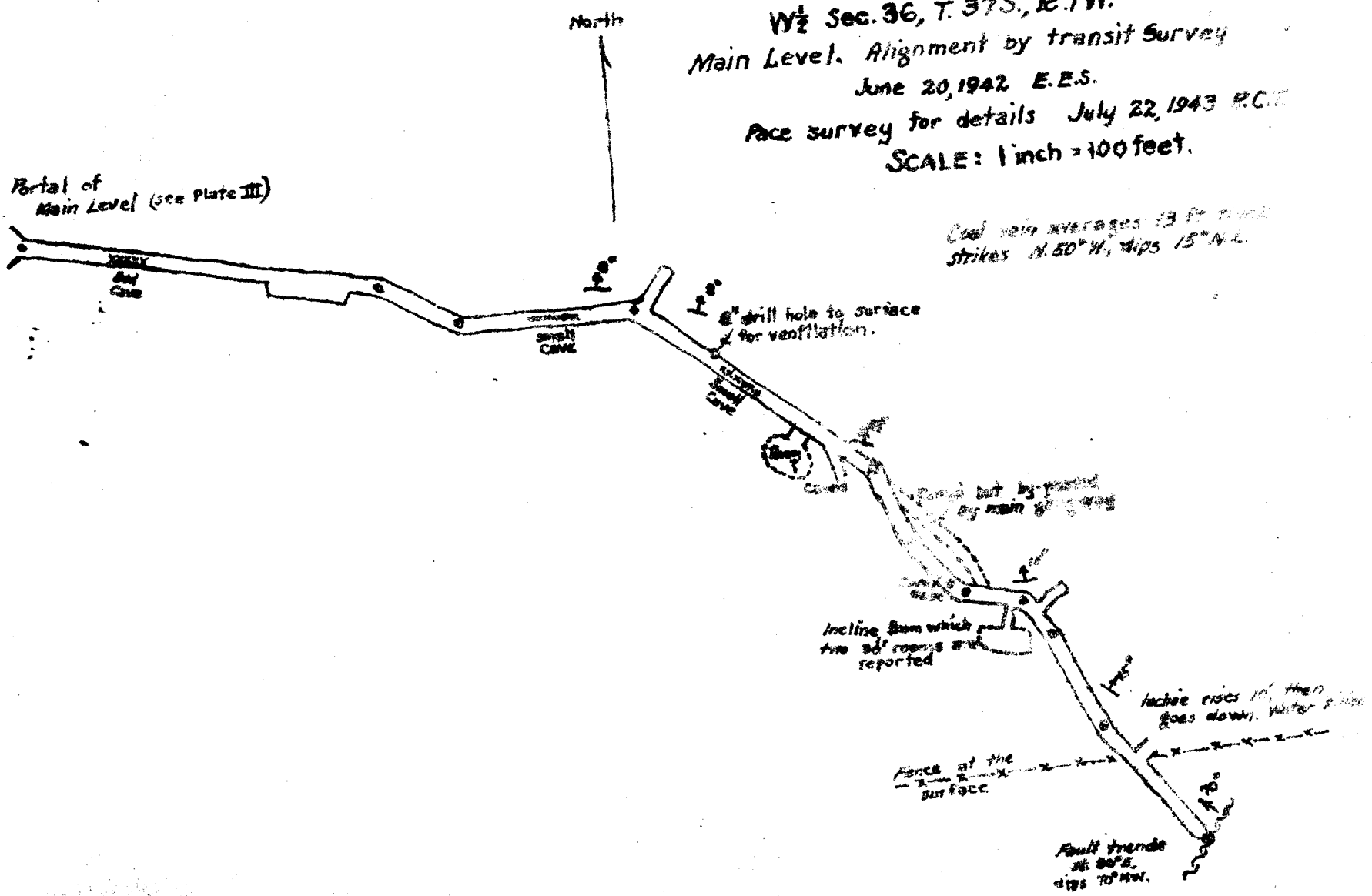

**BLACK BEAR COAL MINE**

W 1/2 sec. 16, T. 97 S., R. 1 W.

Brunton - Pace - Aneroid Survey July 22, 1943

Scale 1 inch = 200 feet

Ray C. Treasher - Field Geologist

North

1925

S.P. stone. Dips 25°  
water filled

"E" elev. 1940'

Caved edit

"L" caved edit  
elev. 1800

"F" shaft  
elev. 2025

"M" caved edit

MAIN LEVEL

Jump  
elev. 2020

"A" caved edit  
elev. 2050

"A" level plotted  
from tent of Paris  
& quarry log

"H" caved edit  
elev. 2100

"J" caved edit  
elev. 2100

These probably  
shall result with  
N.S.P.

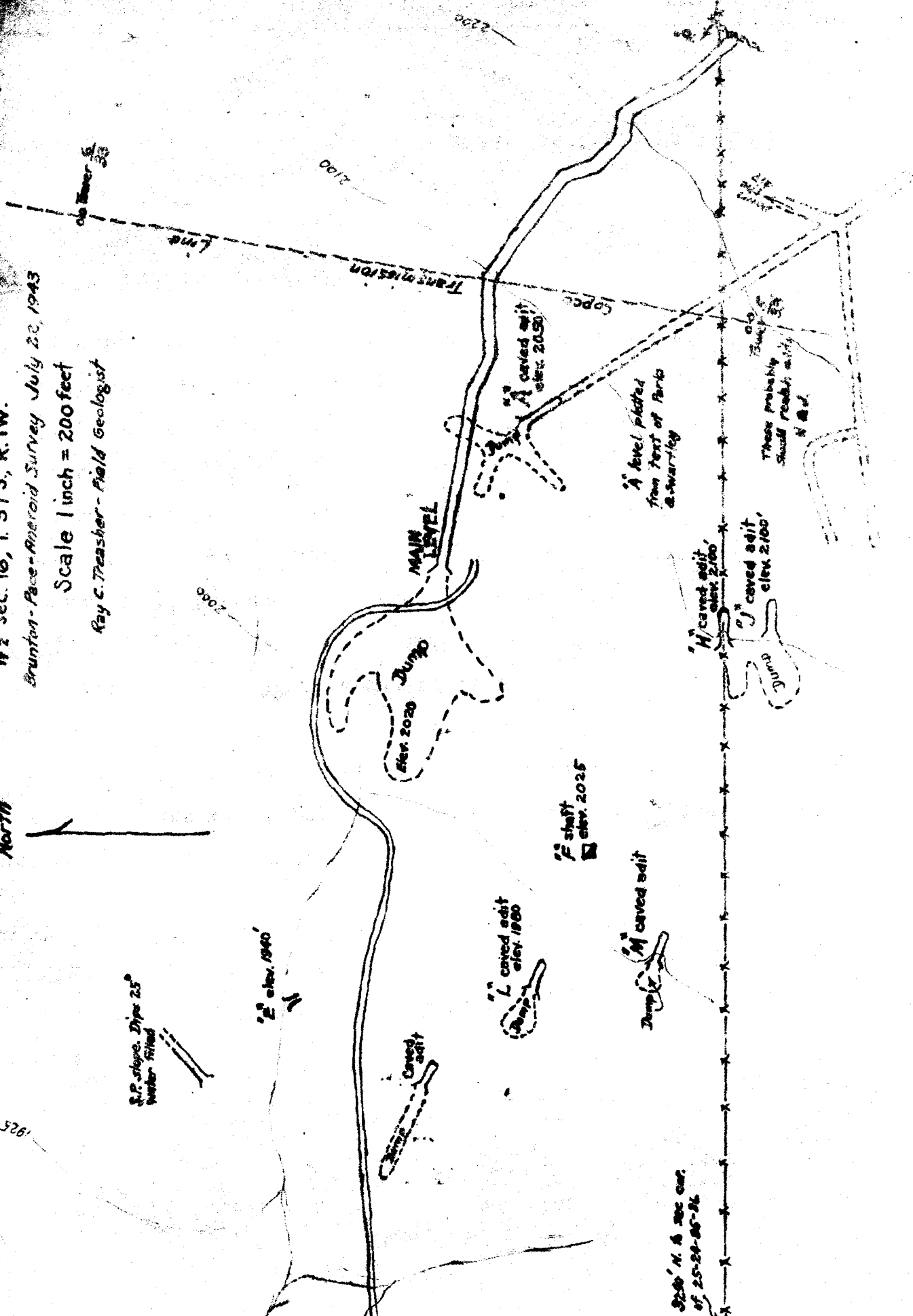

S20' N. & 300' cor.  
of 25-24-25-26'



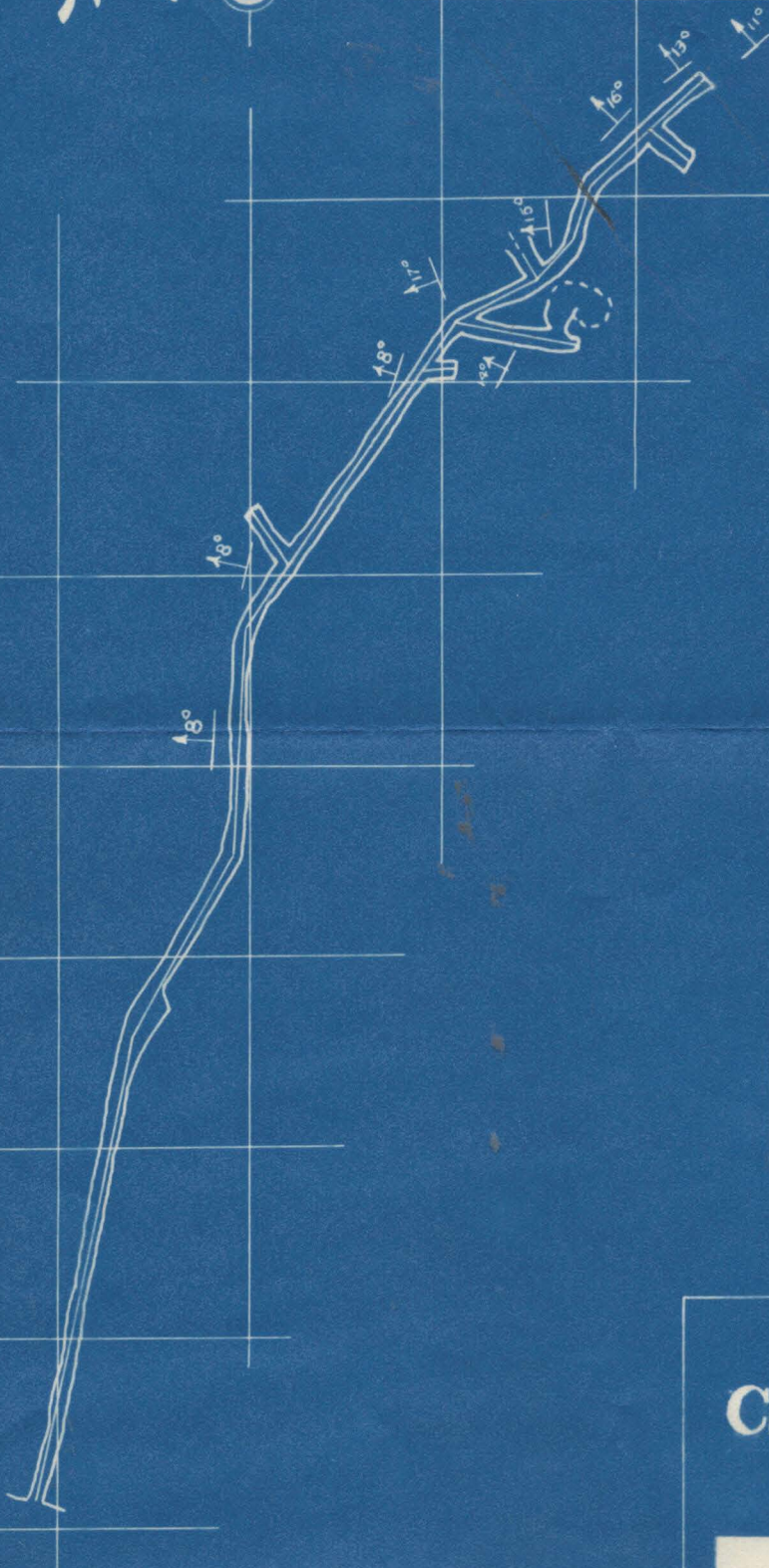

Mine Map  
of  
**CRATER COAL COMPANY**  
T37S-R1W-S36-W $\frac{1}{2}$   
Phoenix, Oregon

Scale: 1" = 100'





Mine Map  
 of  
**CRATER COAL COMPANY**  
 T37S-RIW-S36-W1/2  
 Phoenix Oregon

Scale 1" = 100'



4

52 Cascade Coal Co.

7375

Roxy Ann Coal Co

9

10

11

12

2500'

3000'

Roxy Ann Peak  
3584'

16

Roxy Ann  
15

13

21

22

23

24

Sunnyside Coal Co.

28

27

26

25

Meridian

Hanson Coal Co. 1650

Crater Coal  
216 Sunnyside Coal 1970  
Black Bear

33

34

35

36





