

RECEIVED  
JAN 18 1955  
State Department of Geology and Mineral Industries

DEPT. OF GEOLOGY  
& MINERAL INDS.

1069 State Office Building  
Portland 1, Oregon

Memorandum

MIDNIGHT QUICKSILVER PROSPECT

Jackson County  
Unclassified Dist.

Owners: O. H. Peterson and Sam A. Iversen.

Location: N. edge NW $\frac{1}{4}$  sec. 33, and S. edge sec. 28, T. 33 S., R. 1 E.  
at about 2,000 feet elevation.

History: A brief report is in Bull. 55, p. 65.

Development: The main workings consist of a shallow open cut area about 150 x 200 feet with two short adits. Work is progressing on the western adit (Tunnel No. 1) and it is about 25 feet in length in a N. 35° W. direction. There is a short right-hand drift about 8 feet from the portal.\* The No. 2 tunnel lies about 100 feet east of No. 1 and is about 15 feet in length. An old shallow cut is located about 250 feet south and down hill from the main workings. A few other small prospect cuts have been made up the ridge and around the hill to the east of the main workings.

Geology: The area is underlain by gently dipping basalt and tuff breccia of the Western Cascade volcanic series of Tertiary age. Thin remnants of Rogue River bench gravel were noted at about 2,000 feet elevation on the southeast side of the ridge.

Mineralization appears to be related to north-trending shear zones that are hydrothermally altered to clay and contain secondary silica and abundant limonite seams. A thin N. 30° E-trending vein of opalite has been exposed on the west side near the top of the ridge above the main workings. On the east side of the ridge, both above and below the road leading to the prospect a NW-trending, steeply-dipping, hard quartz vein from 1 to 2 feet thick is exposed. The north end of the vein appears to be either offset about 200 feet horizontally westward by faulting, or there are two similar parallel veins present just above the road. The quartz veins have been explored superficially but no evidence of values was noticed.

Two northwest-trending, near-vertical-faults accompanied by rock alteration are exposed about  $\frac{1}{2}$  mile southeast of the prospect on Crater Lake Highway just east of McLeod Guard Station.

Equipment & exploration: The prospect has been equipped with a gas-fired, semi-portable 5 to 10-ton rotary furnace. It is being used to test-run exploration ore. The ore is distinguished from waste rock by panning. It is seldom that cinnabar is readily visible in the altered rock. Most of the cinnabar appears to be intimately associated with dark-brown limonite seams. Its pattern of concentration has not been accurately determined as yet.

---

\*(No measurements were made, all distances are visual estimations).

- 2 -

Samples taken for assay include: ZG-217, a 4-foot chip taken across the face of the right-hand drift in No. 1 tunnel which assayed 5.00 lbs./ton Hg; ZG-218, a grab sample of rock from the floor of the left-hand drift near the "Y" which assayed 3.00 lbs./ten Hg; and ZG-219 which was split from a week's run of furnaced rock which assayed 4.10 lbs./ton Hg. Samples ZG-220 and 221 from the fault zones on Crater Lake Highway near McLeod Guard Station both assayed 0.20 lbs./ ton Hg.

Visited: 12/17/65.

Report by: Len Ramp 12/22/65.

\*\*\*\*\*

RECORD IDENTIFICATION  
 RECORD NO..... M015640  
 RECORD TYPE..... X1M  
 COUNTRY/ORGANIZATION. USGS  
 FILE LINK ID..... CONSV  
 MAP CODE NO. OF REC..

REPORTER  
 NAME ..... LEE, W  
 DATE ..... 74 01

NAME AND LOCATION  
 DEPOSIT NAME..... MIDNIGHT PROSPECT

MINING DISTRICT/AREA/SUBDIST. TRAIL

COUNTRY CODE..... US  
 COUNTRY NAME: UNITED STATES

STATE CODE..... OR  
 STATE NAME: OREGON

COUNTY..... JACKSON

QUAD SCALE QUAD NO OR NAME  
 1: BUTTE FALLS

LATITUDE LONGITUDE  
 45-49-34N 119-25-50W

UTM NORTHING UTM EASTING UTM ZONE NO  
 4723750. 524150. +10

TWP..... 33S  
 RANGE..... 01E  
 SECTION.. 28  
 MERIDIAN. W.M.

POSITION FROM NEAREST PROMINENT LOCALITY: SOUTH CENTRAL PART OF SECTION.

COMMODITY INFORMATION  
 COMMODITIES PRESENT..... HG

EXPLORATION AND DEVELOPMENT  
 STATUS OF EXPLOR. OR DEV. 1



RECORD IDENTIFICATION

RECORD NO..... M055835  
RECORD TYPE..... XIM  
COUNTRY/ORGANIZATION. USGS  
INFORMATION SOURCE... BAILEY, E. H.  
MAP CODE NO. OF REC..

REPORTER

NAME..... PETERSON, JOCELYN A.  
DATE..... 76 08  
UPDATED..... 81 02  
BY..... FERNS, MARK L. (BROOKS, HOWARD C.)

NAME AND LOCATION

DEPOSIT NAME..... MIDNIGHT

MINING DISTRICT/AREA/SUBDIST. TRAIL

*Unclassified Dist*

COUNTRY CODE..... US  
COUNTRY NAME: UNITED STATES

STATE CODE..... OR  
STATE NAME: OREGON

COUNTY..... JACKSON  
DRAINAGE AREA..... 17100307 PACIFIC NORTHWEST  
PHYSIOGRAPHIC PRDV..... 13 WEST CASCADES  
LAND CLASSIFICATION..... 01

QUAD SCALE QUAD NO OR NAME  
1: 62500 BUTTE FALLS

LATITUDE LONGITUDE  
42-40-01N 122-42-26W

UTM NORTHING UTM EASTING UTM ZONE NO  
4723650. 524000. +10

TWP..... 033S  
RANGE..... 001E  
SECTION.. 28  
MERIDIAN. WILLAMETTE

LOCATION COMMENTS: S. CENTRAL PART SEC 28

COMMODITY INFORMATION

COMMODITIES PRESENT..... HG

EXPLORATION AND DEVELOPMENT

STATUS OF EXPLOR. OR DEV. 1

PROPERTY IS INACTIVE

PRESENT/LAST OWNER..... JOSEPH MADDEN & ORVAL H. PETERSON

DESCRIPTION OF DEPOSIT

DEPOSIT TYPES:

DISSEMINATED IN CHALCEDONY VEINLETS

FORM/SHAPE OF DEPOSIT:

SIZE/DIRECTIONAL DATA

SIZE OF DEPOSIT..... SMALL

DESCRIPTION OF WORKINGS

SURFACE

PRODUCTION

NO PRODUCTION

GEOLOGY AND MINERALOGY

HOST ROCK TYPES..... BASALTS AND TUFF BRECCIAS

PERTINENT MINERALOGY..... LIMONITE STAINED CHALCEDONY VEINLETS

LOCAL GEOLOGY

NAMES/AGE OF FORMATIONS, UNITS, OR ROCK TYPES

1) NAME: LITTLE BUTTE VOLCANIC SERIES

AGE: EOLIG-EMID

SIGNIFICANT ALTERATION:

BLEACHING OF TUFFS

GENERAL REFERENCES

1) BROOKS, H. C., 1963, QUICKSILVER IN OREGON: OREGON DEPT. OF GEOLOGY AND MINERAL INDUSTRIES, BULL. 55, 223 P.,

65

2) MERCURY IN OREGON, 1965, USBM IC 8252



SAMPLE SUMMARY- PETERSON & IVERSEN

| Sample No. | Description   | Sample Type & width | Analysis Pounds Hg/Ton |
|------------|---|---------------------|------------------------|
| 1          | Pits of old timers on Bojock #12. Iron oxides from 4 foot wide trench           | Grab sample         | 0.2                    |
| 2          | Face of 60' tunnel on Bojock #11  | Chip sample 6 feet  | 0.2                    |
| 3          | Wall sample the length of tunnel on Bojock #11                                  | Chip-50 ft.         | 0.3                    |
| 4          | 4th bulldozer cut <u>above</u> plant on Midnight Claim                          | Chip-20 ft.         | 0.1                    |
| 5          | Red kiln tailings <u>below</u> plant  | Grab by S. A. I.    | 0.1                    |
| 6          | 2nd bulldozer cut <u>below</u> plant  | Soil grab-10 ft.    | 0.1                    |
| 7          | 1st trench <u>below</u> plant - a hard pit face sampled by O. H. P.             | Chips-6 ft.         | 0.6                    |
| 8          | Soil sample on top of hill among the hard black lava boulders - Eagle Claim     | Grab sample         | 0.2                    |
| 9          | Midnight claim at edge of Eagle Claim road cut north of ridge                   | Chips-10 ft.        | 0.1                    |
| 10         | Midnight claim, 3rd bulldozer cut <u>above</u> plant                            | Chips-20 ft.        | 0.1                    |
| 11         | Midnight claim, 2nd bulldozer cut <u>above</u> plant. Sample of rich stringer.  | Chip-4 in.          | 142.2                  |
| 12         | Cross cut to right off the main tunnel - 18 ft. of wall and 4 ft. of face       | Chips-22 ft.        | 0.1                    |
| 13         | Main tunnel wall, face to 20 feet back of left wall                             | Chip-20 ft.         | 0.6                    |
| 14         | Main tunnel wall, 20 ft. back to 40 ft. back from face                          | Chip-20 ft.         | 0.2                    |
| 15         | Main tunnel wall, 40 ft. back to 60 ft. back from face                          | Chip-20 ft.         | 0.3                    |
| 16         | Main tunnel wall, 60 ft. back to portal of tunnel                               | Chip-10 ft.         | 0.2                    |
| 17         | 1st cut above plant at tunnel level-30 ft. of face of cut from main tunnel east | Chip-30 ft.         | 0.4                    |
| 18         | 1st cut above plant, 28 ft. of face from sample 17                              | Chip-28 ft.         | 1.3                    |

|    |  |             |     |
|----|--|-------------|-----|
| 19 | 1st cut above plant, wall of No. 3 tunnel,<br>22 ft. long            | Chip-22 ft. | 0.2 |
| 20 | 1st cut above plant, wall of No. 2 tunnel,<br>8 ft. long             | Chip-8 ft.  | 0.6 |
| 21 | 1st cut above plant, face of cut from No. 3<br>tunnel to drill holes | Chip-30 ft. | 0.2 |
| 22 | Plant level cut from plant east for 25 ft.                           | Chip-25 ft. | 0.1 |
| 23 | Plant level cut from 25 ft. east to 50 ft. east                      | Chip-25 ft. | 0.1 |
| 24 | Plant level cut from 50 ft. east to 75 ft. east                      | Chip-25 ft. | 0.1 |

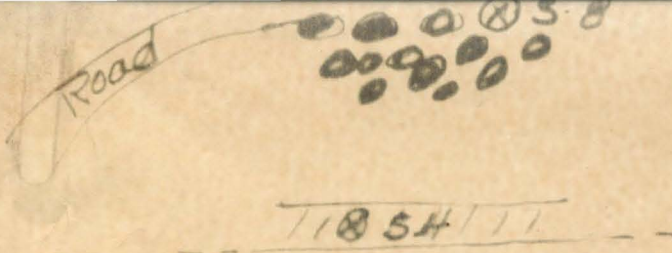

⊗ S-9

⊗ S-10

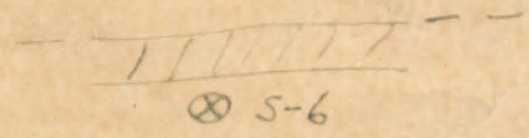
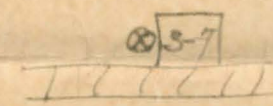
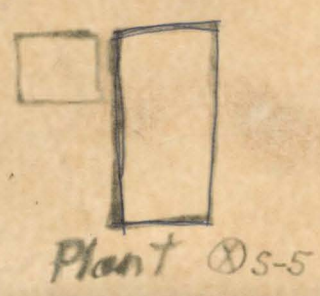
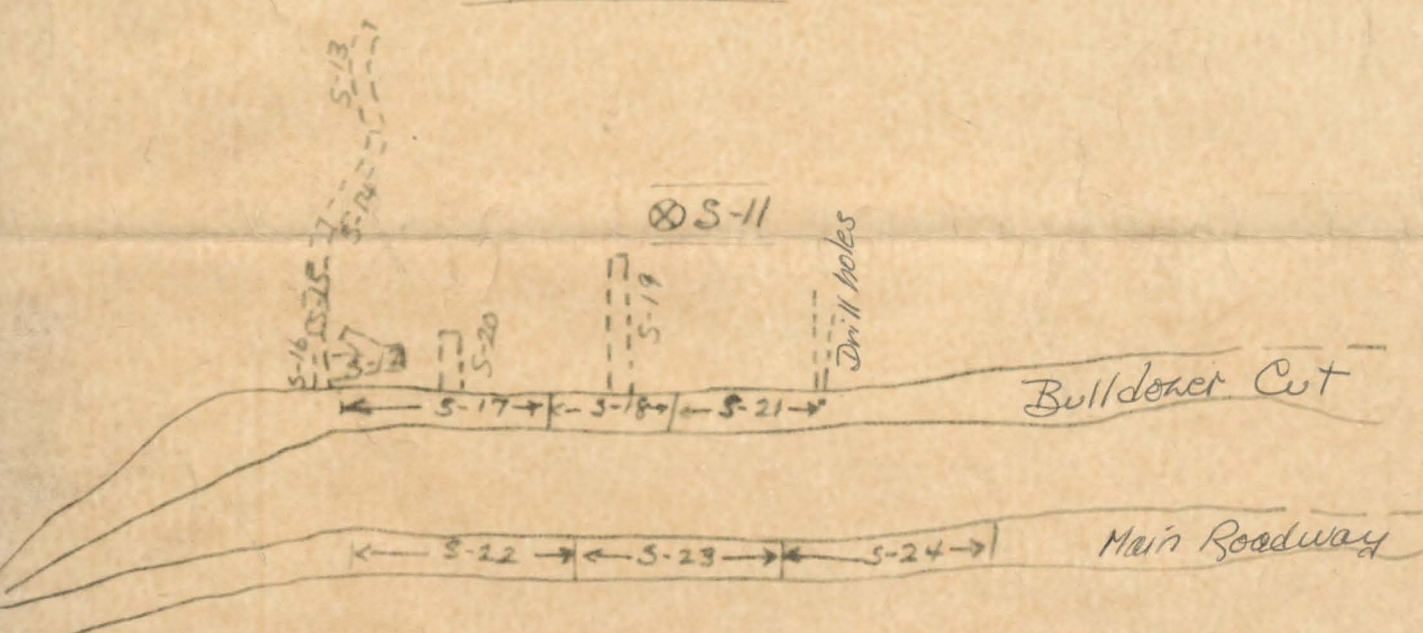

Location of Principle Samples  
 S = samples, by numbers



Midnight claim

N 33° E Opalite ledge  
el 2000' Bench gravel  
on SE side ridge

Iversen & Peterson, C.H.

Point Arena, Cal

N 35° W in No 1 tunnel  
left hand drift  
alt basalt

Sam A. Iversen  
PO B 236  
Steady Cove

Send assay results.

~~890~~

Jackson County  
unclassified Dist.Midnight Quicksilver ProspectOwner~~Owners~~: O. H. Peterson and Sam A. IversenLocation: N. edge NW<sup>1</sup>/<sub>4</sub> sec. 33, <sup>and</sup> S. edge sec. 28, T. 33 S., R. 1 E.

at about 2,000 feet elevation.

History: A brief report is in Bull. 55, p. 65.

Development: The main workings consist~~d~~ of a shallow open cut area ~~of~~ about 150 x 200 feet with two short adits. Work is progressing on the western adit (Tunnel No. 1) <sup>and it</sup> ~~which~~ is about 25 feet in length in a N. 35° W. direction, <sup>there is</sup> ~~and has~~ a short right-hand drift about 8 feet from the portal\*.

The No. 2 tunnel <sup>lies</sup> ~~lies~~ about 100 feet east of No. 1 and is about 15 feet in length. An old shallow cut is located about 250 feet south and down hill from the main workings. A few other <sup>small prospect</sup> ~~cuts~~ <sup>have been made</sup> ~~are situated~~ up the ridge and around the hill to the east of the main workings.

Geology: The area is underlain by gently dipping basalt~~s~~ and tuff breccia~~s~~ of the Western Cascade ~~Tertiary~~ volcanic series, <sup>Tertiary age.</sup> Thin remnants of Rogue River bench gravel were noted at about 2,000 feet elevation on the southeast side of the ridge. ~~Mineralization~~ <sup>Mineralization</sup> appears to be related

to north-trending shear zones that are hydro thermally altered to clay and

\* (No measurements were made, all distances are visual estimations) ~~from~~ <sup>and</sup> ~~memory~~.

contain secondary silica and abundant limonite seams. A thin N. 30° E-trending vein of opalite has been exposed on the west side near the top of the ridge above the main workings. On the east side of the ridge, both above and below the road leading to the prospect a NW-trending, steeply-dipping, hard quartz vein from 1 to 2 feet thick is exposed. The north end of the vein appears to be <sup>either</sup> offset about 200 feet horizontally westward by faulting, or there are two similar parallel veins present just above the road. The quartz veins have been explored superficially but no evidence of values <sup>was noticed</sup> have been detected.

Two northwest-trending, near-vertical faults accompanied by rock alteration are exposed about  $\frac{1}{2}$  mile southeast of the prospect on Crater Lake Highway just east of McLeod Guard Station.

Equipment & exploration: The prospect has been equipped with a gas-fired, semi-portable 5 to 10-ton ~~private-make~~ rotary furnace. It is being used to test-run exploration ore. The ore is <sup>distinguished</sup> separated from waste rock by panning. It is seldom that cinnabar is readily visible in the altered rock. Most of the cinnabar appears to be intimately associated with ~~dark-brown~~ limonite seams. Its pattern of concentration has not been <sup>accurately</sup> determined as yet.



- 3 -

Samples taken for assay include: ZG-217, a 4-foot chip taken across the face of the right-hand drift in No. 1 tunnel which assayed 5.00 lbs./ton Hg; ZG-218, a grab sample of rock from the floor of the left-hand drift near the "Y" which assayed 3.00 lbs./ton Hg; and ZG-219 which was split from a week's run of furnaced rock which assayed 4.10 lbs./ton

Hg. Samples ZG 220 and 221 from the fault zones on Crater Lake Highway near McLead Guard Station both assayed 0.20 lbs/ton Hg.

Visited: 12/17/65

Report by: Len Ramp 12/22/65.

\* \* \* \* \*