

Afterthought Mine (John Bailey)
SE 1/4 Sec. 27, T. 38 S., R. 4 W.

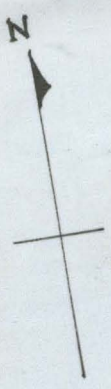

6-30-60
Brunton & pace
Len Ramp

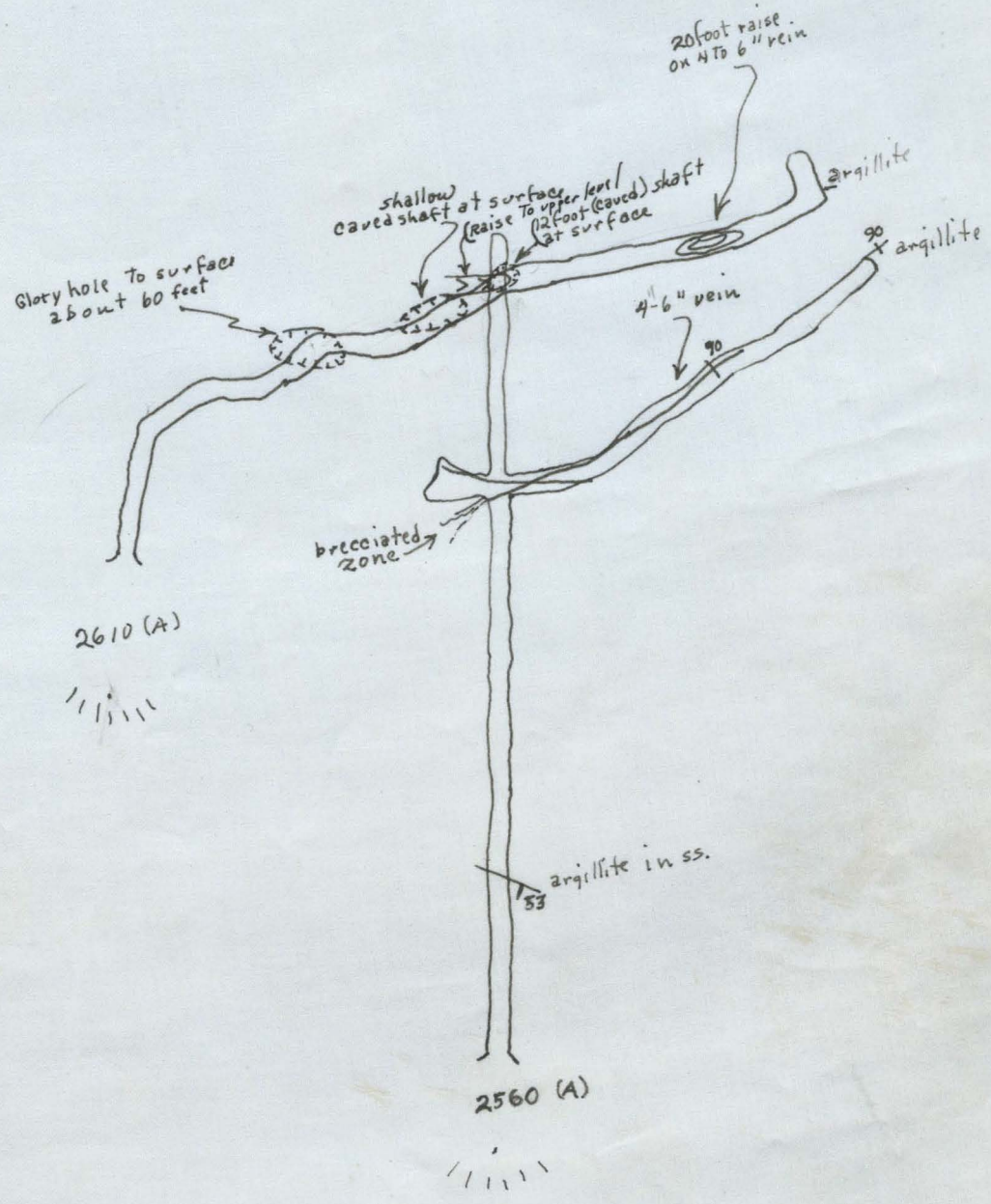

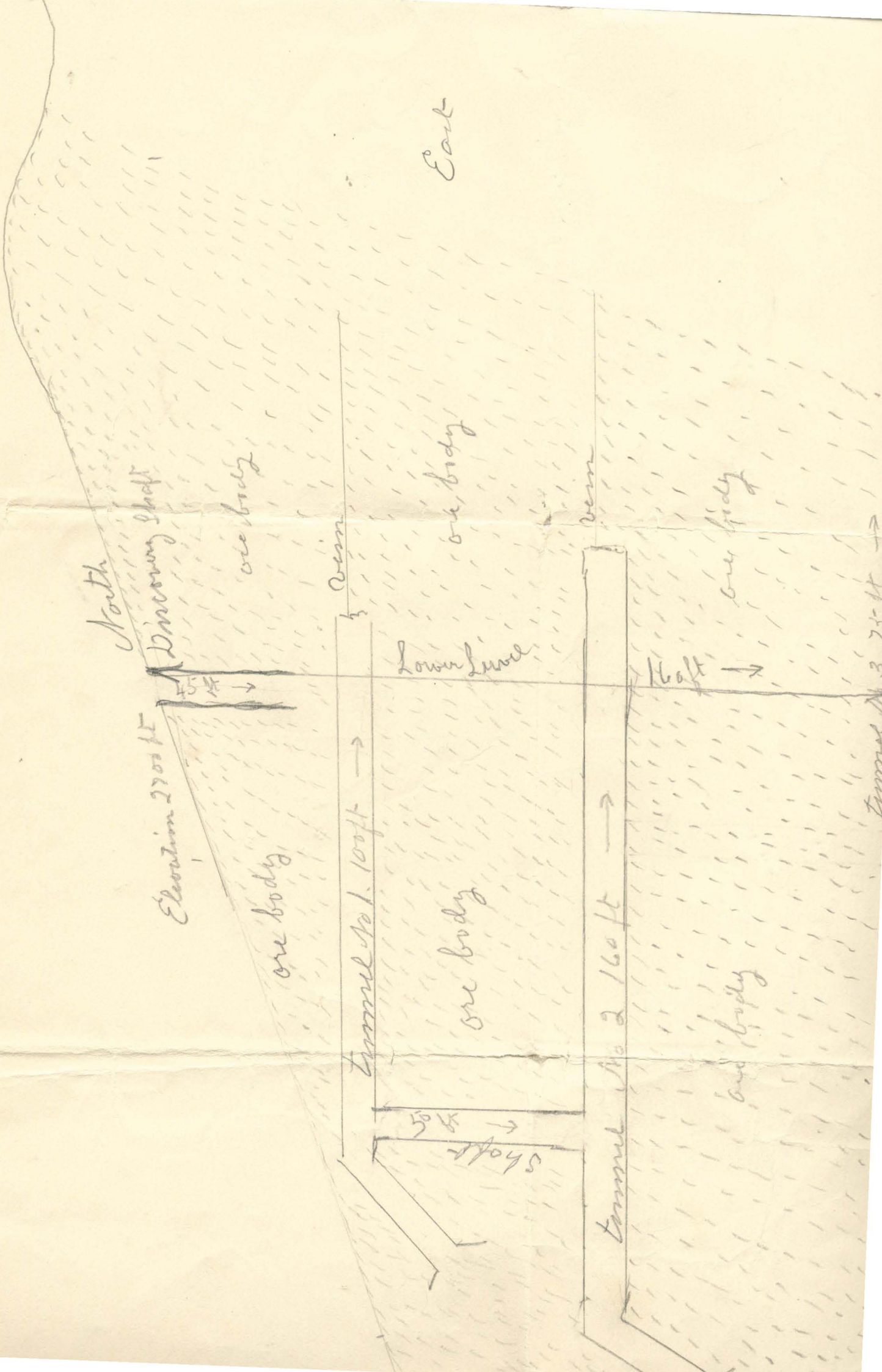

South

Discovery Shaft

Elevation 2700 ft

45 ft →

ore body

vein

Lower Level

ore body

vein

ore body

16 ft →

Tunnel No 3 75 ft →

vein

ore body

Tunnel No 1 100 ft →

ore body

50 ft →
Shaft

Tunnel No 2 160 ft →

ore body

vein

shaft

Afterthought (John Bailey mine)

6-30-60

with Myrtle Hoque & Scott Hyde
elev 2500(A) = tunnel #1
add 75'

N

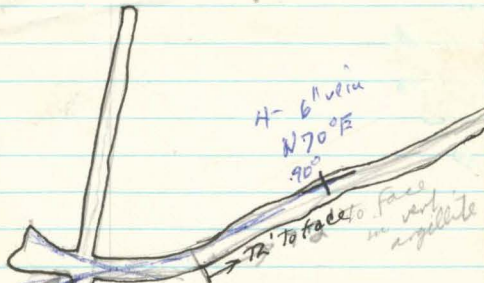

intersecting structures
Narrow linear qtz seams with rusty spots of seams

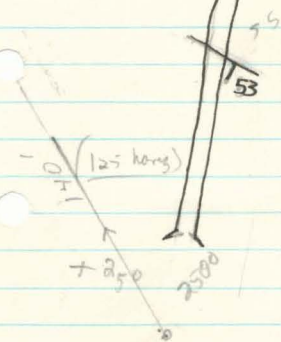

cabin on ridge about 2700 elevation
location noticed white oak
50' S of cabin
Thomas C Schultz & Gladys Schultz Rt 1 Box 61-B Jacksonville John Bailey #1 or Afterthought

Country rock is MS
S of break gully is hd

gray streak 1" to foot wide quartz
hailed out on sleds
milled at W L Slany mill on Thompsons creek about 2 miles up creek

not over 20 tons milled from 50 to 70
Others Bill McDonald & P. purchased
Dunken fish stoped at surface
whitehead killed thereby

After thought

tunnel # 2

2555 (A)

(+ 75)

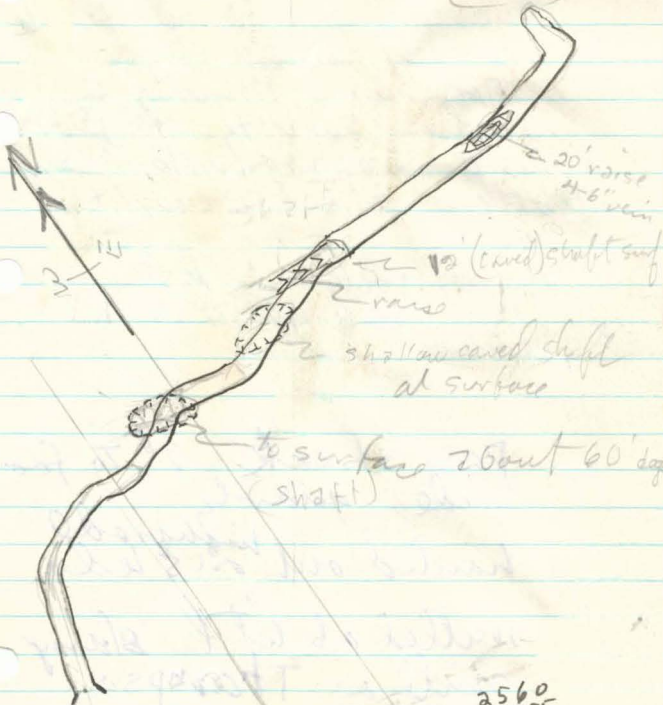

20' raise
4-6" vein

10' (caved) shaft surf
raise

shallow caved shaft
at surface

to surface about 60' deep
(shaft)

2560
55
2615