

BLUE JAY ANTIMONY

NW $\frac{1}{4}$ NW $\frac{1}{4}$ Sec. 14, T. 40 S., R. 4 W.

Brunton-Tape Survey - R.G. Bassett & R.C. Treasher

March 18, 1943

Scale 1 inch = 40 feet

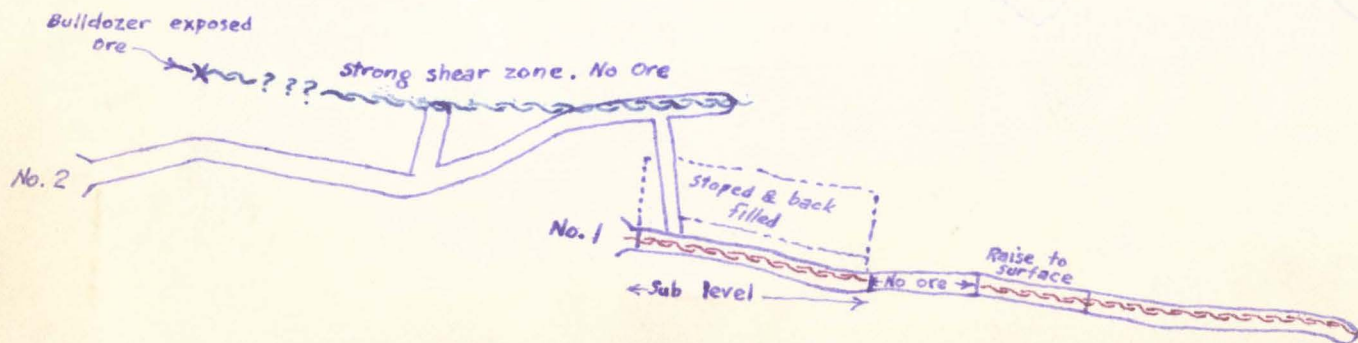

Notebook - Treasher
pp. 42-41 & 43-1d

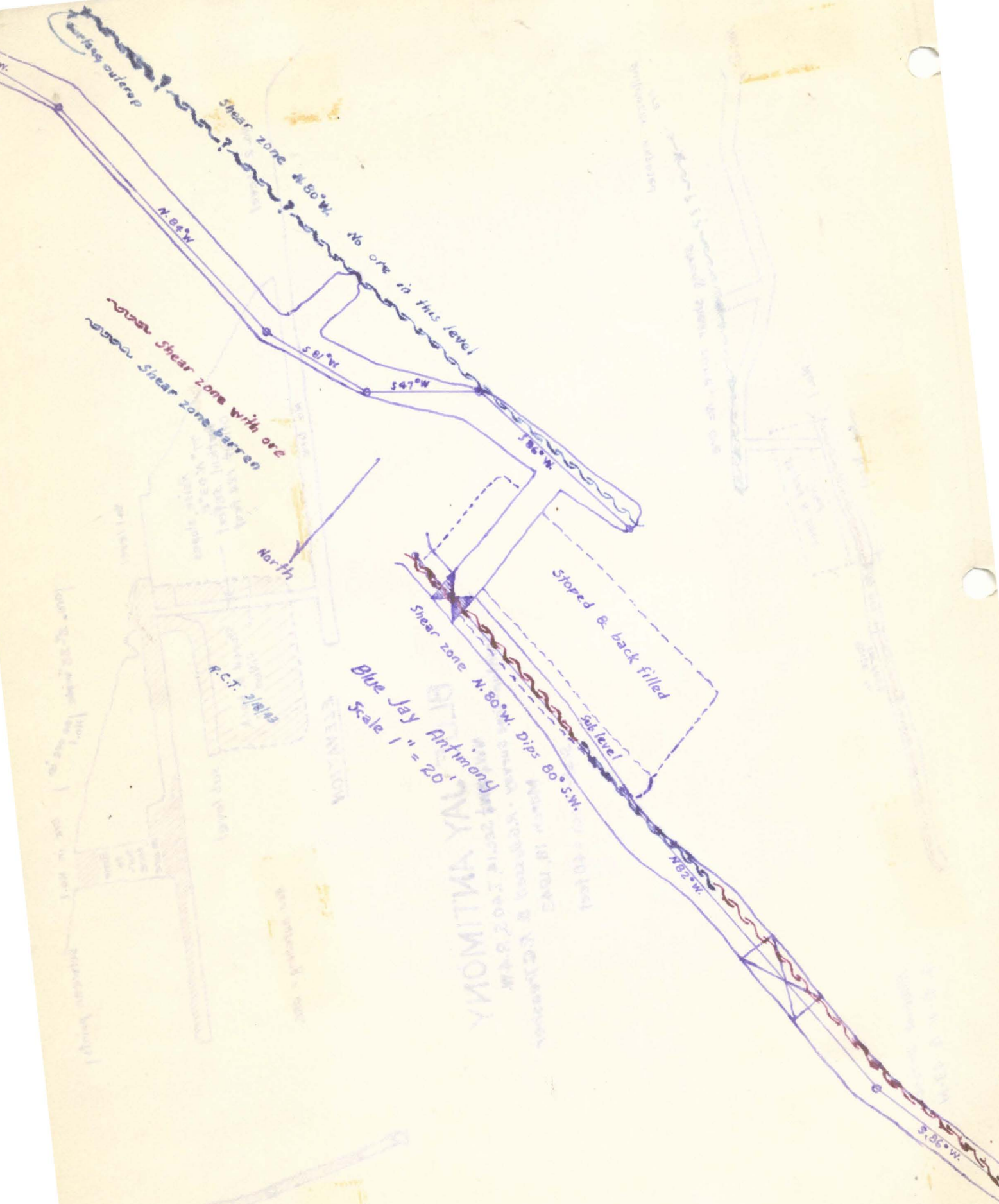

Surface outcrop
 Shear zone N. 80° W.
 No ore in this level

Shear zone with ore
 Shear zone barren

North

Blue Jay Antimony
 Scale 1" = 20'

Shear zone N. 80° W. Dips 80° S.W.
 Stopped & back filled
 Sub level

F.C.T. 2/18/1928

ANTIMONY

N. 86° W.