

DOODLE BUG
No. 3

DOODLE BUG No. 4

DOODLE BUG No. 1

DOODLE BUG No. 2

• Hydro

ADITS

ADITS

ADITS

MAP A

Haskins et al.
Doodle Bug Lodes
Rogue River N.F.
Sec. 3, T40S, R4W.

Scale: 1 in = 330 ft.
CFA



TABLE I

SAMPLE	GRAVITY	% Au	WT.	NET WT.	TA.
	GOLD			TAILS	WIDTH
DB-1-1	Trace	0.25	0.50	51.56	50
DB-1-2	"	0.50	0.60	1.65	60
DB-1-3	"	0.90	0.80	2.17	50
DB-1-4	"	1.045	0.90	2.13	22

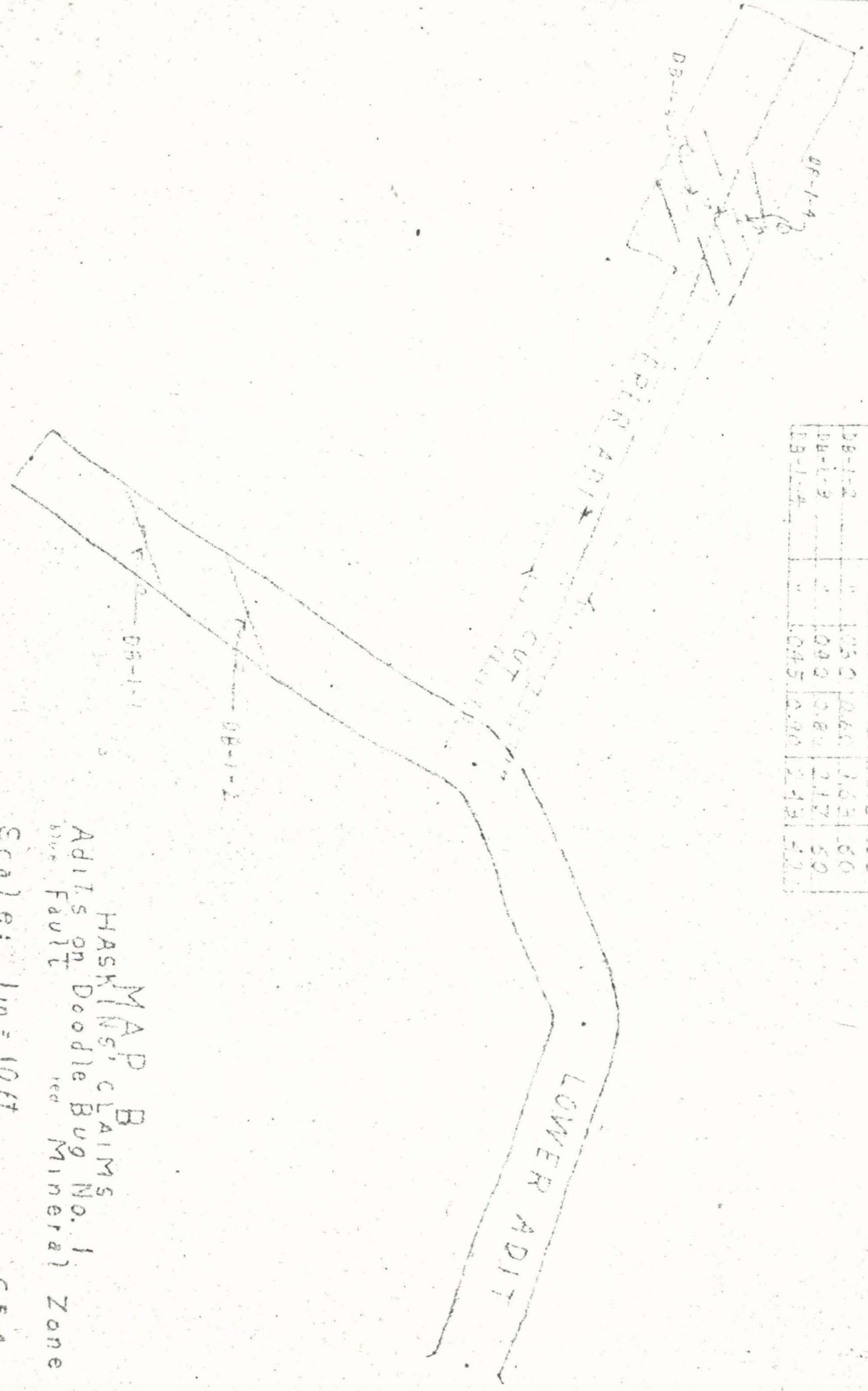

HASKINS' CLAIMS
 MAP B
 Adits on Doodle Bug No. 1
 Fault
 Mineral Zone

Scale: 1 in. = 10 ft.
 C F A

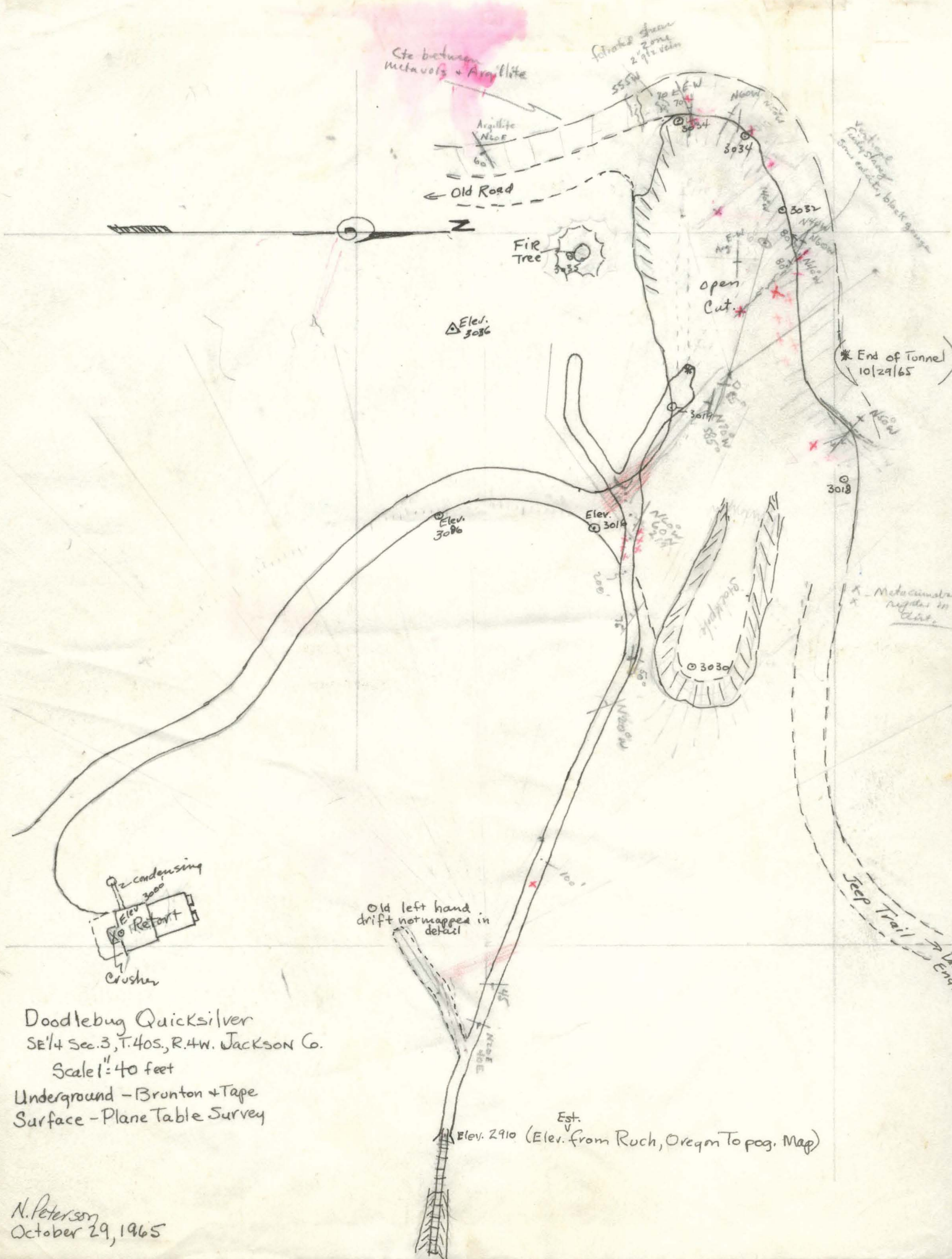

Doodlebug Quicksilver
 SE 1/4 Sec. 3, T. 40S, R. 4W. JACKSON Co.
 Scale 1" = 40 feet

Underground - Brunton + Tape
 Surface - Plane Table Survey

N. Peterson
 October 29, 1965

Approx. location of upper west adit 1970

* End of working Face - 5/19/66 (Sample across face)

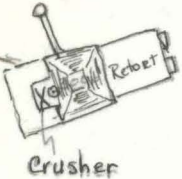
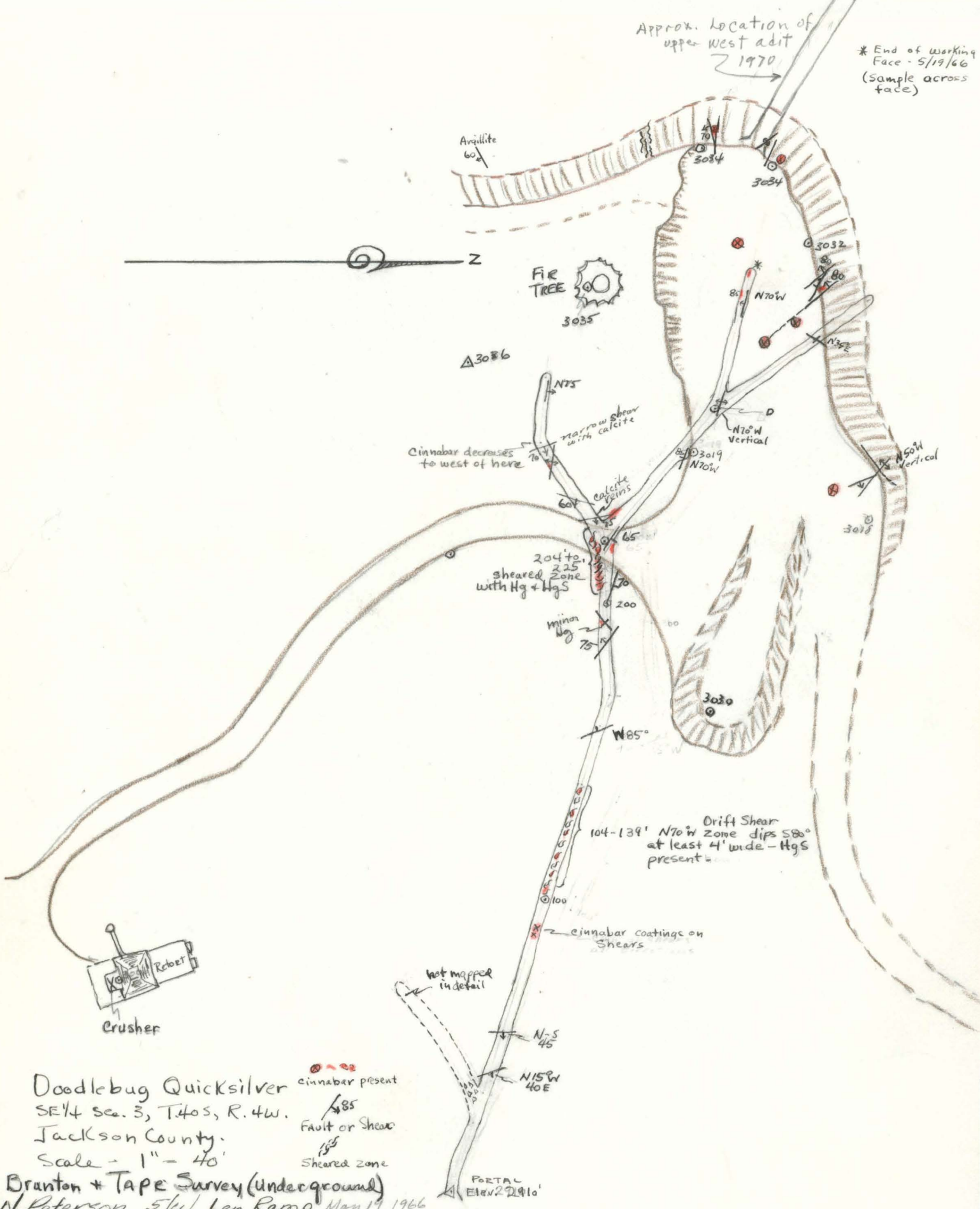

Doodlebug Quicksilver
SE 1/4 Sec. 3, T.40S, R. 4W.
Jackson County.
Scale - 1" = 40'

● ● ● ● cinnabar present
/ 85 Fault or Shear
155 Sheared zone

Branton + Tape Survey (underground)
N. Peterson 5661 Len Ramp May 19, 1966
Surface mapped 1065 Plane Table. N. Peterson

DOODLEBUG CLAIM HgS







8-4-61

Brunton & pace L.R.

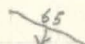
SE 1/4 sec. 3, T.40S, R.4W.

scale 1" = 20'

-  fault showing dip
-  sheared zone
-  vertical joint
-  visible HgS on fractures

