

CROSSCUTE ON DISCOVERY VEIN

NW  SE

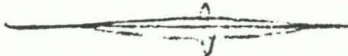
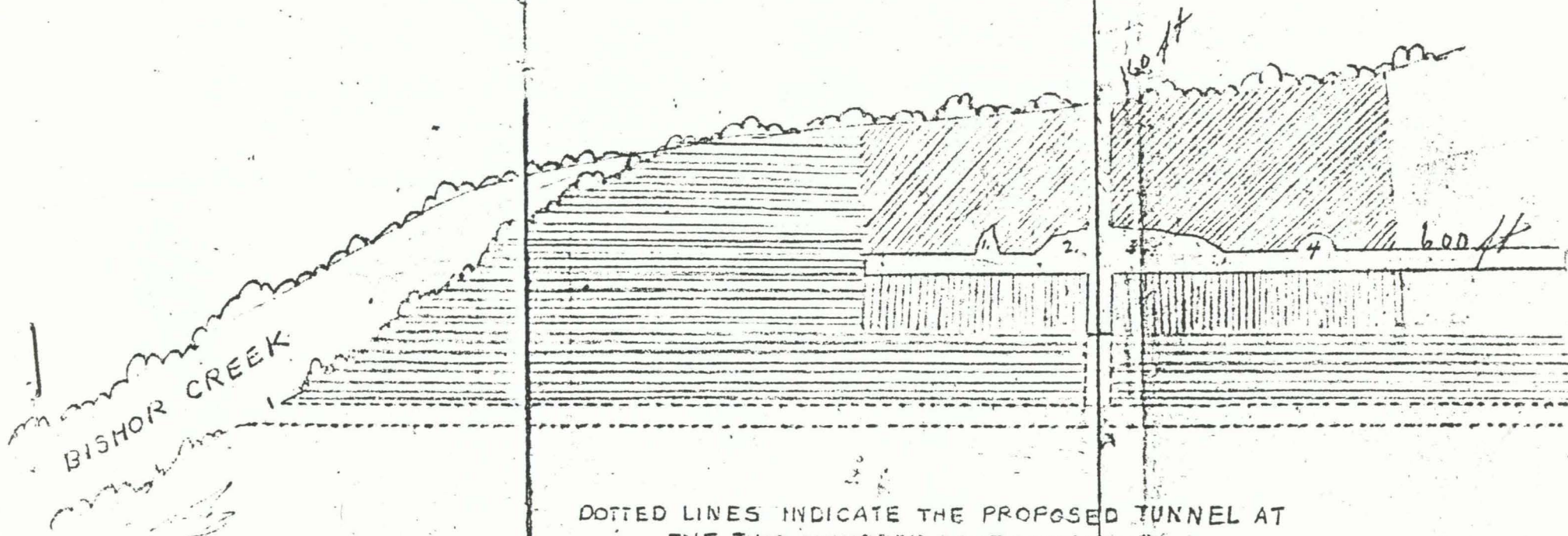
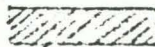

DOTTED LINES INDICATE THE PROPOSED TUNNEL AT THE TWO HUNDRED FOOT LEVEL

 BLOCKED OUT ORE

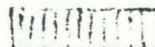
 BLOCKED OUT ON TWO SIDES

 PROBABLE ORE

1-2-3-4 Stopped ore.

SCALE
0 50' 100'

VIEW OF ENTRANCE TUNNEL AND SHAFT

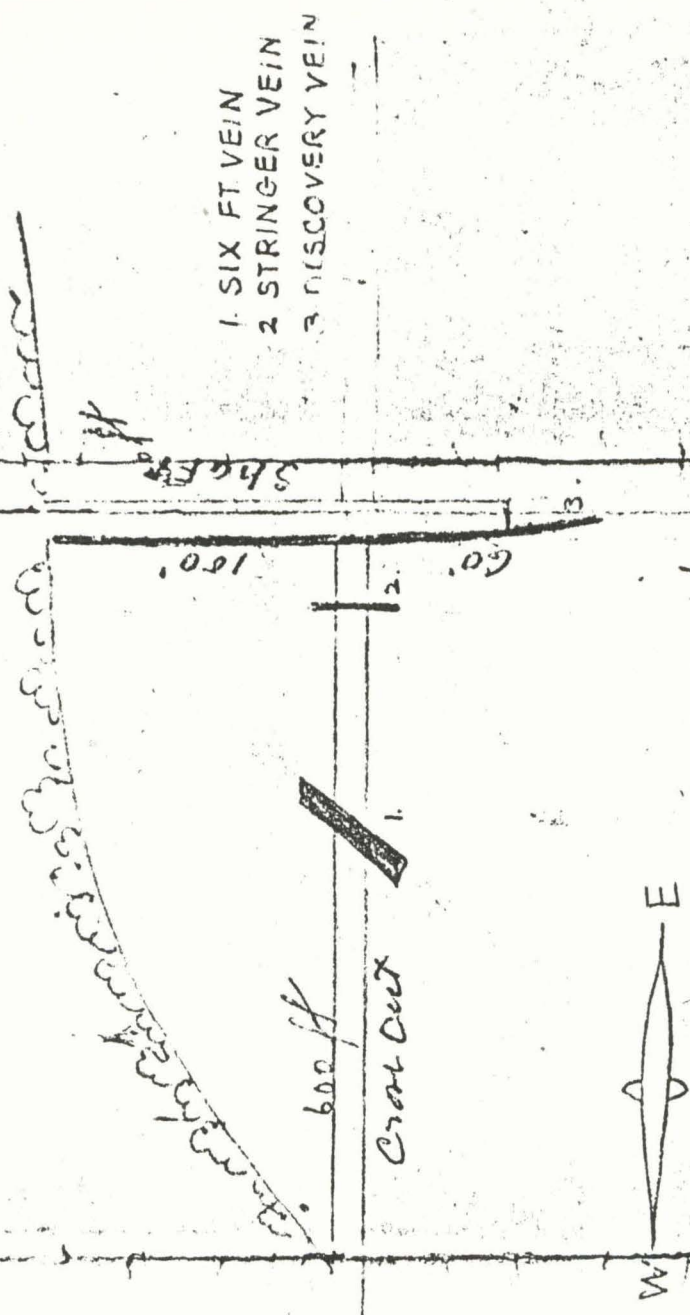

- 1. SIX FT VEIN
- 2. STRINGER VEIN
- 3. DISCOVERY VEIN

MILL HOUSE



Uila, 49 1-A
 Drowsey, 66 6-B
 Dufur, 382 3-E
 Dundee, 232 3-C
 Durkee, 100 4-J

Eagle Point, 211 8-C
 Echo, 311 2-H
 Eddyville, 41 4-B
 Elgin, 728 2-I
 Elkton, 90 6-B
 Elmira, 100 5-B
 Elsie, 68 2-B
 Empire, 493 6-A
 Enterprise, 1,379 3-J
 Estacada, 524 3-D
 Eugene, 18,901 5-C

Falls City, 494 4-B
 Flora, 64 2-J
 Florence, 339 5-A
 Forest Grove, 1,859 2-C
 Fort Klamath, 100 8-D
 Fort Stevens, 160 1-B
 Fossil, 538 3-F
 Foster, 25 2-C
 Freewater, 732 4-H
 Frenchglen, 34 7-H

Gales Creek, 122 2-C
 Gardiner, 300 6-A
 Gardinali, 213 2-B
 Gaston, 227 3-C
 Gearhart, 125 1-B
 Gervais, 254 3-C
 Gladstone, 1,348 3-C
 Glenada, 110 5-A
 Glendale, 516 8-D
 Glenwood, 200 2-B
 Goble, 91 1-C
 Gold Beach, 400 8-A
 Gold Hill, 500 8-C
 Goshen, 93 5-C
 Government Camp, 50 3-D
 Grand Ronde, 350 3-B
 Granite, 50 4-H
 Grants Pass, 4,666 8-B
 Grass Valley, 208 3-F
 Gresham, 1,635 2-D

Haines, 431 4-I
 Halfway, 351 4-J
 Halsey, 300 4-C
 Hamlet, 35 2-B
 Hammond, 244 1-B
 Hardman, 120 3-G
 Harlan, 25 4-B
 Harper, 50 5-J
 Harrisburg, 575 5-C
 Hebo 3-B
 Helix, 193 2-H
 Heppner, 1,190 3-G
 Hermiston, 608 2-G
 Hillsboro, 3,039 2-C
 Homestead 3-J
 Hood River, 2,757 2-E
 Horton, 40 5-B
 Hot Lake, 250 3-I
 Hubbard, 330 3-C
 Huntington, 803 5-J

Imbler, 203 2-I
 Imnaha 2-J
 Independence, 1,248 4-C
 Lone, 283 2-G
 Irrigon, 65 2-G
 Island City, 116 3-I

Jacksonville, 706 8-C
 Jefferson, 391 4-C
 Jewell, 167 2-B
 John Day, 432 4-H
 Jordan Valley, 306 7-J
 Joseph, 504 3-J
 Junction City, 922 5-B
 Juntura, 136 6-I

Kamela, 27 3-H
 Keasey, 50 2-B
 Kent, 94 3-F
 Kerby, 40 9-A
 Kernville, 150 3-B
 Kimberley, 45 4-G
 Kings Valley 4-B
 Kinzua 3-F
 Klamath Agency, 150 8-D
 Klamath Falls, 16,093 9-B
 Knappa, 100 1-B



Fleming Prospect

VIEW OF ENTRANCE TUNNEL
AND SHAFT

- 1. SIX FT VEIN
- 2. STRINGER VEIN
- 3. DISCOVERY VEIN

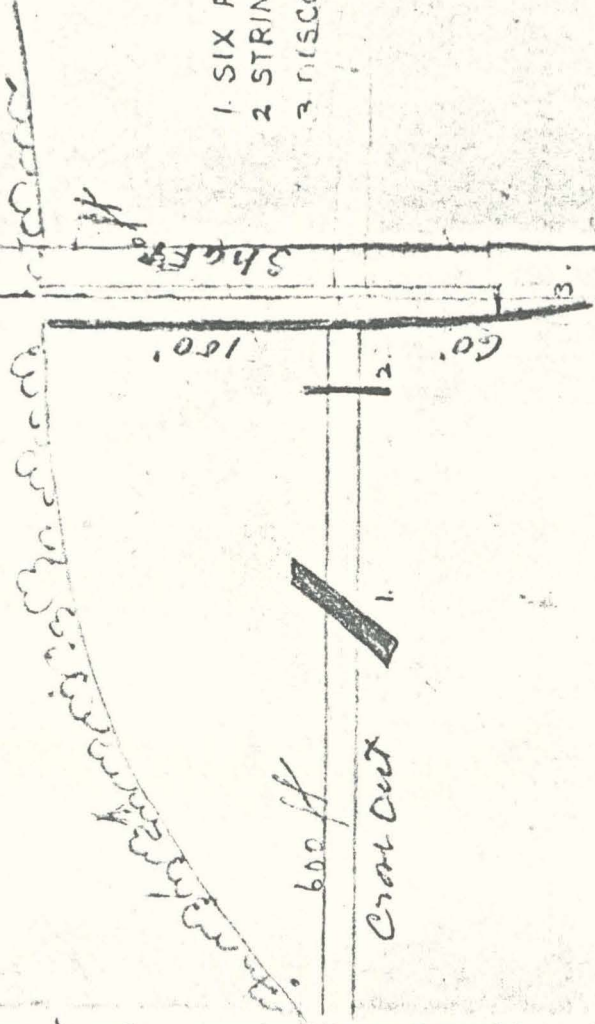

600 ft
Crack Out



MILL HOUSE

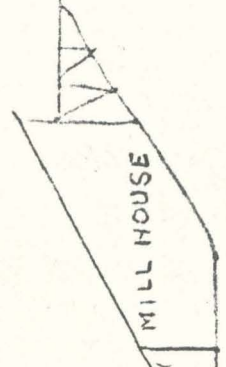

CROSSCUTE ON DISCOVERY VEIN

NW ————— SE

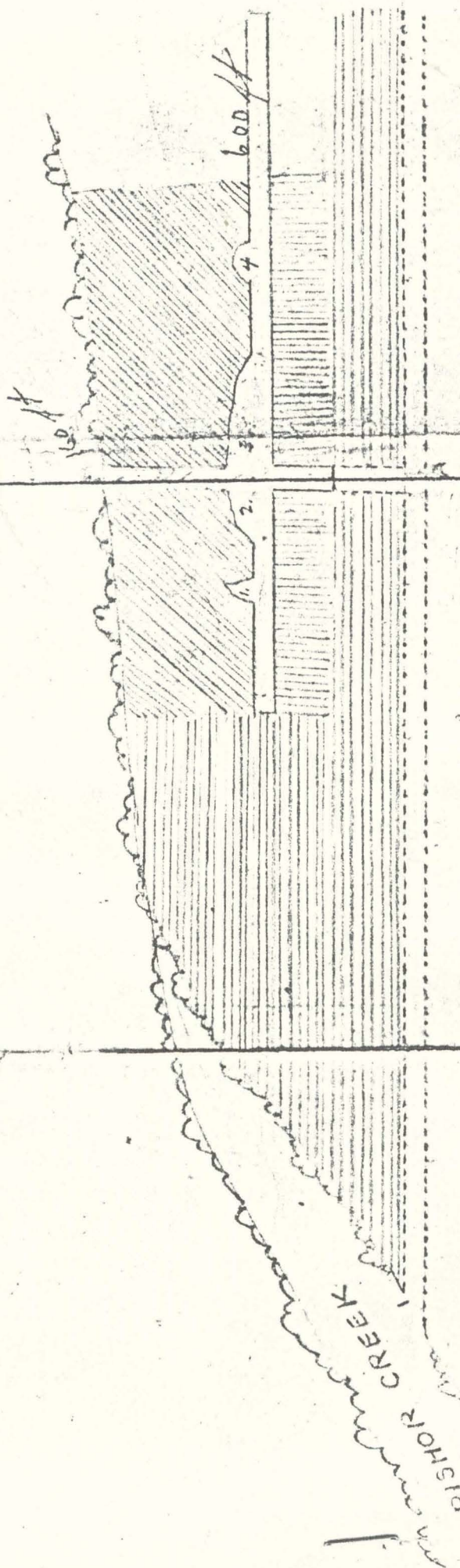

DOTTED LINES INDICATE THE PROPOSED TUNNEL AT THE TWO HUNDRED FOOT LEVEL

- [Hatched pattern] BLOCKED OUT ORE
- [Hatched pattern] BLOCKED OUT ON TWO SIDES
- [Solid shaded] PROBABLE ORE

SCALE
0 50' 100'

1-2-3-4 Stopped ore.

BISHOP CREEK

600 ft