

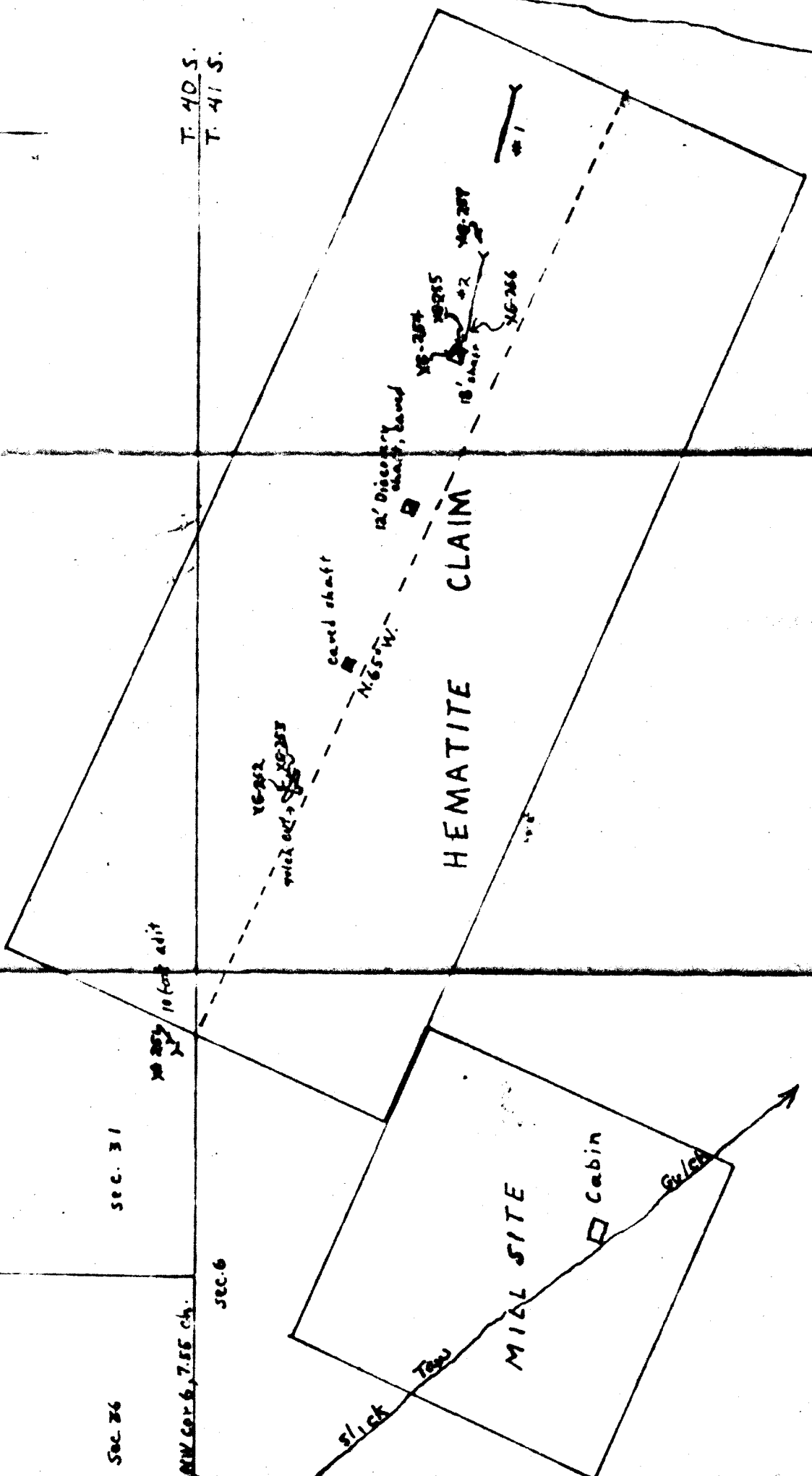

T. 40 S.
T. 41 S.



R. 2 W.
R. 3 W.

Sec. 31

Sec. 26

Sec. 6

10 foot adit

10-252
mick out, 10-253

caved shaft

N 65° W

12' Discovery shaft, sand

10-254
10-255
10-257
10-256

HEMATITE CLAIM

MILL SITE

Cabin

GULCH

690 feet

Map adapted from map by E. W. Lewis, 1934

15

Drift & Vein Chart

9-10-00 L.R.

7 parallel veinlets
3 to 6" thick

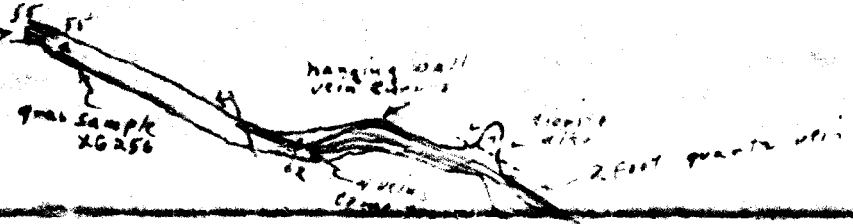

Tunnel # 2

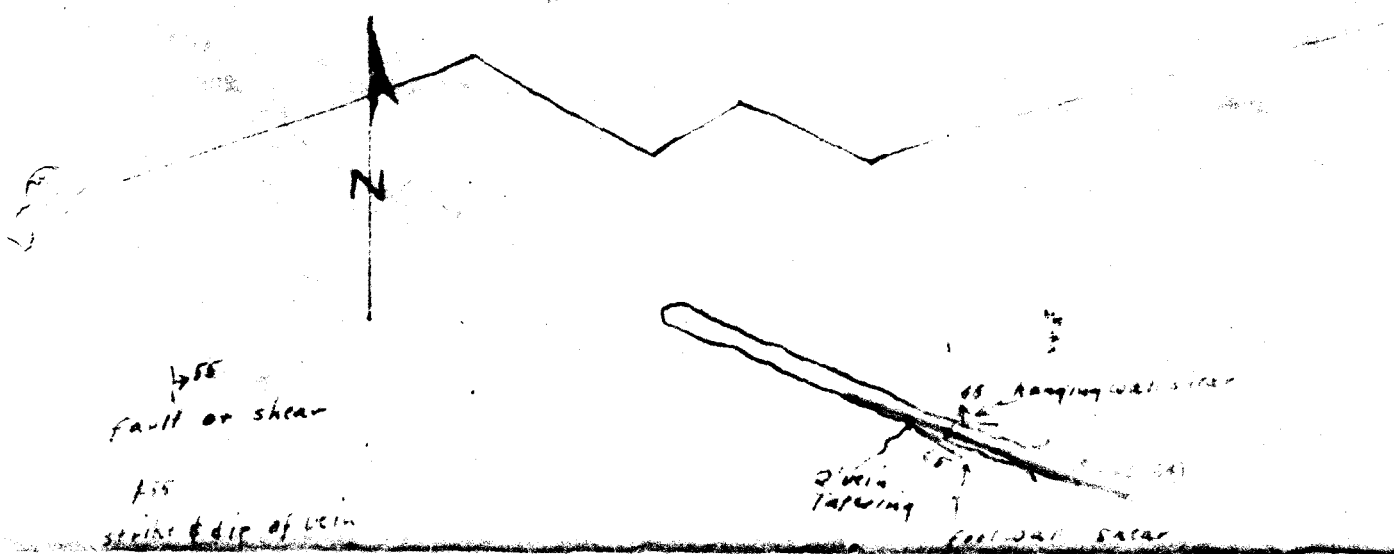

No. 1 Tunnel

Tunnel #1 E end drain
Heratite ledge
L1 = 3360(A)

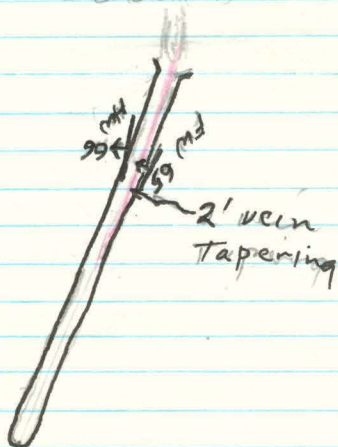

Haskins & Tanager
see Winchell

Tunnel #2 el. 3440 (X)

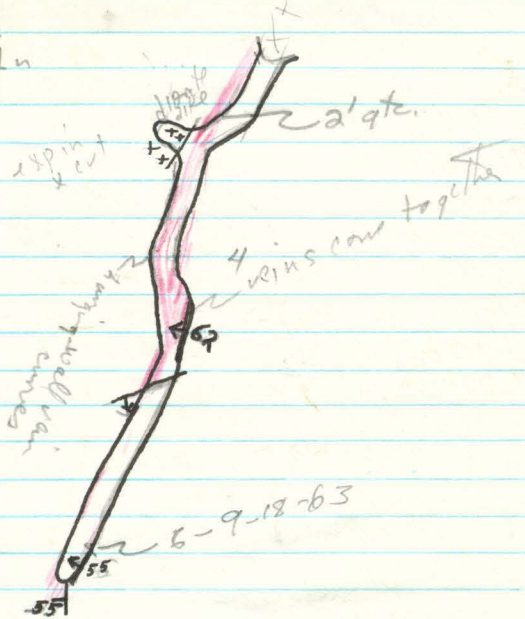
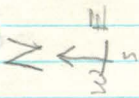

Multiple van
3 to 6 ft thick
7 results proved

1" = 50'

000