

ANTIMONY LODGE
vein should
outcrop here,
at elev. 2570
?

1500'

N 55° W.

1500'

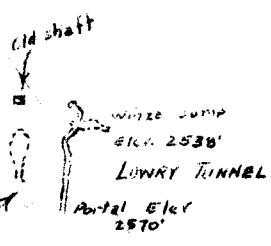

APPLEGATE CLAIM.

LODE

Lower tunnel, winze
full of water. Dip
50° N 35° E. Reported
30' deep, with drifts
on ore NW & SE.

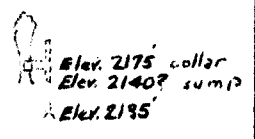

Lowest tunnel, carved,
to drain winze.

ANTIMONY

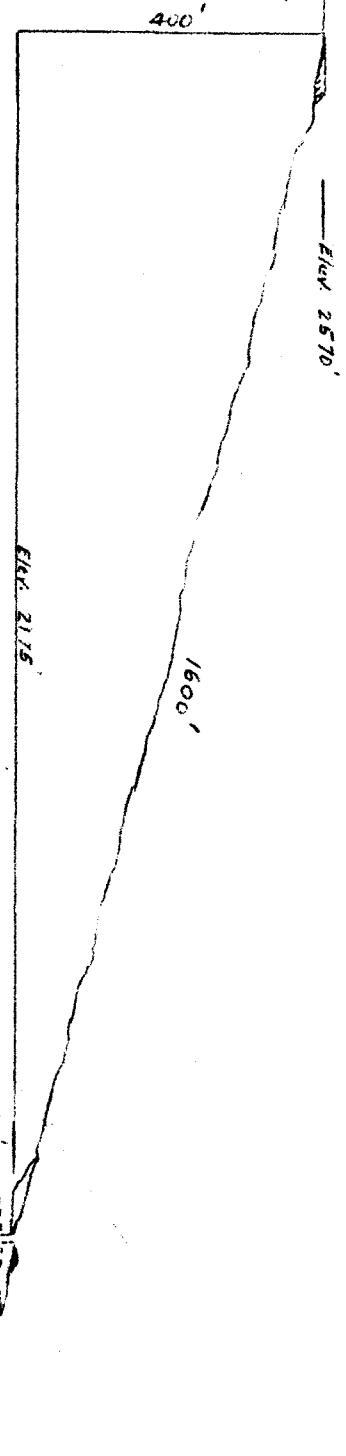

Plan & Elevation of Lowry Stibnite
Claims, NW 1/4 NW 1/4 sec. 25, T. 40S., R. 4W.

Face & Brunton Survey Feb. 12, 1940

Ray C. Teasler

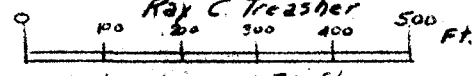

Scale 1 in. = 250 ft.

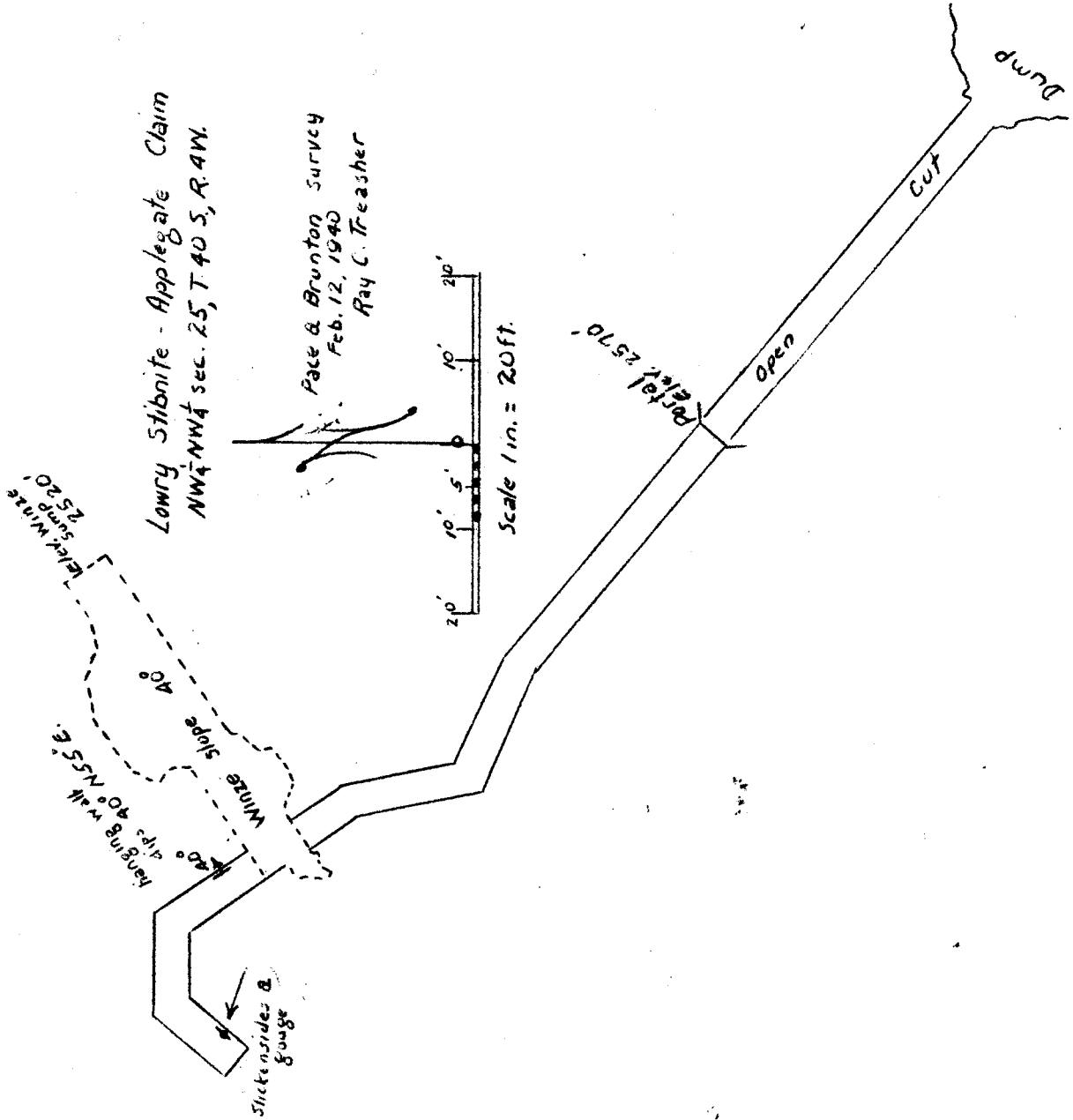

Lowry Stibnite - Applegate Claim
 NW 1/4 NW 1/4 sec. 25, T. 40 S., R. 4 W.

Pace & Brunton Survey
 Feb. 12, 1940
 Ray C. Treasher



Scale 1 in. = 20 ft.

WINGS
 25.20'

WINGS
 40° slope

40° dips
 40° N.S.E.

Stickersides &
 Gauge

portal 2570

Open

Cut

Dump

Lowry Stibnite

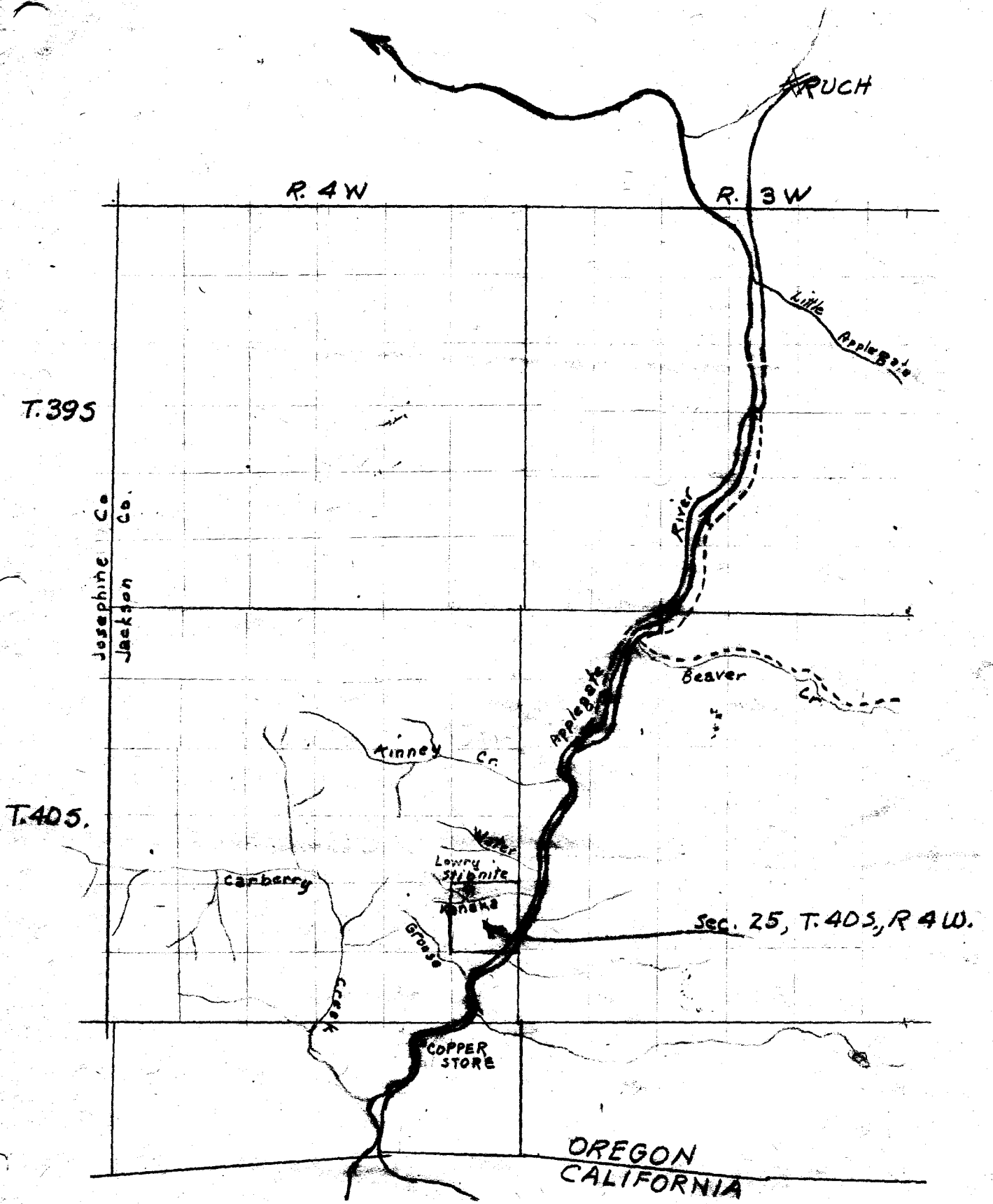

T. 39S

R. 4W

R. 3W

Josephine Co.
Jackson Co.

T. 40S

Tinney Cr.

Carberry

Lowry Stibnite

MINE

Grouse

Creek

COPPER STORE

Sec. 25, T. 40S, R. 4W.

OREGON
CALIFORNIA

Little Applegate

Beaver Cr.

Applegate

River

RUCH

400' 1600'
1 - 4

HOTEL MEDFORD

COMMERCIAL MEN'S HOME
EMIL MOHR, Manager

MEDFORD, OREGON



Plan & Elevation of Lowry stibnite
Claims, NW $\frac{1}{2}$ NW $\frac{1}{2}$ sec 25, T. 40 S., R. 4 W.

Pace & Brunton Survey Feb. 12, 1940

Ray C. Treasher

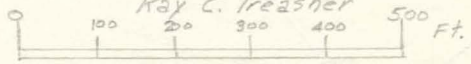

Scale 1 in. = 250 ft.

Gateway to Crater Lake, Diamond Lake and Lake O' the Woods

HOTEL MEDFORD

COMMERCIAL BLDG. HOME

Medford, Oregon

Medford, Oregon

ANTIMONY LOOSE
vein should
outcrop here
at elev. 2570

Old outcrop
tunnel?
Old tunnel, caved
length unknown

Old shaft

Wise sump
elev. 2530
LOWRY TUNNEL
2570

N. 55° W.

APPLEGATE

APPLEGATE CLAIM

LODE

1500'

LODE

Lower tunnel, winze
full of water. Dip
50° N. 35° E. Reported
50' deep, with drifts
on ore NW. & S.E.

Elev. 2175 wooden collar
Elev. 2140
Elev. 2135 portal cut
Lowest tunnel, caved,
to drain winze.

ANTIMONY

ANTIMONY



1250'

Elev. 2350

Elev. 2320

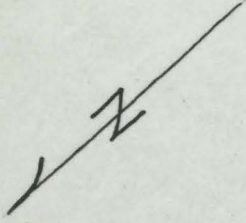
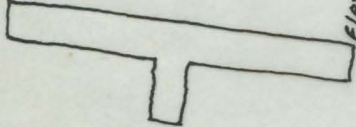

Elev. 2300'

Elevation

Lowry Antimony
sec. 25, T. 40S, R. 4W.

Lower Adit & shaft

Brunton & tape survey R.C.T. 4/28/42.

Scale 1" = 20'

Adit must be extended about 20'
horizontally & raised 14'
to connect with shaft.

Shear zone with silicification
is N. 50° W., dip 60° N.E. Some
stibnite

brecciated quartz 2"
5.70° W.

brecciated quartz 4"
5.80° W.

brecciated quartz 2"
5.60° W.

brecciated quartz 2"
5.35° W.

Elev. 2300'

N. 49° W

Open Cut.

Plan

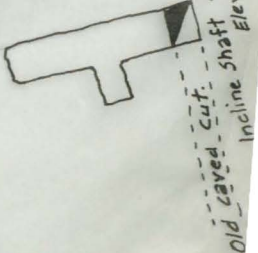

55', 36' deep. in ore

Old caved cut. N. 30° E. dip
Incline Shaft Elev. 2350