

Drain, 477	6-B
Drewsey, 66	3-E
Dunbar, 382	6-1
Dundee, 232	3-C
Durke, 100	4-J
Eagle Point, 211	8-C
Echo, 311	2-H
Eddyville, 41	4-B
Elgin, 728	2-1
Elkton, 90	6-B
Empira, 100	5-B
Empire, 493	2-B
Enterprise, 1,379	3-J
Estacada, 524	3-D
Eugene, 18,901	5-C
Falls City, 494	4-B
Flora, 64	2-J
Florence, 339	5-A
Forest Grove, 1,859	2-C
Fort Klamath, 100	8-D
Fort Stevens, 160	1-B
Fossil, 538	3-F
Foster, 25	4-C
Freewater, 732	2-H
Frenchglen, 34	7-H
Gales Creek, 122	2-C
Gardiner, 300	6-A
Garibaldi, 213	2-B
Gaston, 227	3-C
Gearhart, 125	1-B
Gervais, 254	3-C
Gladstone, 1,348	3-C
Glenada, 110	5-A
Glenade, 516	8-D
Glenwood, 200	2-B
Goble, 91	1-C
Gold Beach, 400	8-A
Gold Hill, 500	8-C
Goshen, 93	5-C
Government Camp, 50	3-D
Grand Ronde, 350	3-B
Granite, 50	4-H
Grants Pass, 4,666	8-B
Grass Valley, 208	3-F
Gresham, 1,635	2-D
Haines, 431	4-1
Halfway, 351	4-J
Halsey, 300	4-C
Hamlet, 35	2-B
Hammond, 244	1-B
Hardman, 120	3-G
Harlan, 25	4-B
Harpur, 50	5-J
Harrisburg, 575	5-C
Hatfield, 193	2-H
Hawthorn, 1,190	3-G
Hermiston, 608	2-G
Hillsboro, 3,039	2-C
Homestead	3-J
Hood River, 2,757	2-E
Horton, 40	5-B
Hot Lake, 250	3-1
Hubbard, 330	3-C
Huntington, 803	5-J
Imbler, 203	2-1
Imnaha	2-J
Independence, 1,248	4-C
Ione, 283	2-G
Irrigon, 65	2-G
Island City, 116	3-1
Jacksonville, 706	8-C
Jefferson, 391	4-C
Jewell, 167	2-B
John Day, 432	4-H
Jordan Valley, 306	7-J
Joseph, 504	3-J
Junction City, 922	5-B
Juntura, 136	6-1
Kamela, 27	3-H
Keasey, 50	2-B
Kent, 94	3-F
Kerby, 40	9-A
Kernville, 150	3-B
Kimberley, 45	4-G
Kings Valley	4-B
Kinzua	3-F
Klamath Agency, 150	8-D
Klamath Falls, 16,093	9-B
Knappa, 100	1-B

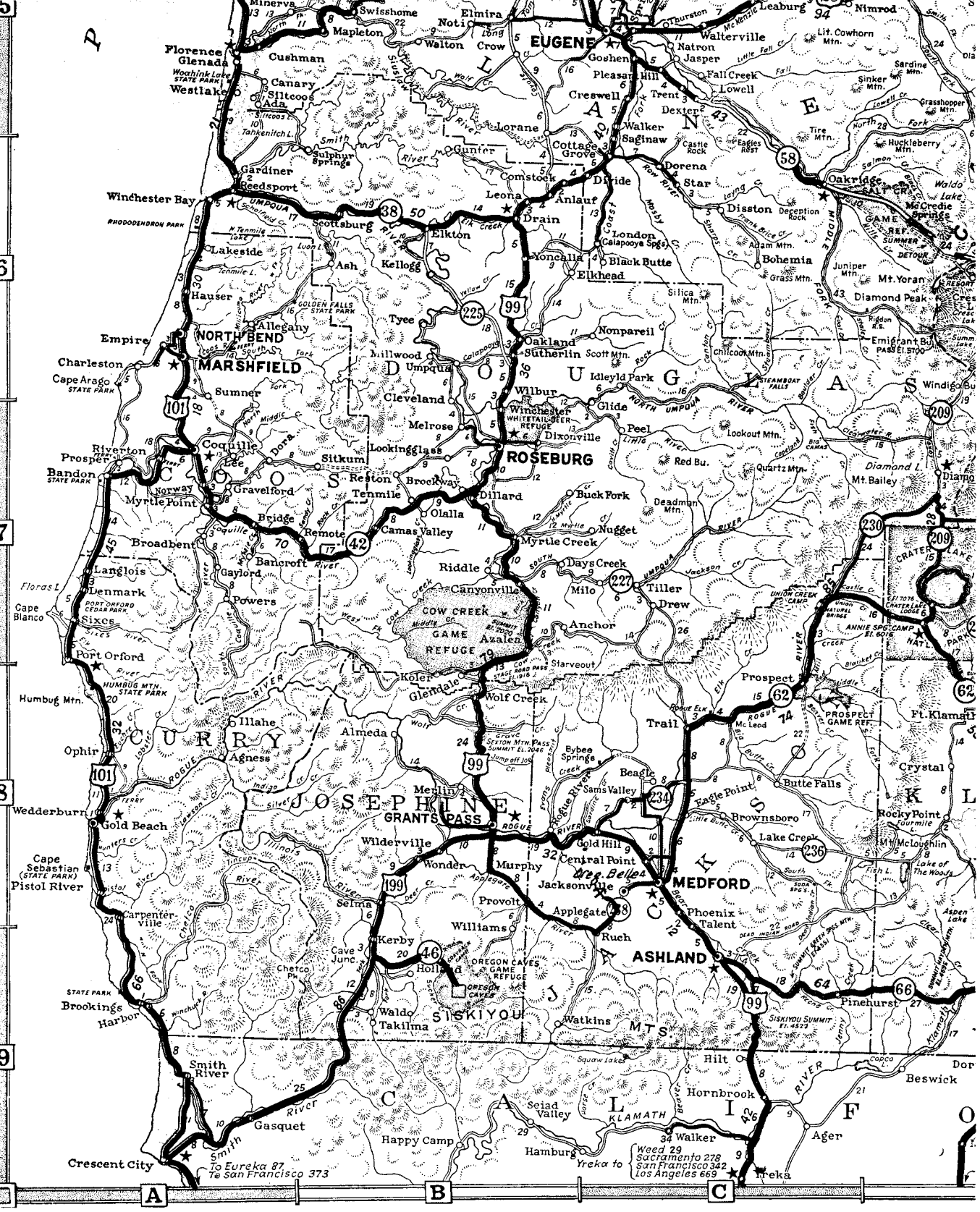

To Eureka 87
To San Francisco 373

Weed 29
Sacramento 278
San Francisco 342
Los Angeles 663

OREGON BELLE

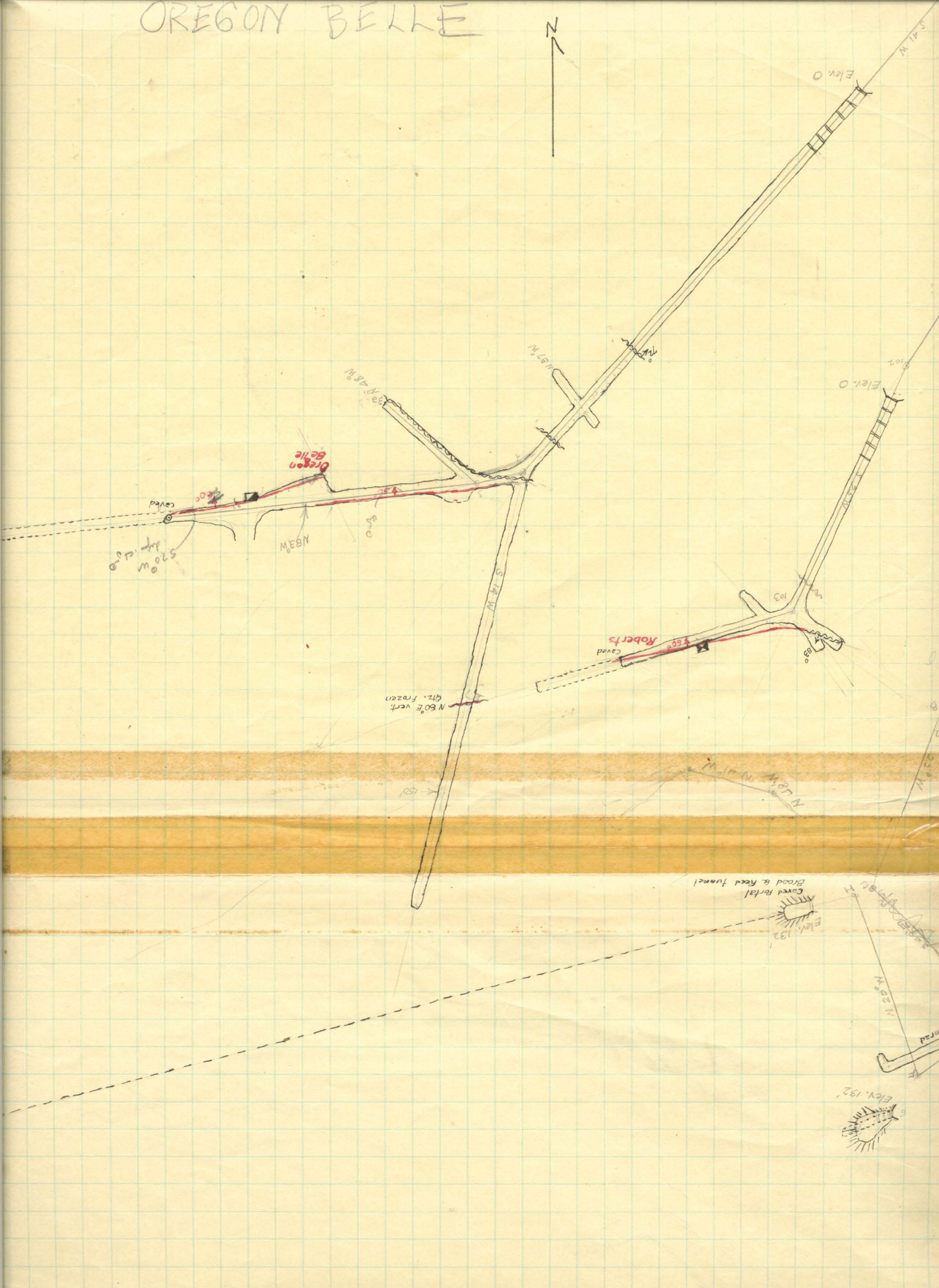
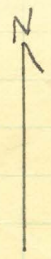

Oregon Belle
600
570 W
N 33 W
500

Roberts
600
Caved

N 60 E vent
Qty. frozen

Covered Portal
Broad & Reed tunnel
Elev. 132

Elev. 132

N 29 W

road

B.L.M. Road Logging

Rt Hand drift crosscut to try for Russell Ledge that was mined in early days -

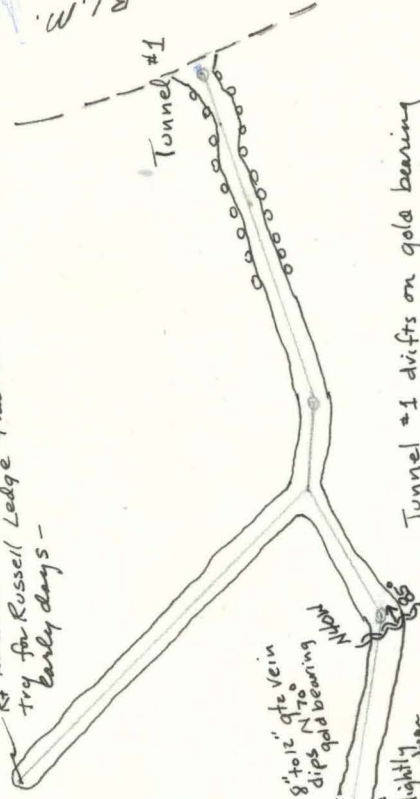

Tunnel #1 drifts on gold bearing vein that pinches + sweels from 1" wide to 1' wide - this vein appears to be at irregular cts of argillite and meta-volcanic (andesite) rock.

Shear up to 2' wide mainly gouge
 of the rock gold porphyritic
 values of gold lowest values are filled barren
 argillite
 andesite

8" to 12" qtz vein dips N 10° E gold bearing
 Argillite
 Altered andesite vein slightly offset by narrow shear

B.L.M. Logging Road

Tunnel #2 Bearing to Tunnel #1 is N68W - 280 both portals are at road level.

8" to 12" qtz vein parallel with edge of drift

argillite
 high grade stringer

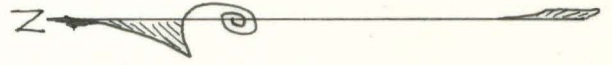

LUCKY STRIKE
 Sec. 6, T. 38S., R. 3W. El. about 3500
 Brunton Compass & TAPE Survey
 Scale - 1" = 20'

JUNE 7, 1966

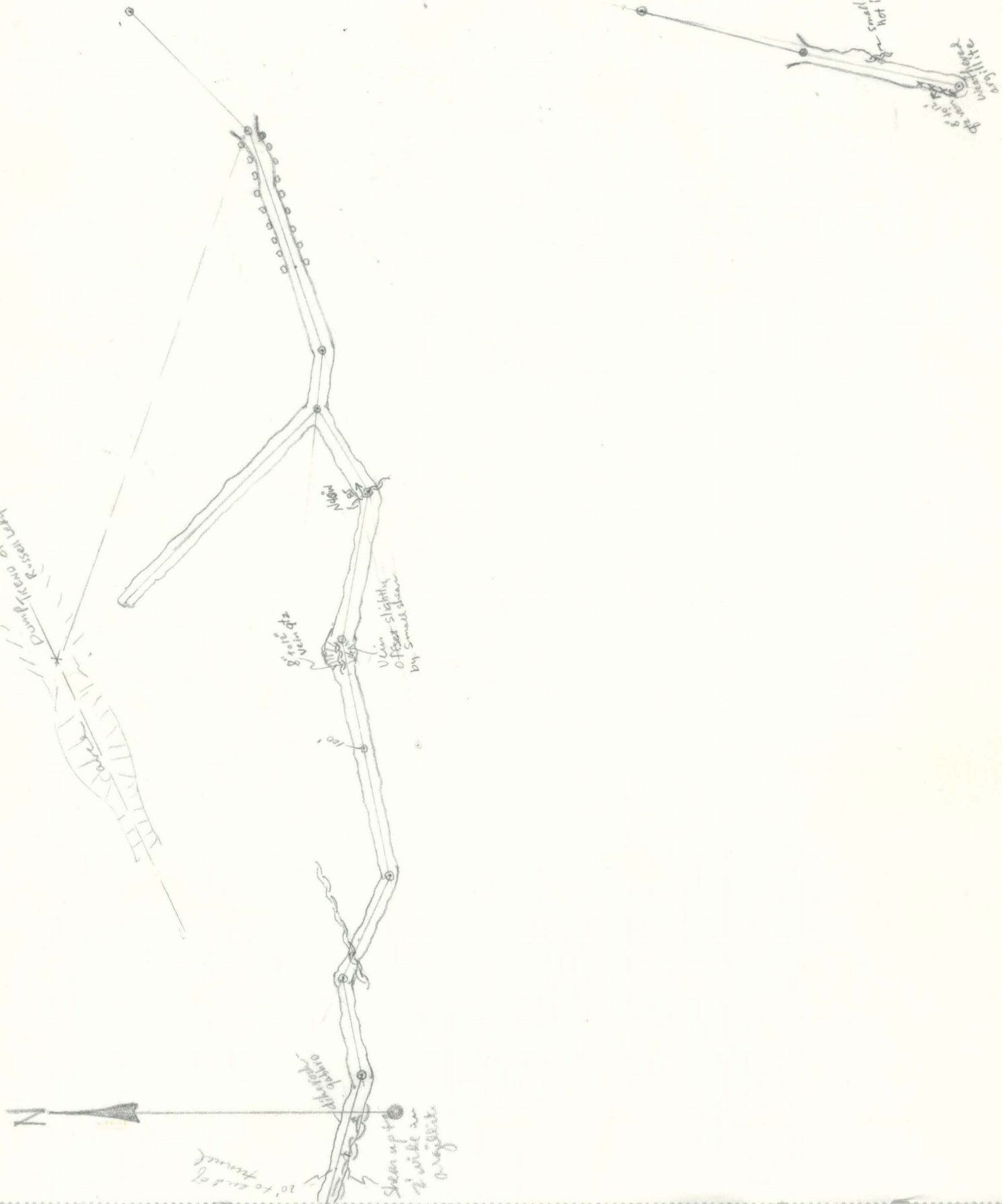

From Notes by RCT
8/14 and 15, 1941

STATION 1
ON
DUMP

OREGON BELLE
Sec. 6, T. 38 S., R. 3 W

Golden King Workings

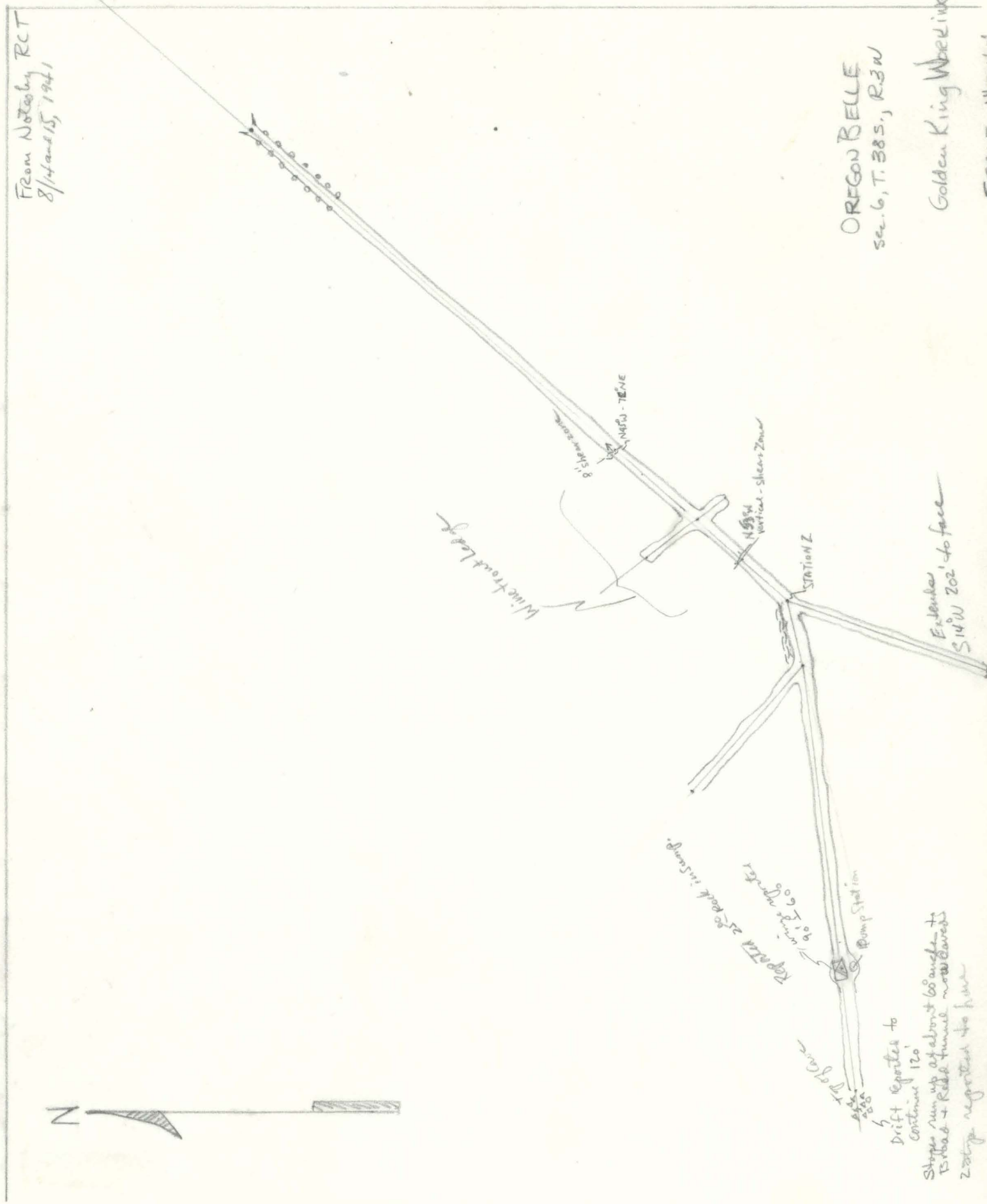

Drift reported to
contain 120'
Shale run up at about 60' angle to
Broad + Rigid tunnel now covered
Zebra reported to have

Extended
S 14 W 202' to face

Reported 25' rock in camp.
90' fine gravel

Pump Station

Drift

STATION 2

N 55 W
Vertical - Shear Zone

8' Shear zone
N 55 W - TENE