

RED FEATHER (quicksilver)

Upper Applegate District

Location: On the north side of Squaw Creek in Sec. 34 and 35, T. 40 S. R 3 W. 35 miles S.W. of Medford, trail 3/4 mile from Squaw Creek.

Owner: D. R. Luper, Jacksonville, Oregon

Area: 5 unpatented quartz claims, running east and west.

Named in order, west to east: Smokey Cabin, Grayback, Red Feather, Ruby and Ruby extension.

On the Ruby claim, a tunnel runs N. 20° W for 250 feet, with another caved tunnel 300 feet to the northeast. On the Red Feather claim there is a 20 foot location cut.

Geology: The cinnabar is said to occur along the contact between granite on the north and serpentine and schist on the south, the strike of the contact being about S. 80° W, with a steep dip to the north. The cut on the Red Feather claim shows the contact to strike N. 48° E., dip 73° N. The tunnel on the Ruby claim runs through schist but is said to strike 3 feet of serpentine at 150 feet, which carries ore. A winze said to be fifty feet deep runs down the vein at the Ruby location cut. A sample ran 4.5 pounds of quicksilver.

Informant: J. E. Morrison, 38

Red Feather. Mercury.

near Squaw Lake
owned by. D R Loper Jacksonville

Quick silver pp 127

877-810
1 - TV
2 - #1.5# per ton

No 2 Sample about 7 ft of vein material.
on it side of shaft tunnel on Ruby.
Loc. Cut.
Ruby runs 750 each way from loc cut.

Super

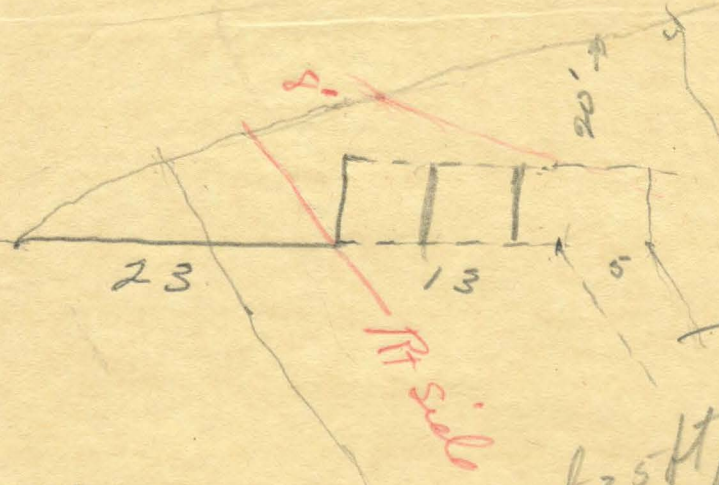

7/26/38

cannot said
to be better than
50 ft deep.
about 3.5 ft vein
material.
Walls not distinct
hanging wall
not reached.

The contact between granite & Super
has about 580° W judging by granite
out cropping & the location of the working
however (judging) observation do not bear
this fact out. I believe the best way to
open this property is to continue tunnel
till it cuts contact with granite.

£ of tunnels. 580 W. -

	750	1500	1500	1500	1500
W	Smoking Cabin 7 ac.	Grayback	Red Feather	Ruby	E Ruby Ex.

D. R. Super - Star Route Jacksonville.

3.5 south of Medford. north of Squaw Cr.

1/2 mile from Squaw lake west. El. 2500 ft.

Cinnabar Property. Plenty timber

Very little water - Domestic use only

No equipment. 3/4 mile trail from
road on Squaw creek to cabin.

90 acres held by location.

Super

Loc. Cut. Red Feather claim. NE 125 ft, SW 137

N - 22 ft. 11 ft face.

T 40 S R 3 W

cuts. contact between. Decomposed granite hanging and serpentine foot wall.

Contact S 48 W and dips 73° to North.

on it wall with material? 2 ft wide

" left " " " " " " "

Sample no 1 taken along left side of cut 7 1/2 ft. (cut strikes vein at angle) a 12 lb sample was quartered. 1/4 taken for assay.

Some cinnamon visible with glass. white material (lime) + yellow material (iron) show in vein deposited by water in cracks.

Ruby claim east ext of R. 7.

Has a tunnel N 20 W caved at 175 ft in 250 ft to face at a point 150 ft? cut a 3 ft serpentine - carry crinoid. Tunnel in schist strikes EW? dip about 25° N? very hard to get accurate.