

# Field Notes



9-15-60

With Carl Stevens & Bill White  
To Copper Eagle Mine

(2890 A elev.)

Drift ~~At~~ trends  $N 5^{\circ} W$ . The curved  
vein strikes  $N 65^{\circ} E$ , dips 50'  
vein 20" wide 15' beyond will  
sinking on 3' sill, down  
5 feet below sill.  
Same attitude in face <sup>of drift. vein</sup> & pinched  
down to 3 to 6" (fisher vein in  
shear).

~~low, rock right pocket far to~~

55 ft from face to window;

105 <sup>feet</sup> from face, <sup>tunnel</sup> ~~the~~ curves

left & toward portal ( $5.50^{\circ}$ )

Point ~~is~~ <sup>feet</sup> 130 from face ~~timbered~~  
directly under face of cap  
out.

Timbered out to 160 <sup>feet</sup> from  
(trends  $55^{\circ} E$ ).

Seven <sup>sets</sup> in at face out above  
drift, ~~two~~ 2 shears <sup>striking</sup> west. O.  
Contains quartz vein about 6-8  
thick. Fe-stained (quartz)

surface cut goes <sup>north</sup> along  
 vein for about 175'  
 To top ridge. ~~top~~

Rock highly jointed & sheared

Rogue formation, meta sedts

S 30° W & 40+ ft lower - is caved in

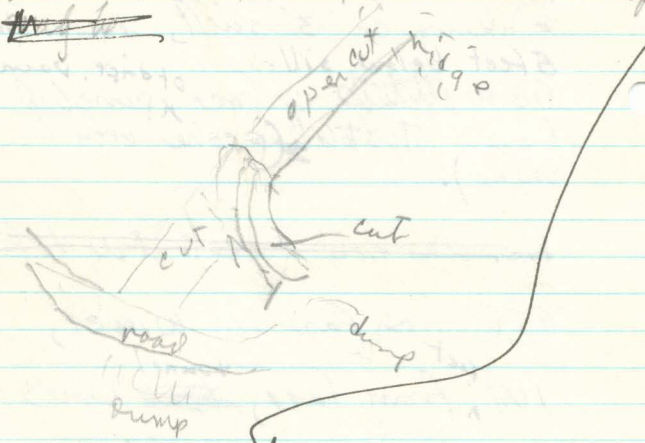

Down to  
~~level~~ el = 2875.

Location notice on this  
 intermediate drift located  
 by Edward R. Cross & John  
 Schilling March 13, 1935

witness F. K. Vincent

Name of claim is Puteley. Trends  
 N. 45° E. bounded on NE by  
 Beth Copper-quartz claim

↑ NE corner of Dutchy claim

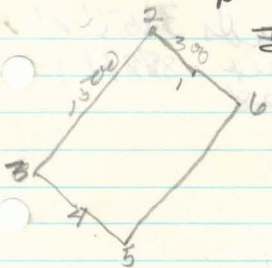

① is 1580' south and 180' west of sec cor common to 22-21-27-28 T. 34S, R. 8W. ~~H. 11~~

fresh phyllitic greenish sandstone drift may be 200' long judging from <sup>size of</sup> ~~entire~~

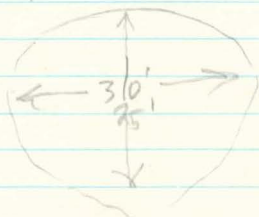

30  
3  
90 100 cu  

---

900 cu ft  
450  
90  

---

1350

20  
30  

---

6000 / 220  
540  

---

10

(2820A) Lower Tunnel I saved at portal but open inside in good shape

heads in N45° E for about

260'. Right hand drill 100' curves hits fault <sup>trending</sup> N30° dipping 20° NW.

~~little~~ no ore seen in lower tunnel.

2033 First Street  
Baker, Oregon

STATE DEPARTMENT OF GEOLOGY AND MINERAL INDUSTRIES  
1069 State Office Building  
Portland 1, Oregon

239 S.E. "H" Street  
Grants Pass, Oregon

REQUEST FOR SAMPLE INFORMATION

The State law governing analysis of samples by the State assay laboratory is given on the back of this blank. Please supply the information requested herein fully and submit this blank filled out along with the samples.

Your name in full Len Ramp (DOGAMI)

Street or P.O. Box P.O. Box 417 City & State Grants Pass, Oregon

Are you a citizen of Oregon? \_\_\_\_\_ Date on which sample is sent \_\_\_\_\_

Name (or names) of owners of the property Harry Connors

Are you hiring labor? \_\_\_\_\_ Are you milling or shipping ore? \_\_\_\_\_

Name of claim sample obtained from Copper Eagle (Brass Ledge)

Location of property or source of sample (If legal description is not known, give location with reference to known geographical point.)

County Josephine Mining District Galice

Township 34 S Range 8 W Section 28 Quarter section NE4

How far from passable road? 1/2 mile Name of road Peavine Rd.

Channel (length) Grab Assay for Description

Sample no. 1 6" Au, Ag Face upper drift

Sample no. 2 55 inch Au, Ag, Cu Winze 55 feet from face - upper drift

(Samples for assay should be at least 1 pound in weight)

(Signed) Len Ramp

DO NOT WRITE BELOW THIS LINE - FOR OFFICE USE ONLY - USE OTHER SIDE IF DESIRED

Sample Description #1 - Sheared weathered greenstone with fractured iron-stained quartz.

#2 - Fractured vein quartz with some chalcopyrite.

Sample number	GOLD		SILVER		COPPER			
	oz./T.	Value	oz./T.	Value	Cu			
UG-243 P-25723	Nil	---	Nil	---	---	---	---	---
UG-244 P-25724	Trace	---	Nil	---	1.60%	---	---	---

Report issued \_\_\_\_\_ Card filed \_\_\_\_\_ Report mailed 9-29-60 Called for \_\_\_\_\_

MAR 16 1939

Galice District  
Josephine County

Name: The Brass Ledge Quartz Claim (gold)  
Owner: Western Metal Mines Company  
Mr. J. J. Seidel, as agent.

This property was formerly known as the Copper Eagle Mine described in the Handbook on Page 72. Also see inclosed sketch of property.

Location: Sec. 22 and 27, T. 34 S., R. 8 W.

Area: The property now consists of one claim instead of 3 as shown on sketch.

Informant: J. E. Morrison, March 9, 1939. Sketch furnished by Mr. P.B. Wickham and was made about 1920.

PROFILE SECTION  
COPPER EAGLE MINE

SCALE 1 inch = 80 Feet

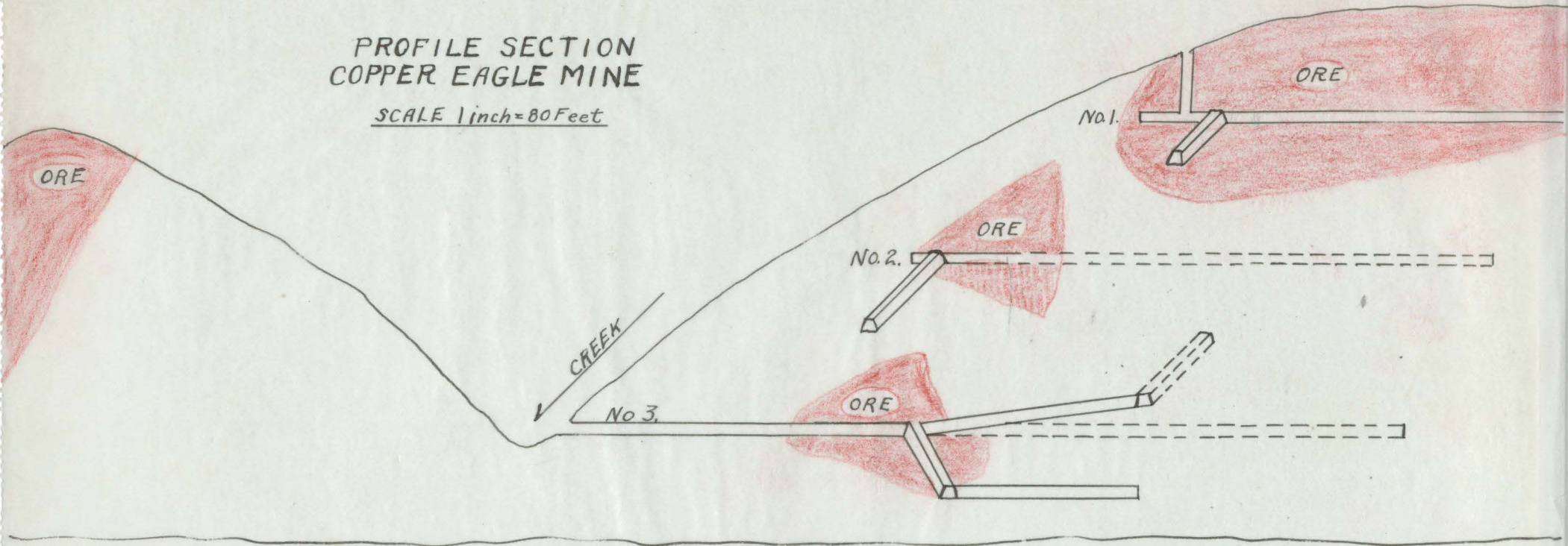

COPPER EAGLE GROUP  
3 CLAIMS

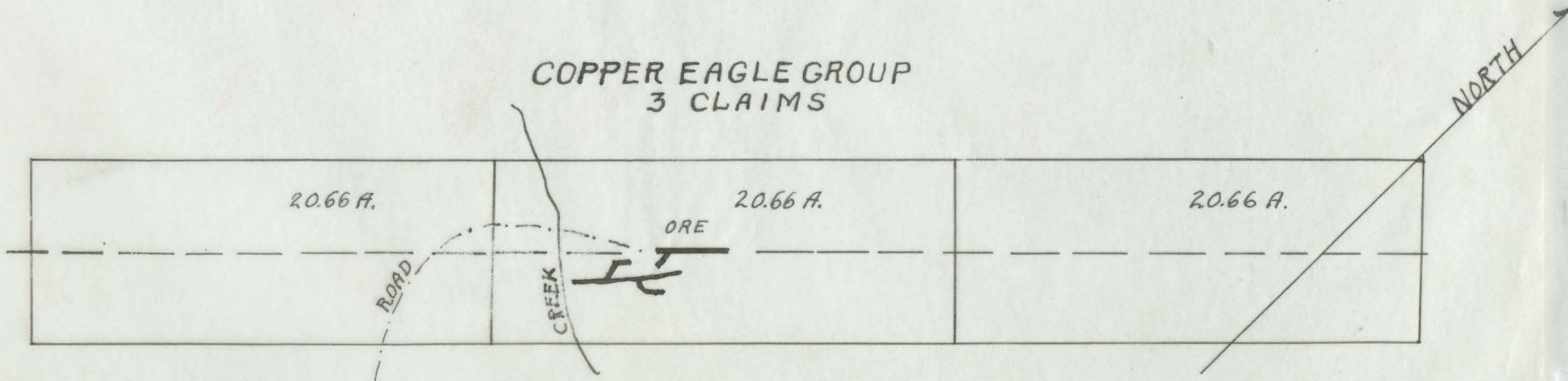

RECORD IDENTIFICATION

RECORD NO..... M060739  
RECORD TYPE..... X1M  
COUNTRY/ORGANIZATION. USGS  
DEPOSIT NO..... DDGMI 100-89  
MAP CODE NO. OF REC..

REPORTER

NAME..... JOHNSON, MAUREEN G.  
UPDATED..... 81 01  
BY..... SMITH, ROSCOE M.  
FERN, MARK L. (BROOKS, HOWARD C.)  
FERN, MARK L. (BROOKS, HOWARD C.)

NAME AND LOCATION

DEPOSIT NAME..... BRASS LEDGE QUARTZ CLAIM  
SYNONYM NAME..... COPPER EAGLE

MINING DISTRICT/AREA/SUBDIST. GALICE

COUNTRY CODE..... US  
COUNTRY NAME: UNITED STATES

STATE CODE..... OR  
STATE NAME: OREGON

COUNTY..... JOSEPHINE  
DRAINAGE AREA..... 17100310 PACIFIC NORTHWEST  
PHYSIOGRAPHIC PROV..... 13 KLAMATH MOUNTAINS  
LAND CLASSIFICATION..... 41

QUAD SCALE QUAD NO OR NAME  
1: 62500 GALICE

LATITUDE LONGITUDE  
42-35-27N 123-38-30W

UTM NORTHING UTM EASTING UTM ZONE NO  
4715353.0 447350.3 +10

TWP..... 34S  
RANGE..... 08W  
SECTION.. 22 27 28  
MERIDIAN. W.M.

COMMODITY INFORMATION

COMMODITIES PRESENT..... AU CU AG AG

OCCURRENCE(S) OR POTENTIAL PRODUCT(S):  
POTENTIAL.....  
OCCURRENCE..... AG

ORE MATERIALS (MINERALS, ROCKS, ETC.):  
QUARTZ, CHALCOPYRITE

ANALYTICAL DATA (GENERAL)  
VEIN IS SAID TO RUN 4-5% CU & \$2.00 AU CIRCA 1916

EXPLORATION AND DEVELOPMENT  
STATUS OF EXPLOR. OR DEV. 4  
PRESENT/LAST OWNER..... STEVE MC TIMMONDS, GRANTS PASS OREGON (1975)

#### DESCRIPTION OF DEPOSIT

DEPOSIT TYPES:  
FISSURE VEIN?  
FORM/SHAPE OF DEPOSIT: WELL DEFINED

SIZE/DIRECTIONAL DATA  
SIZE OF DEPOSIT..... SMALL  
MAX LENGTH..... 400 FT  
MAX WIDTH..... 30 IN

#### DESCRIPTION OF WORKINGS

COMMENTS (DESCRIP. OF WORKINGS):  
ADIT

PRODUCTION  
YES  
SMALL PRODUCTION

#### CUMULATIVE PRODUCTION (ORE, COMMOD., CONC., OVERBUR.)

ITEM	ACC	AMOUNT	THOUS. UNITS	YEAR	GRADE, REMARKS
15 CU		SMALL		1916, 1959, 75	TOTAL OF SIX CARLOADS
23 CU, EST					4-5 CU, 0.1 AU

#### GEOLOGY AND MINERALOGY

AGE OF HOST ROCKS..... PRE-JUR  
HOST ROCK TYPES..... AMPHIBOLITE

LOCAL GEOLOGY  
NAMES/AGE OF FORMATIONS, UNITS, OR ROCK TYPES



NE 1/4 sec. 28, T34S R8W  
 Brass Ledge Soil Samples

September 7-9, 1971

Don Biggs, Roman Street

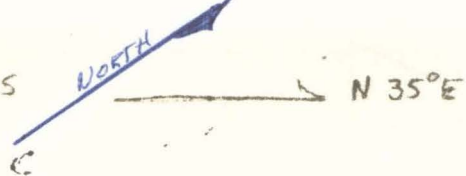

ppm Cu

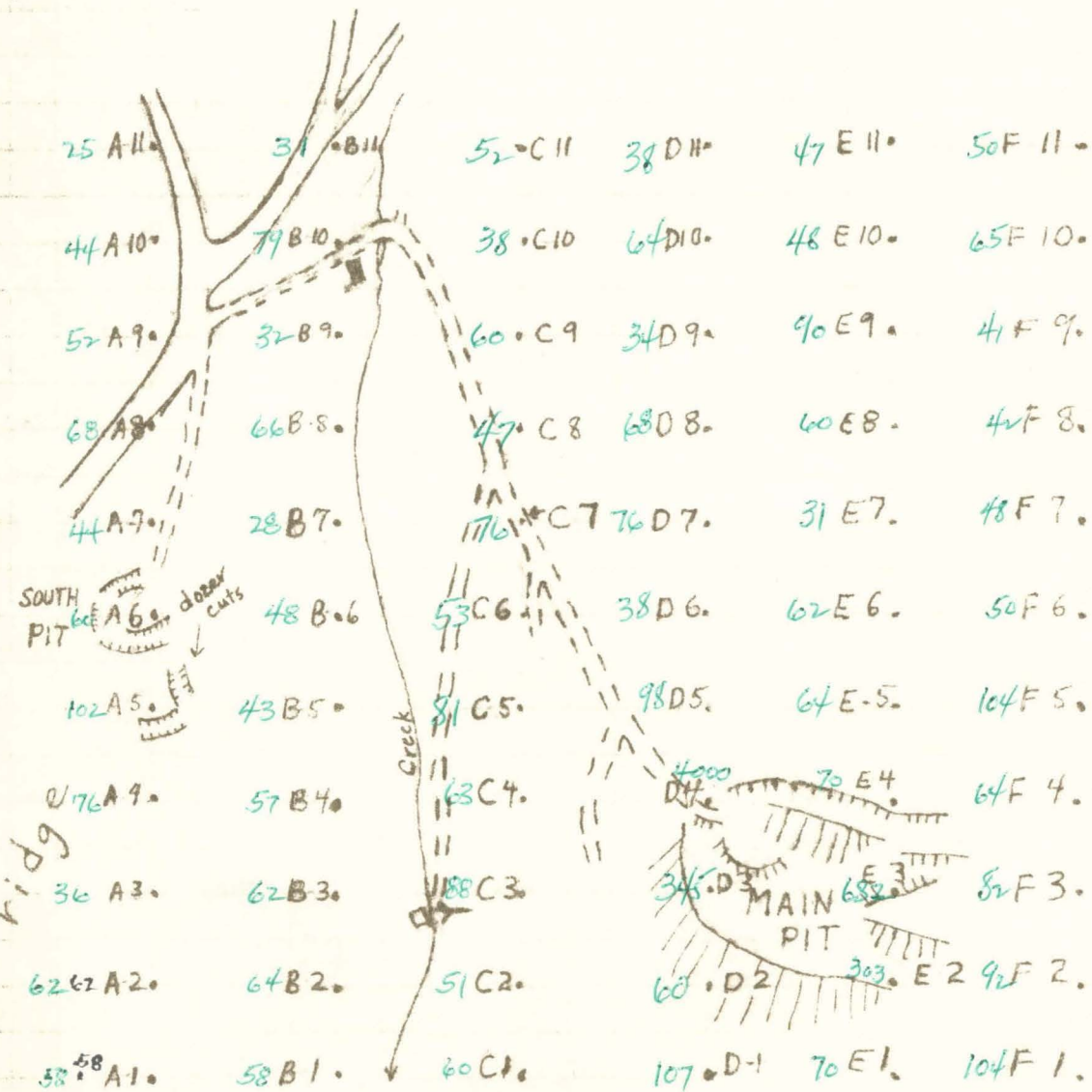

Cu, Ni Analysis  
Brass Ledge Soil Samples

Sample #	Ppm Cu	Ppm Ni	Sample #	Ppm Cu	Ppm Ni
A1	58	150	C2	51	16
A2	62	132	C3	88	30
A3	36	148	C4	63	82
A4	76	146	C5	81	160
A5	102	76	C6	53	122
A6	60	25	C7	76	86
A7	44	40	C8	47	64
A8	68	140	C9	60	54
A9	52	110	C10	38	360
A10	44	192	C11	52	120
A11	25	60	D1	107	99
B1	58	76	D2	60	82
B2	64	144	D3	345	37
B3	62	170	D4	4000	47
B4	57	114	D5	98	94
B5	43	33	D6	38	114
B6	48	23	D7	76	132
B7	28	41	D8	68	61
B8	66	70	D9	34	30
B9	32	122	D10	64	67
B10	79	150	D11	38	890
B11	31	112	E1	70	82
C1	60	56	E2	303	49

Cu, Ni Analysis  
Brass Ledge Soil Samples  
Page 2

Sample #	Ppm Cu	Ppm Ni
E3	682	47
E4	70	18
E5	64	31
E6	62	65
E7	31	107
E8	60	88
E9	90	65
E10	48	23
E11	47	24
F1	104	80
F2	92	45
F3	82	26
F4	64	26
F5	104	53
F6	50	25
F7	48	68
F8	42	76
F9	41	86
F10	65	43
F11	50	36

# State Department of Geology and Mineral Industries

1069 State Office Building  
Portland 1, Oregon

Supplemental information Brass Ledge Copper Mine

Galice District  
Josephine County

Mining News of Southwestern Oregon  
from Sept. 1960 Ore-Bin, page 117

"Harry Commers of Grants Pass shipped 2 carloads of copper-bearing vein quartz from the Copper Eagle (Brass Ledge) mine in the Galice district, Josephine County, to the Tacoma smelter. The shipments were made during October."

Harry Commers reported the total shipment to be about 91 tons. The grade reportedly averaged 5.9 percent copper. Most of the material shipped came from the open cut lying above the upper tunnel.

The mine which is located near the east edge of the NE $\frac{1}{4}$  of sec. 28, T. 34 S., R. 8 W., was visited 9/15/60. Two miners were working in a shallow winze or underhand stope in the upper tunnel (about 3200 level). At this point the N. 65° E.-striking and 50° SE-dipping vein is about 3 feet wide. The winze or underhand stope was about 5 feet below the sill. At the face, 55 feet beyond the winze, the vein is 3-6 inches wide. It occurs in a narrow shear zone in the altered rock (sandstone?). Total length of the upper tunnel is about 150 feet. *metrol?*

An open cut above the tunnel extends north along the vein for a distance of about 175 feet to the crest of a small ridge.

The intermediate level is completely closed by caving at the portal. It is southwest of and about 40 feet lower than the upper tunnel. Judging from the size of the dump the intermediate level may contain 200-300 feet of workings. Rocks found on the dump include fresh phyllitic greenstone

- 2 -

and quartz with some pyrite and chalcopyrite.

The lower tunnel is alongside the creek about 55 feet below the intermediate level. The portal is caved but the tunnel is open and in good condition inside. It contains about 375 feet of workings. There is very little evidence of mineralization and no ore was seen in the lower tunnel.

A sample (UG-244, P-25724) cut across the vein at the winze in the upper tunnel assayed Trace gold, Nil silver and 1.60 percent copper.

Informant: Harry Commers.

Report by: Len Ramp 2/9/61.

\* \* \* \* \*