

Lower adit el. 2000' @
 Trends about N 20° W
 gtz vein 10' thick strikes about
 N 20-30° W dips 25° NE cut
 off in adit by fault

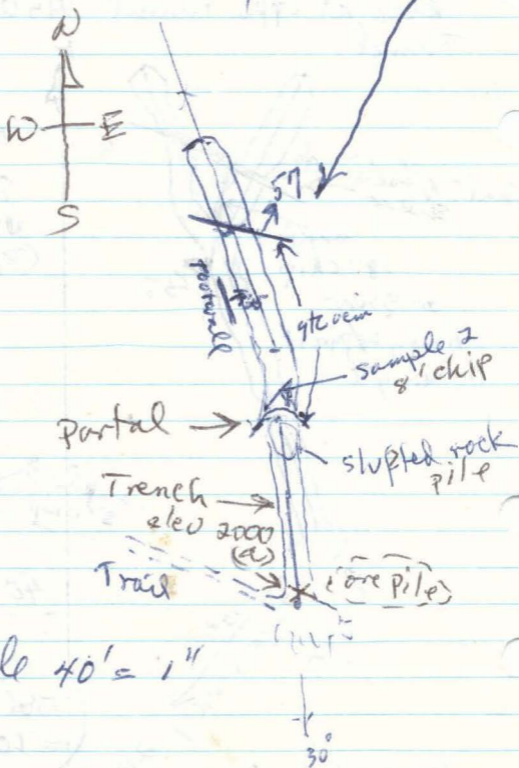

scale 40' = 1"

S. edge sec 13
 or in N. edge sec 24?

8-21-81

Mi at sawmill Gap = 23.8
Turn off Montgomery Hwy rd 25.88
Park at 1st switchback 24.53
hike down to upper tunnel
elev at upper tunnel 2150
Tunnel

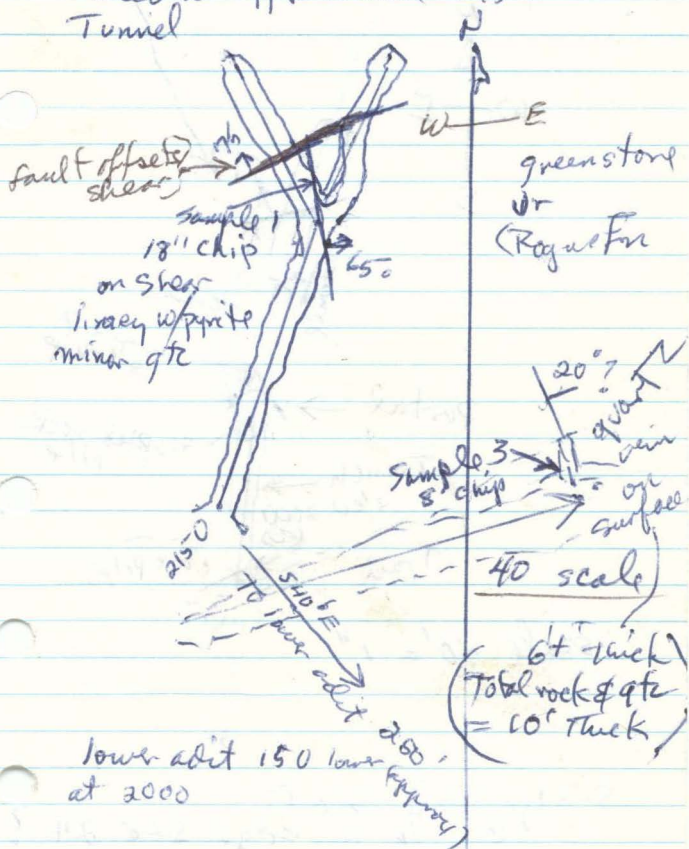

STATE OF OREGON
DEPARTMENT OF GEOLOGY AND MINERAL INDUSTRIES
Project Sample Record

APG-17, 18, &-19

Project 51-300

SAMPLES SUBMITTED BY: LEN RAMP

Date: August 24, 1981

Baker
 Grants Pass

Sample No.	Mine or Prospect	Type	District	S.	T.	R.	Assay for
APG-17	Montgomery	18-in chip	Mt. Reuben	S/SE 13,	33 S.,	8 W.	Au, Ag
APG-18	Montgomery	8-ft chip	Mt. Reuben	13-24	33 S.,	8 W.	Au, Ag
APG-19	Montgomery	8-ft chip	Mt. Reuben	S/SE 13	33 S.,	8 W.	Au, Ag

Descriptions:

- APG-17 Sheared greenstone with disseminated pyrite lime seams and minor quartz veinlets from sill left branch near Y of No. 1 adit, 2,150 ft (alt).
- APG-18 Fractured iron-stained vein quartz from back No. 2 adit near portal
- APG-19 Fractured vein quartz exposed on trail 25 ft east of No. 1 adit. Sample includes some sheared greenstone.

Results:

<u>IP</u>	<u>APG-</u>	<u>Au oz/ton</u>	<u>Ag oz/ton</u>
40113-1	17	0.36	0.17
-2	18	0.08	< 0.2
-3	19	0.08	< 0.2

*Copy mailed to
Lay Yokum
1/25/82 1/26/82*