

MAP SHOWING LOCATION OF FERRO AND ALLOY GROUP OF CLAIMS, EIGHT DOLLAR MTN. AREA, JOSEPHINE CO., OREGON

T 38 S. R 8 W.

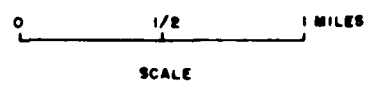

JULY 1953

H.T.S. & P.H.B.

Sample No. % Ni

15614 0.62

15615 0.57

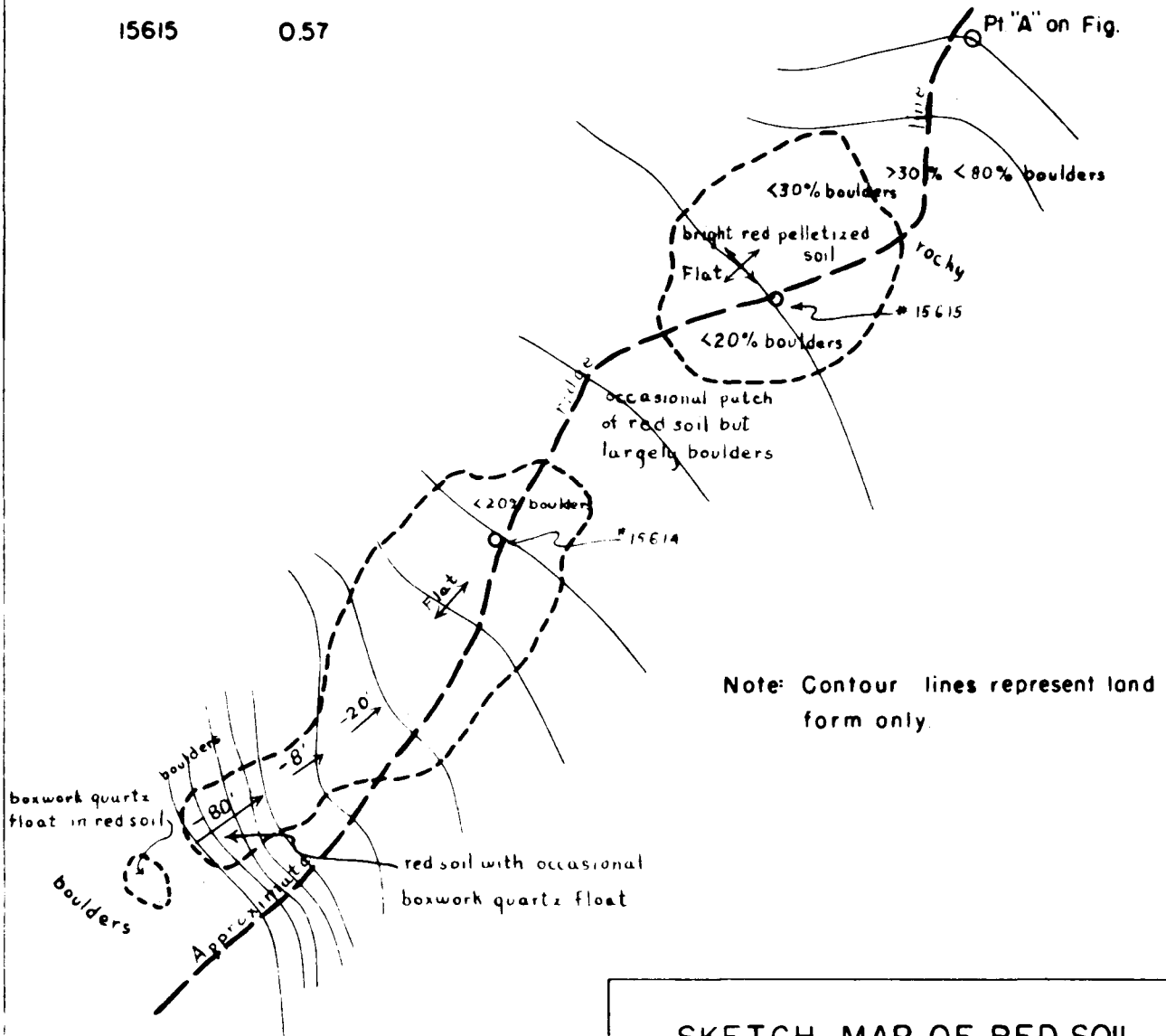

Note: Contour lines represent land form only.

SKETCH MAP OF RED SOIL
AREAS, NORTH PORTION OF
ROUGH AND READY MT.

JOSEPHINE CO, OREGON

0 500 1000 2000 Feet
Scale

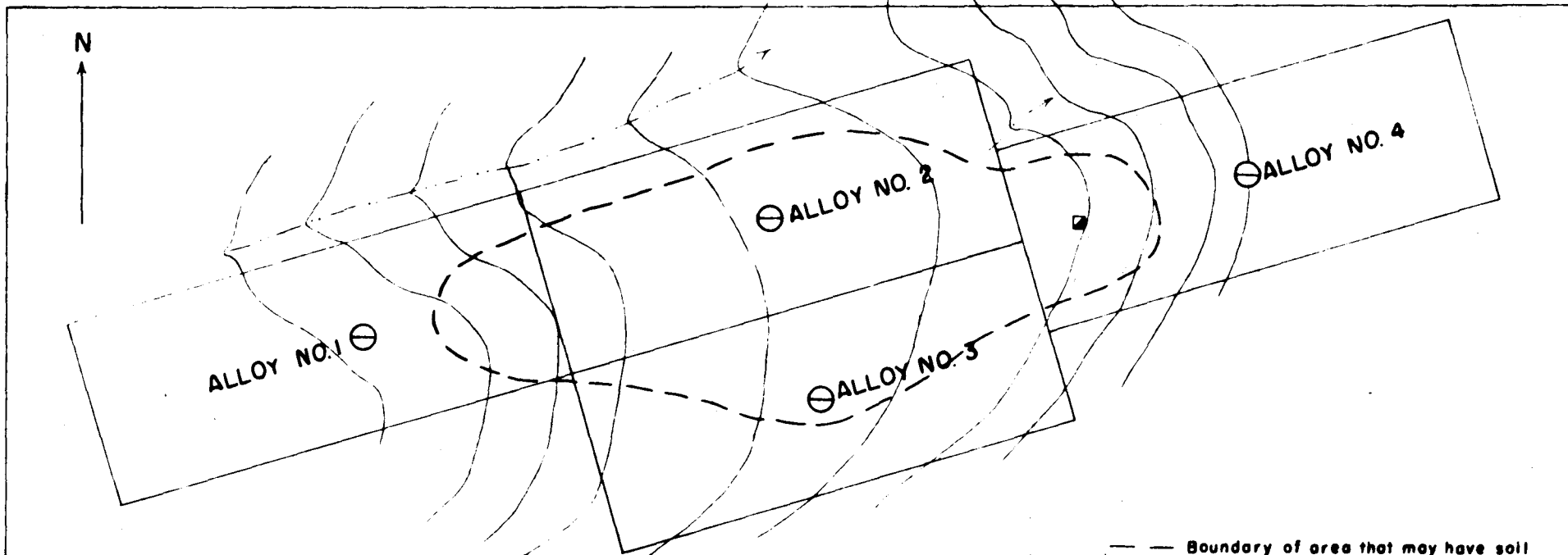

ASSAYS

Sample	Depth	% Ni	Remarks
15643 Loc. nit Alloy No. 1	0-6'	0.30	1½ ft. laterite grades down into ochre soil with 30% boulders in bottom
15642 Loc. nit Alloy No. 2	0-6'	0.92	1 ft. laterite grades down into pitted peridotite bedrock
15640 Loc. nit Alloy No. 3	0-2'	0.77	laterite <10% boulders
15641 Loc. nit Alloy No. 3	2-6'	0.88	ochre soil with <10% boulders, greenish cast
15637 Loc. nit Alloy No. 4	0-4'	0.41	1 ft. laterite grading into ochre below
15638 Loc. nit Alloy No. 4	4-6'	0.26	serpentinized bedrock
15639 Freeport Shaft (Alloy 4)	0-6'	0.33	30% boulders; 1 ft. laterite grading down into ochre

— Boundary of area that may have soil thickness greater than 10 feet.

Note: Contour lines represent land-form only; they do not represent elevation differences.

ALLOY GROUP OF CLAIMS

FREE AND EASY MT.

JOSEPHINE CO., OREGON

0 500 1000 FEET

JULY 1953

M.T.S. & E.M.S.

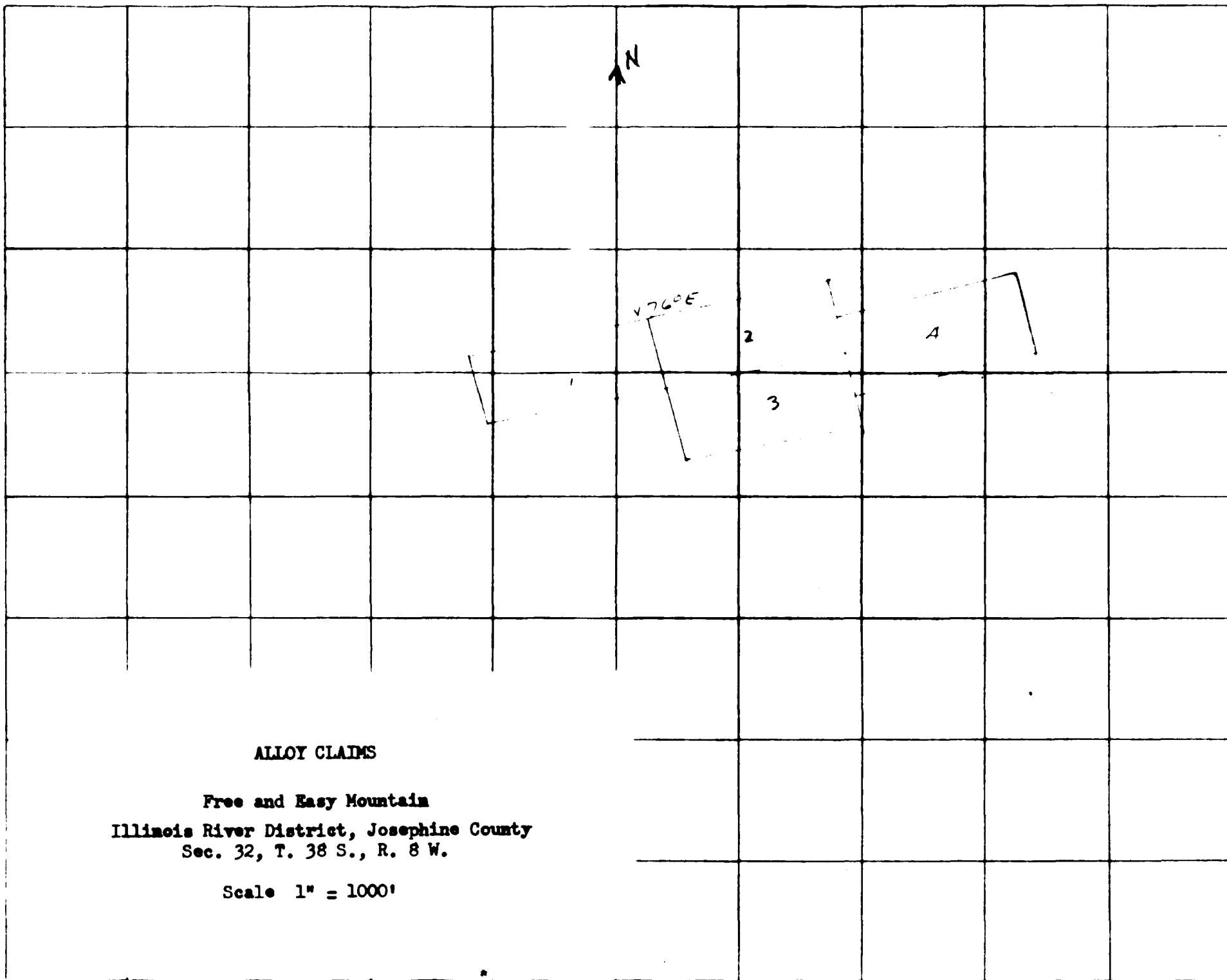

ALLOY CLAIMS

Free and Easy Mountain

Illinois River District, Josephine County

Sec. 32, T. 38 S., R. 8 W.

Scale 1" = 1000'

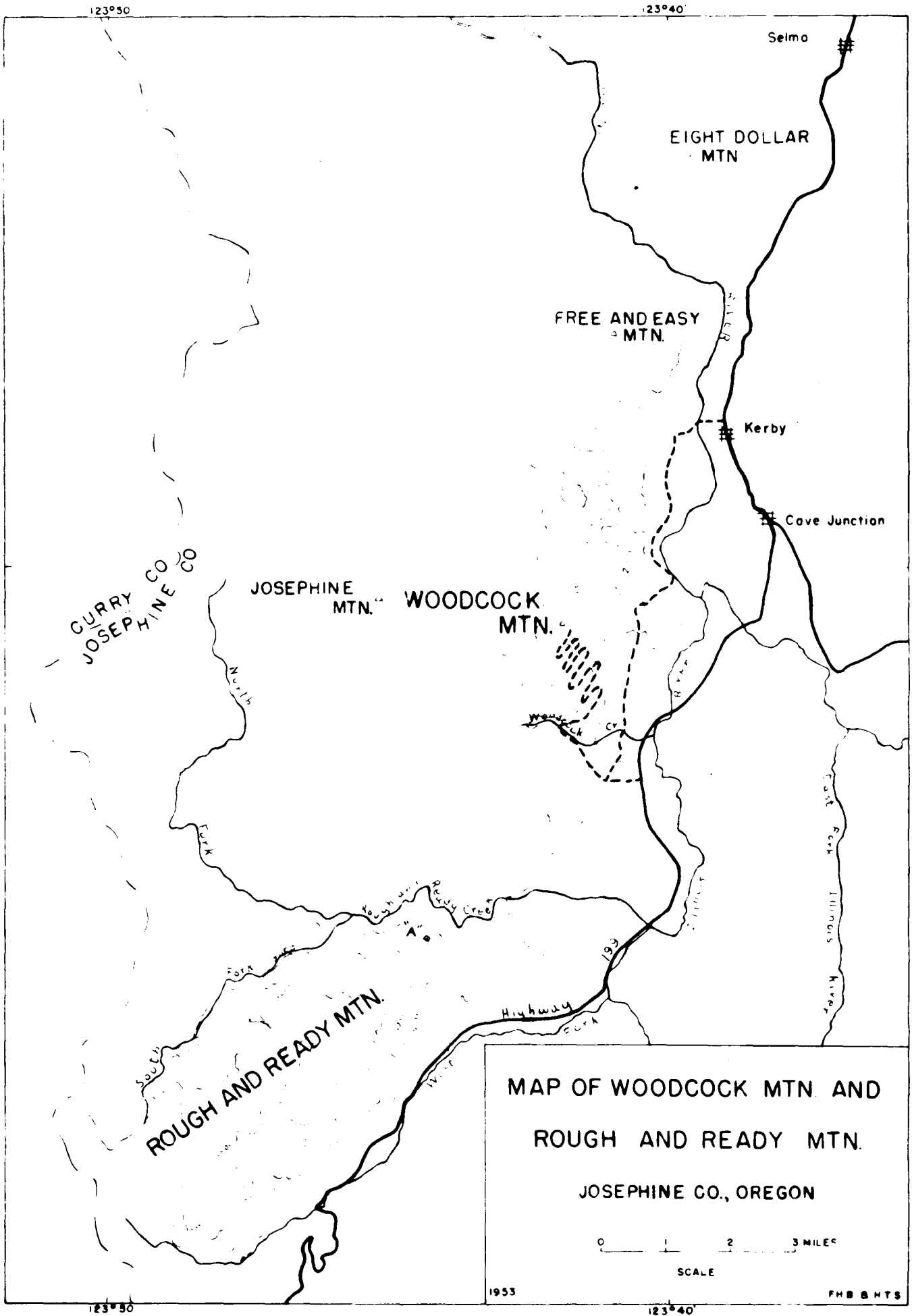

MAP OF WOODCOCK MTN. AND
ROUGH AND READY MTN.
JOSEPHINE CO., OREGON

0 1 2 3 MILES
SCALE

1953

FHB & HTS

Sample No.	% Ni	Description
15626	0.36	6-ft. channel; reddish-brown soil with large boulders, some boulders rotted.
15627	0.40	5-ft. channel; 1 ft. red pelletized soil grading down into reddish-brown soil with many boulders.
15628	0.44	Rotted peridotite boulder 6 ft. under soil surface.
15629	0.48	6-ft. channel; 4 ft. red pelletized soil on top.
15630	0.66	3-ft. auger cuttings; reddish brown soil grading downward into greenish soil.
15631	1.66	Picked sample of green amorphous material occurring on joint surfaces.
15632	0.46	10-ft. channel; 2 ft. red soil on top grading down through brown into gray.

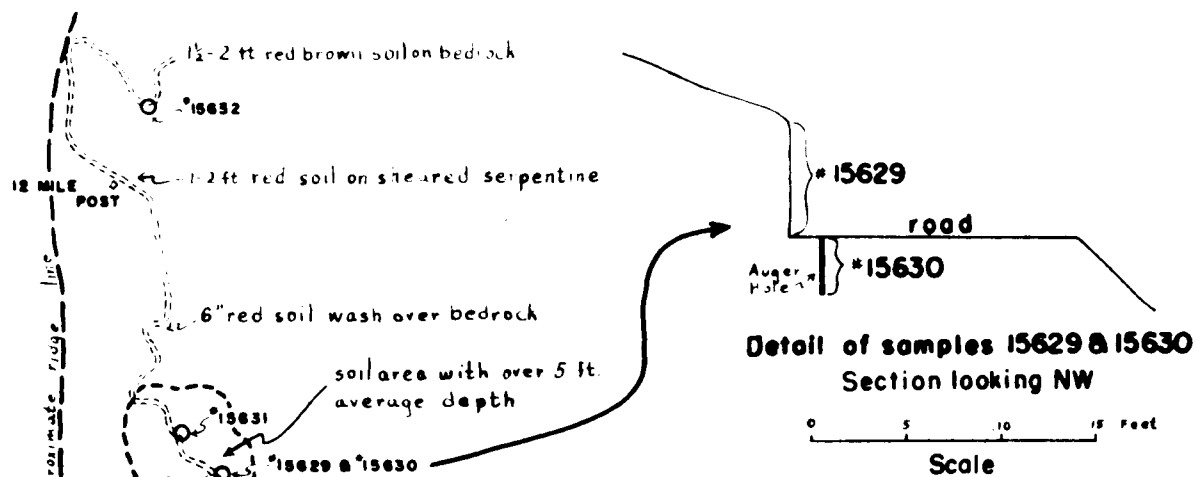

DETAILED MAP OF THE
NORTH END OF LITTLE
RATTLESNAKE MT.
DEL NORTE COUNTY, CALIFORNIA

0 1000 2000 3000 4000 FEET
SCALE