

Josephine County  
Grants Pass District

- Name: Lambtongue Mine (gold quartz)
- Old Name: Baby Mine, Page 18 Handbook.
- Owner: ~~George and~~ Ben Baker, Route 1, Grants Pass, Oregon.
- Location: The Lambtongue Mine is located on east side of Walker Mountain, 8 miles north of Grants Pass in the S.E. 1/4 of S.E. 1/4 of Sec. 8, T. 35 S., R. 5 W.
- Area: One lode mining claim held by location. Area 19.55 acres.
- History: The Lambtongue is an old property and its past history is in the Handbook. Little if any development work has been done since 1916. The present owners located it January, 1937 and has operated it intermittently. It has produced \$6000 since last located. The ore is hauled to a mill on the Oak Mine about one mile.
- Development: A crosscut tunnel runs N. 83° W. 295 feet to the vein. There is a drift in each direction on the vein; one S. 40° E. 115 feet, and the other N. 40° W. 45 feet to a fault. There are a number of drifts north of the fault looking for the vein, which will make a total of 600 feet on this level. 110 feet vertically above on vein is another level. From the portal of the tunnel on this level a crosscut runs west 40 feet to the vein, thence along vein 250 feet to the fault. A large part of the ore has been stoped between the two levels and there is one connecting raise which starts where the fault cuts the vein in the lower tunnel.
- Geology: The country rock is meta gabbro in which a vein was formed along a fracture. Later movement took place along the fault which strikes S. 56° W. dips 50 to 60° to the southeast. Subsequent to the faulting another period of mineralization took place which formed the large quartz ledges. The vein formed along the fracture carries the values and it averages about one foot in width. This vein has not been found beyond the fault. Faults are abundant, probably due to the proximity of the larger one along which the movement took place. The vein minerals are quartz, free gold, pyrite and chalcopryrite. Medium hard ore vein is consistent; its lateral extent is unknown.
- Equipment: Small compressor run by a Fordson tractor and miscellaneous small equipment and ore bin.

Lambtongue Mine  
Josephine County (Continued)

Miscellaneous Information:

There is a small tonnage of ore left between the two levels. The ore mined since 1937 has plated \$19 per ton and the concentrates run about \$175 per ton. Concentration ratio 80 to one. Mill operation for April 7, 1938 showed concentrates \$171.56. Middlings \$18.20 (remilled), tailings \$1.75. Average tailing will run about \$4.00.

Fair road to property. Elevation 2200 feet. Plenty of timber on property for mining purposes. Ground stands well without timbering. Maximum 2 feet of snow. Mine makes enough water for mining purposes.

Informant: J. E. Morrison. 12/10/37.



3 Samples  
Covet.  
Midd.  
Tail.

STATE DEPARTMENT OF GEOLOGY AND MINERAL INDUSTRIES  
ASSAY LABORATORIES

Baker, Oregon  
Grants Pass, Oregon

SAMPLE INFORMATION REQUESTED

The law passed by the Legislature, governing the free assaying and analyzing of samples sent to a State Assay Laboratory, provides that certain information be furnished to the Laboratory regarding samples sent for assays, etc. A copy of the law will be found on the back of this blank. Please read the law carefully. Will you please fill in the information called for in the following blank, as far as possible, and return the same to the nearest State Assay Laboratory, along with your sample. If you have made out a blank, this copy is for your future use. Keep a copy of the information on each sample for your own reference.

Your name in full. J. E. Morrison

Postoffice address. . . . .

Are you a citizen of Oregon? . . . . . Date on which sample is sent. . . . .

Name (or names) of owners of the property . . . . .

Name of particular claim and date of location Larabique Mine

Location of property or source of sample: Mill Products

(1) County. Josephine . . . . . (2) Mining District Grants Pass

(3) Township 3540 . . . . . (4) Range 540 . . . . . (5) Section 7

(6) Quarter Section . . . . .

How far from passable road? on road

For what do you wish sample tested? gold

Does your sample represent a new discovery? no

On a newly located claim? no . . . . . Old? yes

Has any ore from this claim been milled or shipped? yes

Width of ore where sample was taken (length of channel cut) . . . . .

Remarks: The Department would be pleased to have you add to the above, such information as you think would be of interest and value. Use the reverse side of this sheet or a separate sheet. This could best be shown by a pencil sketch, indicating the development on the claim with the widths of vein, especially the width of ore at the place where this sample was taken.

A sample, to be of value, should be taken in an even channel across the vein from wall to wall. Its position in the workings should be marked and the width measured. Assays of unlocated samples, without widths, are of little value. They create but little interest in the minds of experienced investors and engineers.

(signed) J. E. Morrison

(Over)



RECORD IDENTIFICATION

RECORD NO..... M061277  
RECORD TYPE..... X1M  
COUNTRY/ORGANIZATION. USGS  
DEPOSIT NO..... DDGM1 100-150  
MAP CODE NO. OF REC..

REPORTER

NAME..... JOHNSON, MAUREEN G.  
UPDATED..... 81 03  
BY..... FERNS, MARK L. (BROOKS, HOWARD C.)

NAME AND LOCATION

DEPOSIT NAME..... LAMBTONGUE  
SYNONYM NAME..... BABY

MINING DISTRICT/AREA/SUBDIST. GRANTS PASS

COUNTRY CODE..... US  
COUNTRY NAME: UNITED STATES

STATE CODE..... OR  
STATE NAME: OREGON

COUNTY..... JOSEPHINE  
DRAINAGE AREA..... 17100310 PACIFIC NORTHWEST  
PHYSIOGRAPHIC PRDV..... 13 KLAMATH MOUNTAINS  
LAND CLASSIFICATION..... 49

QUAD SCALE            QUAD NO OR NAME  
1: 62500            GLENDALE

LATITUDE            LONGITUDE  
42-32-03N            123-18-28W

UTM NORTHING        UTM EASTING        UTM ZONE NO  
4708924.2            474720.5            +10

TWP..... 35S  
RANGE..... 05W  
SECTION.. 17  
MERIDIAN. W.M.

LOCATION COMMENTS: NE COR

COMMODITY INFORMATION

COMMODITIES PRESENT..... AU    AG    CU



OCCURRENCE(S) OR POTENTIAL PRODUCT(S):  
POTENTIAL.....  
OCCURRENCE..... CU

ORE MATERIALS (MINERALS, ROCKS, ETC.):  
FREE GOLD, PYRITE, CHALCOPYRITE; MALACHITE, AZURITE

COMMODITY SUBTYPES OR USE CATEGORIES:  
6.510 AU:AG

ANALYTICAL DATA (GENERAL)  
SULFIDE CONCENTRATES SAID TO CONTAIN \$75/TON IN GOLD

EXPLORATION AND DEVELOPMENT  
STATUS OF EXPLOR. OR DEV. B

DESCRIPTION OF DEPOSIT

DEPOSIT TYPES:  
VEINS/SHEAR ZONE  
FORM/SHAPE OF DEPOSIT:

SIZE/DIRECTIONAL DATA  
SIZE OF DEPOSIT..... SMALL  
MAX WIDTH..... 10 FT  
STRIKE OF OREBODY..... N56E  
DIP OF OREBODY..... 50-50SE

COMMENTS (DESCRIPTION OF DEPOSIT):  
VEIN MATERIAL IS PARTLY BRECCIATED

DESCRIPTION OF WORKINGS

COMMENTS (DESCRIP. OF WORKINGS):  
1500 FEET OF DRIFTS AND CROSSCUTS ON TWO LEVELS.

PRODUCTION

YES  
SMALL PRODUCTION

ANNUAL PRODUCTION (ORE, COMMOD., CONC., OVERBURD.)

ITEM	ACC	AMOUNT	THOUS. UNITS	YEAR	GRADE, REMARKS
1 ORE	SML	.627	TONS		
2 AU	SML	.189	OZ	.301	OZ/T
3 AG	SML	.029	OZ	.046	OZ/T



15 AU	EST 0001.300 OZ	1897-1938	
16 ORE EST	6.000	DOLLARS	
23 ORE, EST	26.000 DOLLARS	1897-1938	0.3 AU, 0.05 AG

PRODUCTION YEARS..... 1937-1939

SOURCE OF INFORMATION (PRODUCTION).. USBM

#### GEOLOGY AND MINERALOGY

AGE OF HOST ROCKS..... PERM-TRI  
 HOST ROCK TYPES..... METAGABBRO

PERTINENT MINERALOGY..... QUARTZ, CALCITE

IMPORTANT ORE CONTROL/LOCUS.. "VEIN" FORMED ALONG FAULT

#### LOCAL GEOLOGY

NAMES/AGE OF FORMATIONS, UNITS, OR ROCK TYPES

- 1) NAME: APPLGATE GROUP  
 AGE: PERM-TRI

#### SIGNIFICANT LOCAL STRUCTURES:

MAIN FAULT N56E DIPS 50-60SE

#### GENERAL COMMENTS

RECORD NUMBERS (M015226) AND (M013459) HAVE BEEN MERGED WITH THIS RECORD AND DELETED FROM THE OREGON FILE.

#### GENERAL REFERENCES

- 1) RAMP, L. AND PETERSON, N.V., 1979, GEOLOGY AND MINERAL RESOURCES OF JOSEPHINE COUNTY, OREGON; ODGMI BULL. 100  
 45P
- 2) BROOKS, H.C. AND RAMP, L., 1968, GOLD AND SILVER IN OREGON; ODGMI BULL. 61, P.229
- 3) OREGON METAL MINES HANDBOOK, 1942, ODGMI BULL. 14-C, VOL. 2, SEC. 1, P.84

Out. Mine

WHE 200 cross cut.  
S38 E 170 ft.  
S46 E 168 ft to face  
S38 W 181 ft. to face 30 ft.

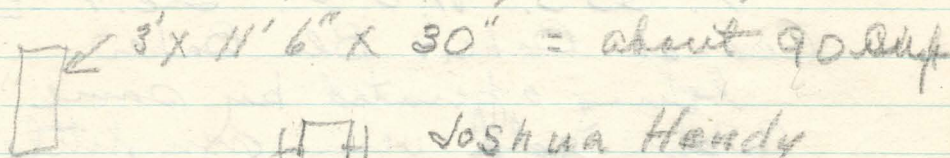

International  
15 HP.  
gas  
engine

Joshua Hendy  
8 x 10. crusher  
1/2 muck  
Bucket Elevator



are here  
48 x 36"  
Trobridge Grander.  
Dr. coal mainly carbon  
Medford Mill. but  
using 4 in light to  
start with.

Screen  
40 mesh  
oversize

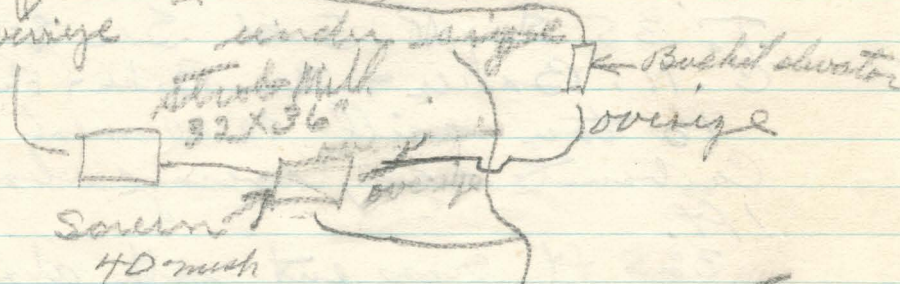

Winds Mill  
32 x 36"

Bucket elevator  
oversize

Screen  
40 mesh

24 x 48  
Plate

Concentrator  
Table run by 3 HP.  
card concentrator  
Table

2-Plates  
36 x 48

tails  
Hendrick & Boltzhoff Screen



September 8th, 1937

(Need capital to operate)

### Oak Mine

T. 35 S. R. 5 W. Sec. 4 SW. q.

George Baker + Ben Baker

being operated by same

Copper gold vein, very little  
quartz. Average width of  
vein 8 ft. Two tunnels,  
700 ft. of tunnel in vein.

250 ft. depth on vein.

About 350 tons milled in 1932+33  
plated about \$300. Tabled tailing  
concentrated 4 to 1, Assayed \$22.00  
in gold Rich in copper + zinc.

Listed as Baby Mine in State Publication  
listed at present as The Hamb Tongue

T. 35 S. R. 5 W. Sec. 8 S.E. q.

C. N. Baker + Ben Baker + Phil Burns

16 ton mill - 40-60 mesh,

Carbonate vein, average about  
1 ft.

325 ft cross cut with about  
700-800 ft. of underground work.

Vein ~~main~~ mineral is pyrite  
carrying gold.

\$10 to \$25 / ton - 80 to 1 cond ratio

Concl. runs 200-250 - Plate, about

\$23.00 / ton

No 1 sample	Pipe 25 to 5	Station 65 - 23	12 ft F + F
No 2	" "	" 5.0 - 23"	" " F + F
No 3	" "	" 87 - 12"	5 ft F
No 4	" "	" 90 - 31"	18 ft + 18 in
No 5	" "	" 100 - 42"	18 ft + 18 in
No 6	" "	" 145 - 60"	18" gauge
No 7	" "	" 53° E 45' 75V"	12" gauge
No 8	" "	5' above 2 ft 50 of 7	10" gauge

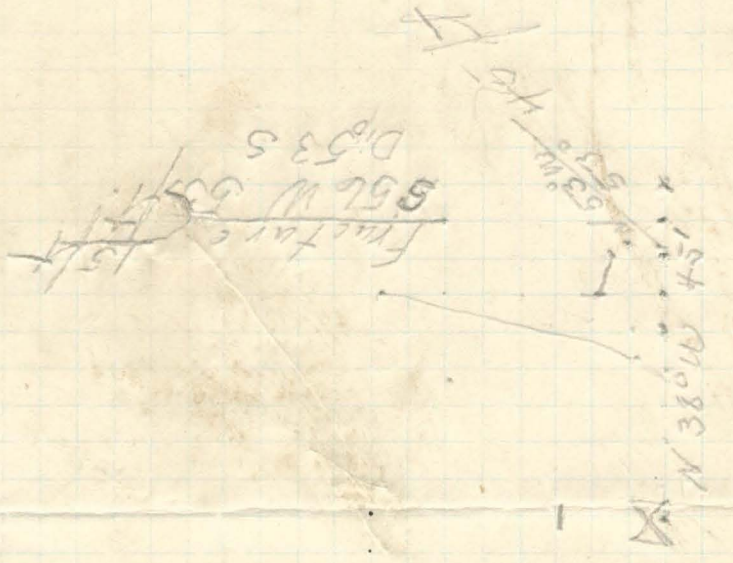
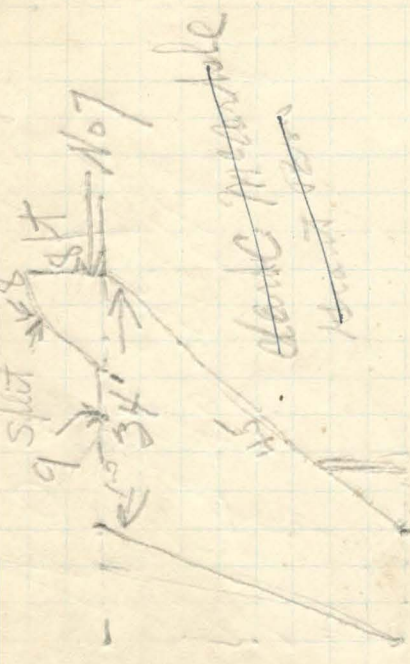

Madrone  
N 27 W  
51° E

N 82° E 30 ft  
at in ...  
D 55° W



Tie on upper level. N54°W 54ft. Portal

S 79°W 40ft. to Portal.

Upper Tunnel  
N85°E 55ft / S 57°W 56ft.  
Dip 56°S.

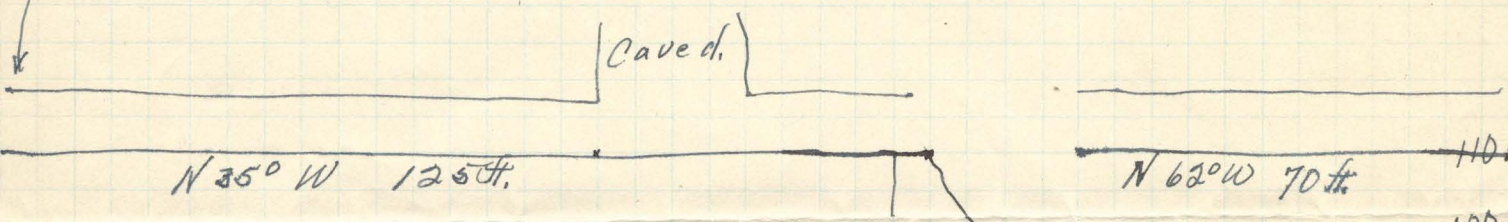

Anaroid. - 110.  
Transit. 106+?  
102.5

Strike N40W

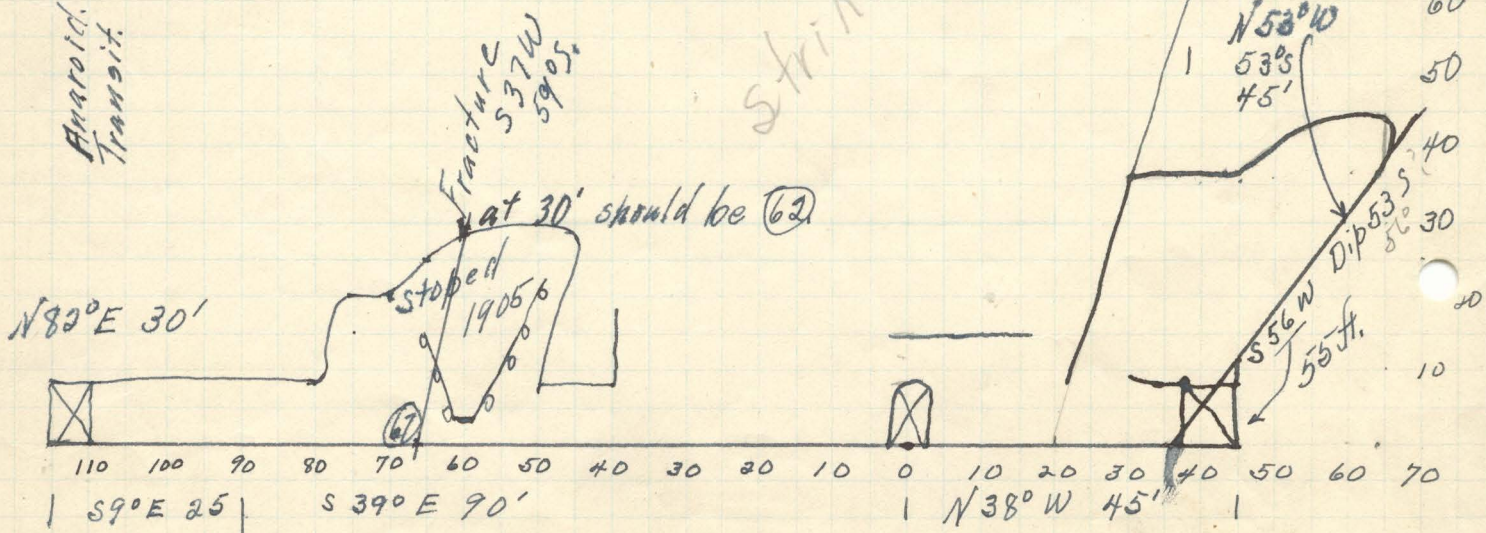

Fracture in X N10W Dip 55°W

Madrone.  
N27°W.  
Dip 51°E.  
30ft east of vein.



STATE DEPARTMENT OF GEOLOGY AND MINERAL INDUSTRIES

ASSAY LABORATORIES

Baker, Oregon  
Grants Pass, Oregon

SAMPLE INFORMATION REQUESTED

The law passed by the Legislature, governing the free assaying and analyzing of samples sent to a State Assay Laboratory, provides that certain information be furnished to the laboratory regarding samples sent for assays, etc. A copy of the law will be found on the back of this blank. Please read the law carefully. Will you please fill in the information called for in the following blank, as far as possible, and return the same to the nearest State Assay Laboratory, along with your sample. If you have made out a blank, this copy is for your future use. Keep a copy of the information on each sample for your own reference.

Your name in full J. E. Morrison.

Post office address \_\_\_\_\_

Are you a citizen of Oregon? \_\_\_\_\_ Date on which sample is sent 12/9/37

Name (or names) of owners of the property G. C. Baker.

Name of particular claim and date of location Samptongue.

Location of property or source of sample:

(1) County Josephine. (2) Mining District Grants Pass

(3) Township 35 S. (4) Range 5 W. (5) Section 17

(6) Quarter Section \_\_\_\_\_

How far from passable road? on road.

For what do you wish sample tested? Gold.

Does your sample represent a new discovery? no.

On a newly located claim? no Old? yes.

Has any ore from this claim been milled or shipped? wt. 3000 tons.

Width of ore where sample was taken (length of channel cut) Various. see 9 samples.

Remarks: The Department would be pleased to have you add to the above, such information as you think would be of interest and value. This could be placed in the space below or upon a separate sheet. This could best be shown by a pencil sketch, indicating the development on the claim with widths of vein, especially the width of ore at the place where this sample was taken.

A sample, to be of value, should be taken in an even channel across the vein from wall to wall. Its position in the workings should be marked and the width measured. Assays of unlocated samples, without widths, are of little value. They create but little interest in the minds of experienced investors and engineers.

No 1 - <sup>inches</sup> 23      No 6 - 60  
 No 2 - 23      No 7 - 18  
 No 3 - 12      No 8 - 12  
 No 4 - 31      No 9 - 10

Signed J. E. Morrison



ASSAY REPORT

December 31, 1937

Mr. J. E. Morrison, Mining Geologist  
State Assay Laboratory

Following are the results of assays made on samples  
from the Lambtongue Mine:

Office number	Sample number	Gold		Silver		Total value
		Oz./ton	\$/ton	Oz./ton	\$/ton	\$/ton
583	1	0.14	4.90	Trace		4.90
584	2	0.53	18.55	Trace		18.55
585	3	0.44	15.40	Trace		15.40
586	4	0.02	0.70	Trace		0.70
587	5	Trace		Trace		
588	6	Trace		Trace		
589	7	0.02	0.70	Trace		0.70
590	8	1.32	46.20	0.1	0.06	46.26
591	9	0.88	30.80	0.1	0.06	30.86
592	10	1.04	36.40	0.1	0.06	36.46
593	11	0.04	1.40	Trace		1.40
594	12	0.05	1.75	Trace		1.75
595	13	0.07	2.45	Trace		2.45
596	14	0.06	2.10	Trace		2.10
597	15	0.03	1.05	Trace		1.05

Signed.....*R. A. L.*.....  
Assayer



STATE DEPARTMENT OF GEOLOGY AND MINERAL INDUSTRIES

ASSAY LABORATORIES

Baker, Oregon  
Grants Pass, Oregon

SAMPLE INFORMATION REQUESTED

The law passed by the Legislature, governing the free assaying and analyzing of samples sent to a State Assay Laboratory, provides that certain information be furnished to the laboratory regarding samples sent for assays, etc. A copy of the law will be found on the back of this blank. Please read the law carefully. Will you please fill in the information called for in the following blank, as far as possible, and return the same to the nearest State Assay Laboratory, along with your sample. If you have made out a blank, this copy is for your future use. Keep a copy of the information on each sample for your own reference.

Your name in full J E Menzies

Post office address \_\_\_\_\_

Are you a citizen of Oregon? \_\_\_\_\_ Date on which sample is sent Sept. 24 1937

Name (or names) of owners of the property Grant Baker

Name of particular claim and date of location Sitting Mine

Location of property or source of sample:

- (1) County Josephine (2) Mining District Grants Pass
- (3) Township 35-5 (4) Range 5 W (5) Section 8
- (6) Quarter Section 2 E

How far from passable road? Road to mine

For what do you wish sample tested? Gold

Does your sample represent a new discovery? no

On a newly located claim? no Old? yes

Has any ore from this claim been milled or shipped? yes

Width of ore where sample was taken (length of channel cut) Head to mill

Remarks: The Department would be pleased to have you add to the above, such information as you think would be of interest and value. This could be placed in the space below or upon a separate sheet. This could best be shown by a pencil sketch, indicating the development on the claim with widths of vein, especially the width of ore at the place where this sample was taken.

A sample, to be of value, should be taken in an *even channel across the vein* from wall to wall. Its position in the workings should be marked and the width measured. Assays of unlocated samples, without widths, are of little value. They create but little interest in the minds of experienced investors and engineers.

Signed J E M.



April 15, 1938

Mr. J. E. Morrison, Mining Geologist  
State Assay Laboratory  
Grants Pass, Oregon

Following are the results of assays made on mill  
products from the Lantongue Mine.

Office Number	Sample number	Gold		Silver		Total value \$/ton
		Oz./ton	\$/ton	Oz./ton	\$/ton	
305	Conc't	4.90	171.50	0.1	.06	\$171.56
306	Middling	0.52	18.20	Trace		18.20
307	Tailing	0.06	1.75	Trace		1.75

SIGNED.....  
Assayer





STATE DEPARTMENT OF GEOLOGY AND  
MINERAL INDUSTRIES

STATE ASSAY LABORATORY  
802 EAST H STREET  
GRANTS PASS, OREGON

ASSAY REPORT

December 31, 1937

Mr. J. E. Morrison, Mining Geologist  
State Assay Laboratory

Following are the results of assays made on samples  
from the Lambtongue Mine:

Office number	Sample number	Gold		Silver		Total value \$/ton
		Oz./ton	\$/ton	Oz./ton	\$/ton	
583	1	0.14	4.90	Trace		4.90
584	2	0.53	18.55	Trace		18.55
585	3	0.44	15.40	Trace		15.40
586	4	0.02	0.70	Trace		0.70
587	5	Trace		Trace		
588	6	Trace		Trace		
589	7	0.02	0.70	Trace		0.70
590	8	1.32	46.20	0.1	0.06	46.26
591	9	0.88	30.80	0.1	0.06	30.86
592	10	1.04	36.40	0.1	0.06	36.46
593	11	0.04	1.40	Trace		1.40
594	12	0.05	1.75	Trace		1.75
595	13	0.07	2.45	Trace		2.45
596	14	0.06	2.10	Trace		2.10
597	15	0.03	1.05	Trace		1.05

Signed *Albert G. Lewis*.....  
Assayer







STATE DEPARTMENT OF GEOLOGY AND MINERAL INDUSTRIES  
ASSAY LABORATORIES

Baker, Oregon  
Grants Pass, Oregon

SAMPLE INFORMATION REQUESTED

The law passed by the Legislature, governing the free assaying and analyzing of samples sent to a State Assay Laboratory, provides that certain information be furnished to the laboratory regarding samples sent for assays, etc. A copy of the law will be found on the back of this blank. Please read the law carefully. Will you please fill in the information called for in the following blank, as far as possible, and return the same to the nearest State Assay Laboratory, along with your sample. If you have made out a blank, this copy is for your future use. Keep a copy of the information on each sample for your own reference.

Your name in full J E Morrison

Post office address .....

Are you a citizen of Oregon? ..... Date on which sample is sent Sept 24 1937

Name (or names) of owners of the property George Baker

Name of particular claim and date of location Long Long Mine

Location of property or source of sample:

(1) County Josephine (2) Mining District Grant Pass

(3) Township 35-S. (4) Range 5 W (5) Section 8

(6) Quarter Section 5 E

How far from passable road? Road to mine

For what do you wish sample tested? Gold.

Does your sample represent a new discovery? no

On a newly located claim? no Old? yes

Has any ore from this claim been milled or shipped? yes

Width of ore where sample was taken (length of channel cut) Falls from mill

Remarks: The Department would be pleased to have you add to the above, such information as you think would be of interest and value. This could be placed in the space below or upon a separate sheet. This could best be shown by a pencil sketch, indicating the development on the claim with widths of vein, especially the width of ore at the place where this sample was taken.

A sample, to be of value, should be taken in an *even channel across the vein from wall to wall*. Its position in the workings should be marked and the width measured. Assays of unlocated samples, without widths, are of little value. They create but little interest in the minds of experienced investors and engineers.

Signed J E M.







STATE DEPARTMENT OF GEOLOGY AND MINERAL INDUSTRIES

ASSAY REPORT

Office Number 52

Grants Pass, Oregon  
Baker, Oregon  
~~XXXXXXXXXX~~

January 21, 1939

Sample submitted by George A. Baker Route 1, Box 760, Grants Pass

Sample description Pyritic, table concentrate.

The assay results given below are made without charge as provided by Chapter 176, Section 10, Oregon Laws 1937, the sender having complied with the provisions thereof.

NOTICE: The assay results given below are from a sample furnished by the above named person. This department had no part in the taking of the sample and assumes no responsibility, other than the accuracy of the assay of the material as furnished it by the sender.

Sample Number	GOLD		SILVER		Percent	Value	Percent	Value	Total Value
	Ounces per ton	Value	Ounces per ton	Value					
	3.82	133.70	0.5	0.32					\$134.02

Market Quotations:

Gold       \$ 35.00 per oz.  
Silver     \$ 0.64 per oz.  
           \$       per lb.  
           \$       per lb.

State Assay Laboratory

\_\_\_\_\_  
Assayer



STATE DEPARTMENT OF GEOLOGY AND MINERAL INDUSTRIES

ASSAY LABORATORIES

Baker, Oregon  
Grants Pass, Oregon

SAMPLE INFORMATION REQUESTED

The law passed by the Legislature, governing the free assaying and analyzing of samples sent to a State Assay Laboratory, provides that certain information be furnished to the laboratory regarding samples sent for assays, etc. A copy of the law will be found on the back of this blank. Please read the law carefully. Will you please fill in the information called for in the following blank, as far as possible, and return the same to the nearest State Assay Laboratory, along with your sample. If you have made out a blank, this copy is for your future use. Keep a copy of the information on each sample for your own reference.

Your name in full J. E. Morrison

Post office address \_\_\_\_\_

Are you a citizen of Oregon? \_\_\_\_\_ Date on which sample is sent 11/20/37

Name (or names) of owners of the property G. A. Baker

Name of particular claim and date of location Lamb Tongue

Location of property or source of sample:

- (1) County Josephine
- (2) Mining District Grants Pass
- (3) Township 35 S.
- (4) Range 5 W
- (5) Section 17
- (6) Quarter Section \_\_\_\_\_

How far from passable road? on road.

For what do you wish sample tested? gold.

Does your sample represent a new discovery? no.

On a newly located claim? no Old? yes.

Has any ore from this claim been milled or shipped? no.

Width of ore where sample was taken (length of channel cut) tailing from mill,

Remarks: The Department would be pleased to have you add to the above, such information as you think would be of interest and value. This could be placed in the space below or upon a separate sheet. This could best be shown by a pencil sketch, indicating the development on the claim with widths of vein, especially the width of ore at the place where this sample was taken.

A sample, to be of value, should be taken in an even channel across the vein from wall to wall. Its position in the workings should be marked and the width measured. Assays of unlocated samples, without widths, are of little value. They create but little interest in the minds of experienced investors and engineers.

Signed J. E. Morrison





STATE DEPARTMENT OF GEOLOGY AND  
MINERAL INDUSTRIES

STATE ASSAY LABORATORY  
802 EAST H STREET  
GRANTS PASS, OREGON

ASSAY REPORT

December 17, 1937

Mr. J. E. Morrison, Mining Geologist  
State Assay Laboratory  
Grants Pass, Oregon

Following are the results of assays made on mill  
tailing samples from the Baker Mine:

<u>Office number</u>	<u>Sample number</u>	<u>Gold</u>		<u>Silver</u>		<u>Total value</u>
		<u>Oz./ton</u>	<u>\$/ton</u>	<u>Oz./ton</u>	<u>\$/ton</u>	<u>\$ per ton</u>
542	Tues.	0.40	14.00	Trace		14.00
543	Wed.	0.22	7.70	Trace		7.70
544	Thurs.	0.20	7.00	Trace		7.00
545	Fri.	0.16	5.60	Trace		5.60
546	Sat.	0.20	7.00	0.1	0.08	7.08

Signed... *Albert G. Lewis*  
Assayer





STATE DEPARTMENT OF GEOLOGY AND  
 MINERAL INDUSTRIES

STATE ASSAY LABORATORY  
 802 EAST H STREET  
 GRANTS PASS, OREGON

April 15, 1938

Mr. J. E. Morrison, Mining Geologist  
 State Assay Laboratory  
 Grants Pass, Oregon

Following are the results of assays made on mill  
 products from the Lamtongue Mine.

Office Number	Sample number	Gold		Silver		Total value \$/ton
		Oz./ton	\$/ton	Oz./ton	\$/ton	
305	Conc't	4.90	171.50	0.1	.06	\$171.56
306	Middling	0.52	18.20	Trace		18.20
307	Tailing	0.05	1.75	Trace		1.75

SIGNED.....  
 Assayer

*Mint returns 1937 \$2015.91 Smelter returns \$156.66*  
*" " to June 38 1515.12*