

Garcia Samples Middle Level

broken and covered (1/12/89)

assays
 ave = 0.025 of Au
 at 4 ft width
 cut by G. Garcia

130-B	24	.029	.322
140	3	.075	
150	6	.513	
160	12	.253	
170	6	.209	
180	10	.161	
190	17	.023	
200	12	.029	
210	12	.012	
220	5	.06	

Portion of
 Martha Mine
 Plan Map
 by G. Garcia
 January, 1988

1 inch = 50 feet [TF]

Additional
 data added
 6/1/88. [TF]

End of new drift
 as of 5/27/88. [TF]

[TF]

70 ft
 width

[TF]

Calculation of Year

[TF]

4" wide

[TF]

Swells to
 average of
 18" I. [TF]

[TF]

covered

[TF]

down
 on
 the
 tabs.

[TF]

covered

[TF]

upper adit

[TF]

2907

[TF]

2920

[TF]

4.005

[TF]

sink hole

[TF]

2943

[TF]

17.005

[TF]

27.005

[TF]

37.005

[TF]

17.005

[TF]

MIDDLE LEVEL

LOC. PHASE

core

UPPER LEVEL

4.005

2920

2907

17.005

27.005

37.005

17.005

17.005

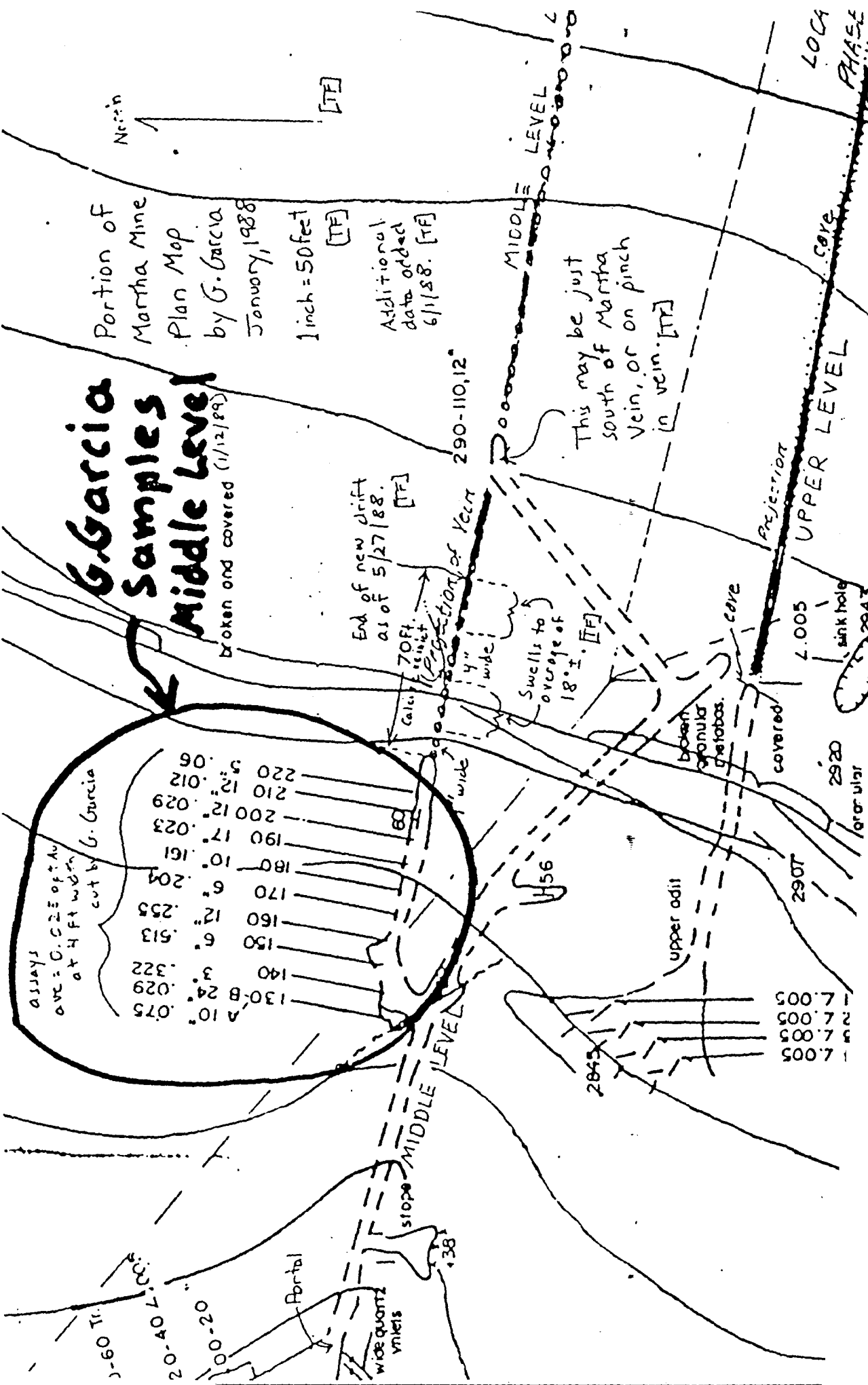

LEGEND

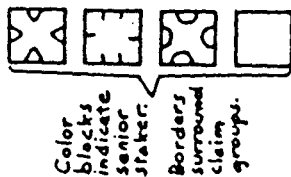

- Dragon's Gold (DG-X) Claim Group
- Saint Peter (SP-X) claim group - Bert West
- Horseshoe Extension (HE-X) / Alley (A-X) claim group - Miller
- King Midas claim - Bill Mignot

Notes: West claims approximated from poor descriptions on location notices in courthouse. Miller and Dragon's claims taken from other available maps.

Claims information based on courthouse research only - no field examination.

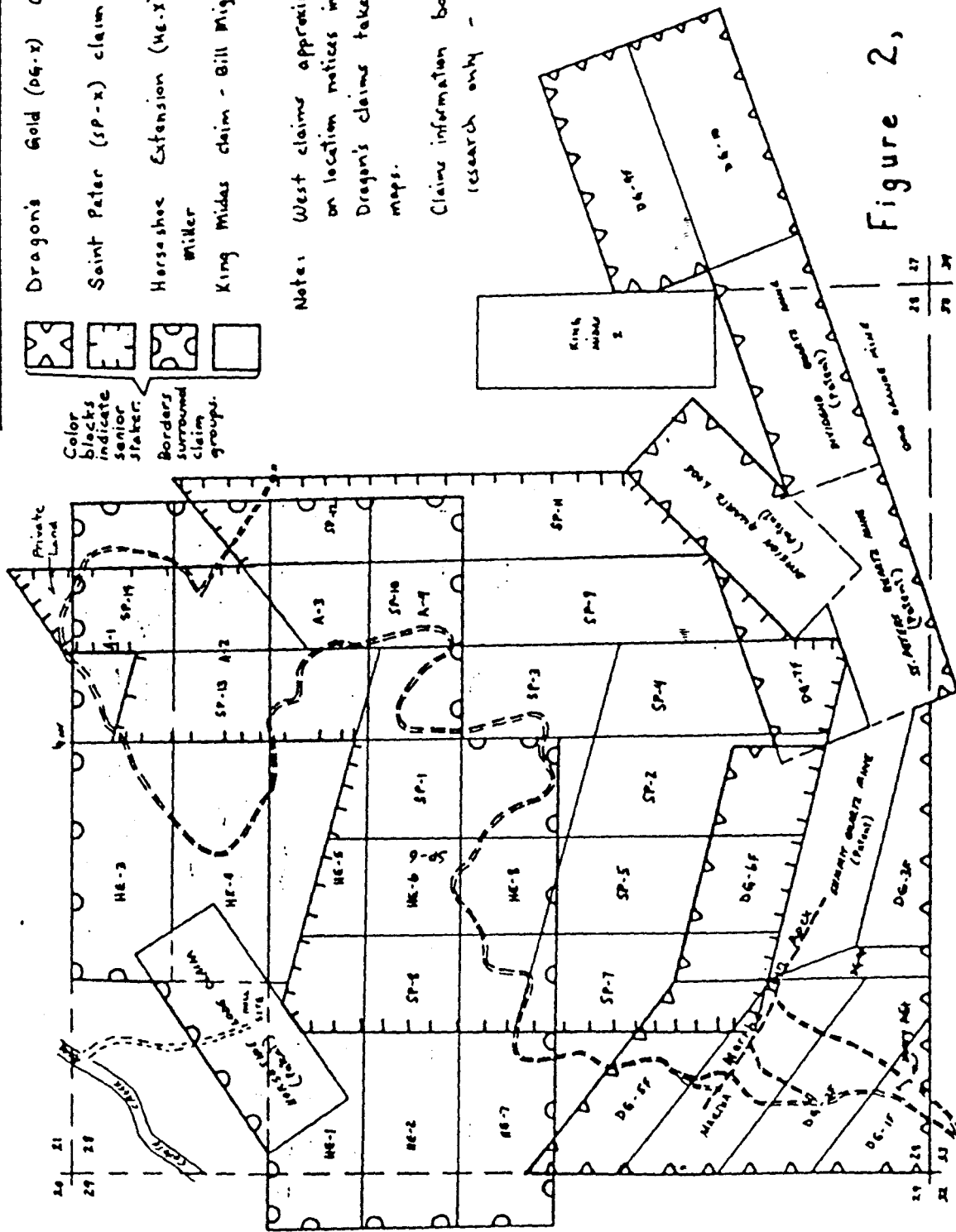
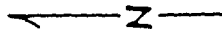
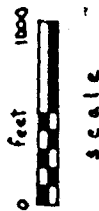
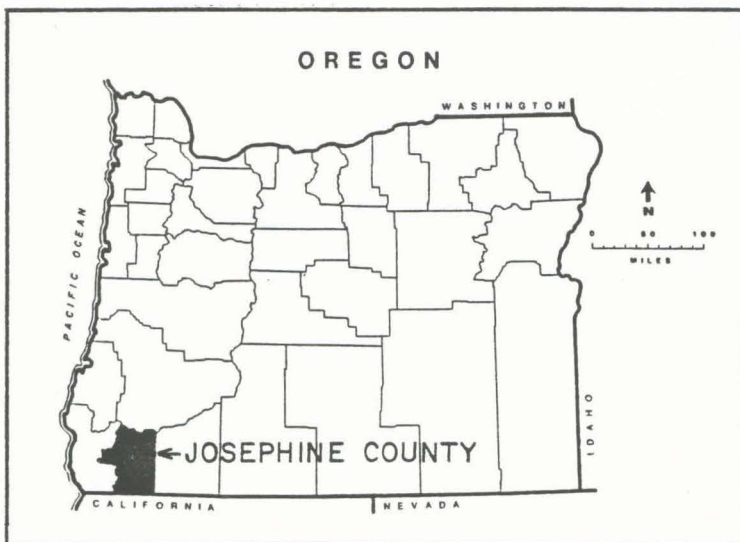
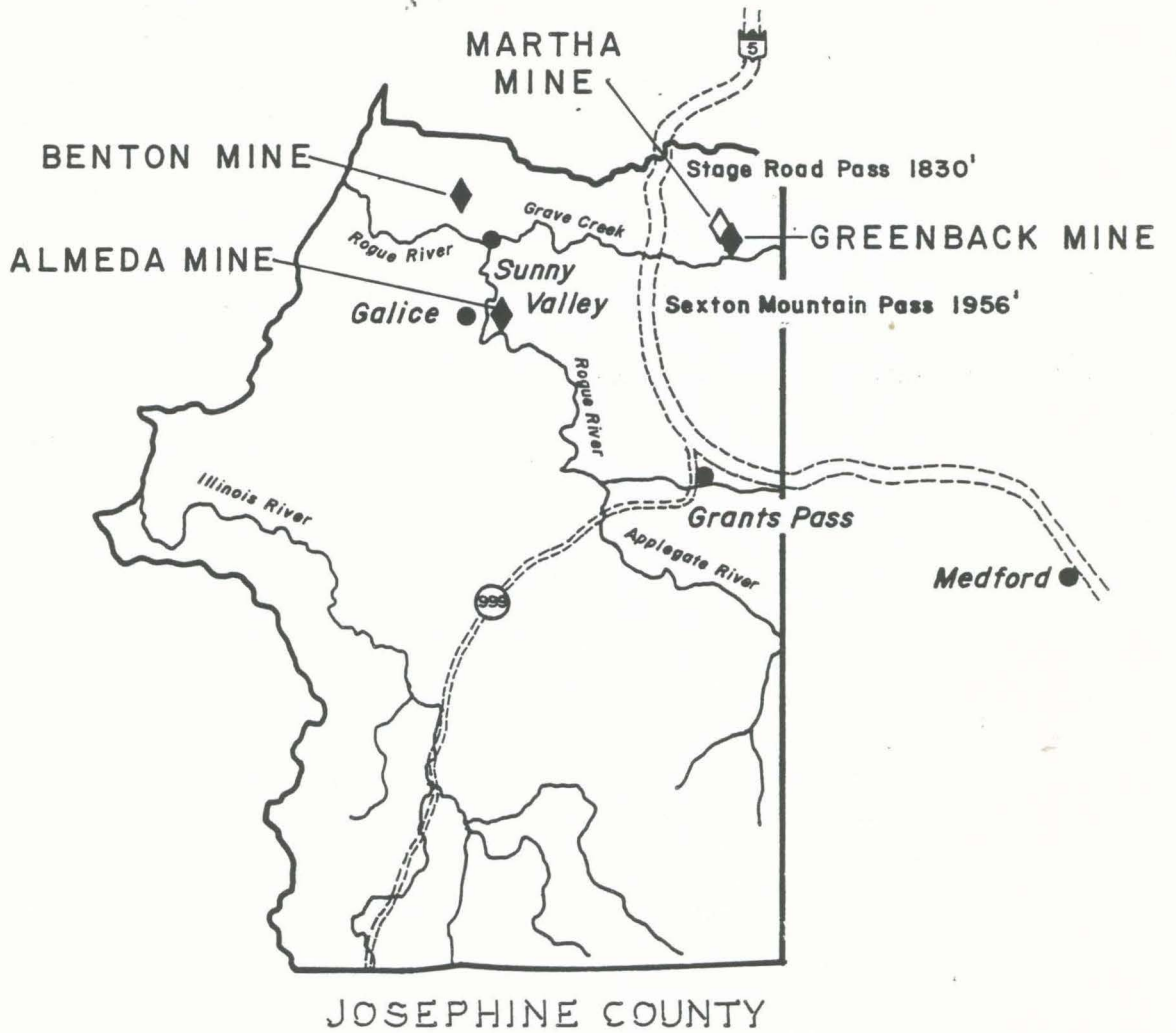

Figure 2, Property Map



C/MBIOR USA		
LOCATION MAP		
MARtha MINE		
COMPILED BY: R. MOORE	REVISIONS	DATE
DATE: 10/89		
MAP #: DG315-11.01	SHEET	OF

R 5 W

T 33 S

SUNSHINE 8
Paul M.
Bagdriwicz
&
DG II-F

SW-
SEC. 28



Foreign Claims



Dragons Gold



Patented Claim

- NOTES: ● Claims Plotted by Seniority
● Oro Grande Claims are Overstaked by Dragons Gold Claims, Which are Junior Claims



1000' 500' 0 1000'



SCALE: 1" = 1000'

CAMBIOR USA
DRAGONS GOLD PROJECT
CLAIM MAP
MARTHA PROPERTY
JOSEPHINE COUNTY, OREGON

COMPILED BY: J. Moore	REVISIONS	DATE
	L. Gaborit	2/91





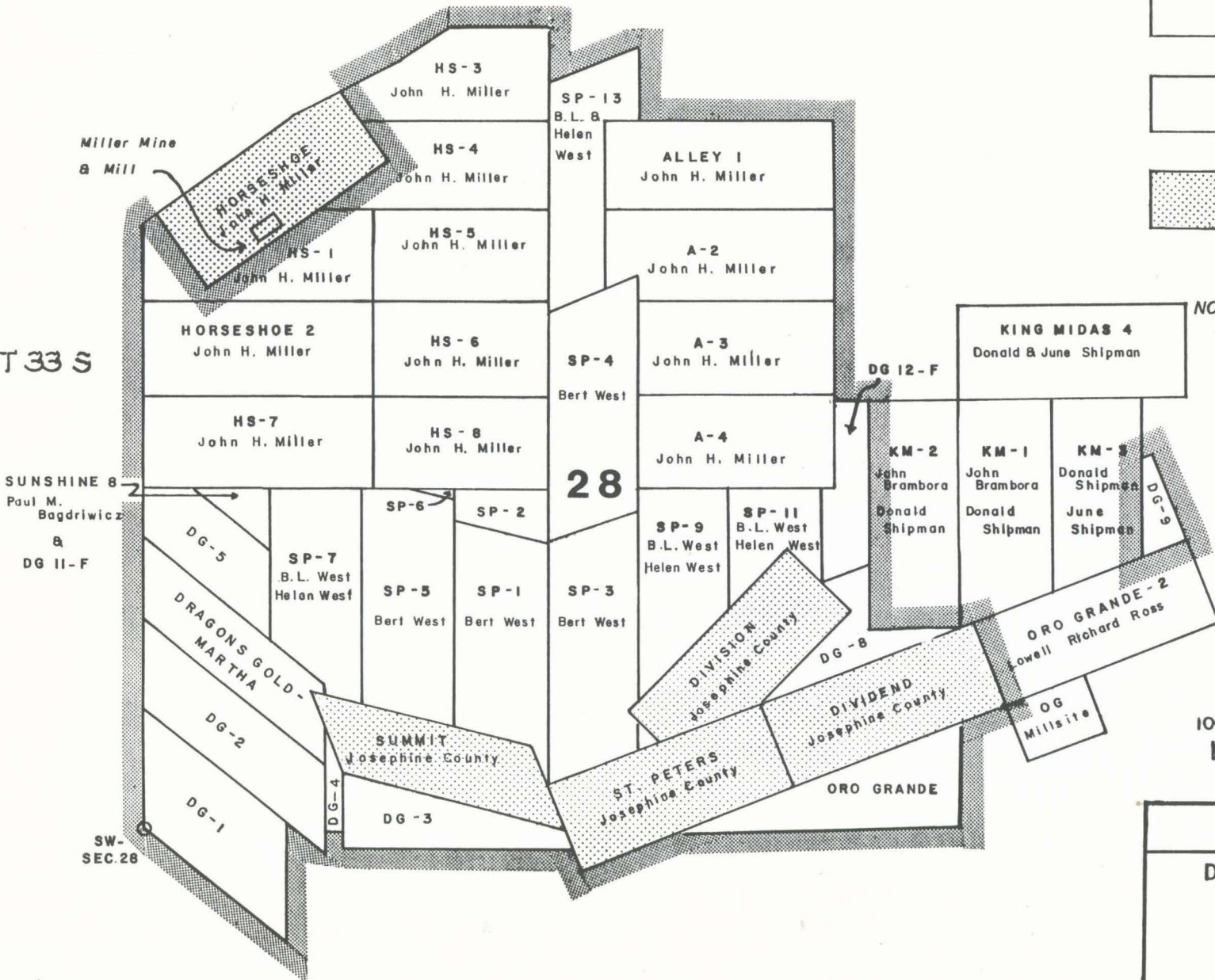

DATE: 2/1/90		
MAP #: 13.04		SHEET OF

BASE: Golden, Oregon 7.5' U.S.G.S. Quadrangle Map (Portion)





R 5 W

EXPLANATION

-  Applegate Group metavolcanic rock: andesite and basalt
-  Intrusive rock: diorite and gabbro
-  Ultramafic rock: serpentinite
-  High angle fault
-  Geological contact
-  Trace of the Martha vein structure
-  Drill hole

SOIL ANOMALIES

-  > 100 ppb Au
-  50 - 100 ppb Au
-  Trace of Martha Vein

T 33 S

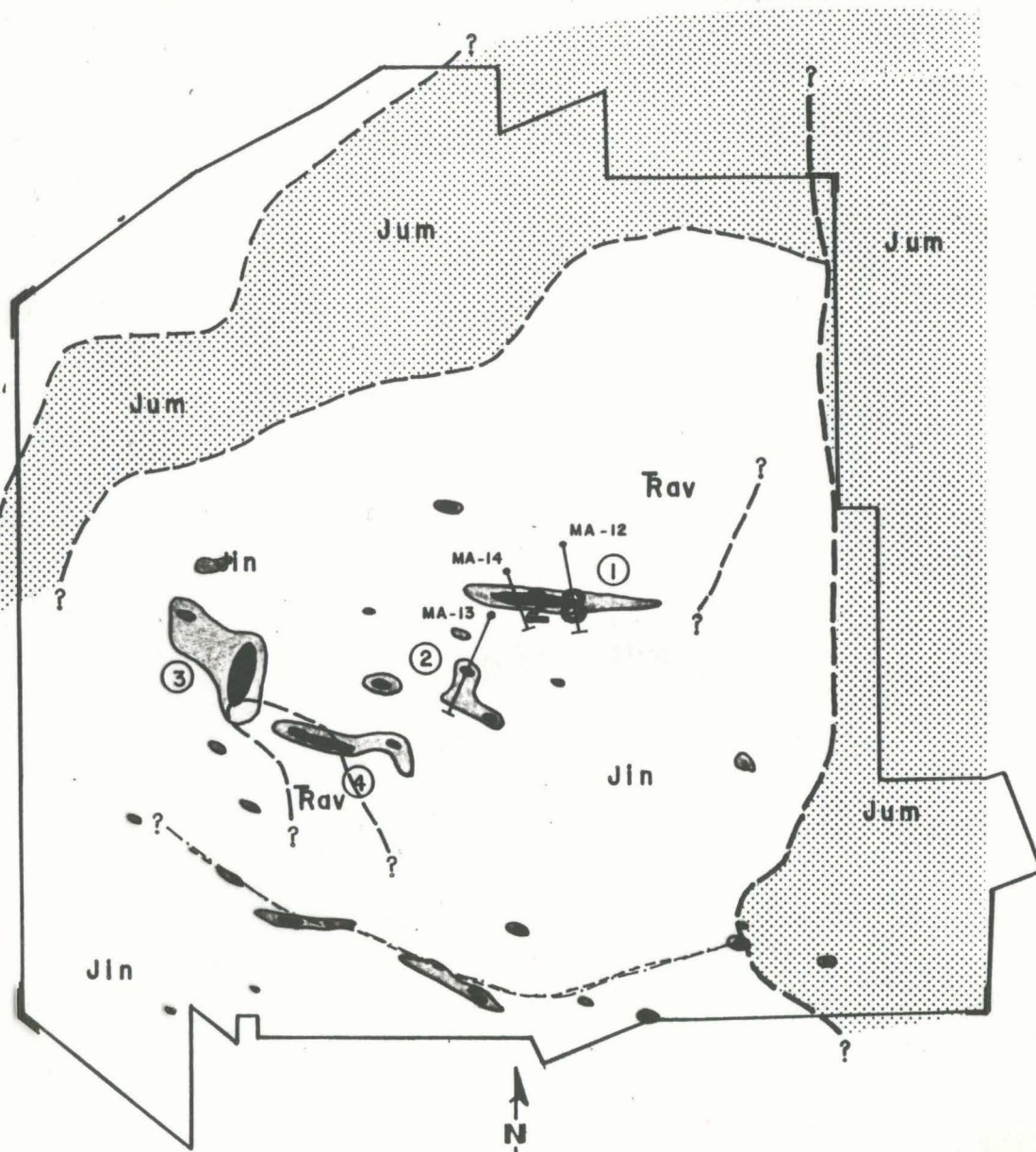

BASE: Golden, Oregon 7.5' U.S.G.S. Quadrangle Map (Portion)

CAMBIO USA

**DRAGONS GOLD PROJECT
MARTHA PROPERTY
GENERAL GEOLOGY
SOIL ANOMALIES**

JOSEPHINE COUNTY, OREGON

COMPILED BY: L. Gaborit	REVISIONS	DATE
DATE: 2/91		
MAP # DG315-16 1B	SHEET	OF

R 5 W

EXPLANATION

- Rav Applegate Group metavolcanic rock: andesite and basalt
- Jin Intrusive rock: diorite and gabbro
- Jum Ultramafic rock: serpentinite
- High angle fault
- Geological contact
- Trace of the Martha vein structure

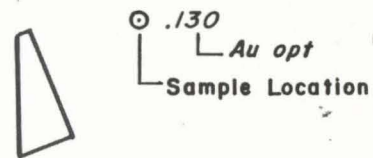

T 33 S

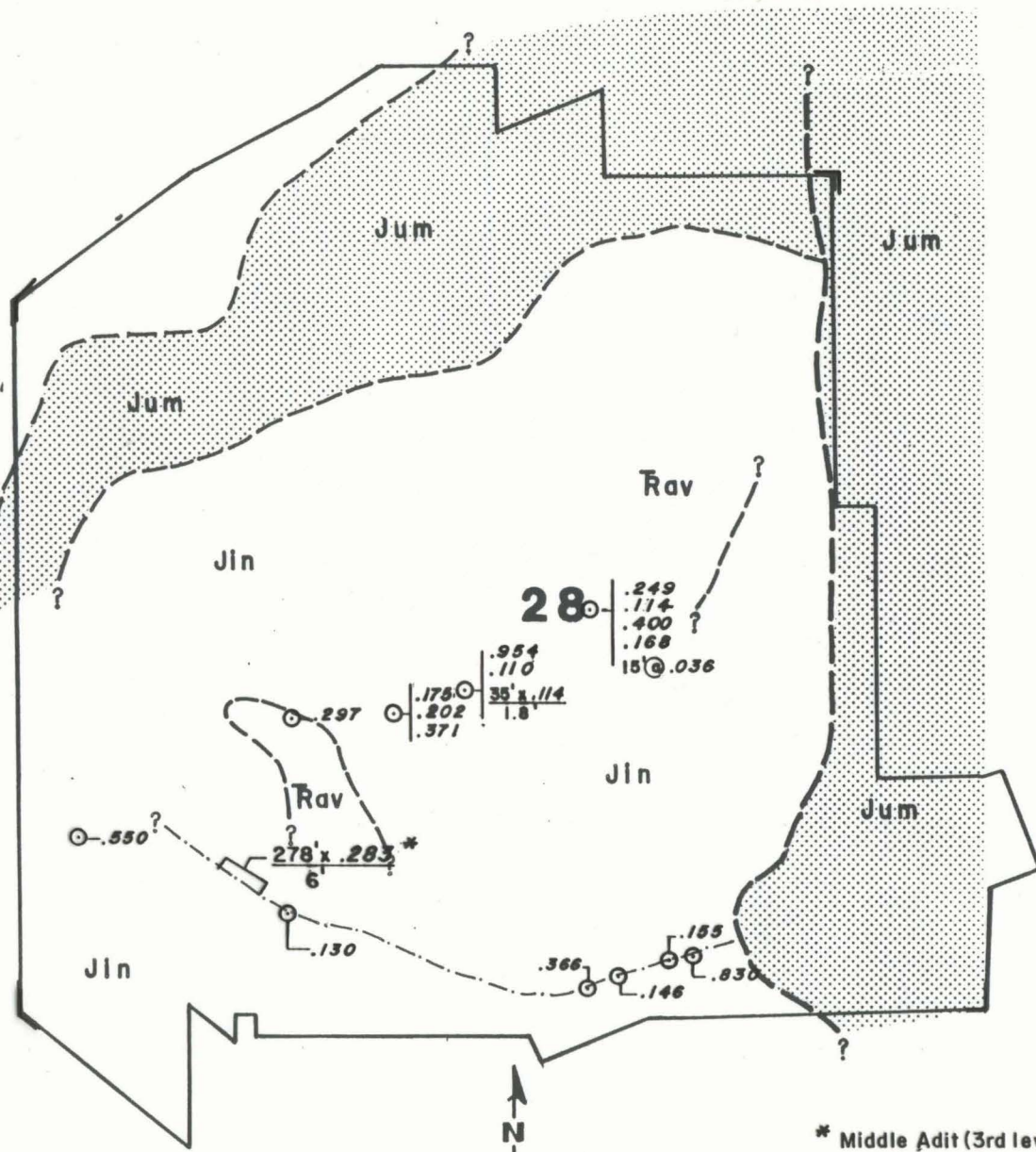

* Middle Adit (3rd level) ore shoot projected to surface.

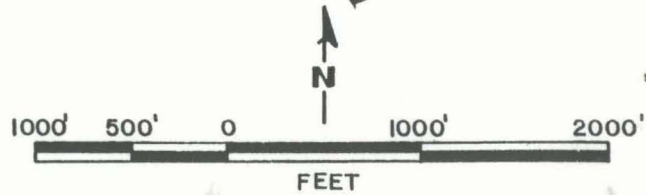

CAMBIOR USA

DRAGONS GOLD PROJECT
SIGNIFICANT ASSAY
 GEOLOGY
GENERAL RESULTS

JOSEPHINE COUNTY, OREGON

COMPILED BY: L. Gaborit	REVISED	DATE
DATE: 8/91	DRAWN BY: 10216-16 18	SHEET 077

BASE: Golden, Oregon 7.5' U.S.G.S. Quadrangle Map (Portion)

132475

CLAIM No. 39

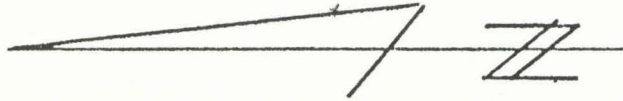
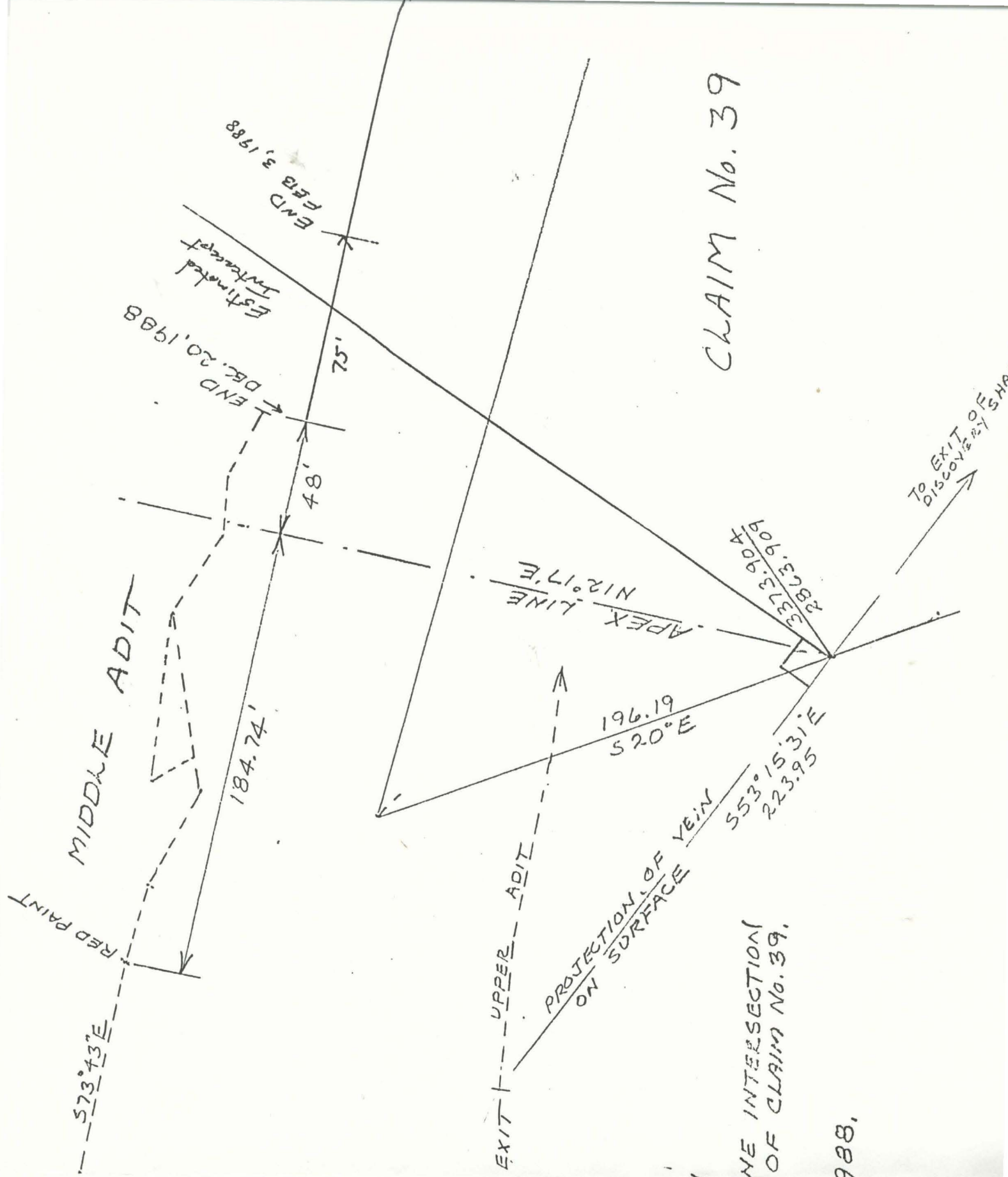

SCALE: 1" = 50'

SKETCH

SHOWING APEX LINE INTERSECTION WITH WEST LINE OF CLAIM No. 39.

DATE: DEC. 23, 1988.

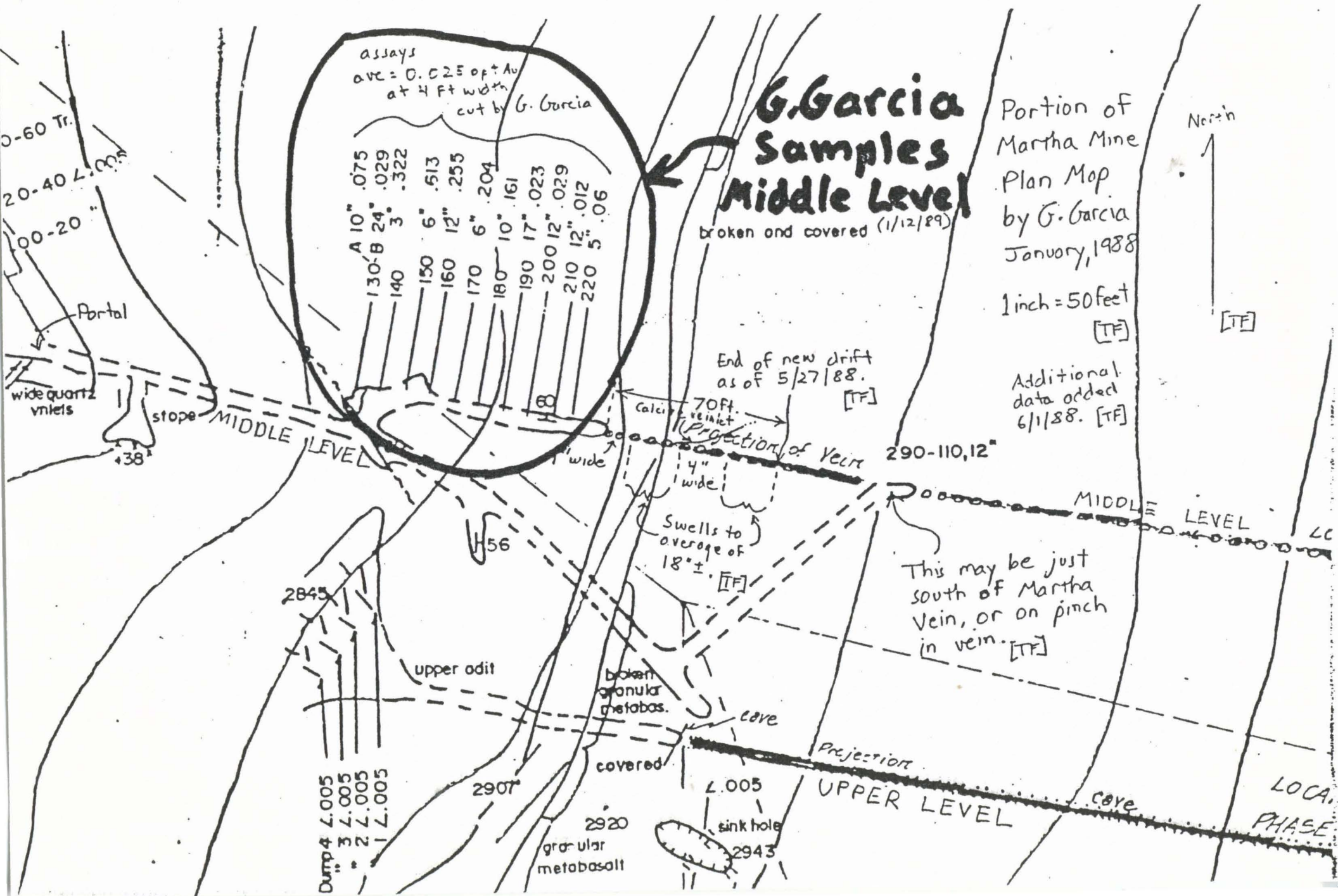

assays
 ave = 0.025 opt Au
 at 4 Ft width
 cut by G. Garcia

A 10"	.075
130" B 24"	.029
140 3"	.322
150 6"	.513
160 12"	.255
170 6"	.204
180 10"	.161
190 17"	.023
200 12"	.029
210 12"	.012
220 5"	.06

G. Garcia Samples Middle Level

broken and covered (1/12/89)

Portion of Martha Mine Plan Map by G. Garcia January, 1988

1 inch = 50 feet [TF]

Additional data added 6/1/88. [TF]



End of new drift as of 5/27/88. [TF]

Calc. veinlet 70ft. projection of Vein 290-110, 12"

Swells to average of 18" ± [TF]

This may be just south of Martha Vein, or on pinch in vein. [TF]

2845

upper adit

broken granular metabas.

cave

covered

Projection UPPER LEVEL

Dump 4 4.005
 3 4.005
 2 4.005
 1 4.005

2907

2920 granular metabasalt

4.005

sink hole

2943





LOCA. PHASE

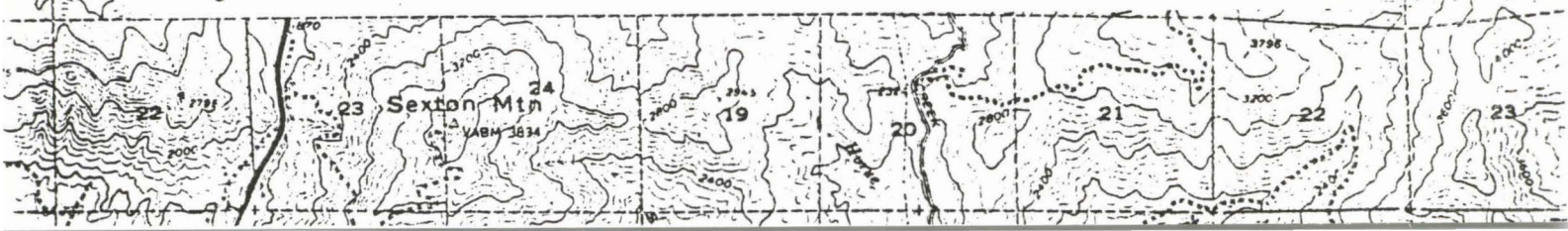

Figure 1: Topographic Location Map, Martha Mine (1inch=1mile)



LEGEND

-  Dragon's Gold (DG-x) Claim Group
 -  Saint Pater (SP-x) claim group - Bert West.
 -  Horseshoe Extension (HE-x) / Alley (A-x) claim group - Miller
 -  King Midas claim - Bill Mignot
- Color blocks indicate senior staker.
Borders surround claim groups.

Note: West claims approximated from poor descriptions on location notices in courthouse. Miller and Dragon's claims taken from other available maps.

Claims information based on courthouse research only - no field examination.

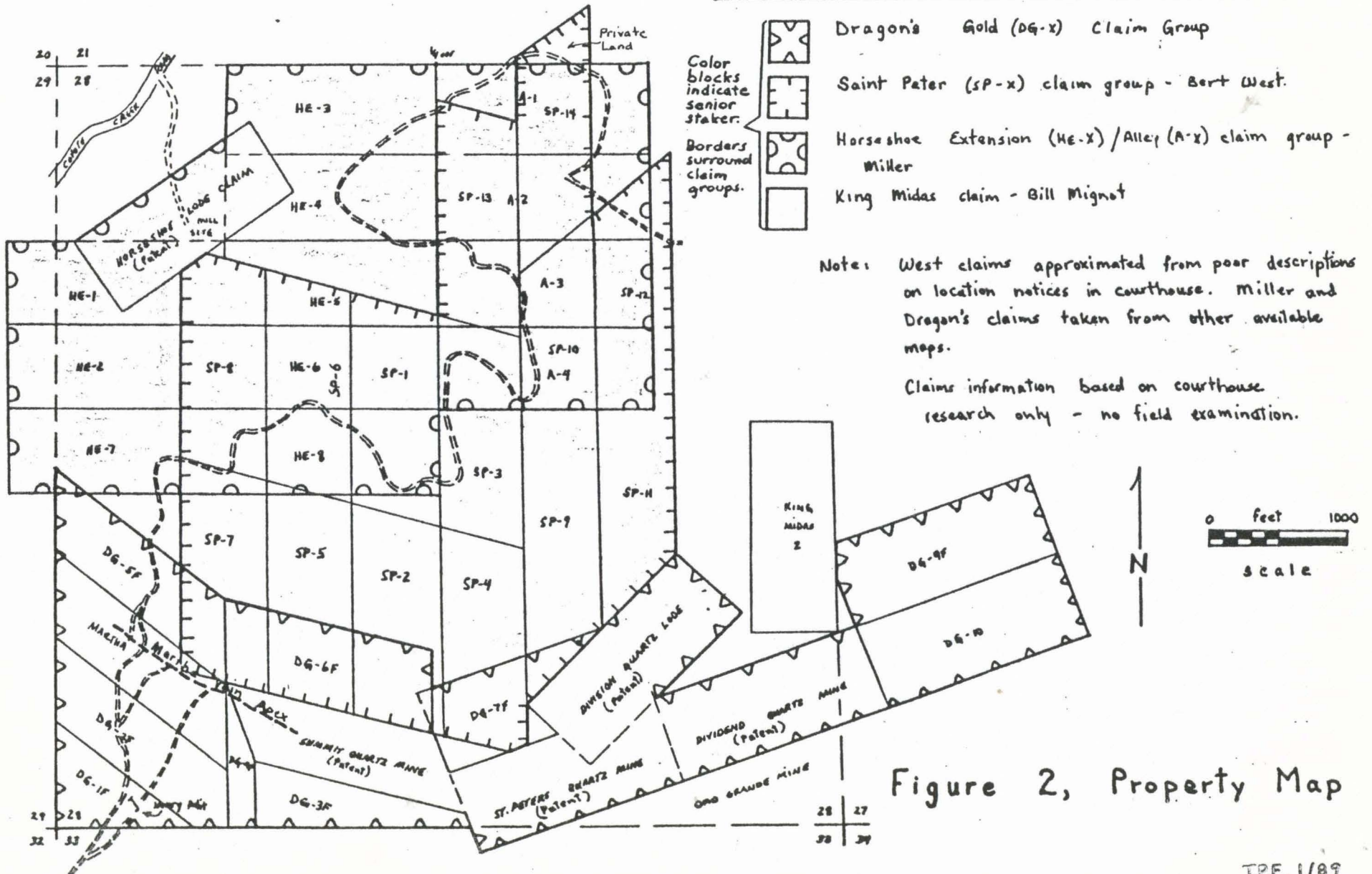

Figure 2, Property Map