

Waldo But

7-7-38  
Josephine County

Lucky Strike Mine (gold quartz)

Owners: John a Fetterly and A. H. Marks (died in March) R. F. D.,  
Kerby, Oregon.

Location:  $1\frac{1}{2}$  miles by trail west of Bolan Lake, in iron Gulch,  
Sec. 1, T. 41 S., R. 7 W.

Area: Three quartz claims - 60 acres- held by location.

History: Discovered in 1932. Worked by hand until 1937 when they  
put in a self-shooter 12 ft. high\* by 3 ft. wide.

General Information: No water right. Stripping contact by the use  
of self-shooter. Water to operate from November to June.  
Elevation 4400 ft. Gulch operation. Lots of boulders.  
Steep mountainous topography. No clay, talc about 12 ft.  
wide. Gold comes from pockets along contact. Produced  
\$1200 to July 1937. Have not made complete clean-up since  
then.

Geology: Contact of altered greenstone and serpentine.

Informant: J. E. Morrison.

State Department of **RECEIVED** ~~Geology~~ and Mineral Industries  
JAN 23 1961

DEPT. OF GEOLOGY  
MINERAL INDS.

1069 State Office Building  
Portland 1, Oregon

LUCKY STRIKE (Allen Prospect) - Au, Ag, Cu

Josephine County  
Waldo District

Owner: James L. Allen, Cave Junction.

Area: Two lode claims, the Jackpot No. 1, and the Lucky Strike were located in 1937 and 1938.

Location: The claims are in the SW $\frac{1}{4}$  sec. 5, T. 41 S., R. 7 W. The area examined is on the Lucky Strike claim along east fork Elder Creek below Allen's small cabin which is beside the old Happy Camp road at about 4,000 feet elevation. The area is reached via the Happy Camp road and is about 8 $\frac{1}{2}$  miles from Takilma Road junction.

Development work: Debris in the creek has been washed away from the bedrock by means of a selfshooter. A small amount of gold has been recovered in sluice boxes. A quartz vein is exposed in part by a small partly caved cut.

Geology: Mineralization occurs in a fairly flat-lying quartz vein which is exposed in the bed of Elder Creek for a distance of about 35 feet. The vein is within contorted sandstones and argillites of the Applegate group of Upper Triassic Age. These sandstones and argillites strike about N. 30° E. and dip 35° SE. The vein strikes northeasterly and has an apparent shallow dip SE. Because the true dip of the vein is not shown in the limited exposure, the thickness of the vein is difficult to measure, however, it appears to be from 5 to 8 feet thick. In the creek the vein is overlain by a thin lens of fractured sandstone lying between the vein and a medium-grained, in part porphyritic dike of dioritic(?) composition. A few lenses and shears containing serpentine add to the complexity of the

geology in the small area examined.

The sulfide-bearing portions of the vein contain the better values. Sulfides including pyrite, chalcopyrite, and rare galena(?), are concentrated in some portions of the vein and almost completely lacking in other areas. Silver and copper appear to be the most important metals contained. Much of the gold recovered in the creek below the vein is reportedly a light color probably due to its silver content.

The following assays were made on samples from the vein.

<u>Sample Number</u>	<u>Description</u>	<u>Oz/T</u> <u>Au</u>	<u>Oz/T</u> <u>Ag</u>	<u>%</u> <u>Pb</u>	<u>%</u> <u>Cu</u>
P-25437	Sulfides in quartz	0.12	5.30	0.10	—
P-25438	Malachite & pyrite in rusty quartz	0.06	1.50	0.10	—
P-25572	Quartz with chalcopyrite & bornite	0.03	2.60	—	—
P-25682,UG-229	Fractured rusty quartz	0.01	Nil	—	—
P-25683,UG-230	Quartz with pyrite & chalcopyrite	0.045	2.40	—	2.40

Visited: 9/8/60.

Informant: James L. Allen.

Report: 1/10/61 by Len Ramp.

Reference: Wells, Francis G., Preliminary Geology of the Kerby Quadrangle, Oregon: Oregon Dept. of Geology & Mineral Industries, Bull. 40, 1949.

\* \* \* \* \*

STATE OF OREGON DEPARTMENT OF GEOLOGY AND MINERAL INDUSTRIES  
ASSAY LABORATORIES

REQUEST FOR SAMPLE INFORMATION

The State law governing free analysis of samples sent to State Assay Laboratories requires that certain information be furnished the Laboratory regarding samples sent for assay or identification. A copy of the law will be found on the back of this blank. Please fill in the information called for as completely as possible, and submit it along with your sample. Keep a copy of the information on each sample for your own reference.

Your name in full James L. Allen

Post-office address Grave Creek

Are you a citizen of Oregon yes Date on which sample is sent 9/24/45

Name (or names) of owners of the property James L. Allen

Name of claim sample obtained from Lucky Strike

Location of property or source of sample (describe as accurately as possible below):

County Josephine Mining district Waldo

Township 41 Range 7W Section 5 Quarter section \_\_\_\_\_

How far from passable road 300'

For what minerals or elements do you wish the sample(s) analyzed Au, Ag, Pb.

	<u>Channel (length)</u>	<u>Grab</u>	<u>Pipe</u>	<u>Description</u>
Sample No. 1	<u>600'</u>	_____	_____	_____
Sample No. 2	_____	_____	_____	_____

**IMPORTANT:** A vein sample should be taken in an even channel across the vein from wall to wall. Location of sample in the workings, together with the width measured, should be recorded.

(Signed) James L. Allen

**DO NOT WRITE BELOW THIS LINE - FOR OFFICE USE ONLY - USE OTHER SIDE IF DESIRED**

Description \_\_\_\_\_

Sample Number	GOLD		SILVER		LEAD		TOTAL
	oz./T.	Value	oz./T.	Value			
FG-294	0.32	\$11.20	7.12	\$6.41	0.10%		\$17.61
FG-295	0.01		Trace		Trace		

Report issued \_\_\_\_\_ Card filed \_\_\_\_\_ Report mailed \_\_\_\_\_ Called for \_\_\_\_\_

State Department of Geology and Mineral Industries

RECEIVED  
OCT 27 1945

702 Woodlark Building  
Portland, Oregon

STATE DEPT OF GEOLOGY  
& MINERAL INDS.

Report by: Elton A. Youngberg  
Date: October 19, 1945

Waldo Area  
Josephine County

Name: Lucky Strike Prospect (Gold, silver, copper)

Owner: J. L. Allen, Sunny Valley, Oregon

Location: The property is located between the nine and ten mile posts on the Happy Camp Takilma road on Elder Creek. The property is in Sec. 5, T. 41 S., R. 7 W.

Area: The property consists of two located lode claims, the Lucky Strike and the Jack Pot.

History: The prospect has had no production.

Development: The vein has been open by five shallow cuts and a short adit fifteen feet long which is now caved. The cuts expose the vein at intervals for about 150 feet along its outcrop on the east side of Elder Creek.

Geology: In the immediate vicinity of the prospect the area is rather flat resulting in heavy overburden which prevented detailed examination of country rocks. The vein is in a shear zone in a black, fine ground rock, probably a meta volcanic of Mesozic age. Considerable float of diorite and related rocks were noted on the west side of Elder Creek indicating the contact between diorite and the meta volcanics was 100-200 feet west of the vein outcrop. A belt of diorite was noted crossing the Happy Camp road about 700 feet northeast of the prospect.

The vein is very flat, dipping  $5^{\circ}$  to  $20^{\circ}$  in an easterly direction. The strike of the vein was difficult to deter-

# State Department of Geology and Mineral Industries

702 Woodlark Building  
Portland, Oregon

(2)

mine because of its flat dip but appeared to have a north-easterly strike. The vein consisted of a band of mineralized quartz four to five feet in thickness with a shear zone on the footwall side.

The metallic minerals in the vein were chalcopryrite, pyrite and chalcocite, no free gold was noted. Assay values run from \$10-\$20 in gold accompanied by five to ten ounces of silver. No analysis have been made for copper.

Equipment: There is no mining or milling equipment on the property.

General Information: The mountain slopes are steep in the area, however in the vicinity of the mine which is near the summit of the mountain the terrain is rather flat. Snow fall is heavy in this area during the winter months and the roads are closed to automobiles. Water is ample for a small mining and milling operation the year around. The roads from Grants Pass to the property are surfaced or graveled and passable except for snow at higher elevations during the winter months. The nearest railroad is at Grants Pass a distance of fifty miles.

# Lucky Strike Mine

Ownership: J.L. Allen

Claims - Two Lode claims

Area. Elevation 4000 ft.

On Elder Creek a branch of E. fork of Illinois, mine is located about a mile below its head and 300 ft below the Happy Camp road.

Development: The vein is exposed by several cuts and a short adit 15' in length.

Geology. The vein is in meta-volcanics near a contact with diorites. The vein is 4-5' in width and dips 5-20° to the East. The ore minerals were chalcopyrite and chalcocite and pyrite. The diorite lies to the ~~east~~<sup>west</sup> of Elder Creek.

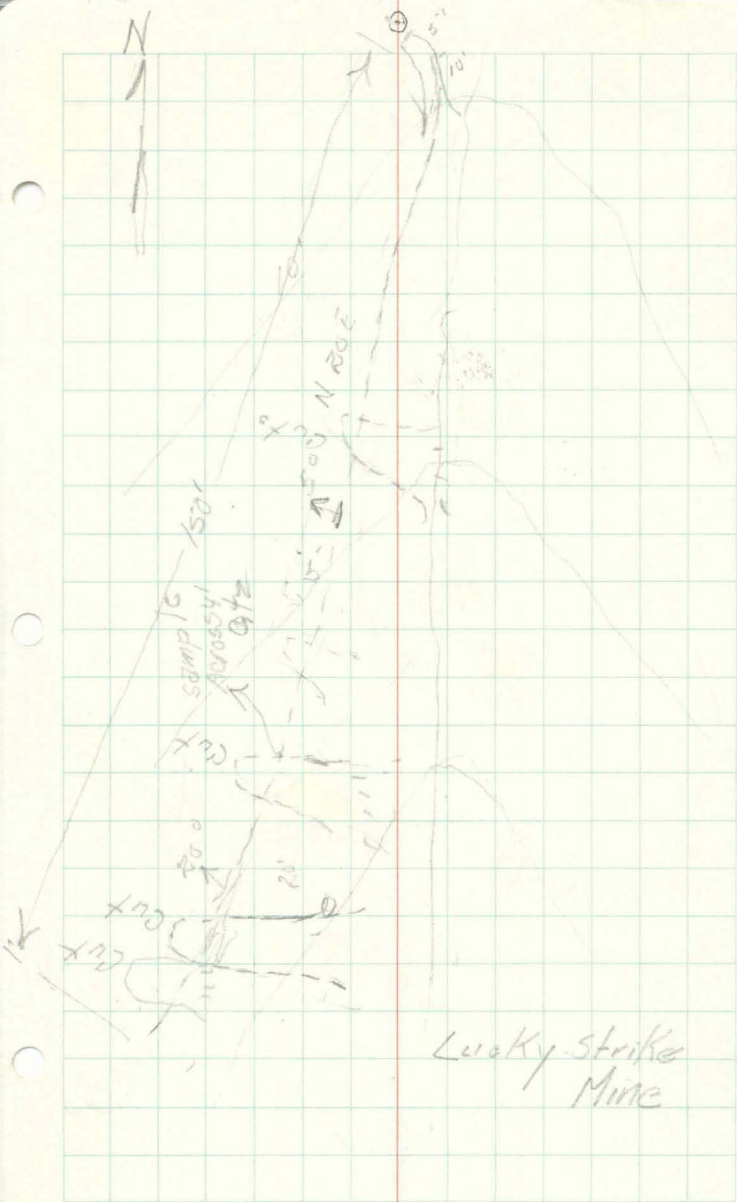

Lucky Strike  
Mine



9-8-60

with Jim Allen to  
his Lucky Strike claim

(A) E Fork

3475 on Elder Creek

~~3036~~

crosscut (open into vein quartz  
fr. Fe stained some chalcopyrite  
vein cut is caved

vein said to be about 5 feet  
striking flat lying?!

footwall? rock is meta sed  
ss - argill. to striking N30E  
dipping SE 35+

Top of vein exposed <sup>just</sup> above  
self shooter appears still  
flat-lying dipping gently  
SE overlain by thin  
lens of sandstone then  
medium grained in part  
porphyritic dioritic dike  
rock

gold in quartz is reported to  
be light colored due to silver  
content

at B.M. 3861 3861

altimeter reads 3300

i.e. too low 561 ft

# ASSAY REPORT

~~Baker, Oregon~~  
Grants Pass, Oregon.

Date October 7, 1937

Sample submitted by Mr. J. E. Morrison

Sender's Address Grants Pass, Oregon

Description of sample furnished by sender Number 4; Allen - Lucky Strike.

Character: Quartz. Weight: About 7 pounds. Size: 2 inches and smaller.

The assay results given below are made without charge as provided by Chapter 176, Section 10, Oregon Laws 1937, the sender having complied with the provisions thereof.

**NOTICE: The assay result given below is from a sample furnished by the above named person. This department had no part in the taking of the sample and assumes no responsibility, other than the accuracy of the assay of the material as furnished it by the sender.**

	Ounces per ton	Dollars per ton	Per cent	Value per ton	Total Value
Gold @ \$35.00 / oz.	0.02	0.70			\$0.70
Silver @ \$0.77 / oz.	0.82	0.63			0.63
Copper . . . . .					
Lead . . . . .					
Zinc . . . . .					
. . . . .					
. . . . .					
. . . . .					
. . . . .					
Total Value .					\$1.33

STATE DEPARTMENT OF GEOLOGY AND MINERAL INDUSTRIES

ASSAY LABORATORIES

Baker, Oregon  
Grants Pass, Oregon

SAMPLE INFORMATION REQUESTED

The law passed by the Legislature, governing the free assaying and analyzing of samples sent to a State Assay Laboratory, provides that certain information be furnished to the laboratory regarding samples sent for assays, etc. A copy of the law will be found on the back of this blank. Please read the law carefully. Will you please fill in the information called for in the following blank, as far as possible, and return the same to the nearest State Assay Laboratory, along with your sample. If you have made out a blank, this copy is for your future use. Keep a copy of the information on each sample for your own reference.

Your name in full *J. E. Morrison*

Post office address

Are you a citizen of Oregon?  Date on which sample is sent *Sept 22 1937*

Name (or names) of owners of the property *J. S. Allen*

Name of particular claim and date of location *Lucky Strike April 1937*

Location of property or source of sample:

(1) County *Jesphine* (2) Mining District *Walds*

(3) Township *41 S* (4) Range *7 W* (5) Section *5*

(6) Quarter Section

How far from passable road? *On Happy Camp Road*

For what do you wish sample tested? *Gold & silver*

Does your sample represent a new discovery? *no*

On a newly located claim? *no* Old? *yes*

Has any ore from this claim been milled or shipped? *no*

Width of ore where sample was taken (length of channel cut) *7' along & across vein*

Remarks: The Department would be pleased to have you add to the above, such information as you think would be of interest and value. This could be placed in the space below or upon a separate sheet. This could best be shown by a pencil sketch, indicating the development on the claim with widths of vein, especially the width of ore at the place where this sample was taken.

A sample, to be of value, should be taken in an even channel across the vein from wall to wall. Its position in the workings should be marked and the width measured. Assays of unlocated samples, without widths, are of little value. They create but little interest in the minds of experienced investors and engineers.

*Sample no 4.*

Signed *J. E. M.*

# ASSAY REPORT

~~X~~ Baker, Oregon.  
Grants Pass, Oregon.

Date October 7, 1937.

Sample submitted by Mr. J. E. Morrison

Sender's Address Grants Pass, Oregon

Description of sample furnished by sender Sample number 2; Allen-Lucky Strike.

Character: Quartz. Weight: About 3 pounds. Size: 1 inch and smaller.

The assay results given below are made without charge as provided by Chapter 176, Section 10, Oregon Laws 1937, the sender having complied with the provisions thereof.

**NOTICE:** The assay result given below is from a sample furnished by the above named person. This department had no part in the taking of the sample and assumes no responsibility, other than the accuracy of the assay of the material as furnished it by the sender.

	Ounces per ton	Dollars per ton	Per cent	Value per ton	Total Value
Gold $\text{\$}35.00 / \text{oz.}$	0.02	0.70			$\text{\$}0.70$
Silver $\text{\$}0.77 / \text{oz.}$	0.72	0.55			0.55
Copper . . . . .					
Lead . . . . .					
Zinc . . . . .					
. . . . .					
. . . . .					
. . . . .					
. . . . .					
. . . . .					
Total Value .					$\text{\$}1.25$

# State Department of Geology and Mineral Industries

702 Woodlark Building  
Portland, Oregon

Report by: Elton A. Youngberg  
Date: October 19, 1945

## ECONOMICS:

The length, width and values of the vein on this prospect is considerably better than average. If the vein proves to have continuity on its up a small tonnage of good grade ore could quickly be developed.

The owner plans to further expose the outcrop to determine further extensions of the vein. A local contractor with earth moving equipment possibly will aid in the development of the prospect.

CONFIDENTIAL

*Len*

STATE DEPARTMENT OF GEOLOGY AND MINERAL INDUSTRIES  
 2033 First Street Baker, Oregon      1069 State Office Building Portland 1, Oregon      239 S.E. "H" Street Grants Pass, Oregon

REQUEST FOR SAMPLE INFORMATION

The State law governing analysis of samples by the State assay laboratory is given on the back of this blank. Please supply the information requested herein fully and submit this blank filled out along with the sample.

Your name in full Len Ramp (DOGAMI)  
 Street or P.O. Box P.O. Box 417 City & State Grants Pass, Oregon  
 Are you a citizen of Oregon? Yes Date on which sample is sent 9/9/60  
 Name (or names) of owners of the property Jim L. Allen Gen Del Cave Junction  
 Are you hiring labor? \_\_\_\_\_ Are you milling or shipping ore? \_\_\_\_\_  
 Name of claim sample obtained from Lucky Strike

Location of property or source of sample (If legal description is not known, give location with reference to known geographical point.)

County Josephine Mining District Waldo  
 Township 41 S Range 7 W Section 5 Quarter section \_\_\_\_\_

How far from passable road? 100 yards Name of road Old Happy Camp Road

	Channel (length)	Grab	Assay for	Description
Sample no. 1		<u>x</u>	<u>Au, Ag</u>	<u>from various parts vein in creek</u>
Sample no. 2		<u>x</u>	<u>Au, Ag, Cu</u>	<u>from dump caved out</u>

(Samples for assay should be at least 1 pound in weight)

(Signed) L.R.

DO NOT WRITE BELOW THIS LINE - FOR OFFICE USE ONLY - USE OTHER SIDE IF DESIRED

Sample Description #1 - Fractured iron-stained vein quartz. ✓  
#2 - Vein quartz with some mixed chalcopyrite and pyrite sulfides are partially oxidized.

Sample number	GOLD		SILVER		COPPER			
	oz./T.	Value	oz./T.	Value	Cu			
UG-229 P-25682	0.01	\$0.35	Nil	- - -	- - -	- - -	- - -	- - -
UG-230 P-25683	0.045	\$1.57	2.40	\$2.17	2.40%	- - -	- - -	- - -

Report issued \_\_\_\_\_ Card filed \_\_\_\_\_ Report mailed 9-28-60 Called for \_\_\_\_\_

STATE DEPARTMENT OF GEOLOGY AND MINERAL INDUSTRIES

ASSAY LABORATORIES

Baker, Oregon  
Grants Pass, Oregon

SAMPLE INFORMATION REQUESTED

The law passed by the Legislature, governing the free assaying and analyzing of samples sent to a State Assay Laboratory, provides that certain information be furnished to the laboratory regarding samples sent for assays, etc. A copy of the law will be found on the back of this blank. Please read the law carefully. Will you please fill in the information called for in the following blank, as far as possible, and return the same to the nearest State Assay Laboratory, along with your sample. If you have made out a blank, this copy is for your future use. Keep a copy of the information on each sample for your own reference.

Your name in full J. E. Monahan

Post office address

Are you a citizen of Oregon?  Date on which sample is sent Sept 22 1937

Name (or names) of owners of the property J. E. Monahan

Name of particular claim and date of location Lucky Strike April 1937

Location of property or source of sample:

(1) County Josephine (2) Mining District Waldo

(3) Township H 1 S (4) Range 7 W (5) Section 5

(6) Quarter Section

How far from passable road? On Happy Camp Road.

For what do you wish sample tested? Gold & Silver

Does your sample represent a new discovery? no

On a newly located claim? no Old? April 1937

Has any ore from this claim been milled or shipped? no

Width of ore where sample was taken (length of channel cut) 4 ft across vein

Remarks: The Department would be pleased to have you add to the above, such information as you think would be of interest and value. This could be placed in the space below or upon a separate sheet. This could best be shown by a pencil sketch, indicating the development on the claim with widths of vein, especially the width of ore at the place where this sample was taken.

A sample, to be of value, should be taken in an *even channel across the vein* from wall to wall. Its position in the workings should be marked and the width measured. Assays of unlocated samples, without widths, are of little value. They create but little interest in the minds of experienced investors and engineers.

Sample No 3

Signed J E M.